



Bharat Heavy Electricals Limited

(A Government of India Undertaking)

Electronics Division

*P.B.No 2606, Mysore Road, Bangalore - 560 026.
External Services Department*

Notice Inviting Tender (NIT)

for

Electrical Repairs Works for BHEL –EDN Site office at 4 x 210 MW Thermal Power Station Stage-II TS-II at Neyveli Lignite Corporation, Neyveli.

at

**4 x 210 MW Thermal Power Station TS-II Stage-II
Neyveli Lignite Corporation Limited.
NEYVELI Dist. Cuddalore
Tamil Nadu.**

NIT No. : CE-ES/2014-15/16/Neyveli R&M/EW/MJ

Date: 10-09-2014

Tender due Date and Time: 06.10.2014 at 13:00 hrs

Tender Opening Date and Time : 06.10.2014 at 13:30 hrs

Total Number of Pages (Including Cover): 09



ಭಾರತ್ ಹೆವಿ ಎಲೆಕ್ಟ್ರಿಕಲ್ಸ್ ಲಿಮಿಟೆಡ್
भारत हेवी इलेक्ट्रिकल्स लिमिटेड
Bharat Heavy Electricals Limited

(A Government of India Undertaking)

ELECTRONICS DIVISION

P.B.No 2606, Mysore Road, Bangalore - 560 026

Phone : 080 – 26998657 / 26989126, Fax : 080 – 26989222, email id : jagadeesan@bheledn.co.in,
maurya@bheledn.co.in, sdbarman@bheledn.co.in

TO

Dear Sirs,

Sub : Tender enquiry for sub-contract work for carrying out Electrical repair works in closed storage shed at BHEL EDN Storage Yard in NLC, TS - 2, STAGE – II R & M site (4 x 210 MW).

Tender Enquiry Number : CE/ES/2014-15/16/NEYVELI-R&M/EW/MJ
Tender date : 10.09.2014
Tender due Date and Time : 06.10.2014 at 13.00 hrs.

Sealed tenders in single part are invited for carrying out electrical repair works in closed storage shed at No. 131, BHEL EDN Storage Yard in NLC, TS - 2, STAGE – II R & M site (4 x 210 MW), NEYVELI. The following details may be carefully studied and considered in responding to this enquiry.

1. No extension of time will be given for submission of offer under any circumstances.
2. Offer cover shall be super scribed with the "Tender Enquiry number, due date and time".
3. Offer can be sent by post/courier addressed to the Addl. General Manager / External Services Department, BHEL-EDN, P.B.No.2606, Mysore Road, Bangalore-560 026 so as to reach us before the due date and time. Offers can be handed over / submitted to Resident Manager, BHEL-EDN-NLC site, TS-2, stage – II, Neyveli also, before due date & time.



4. Offers will be opened at Tender opening room situated near Reception, BHEL-EDN, Bangalore on 06.10.2014 at 13.30 hours in the presence of bidders who wish to be present.
5. This tender is for carrying out electrical repair works in closed storage shed.
6. The validity of offer shall be for 90 days from the date of opening.
7. The prices quoted shall be FIRM. No escalation in price/s will be allowed.
8. Service tax & WCT shall be paid extra on submission of ST registration certificate / details.
9. The bidder shall submit a copy of ESI, PF registration and Income Tax PAN Number along with the offer.
10. The tender is likely to be finalized in a very short time.
11. Advance payment and interim payment will **not** be paid.
12. For any clarification on this tender, Addl. General Manager / External Services may please be contacted on phone no. 09489509597 / 080 - 26989126, Fax no. 080 - 26989222 / 26989217, email id: maurya@bheledn.co.in, sdbarman@bheledn.co.in

Kindly acknowledge receipt of this tender enquiry.

BHEL reserves the right to cancel or reject the offer either partly or in full without assigning any reasons thereof.

Bidder is advised to return one set duly signed in all the pages along with the offer.

Thanking you,

Yours Faithfully,
For & On behalf of BHEL-EDN

(SUBHRAJYOTI D BARMAN)
Manager / BHEL-EDN-NLC Site



SECTION 1

SPECIAL INSTRUCTIONS

1. **Project Location:** Work is to be carried out in shed No. 131 (BHEL) at STG – II of TS - II, NLC Limited, Neyveli. NLC, TS-II is located at Neyveli, Panruti Taluk in the district of Cuddalore, Tamilnadu and it is around 200 km from Chennai.
2. The offer shall be submitted in a single part in a sealed envelope prominently super scribing the Tender Enquiry Number and due date as mentioned in the covering letter.
3. The bidder is requested to carefully and thoroughly read the instructions / documents sent to them. For any further clarifications bidders may be contacted BHEL-EDN officials.
4. The bidder is advised to visit project site to familiarize themselves with the site conditions before preparing the offer.
5. Security deposit @ 10% of the total price of work order shall be paid by the successful bidder. The SD amount by pay order or demand draft in favour of BHEL, payable at Bangalore before start of work.
6. The security deposit shall not carry any interest.
7. Security Deposit amount will be returned after three months from the date of successful completion of work as per the contract after duly certified by BHEL Site Engineer.
8. The bidder will have to submit a certificate to BHEL declaring that the bidder has complied with all the statutory provisions including and pertaining to Provident fund and ESI during the execution period of the contract. All persons working should have PF & ESI. **ESI is must for all men entering the TS - II premises.**
9. All necessary personal safety equipment as considered adequate by the BHEL site Engineer or the safety officer of NLC should be made available at bidders cost for use by the persons working at repair work.
10. Workmanship guarantee is applicable for a period of three months from the date of successful completion of work. Any rectification work to be carried out during the guarantee period shall be carried out at free of cost.
11. The bidder shall mobilize his men, materials, tools & tackles to site immediately after the date of intimation from BHEL or release of work order.
12. In addition to the local laws and regulations the bidder shall also comply with the Minimum Wages Act. The Payment of Wages Act and the rules made there under in respect of labour currently employed on or connected with the contract shall be followed.



13. **Payment terms:** 90% payment will be released within 30 days from the date of receipt of bill at BHEL-EDN, Bangalore on completion of work & actual measurement certification by BHEL Site Engineer. Bill shall be forwarded to BHEL-EDN, Bangalore for process and release of payment will be made from Bangalore. Balance 10 % will be paid after completion of workmanship guarantee period, against supplementary invoice.
14. **Mode of payment:** Payment will be made by EFT and the charges shall be borne by the bidder. The bidder will be required to submit original filled & signed format for EFT mode of payment along with a crossed cancelled Cheque. EFT form will be provided along with work order.
15. **No EMD is applicable for this tender.**
16. Service tax & WCT shall be paid extra. A copy of service tax registration certificate shall be enclosed with the offer.
17. Income tax plus surcharge as applicable will be deducted from the gross amount of each bill. Please indicate the IT PAN and a copy of PAN Card be submitted with the offer.



SECTION 2

ELECTRICAL REPAIR WORKS IN CLOSED SHED AT BHEL EDN STORAGE YARD IN STAGE – II OF TS - II, NLC, NEYVELI SITE (4 x 210 MW)

A) SCOPE OF WORK:

1. A closed shed exists at store no. 131 (BHEL) storage yard in STG-II of TS-II, NLC Limited, Neyveli.
2. In the closed shed, supply and fixing PVC conduits (25mm), Wiring along with earth wire with the following sizes of FR PVC insulated copper conductor, single core cable in PVC conduit as required (2.5 sq.mm and 1.5 sq.mm cables wherever necessary). And supply and fixing of suitable supply points and lighting points with complete wiring and installation MCB of suitable ratings with distribution board as per architectural drawings and the directions of Engineer-in-charge.
3. Providing and fixing CFL lamps (80W), tube lights (80W), Switches and sockets (5A and 15A rating), AC points with suitable MCB (15A) and flood lights (Halogen lamp of 500/1000W) as per the directions of Engineer-in-charge.
4. Providing & fixing main distribution board with 40A MCCB as per directions of Engineer - in – charge.

B) SUPPLY OF MATERIAL:

1. Required quantity of PVC conduits, FR PVC wires (1.5 sq.mm and 2.5 sq.mm).
2. Required quantity of Switches, Sockets, MCB and Distribution board as mentioned in scheme.
3. Required quantity of CFL, Tube lights and Halogen focus lights along with fittings as mentioned in scheme
4. Consumables as required for completion of job.

C) TOOLS & TACKLES:

All the tools & tackles required for making partitions are to be arranged by the bidder.

D) MAN POWER:

The bidder should be able to depute required technical manpower for completion of the work.

The sketch of the electrical scheme to be done in closed shed is shown below:

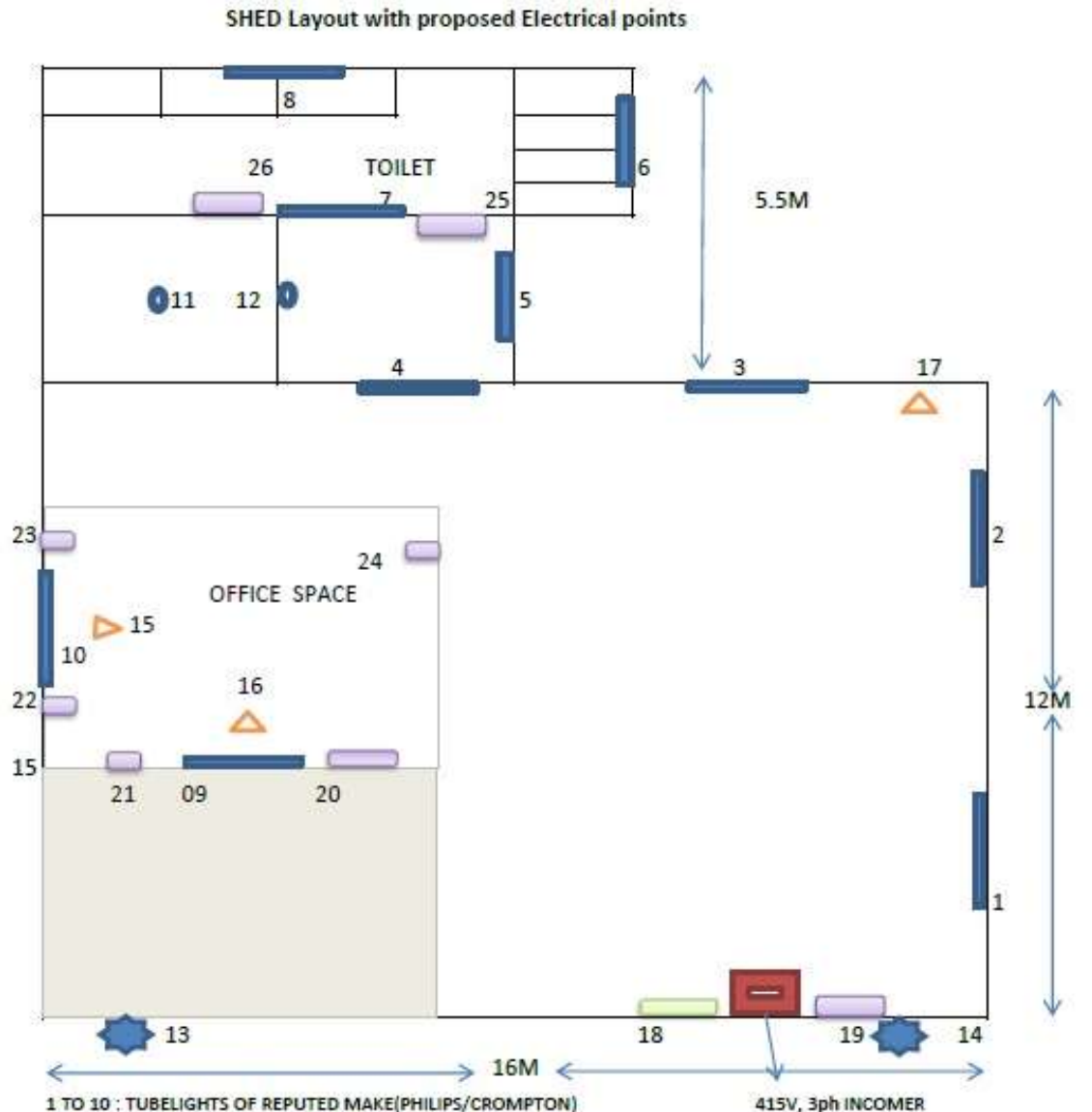

- 1 TO 10 : TUBELIGHTS OF REPUTED MAKE(PHILIPS/CROMPTON)
 - 11-12 : CFL LAMPS OF REPUTED MAKE(PHILIPS/ CROMPTON)
 - 13-14 : FOCUS LIGHT/FLOOD LIGHTS OF REPUTED MAKE (Halogen lamp)
 - 15-17 : AC POINTS WITH 15 A (MCB)BREAKER -REPUTED MAKE (ANCHOR/ HAVELLS/CROMA)
 - 18 : SUPPLYBOARD HAVING 40 A MCB FOR TAPPING MAIN SUPPLY FOR LIGHTING FROM EXISTING 415V 3 PHASE CUSTOMER SUPPLY
 - 19 : SWITCH BOARD HAVING 2 nos of 10 A MCB FOR FOCUS LIGHTING AND TUBE LIGHTS, 5A SWITCHES - 7 nos AND 5A 3PIN SOCKET - 3nos
 - 20 : SWITCH BOARD HAVING 1 nos of 10 A MCB, 5A SWITCHES - 4 nos AND 5A 3PIN SOCKET - 2nos
 - 21-24 : SWITCH BOARD/EXTENSION BOARD - 4 NOS HAVING 5A SWITCH - 4nos AND 5A 3 PIN SOCKET - 4NOS EACH RESPECTIVELY
 - 25 : SWITCH BOARD WITH 1NO OF 10A MCB AND 15A 3 PIN SCCKET WITH SWITCH - 2nos, 5A SWITCH 3 -nos, 5A 3 PIN SOCKET -1 no.
 - 26 : SWITCH BOARD HAVING 5A SWITCHES -4nos.
 - 29 : SWITCH BOARD WITH 1NO OF 10A MCB AND 15A 3 PIN SCCKET WITH SWITCH - 2nos, 5A SWITCH 3 -nos, 5A 3 PIN SOCKET -1 no.
 - 30 : SWITCH BOARD HAVING 5A SWITCHES -4nos.
- ALL SWITCHES , SOCKETS and MCB SHOULD BE REPUTED MAKE (ANCHOR/ HAVELLS/CROMA)



SECTION – 3

(SCHEDULE OF PRICE)

S.No	Description of work	Unit	Approx Quantity	Unit Price in Rs.	Total Price in Rs.
1	Supplying and fixing of following sizes of medium class PVC conduit along with accessories in surface/recess including cutting the wall and making good the same in case of recessed conduit (25mm)	Meters	120		
2	Wiring for circuit/ submain wiring along with earth wire with the following sizes of FR PVC insulated copper conductor, single core cable in PVC conduit as required				
2.1	2x1.5sq.mm + 1x1.5sq.mm	Meters	150		
2.2	2x2.5sq.mm + 1x2.5sq.mm	Meters	80		
3	Supplying and fixing box of following sizes (nominal size) on surface or in recess with suitable size of phenolic laminated sheet cover in front including painting etc as required.				
3.1	180X100X60mm	nos	1		
3.2	150X150X60mm	nos	3		
3.3	100X100X60mm	nos	1		
3.4	75X75X60mm	nos	4		
4	Supplying and fixing following rating, double pole, (single phase and neutral), 240 volts, residual current circuit breaker (RCCB), having a sensitivity current upto 300 milliamperes in the existing MCB DB complete with connections, testing and commissioning as required 40A	nos	1		
5	Supplying and fixing 5 amps to 32 amps rating, 240/415 volts, "C" curve, miniature circuit breaker suitable for inductive load of following poles in the existing MCB DB complete with connections, testing and commissioning etc. as required	nos	5		
6	Supplying and fixing TP sheet steel enclosure on surface/ recess along with 16 amps 415 volts "C" curve TP MCB complete with connections, testing and commissioning etc. as required.	nos	3		
7	Supplying and fixing brass batten/ angle holder including connection etc.	nos	2		
8	Tube light fixing charges	nos	10		
9	5A switch supply & fixing charges	nos	33		
10	5A socket supply & fixing charges	nos	20		
11	15A switch supply & fixing charges	nos	2		
12	15A socket supply & fixing charges	nos	2		
13	Tube light set of reputed make	nos	10		
14	Focus light set of reputed make	nos	2		
15	CFL lamps of reputed make	nos	2		



i) TOTAL COST IN FIGURES:

ii) TOTAL COST IN WORDS:

Note:

- a. Total cost exclusive of taxes & duties. Taxes & duties will be considered for evaluation at prevailing rates. (Service tax on 70% Value @12.36% and WCT 2.1% on total value)
- b. The quantity mentioned above is tentative, may vary depends on actual size.

(SIGNATURE OF THE BIDDER WITH SEAL)

-X-X-X-