

Figure 6.1

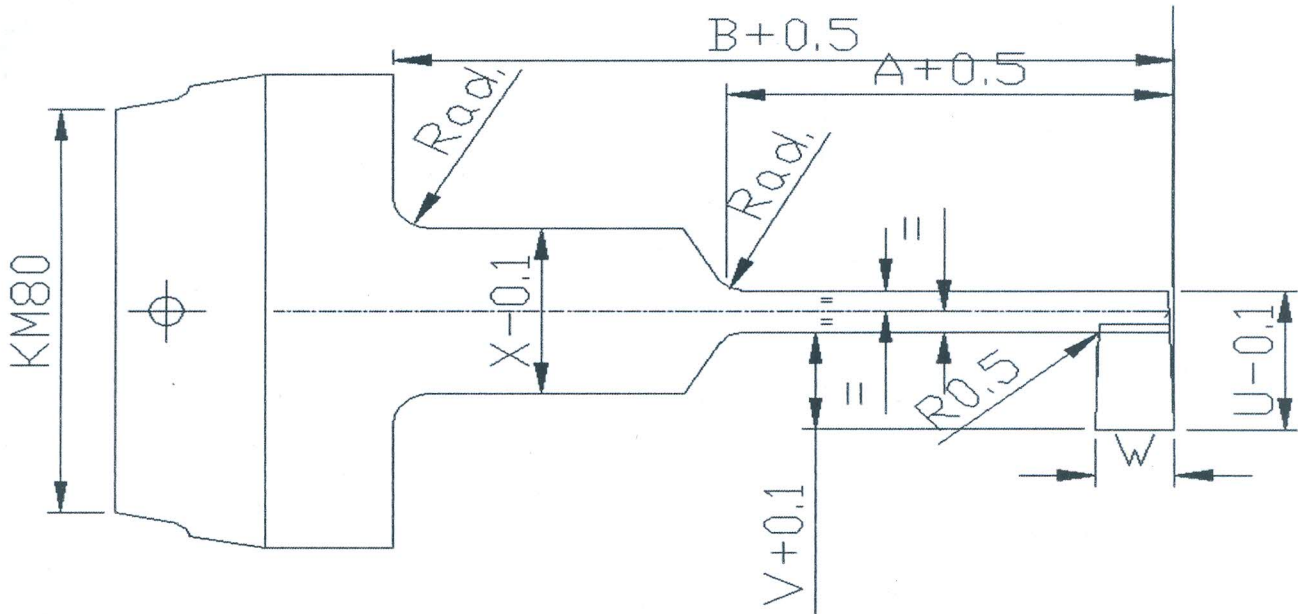

Table 6.2 (All dimensions are in mm w.r.t figure 6.1)

| SNO. | TLMW | U | V | W | X | A | B | Dia for Face Grooving | | Qty. |
|------------|------|----|-----|---|----|----|----|-----------------------|-----------|------------------------|
| | | | | | | | | Dia(Min.) | Dia(Max.) | |
| 1 | | 22 | 8 | 6 | 23 | 48 | 70 | 755 | 1020 | LH- 1 set RH- 1 set |
| 2 | | 31 | 11 | 6 | 40 | 48 | 70 | 550 | 800 | LH- 1 set RH- 1 set |
| 3 | | 31 | 11 | 6 | 30 | 55 | 80 | 720 | 1015 | LH- 1 set RH- 1 set |
| 4 | | 16 | 6.5 | 6 | 17 | 38 | 65 | 1150 | 1650 | LH- 1 set RH- 1 set |
| TOTAL QTY. | | | | | | | | | | LH- 4 set RH- 4 set |

Radius (Rad.) - vendor's choice (any suitable radius)

1 work
CV-Kishan 7/4/15
NCTech

