



Bharat Heavy Electricals Limited

(High Pressure Boiler Plant)

Tiruchirapalli – 620014, TAMIL NADU, INDIA

An ISO 9001 Company

MATERIALS MANAGEMENT

| | |
|---|---|
| TITLE CORRIGENDUM for NIT-22285 | Phone: +91 431 2577025 Fax : +91 431 252 0719 Email : dcm@bheltry.co.in / mmcpmfg3@bheltry.co.in |
|---|---|

| | | |
|--|------------------------------------|--|
| Reference Number: Enquiry 2661500123 | Enquiry Date: 23.04.2015 | Due date for submission of quotation: 16.05.2015 |
|--|------------------------------------|--|

You are requested to quote the Enquiry number date and due date in all your correspondences. This is only a request for quotation and not an order

CORRIGENDUM - I

| Details of Corrigendum |
|--|
| <i>i) Drawing no. : 4-M-20B-09-24615 is enclosed for Enquiry item Sl. No.60 CONE. 4-M-20B-09-24615</i> |
| <i>ii) The Due date for submission of TENDER has been extended from 16.05.2015 to <u>21.05.2015</u>.</i> |
| All other terms and conditions as published in the NIT-22285 remain unaltered. |

BHEL commercial terms & conditions with Price Bid formats and all annexure can be downloaded from BHEL web site <http://www.bhel.com> or from the Government tender website <http://tenders.gov.in> (public sector units) Bharat Heavy Electricals Limited) under enquiry reference "2661500123"

Tenders should reach us before 14:00 hours on the due date
Technical bid will be opened at 14:30 hours on the due date
Tenders would be opened in presence of the tenderers who have submitted their offers and who may like to be present.

Yours faithfully,
For Bharat Heavy Electricals Limited

D. CHANDRAMOHAN
Senior Manager / MM / RM
Purchase / CP & SP
BHEL, TIRUCHY - 620 014.

Caution

THIS DRAWING IS OUR SOLE PROPERTY AND SHOULD NOT BE USED IN ANY FORM FOR ANY OTHER PURPOSE WITHOUT THE WRITTEN PERMISSION OF BHARAT HEAVY ELECTRICALS LTD., TIRUCHIRAPALLI - 620 014.

[Handwritten signature]

39-607 A

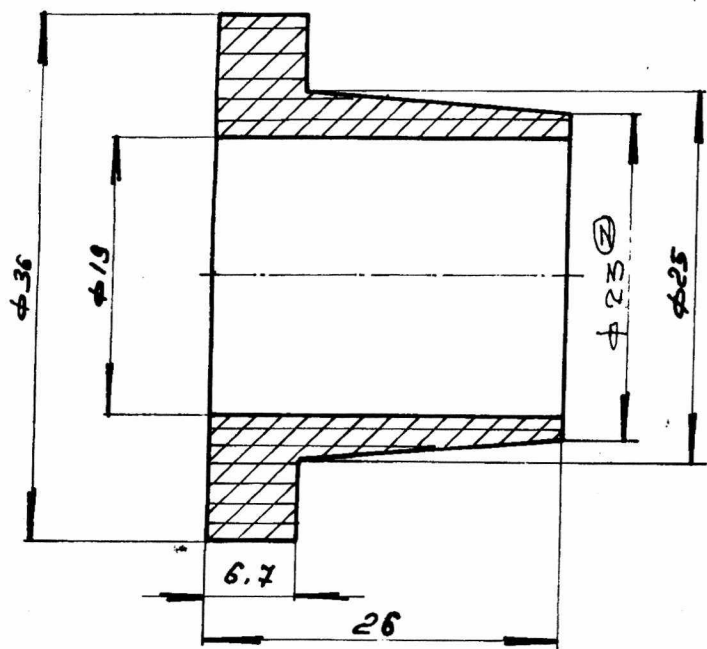

SHORE HARDNESS 70A°

[Handwritten signature]
 D. CHANDRAMOHAN
 Senior Manager / MM / RM
 Purchase / CP & SP
 BHEL, TIRUCHY - 620 014.

| | | | | | | | | | |
|--------------------------|-------------|--|-----------------------------------|-----------------|----------------|--------------------|-------|----------|--|
| | | NEOPRENE RUBBER | | | | | | | |
| No. of pcs. | DESCRIPTION | MATERIAL | STD/BPS | Net wt. (kg) | Gross wt. (kg) | DRAWING No. | | Item No. | |
| REFERENCE: | | | ALTERATIONS EC: 00 EC: 09 | | DATE | SIGN. | Index | | |
| | | | DIMENSION $\phi 23$ WAS $\phi 22$ | | 11 09 02 | <i>[Signature]</i> | ② | | |
| SCALE 2:1 | DRAWN | <i>[Signature]</i> | | | | | | | |
| | CHECKED | <i>[Signature]</i> | | | | | | | |
| | APPROVED | <i>[Signature]</i> | | | | | | | |
| | DATE | 20-03-92 | | | | | | | |
| MACHINE: VERTICAL BOILER | | TYPE: 4513: 03 | | Total wt. (kg.) | | | | | |
| TITLE CONE | | DRAWING No. 4-M-206-24615⁰⁹ | | REV. | | | | | |
| No. of Sheets : | | Sheet No. | | | | | | | |





BHARAT HEAVY ELECTRICALS LIMITED

(A Government of India Undertaking)
HIGH PRESSURE BOILER PLANT
PURCHASE DEPARTMENT - FOSSIL BOILERS
THIRUCHIRAPALLI - 620014
TAMILNADU (INDIA)

PHONE :2577331
GRAMS : BHARATELEC
FAX NO: 2520719
E-mail: srchandran@bheltry.co.in
Web:

429-002/A

| | | | |
|---|-------------------|---------------------|-------------------------------|
| | Enquiry No | Enquiry Date | Due Date for Quotation |
| | 2661500123 - 46 | 23.04.2015 | 16.05.2015 |
| Please quote Enquiry No, Date and due date in all correspondences. This is only a request for quotation and not an order | | | |

| Item | Description | Unit | Quantity | Delivery Quantity | Schedule Date |
|------|--|------|----------|-------------------|---------------|
| 10 | VENDOR QUALIFYING CRITERIA; Only those vendors who satisfy the following conditions will get qualified to participate in the tender: 1.Minimum One Previous Purchase order copy for supplying of rubber items should be submitted along with offer. 2.Customer contact details like contact person with contact number,email address are to be submitted along with the offer. 3.BHEL reserves the right to verify the credentials furnished by the vendor. In case the information furnished with the offers is found to be false /incorrect, the offer shall be rejected. RUBBER BUSH ID=26MM OD=50MM L=40MM. TECHNICAL SPECIFICATION; MATERIAL : NEOPRENE RUBBER SIZE :ID=26MM OD=50MM L=40MM. MINIMUM SHORE HARDNESS: 80A COMMON NOTE FOR ALL ITEMS: PREFERABLE DELIVERY PERIOD TO BE WITHIN TWO MONTHS FROM THE DATE OF PURCHASE ORDER. | NO | 30.000 | 30.00 | 17.06.15 |
| 20 | RUBBER BUSH ID=20MM OD=43MM L=30MM MATERIAL : NEOPRENE RUBBER SIZE :ID=20MM OD=43MM L=30MM MINIMUM SHORE HARDNESS: 80A | NO | 30.000 | 30.00 | 17.06.15 |
| 30 | RUBBER BUSH ID=30MM OD=68MM L=45MM. MATERIAL : NEOPRENE RUBBER SIZE :ID=30MM OD=68MM L=45MM MINIMUM SHORE HARDNESS: 80A | NO | 150.000 | 150.00 | 17.06.15 |
| 40 | | NO | 60.000 | 60.00 | 17.06.15 |

The offers should reach us 30 minutes before the time of opening of tenders.
The offers will be opened at 14.30 hrs on the due date of tender in the presence of tenderers who have submitted their offer and who may like to be present for the tender opening.Late and delayed offers are liable to be rejected.

Yours faithfully,
For **BHARAT HEAVY ELECTRICALS LIMITED**

D. CHANDRAMOHAN
Senior Manager / MM / RM
Purchase / CP & SP
BHEL, TIRUCHY - 620 014.

[Signature]
MANAGER / PURCHASE
(FOSSIL BOILERS)
Yours faithfully,



BHARAT HEAVY ELECTRICALS LIMITED

(A Government of India Undertaking)
HIGH PRESSURE BOILER PLANT
PURCHASE DEPARTMENT - FOSSIL BOILERS
THIRUCHIRAPALLI - 620014
TAMILNADU (INDIA)

Page
2/2
PHONE :2577331
GRAMS : BHARATELEC
FAX NO: 2520719
E-mail: srchandran@bheltry.co.in
Web:

2661500123 / 23.04.2015

RUBBER BUSH ID=12MM OD=30MM
L=30MM
MATERIAL : NEOPRENE RUBBER
SIZE :ID=12MM OD=30MM L=30MM
MINIMUM SHORE HARDNESS: 80A

| | | | | |
|----|----|---------|--------|----------|
| 50 | NO | 200.000 | 200.00 | 17.06.15 |
|----|----|---------|--------|----------|

O RING ID-29mm, Thickness-3.5mm,
Material: Viton, SHORE HARDNESS 80A

| | | | | |
|----|----|--------|-------|----------|
| 60 | NO | 50.000 | 50.00 | 17.06.15 |
|----|----|--------|-------|----------|

CONE 4-M-20B-09-24615
Cone as per drawing no.4-M-20B-09-24615 for
level indicater,
Heat resisting quality, Temperature 200
deegree centigrade,
Working medium: water/steam.

General Note:

PL. SUBMIT YOUR OFFER ON F.O.R - BHEL, TRICHY (TAMILNADU) BASIS AND IN TWO PART (PART-I: TECHNO-COMMERCIAL BID AND PART-II: PRICE BID) IN A SEPARATE COVERS.

IF THE OFFER IS SUBMITTED IN SIGNLE PART AND THE SAME WILL BE LIABLE FOR REJECTION.

EMAIL OFFERS WILL NOT BE ACCEPTED TO PARTICIPATE IN TENDER.

REQUEST FOR EXTENSION OF TENDER OPENING WILL NOT BE CONSIDERED IF THE REQUISITION REACH US LESS THAN 48 HOURS OF TENDER OPENING

ANNEXURE-III ENCLOSED HEREWITH MUST BE FILLED, SIGNED AND SUBMITTED ALONG WITH YOUR OFFER.

THIS TENDER IS HOSTED IN BHEL WEBSITE VIDE NIT REF. _____ DT. _____ AND ANY CORRIGENDUM MAY PL BE VIEWED IN THE BHEL WEBSITE (HTTP://WWW.BHEL.COM)

ENCLOSURE: ANNEXURE - III & Drawing No. 4-M-20B-09-24615

MSME VENDOR GIDE LINES WILL BE FOLLWDED FOR THIS TENDER

Enclosures:

"LD clause has to be confirmed without fail."

The offers should reach us 30 minutes before the time of opening of tenders. The offers will be opened at 14.30 hrs on the due date of tender in the presence of tenderers who have submitted their offer and who may like to be present for the tender opening.Late and delayed offers are liable to be rejected.

Yours faithfully,
For BHARAT HEAVY ELECTRICALS LIMITED

D. CHANDRAMOHAN
Senior Manager / MM / RM
Purchase / CP & SP
BHEL, TIRUCHY - 620 014.

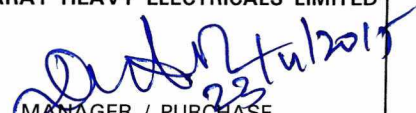

MANAGER / PURCHASE
(FOSSIL BOILERS)
Yours faithfully,

Caution

THIS DRAWING IS OUR SOLE PROPERTY AND SHOULD NOT BE USED IN ANY FORM FOR ANY OTHER PURPOSE WITHOUT THE WRITTEN PERMISSION OF BHARAT HEAVY ELECTRICALS LTD., TIRUCHIRAPALLI - 620 014.

[Handwritten signature]

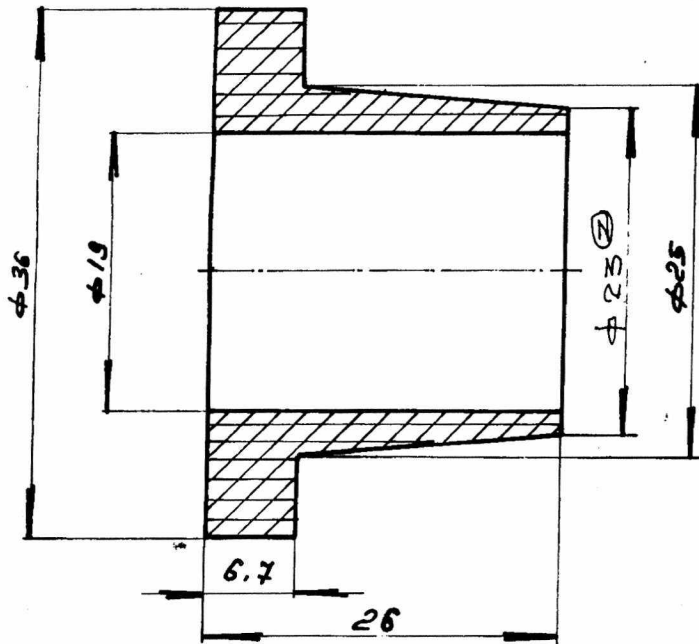
39-607 A



SHORE HARDNESS 70A°

[Handwritten signature]
 20/11/2015
D. CHANDRAMOHAN
 Senior Manager / MM / RM
 Purchase / CP & SP
 BHEL, TIRUCHY - 620 014.

| | | | | | | | |
|-----------------|--------------------------|------------------------|---|--------------|-----------------|--------------------|----------|
| | | NEOPRENE RUBBER | | | | | |
| No. of pcs. | DESCRIPTION | MATERIAL | STD/BPS | Net wt. (kg) | Gross wt. (kg) | DRAWING No. | Item No. |
| REFERENCE: | | | ALTERATIONS | EC: 00 | EC: 09 | DATE | SIGN. |
| | | | DIMENSION $\phi 25$ WAS $\phi 22$ | | 11 09 02 | <i>[Signature]</i> | (2) |
| SCALE 2:1 | DRAWN | <i>[Signature]</i> | | | | | |
| | CHECKED | <i>[Signature]</i> | | | | | |
| | APPROVED | <i>[Signature]</i> | | | | | |
| | DATE | 20-03-92 | | | | | |
| | MACHINE: VERTICAL BOILER | | TYPE: 4513:03 | | Total wt. (kg.) | | |
| | TITLE CONE | | DRAWING No. 4-M-20b-24615 ⁰⁹ | | REV. | | |
| No. of Sheets : | | | Sheet No. | | | | |