



An ISO 9001
Company

Bharat Heavy Electricals Limited

(High Pressure Boiler Plant)

Tiruchirappalli – 620014, TAMIL NADU, INDIA

MATERIALS MANAGEMENT

TITLE CORRIGENDUM for NIT_24026	Phone: +91 431 257 7426 Fax : +91 431 252 0719 Email : tantuway@bheltry.co.in geetha@bheltry.co.in
--	---

Reference Number: Enquiry 1401500054	Enquiry Date: 22.08.2015	Due date for submission of quotation: 20.11.2015
You are requested to quote the Enquiry number date and due date in all your correspondences. This is only a request for quotation and not an order		

CORRIGENDUM

Details of Corrigendum
Include the revised drawing and Tender Opening date extend up to 20.11.2015.
All other terms and conditions as published in the NIT 24026 remain unaltered.

BHEL commercial terms & conditions with Price Bid formats and all annexure can be downloaded from BHEL web site http://www.bhel.com or from the Government tender website http://tenders.gov.in (public sector units) Bharat Heavy Electricals Limited) under enquiry reference "1401500054"	
Tenders should reach us before 14:00 hours on the due date Technical bid will be opened at 14:30 hours on the due date Tenders would be opened in presence of the tenderers who have submitted their offers and who may like to be present.	Yours faithfully, For Bharat Heavy Electricals Limited

3-04-321-02705
DRAWING NO:

ALL DIMENSIONS ARE IN MM
FOR TOLERANCES OF UNTOLERANCED
DIMENSIONS DURING MANUFACTURE
REFER RELEVANT QCP / QP

NOTES:

- 01. DESIGN MANUFACTURE AND INSPECTION AS PER IBR.
- 02. ALL DIMENSIONS SHOWN ARE FINISHED DIMENSIONS.
- 03. NORMALISING AND TEMPERING IS TO BE DONE AFTER HOT FORMING.
- 04. MAXIMUM THICKNESS SHALL NOT EXCEED THE NOMINAL THICKNESS. BHEL APPROVAL.
- 05. FITTING SPECIFICATION : SA234 WP91
- 01. THE FORMED HEMISPHERICAL END COVER SHALL BE SUPPLIED WITH PLAIN END.

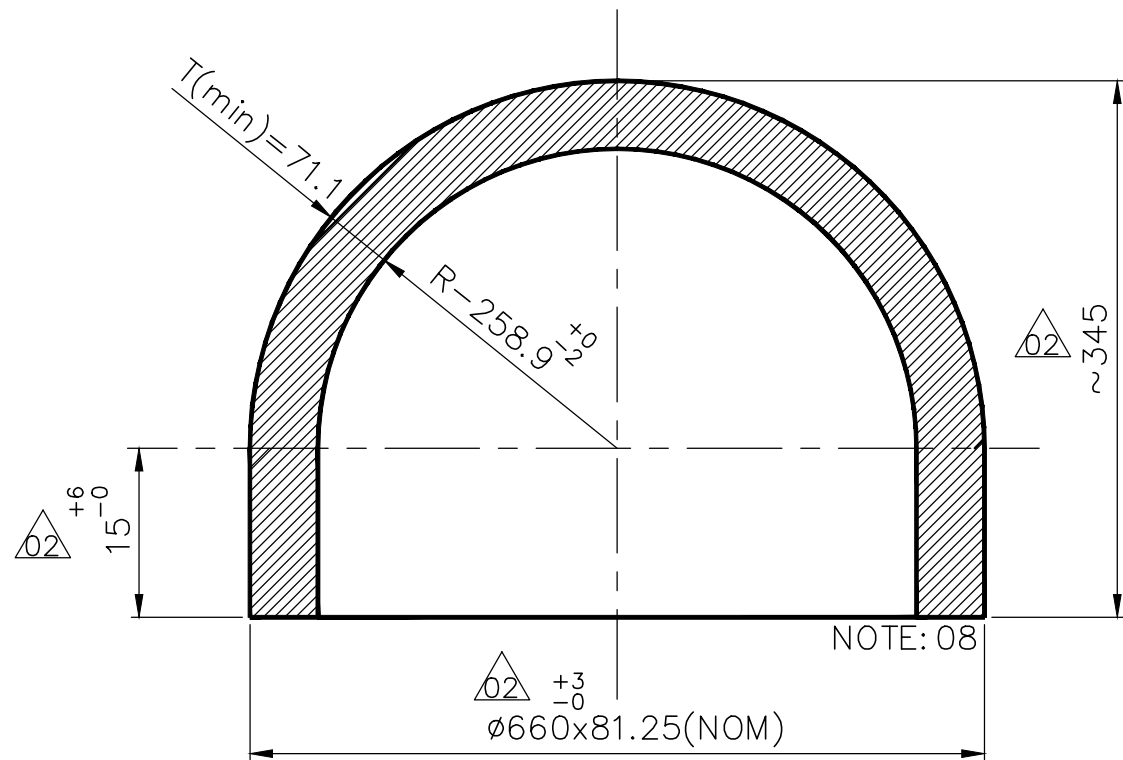

FITTING MATERIAL CODE: 920841930000

VARIANT NUMBER	ITEM NUMBER	DESCRIPTION	STD	DRAWING NUMBER	ITEM NO	MATERIAL CODE	A/C	UNIT	UNIT WEIGHT	CS
					VAR NO	MATERIAL SPECN	D1	QUANTITY		
		HS END COVER				SA 234 WP91	A		330.000	

REV	DATE	ALTERED :GUNA	REV	DATE	ALTERED :K.S.
02	05.11.15	CHD & APPD: V.M.RAO	01	31.07.12	CHD & APPD: RAJA.K.
ZONE	NOTE-2 DELETED AND DRAWING UPDATED.		ZONE	NOTE -7 DELETED.	

CAUTION: The information on this document is the property of BHARAT HEAVY ELECTRICALS LTD. It must not be used directly or indirectly in any way detrimental to the interest of the company.

TYPE OF PRODUCT OR NAME OF CUSTOMER/PROJECT		Bharat Heavy Electricals Ltd UNIT: HIGH PRESSURE BOILER PLANT TIRUCHIRAPALLI - 620014		DRN	K.S	SIGNATURE	DATE	NO. OF VAR	
DEPT	PP	SCALE	NTS	CHD	I.K.S		04.02.10		
CODE	121			APPD	I.K.S		04.02.10		
TITLE	HEMISPHERICAL END COVER RAW FORMING D660x81.25(NOM)			WEIGHT (Kg)	330.000	REF TO ASSY / OLD DWG	F-31	ITEM NO	No OF ITEMS
CARD CODE	U 01	DRAWING NO :		3-04-321-02705		REV	02		

3-04-323-02706
DRAWING NO:

ALL DIMENSIONS ARE IN MM
FOR TOLERANCES OF UNTOLERANCED
DIMENSIONS DURING MANUFACTURE
REFER RELEVANT QCP / QP

NOTES:

- 01. DESIGN MANUFACTURE AND INSPECTION AS PER IBR.
- 02. ALL DIMENSIONS SHOWN ARE FINISHED DIMENSIONS.
- 04. NORMALISING AND TEMPERING IS TO BE DONE AFTER HOT FORMING.
- 05. MAXIMUM THICKNESS SHALL NOT EXCEED THE NOMINAL THICKNESS.
- 06. FITTING SPECIFICATION : SA234 WP91
- 01. THE FORMED HEMISPHERICAL END COVER SHALL BE SUPPLIED WITH PLAIN END.

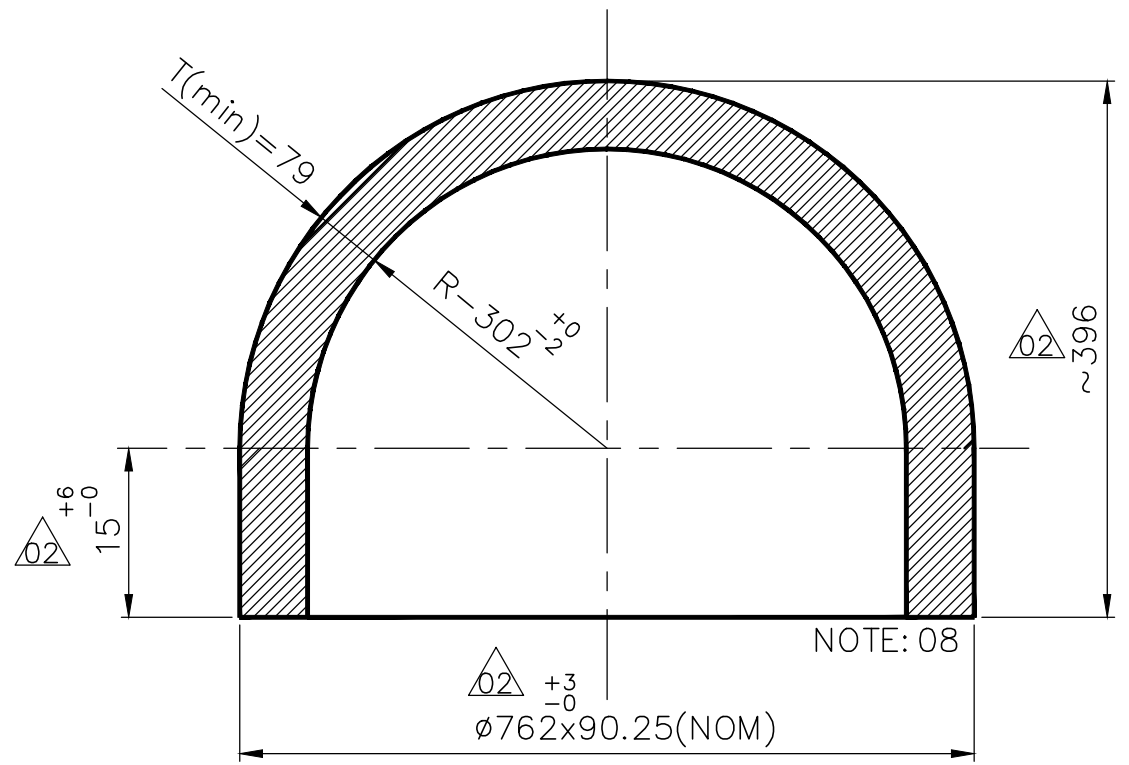

FITTING MATERIAL CODE: 920841940000

VARIANT NUMBER	ITEM NUMBER	DESCRIPTION	STD	DRAWING NUMBER	ITEM NO	MATERIAL CODE	A/C	UNIT	UNIT WEIGHT	CS
					VAR NO	MATERIAL SPECN	D1	QUANTITY		
		HS END COVER				SA 234 WP.91	A		410.000	

REV	DATE	ALTERED :GUNA	REV	DATE	ALTERED :K.S.
02	05.11.15	CHD & APPD: V.M.RAO	01	31.07.12	CHD & APPD: RAJA.K.
ZONE	NOTE-2 DELETED AND DRAWING UPDATED.		ZONE	NOTE -7 DELETED.	

CAUTION: The information on this document is the property of BHARAT HEAVY ELECTRICALS LTD. It must not be used directly or indirectly in any way detrimental to the interest of the company.

TYPE OF PRODUCT OR NAME OF CUSTOMER/PROJECT		Bharat Heavy Electricals Ltd UNIT: HIGH PRESSURE BOILER PLANT TIRUCHIRAPALLI - 620014		DRN	K.S	SIGNATURE	DATE	NO. OF VAR
DEPT	PP	SCALE	WEIGHT (Kg)	REF TO ASSY / OLD DWG	ITEM NO		REV	
CODE	121			NTS	410.000	F-33		
TITLE			CARD CODE	DRAWING NO :		REV		
HEMISPHERICAL END COVER RAW FORMING D762X90.25(NOM)			U 01	3-04-323-02706		02		