



BHARAT HEAVY ELECTRICALS LIMITED

(A Government of India Undertaking)
HIGH PRESSURE BOILER PLANT
PURCHASE DEPARTMENT - FOSSIL BOILERS
THIRUCHIRAPALLI - 620014
TAMILNADU (INDIA)

PHONE :2577629
GRAMS : BHARATELEC
FAX NO: 2520719
E-mail: srchandran@bheltry.co.in
Web:

429-002/A

	Enquiry No	Enquiry Date	Due Date for Quotation
	2661400593	28.08.2014	24.09.2014
Please quote Enquiry No, Date and due date in all correspondences. This is only a request for quotation and not an order			

Item	Description	Unit	Quantity	Delivery Quantity	Schedule Date
10	7504B0400100 GUIDE BAR AS PER DRG.NO. 2M-04B-04-2057 VENDOR QUALIFYING CRITERIA Only those vendors who satisfy the following conditions will get qualified to participate in the tender: 1. Vendor should have minimum 3 years of experience in this field. 2. Previous PO details for supplying similar kind of itemsto BHEL and / or any-other Organisation should be submitted along with offer. Otherwise offer will be rejected. 3. Company profile details has to be provided along with offer. 4. BHEL reserves the right to visit the vendor's works for verifying the manufacturing facilities and any other credential furnished by the vendor. In case the information furnished with the offers found to be false /incorrect, the offer shall be rejected.	NO	6.000	6.00	31.12.14
20	7504B0501200 ARRESTING SCREW AS PER DRG.NO. 3M-04B-05-1679 NOTE: SL.NO. 20 TO 60 ARE MATING COMPONENTS. HENCE THESE ITEMS SHOULD BE PROCURED FROM SINGLE SOURCE ONLY.	NO	10.000	10.00	31.12.14
30	7504B0501300 NUT AS PER DRG NO.4M-4B-05-2973	NO	15.000	15.00	31.12.14
40	7504B0501500 NUT AS PER DRG.NO. 4M-04B-05-3994, SL.NO.1 (L = 96 MM)	NO	15.000	15.00	31.12.14
50	7504B0501600 NUT AS PER DRG.NO. 4M-04B-05-3994, SL.NO.2 (L = 102.5 MM)	NO	15.000	15.00	31.12.14
60	7504B0501700 NUT AS PER DRG.NO.4M-04B-05-05627	NO	15.000	15.00	31.12.14

The offers should reach us 30 minutes before the time of opening of tenders.
The offers will be opened at 14.30 hrs on the due date of tender in the presence of tenderers who have submitted their offer and who may like to be present for the tender opening.Late and delayed offers are liable to be rejected.

Yours faithfully,
For **BHARAT HEAVY ELECTRICALS LIMITED**

MANAGER / PURCHASE
(FOSSIL BOILERS)
Yours faithfully,



BHARAT HEAVY ELECTRICALS LIMITED

(A Government of India Undertaking)
HIGH PRESSURE BOILER PLANT
PURCHASE DEPARTMENT - FOSSIL BOILERS
THIRUCHIRAPALLI - 620014
TAMILNADU (INDIA)

Page
2/3
PHONE :2577629
GRAMS : BHARATELEC
FAX NO: 2520719
E-mail: srchandran@bheltry.co.in
Web:

2661400593 / 28.08.2014

70	7504B0501100 CYLINDRICAL CAM AS PER DRG.NO.3M-04B-03-2237	NO	15.000	15.00	31.12.14
80	7504B0502800 SPUR GEAR AS PER DRG NO 3 M 04B 05 13220 NOTE: SL.NO. 80 AND 90 ARE MATING COMPONENTS. HENCE THESE ITEMS SHOULD BE PROCURED FROM SINGLE SOURCE ONLY.	NO	15.000	15.00	31.12.14
90	7504B0502700 SPUR GEAR AS PER DRG NO 4 M 04B 05 24058	NO	15.000	15.00	31.12.14
100	7504B1702200 PINION SHAFT AS PER DRG.NO. 3M-04B-17-12320-02 NOTE: SL.NO. 100 AND 110 ARE MATING COMPONENTS. HENCE THESE ITEMS SHOULD BE PROCURED FROM SINGLE SOURCE ONLY.	NO	6.000	6.00	31.12.14
110	7504B1705400 RACK SEGMENT AS PER DRG: 3M-04B-17-13072-01	NO	20.000	20.00	31.12.14
120	7504B1703900 SPUR GEAR AS PER DRG NO: 4M 04B 17 24416 NOTE: SL.NO. 120 AND 130 ARE MATING COMPONENTS. HENCE THESE ITEMS SHOULD BE PROCURED FROM SINGLE SOURCE ONLY.	NO	10.000	10.00	31.12.14
130	7504B1703800 PINION AS PER DRG NO: 4M 04B 17 24420	NO	10.000	10.00	31.12.14
140	7504B1700600 SPUR GEAR AS PER DRG. NO. 3M-04B-17-9097 NOTE: SL.NO. 140 AND 150 ARE MATING COMPONENTS. HENCE THESE ITEMS SHOULD BE PROCURED FROM SINGLE SOURCE ONLY.	NO	10.000	10.00	31.12.14
150	7504B1701800 SPUR GEAR AS PER DRG. NO. 3M-04B-17-9096-01	NO	10.000	10.00	31.12.14
160	7504B0601600 SHAFT AS PER DRG.NO.3M-04B-06-8439-01	NO	10.000	10.00	31.12.14
170	7504B0500800	NO	5.000	5.00	31.12.14

The offers should reach us 30 minutes before the time of opening of tenders.
The offers will be opened at 14.30 hrs on the due date of tender in the presence of
tenderers who have submitted their offer and who may like to be present for the tender
opening.Late and delayed offers are liable to be rejected.

Yours faithfully,
For **BHARAT HEAVY ELECTRICALS LIMITED**

MANAGER / PURCHASE
(FOSSIL BOILERS)
Yours faithfully,



BHARAT HEAVY ELECTRICALS LIMITED

(A Government of India Undertaking)
HIGH PRESSURE BOILER PLANT
PURCHASE DEPARTMENT - FOSSIL BOILERS
THIRUCHIRAPALLI - 620014
TAMILNADU (INDIA)

Page
3/3

PHONE :2577629
GRAMS : BHARATELEC
FAX NO: 2520719
E-mail: srchandran@bheltry.co.in
Web:

2661400593 / 28.08.2014

WORM SHAFT AS PER
DRG.NO.3M-04B-05-01492-01
NOTE: SL.NO. 170 AND 180 ARE MATING
COMPONENTS. HENCE THESE ITEMS SHOULD
BE PROCURED FROM SINGLE SOURCE ONLY.

180	7504B0500900 WORM WHEEL AS PER DRG.NO.3M-04B-05-01494-01	NO	5.000	5.00	31.12.14
190	7504B0601800 AUTOMAIC TRIPPING DOG AS PER DRG NO:4M 04B 06 22336-01	NO	30.000	30.00	31.12.14
200	7504B0502500 LOCKING PIN AS PER DRG.NO. 4M-04B-03/05/06-02583-01	NO	30.000	30.00	31.12.14

General Note:

GENERAL NOTE:

Enclosures:

"LD clause has to be confirmed without fail."

"Payment to vendors will be made only thro E-Payment mode"

The offers should reach us 30 minutes before the time of opening of tenders.
The offers will be opened at 14.30 hrs on the due date of tender in the presence of
tenderers who have submitted their offer and who may like to be present for the tender
opening.Late and delayed offers are liable to be rejected.

Yours faithfully,
For **BHARAT HEAVY ELECTRICALS LIMITED**

MANAGER / PURCHASE
(FOSSIL BOILERS)
Yours faithfully,

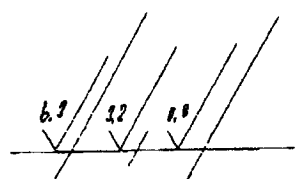

+70 HB	-0.046
	-0.000
10 D9	+0.040
	+0.076

SECTION-AA

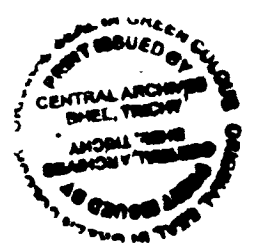
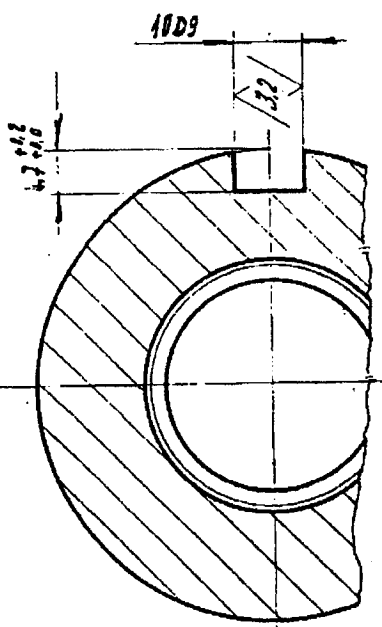
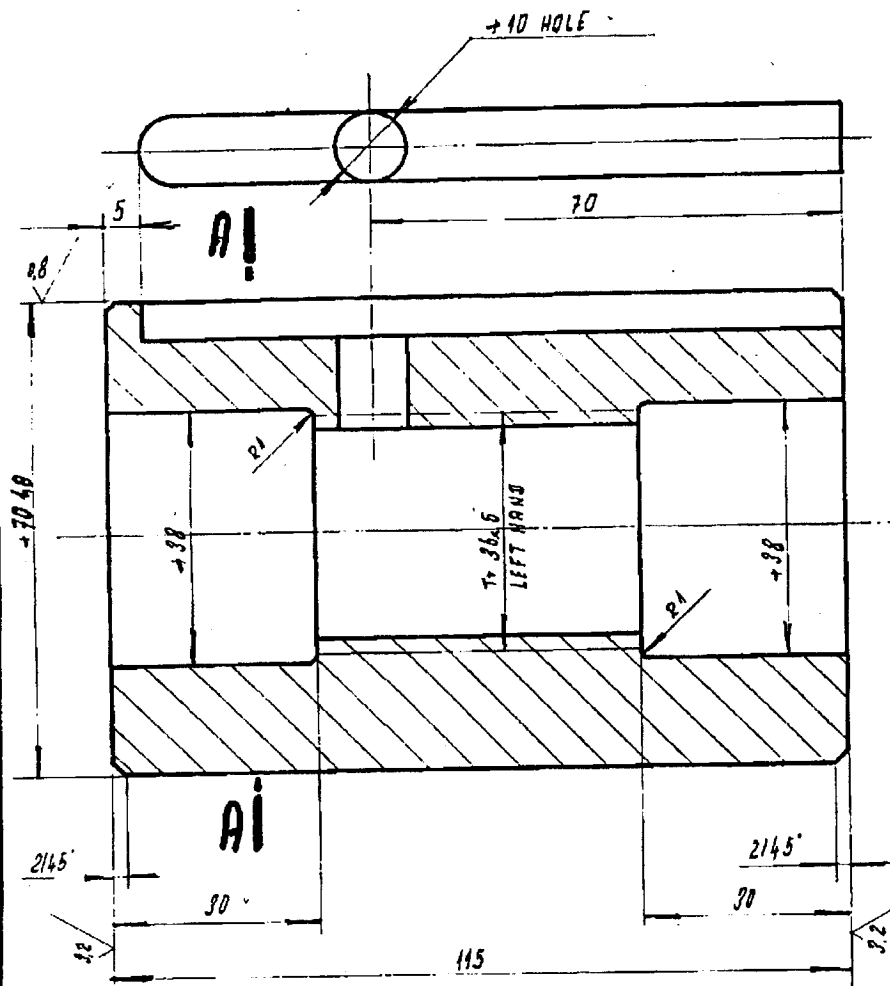

FOR MATING SCREW REFER DRG 3-M-046-1679

NO. OF PIECES	DESCRIPTION	SEMI PRODUCT	FINAL MATERIAL	INITIAL MATERIAL	SCRAP SORT	NET WT	GROSS WT	DRAWING NO.	ITEM NO.
			PCU 507 15:28			3.01		3-M-046-0414	4
REMARKS						TOTAL NET WT (kg)		CC 24	EC 05
SCALE	DRAWN	REFERENCE		ALTERATIONS	DATE	SIGNATURE	ALTERATION INDEX		
1:1	Handwritten signatures								
	CHECKED								
	APPROVED								
	STDS. OFFICER								
	DATE	22.2.69							
MACHINE: RADIAL DRILLING			TYPE: VR-104 A & VR104A			INV. NO.			
TITLE: NUT (COLUMN CLAMPING) 513-3941			DRAWING NO: 4-M-046-2973			05			
			NO. OF SHEETS			SHEET NO:			

3.2/1.6/

SL.No.	L	REMARKS	WT
1	96	-	2.36
② 2	102.5	LOC.No. 4667-1748	2.51

10 D9	+ 0.076
	+ 0.040
φ 38 H8	+ 0.039
	+ 0.000
φ 70 h8	- 0.000
	- 0.046

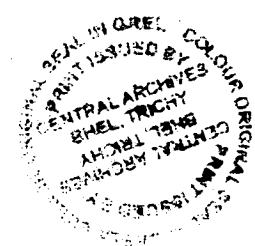
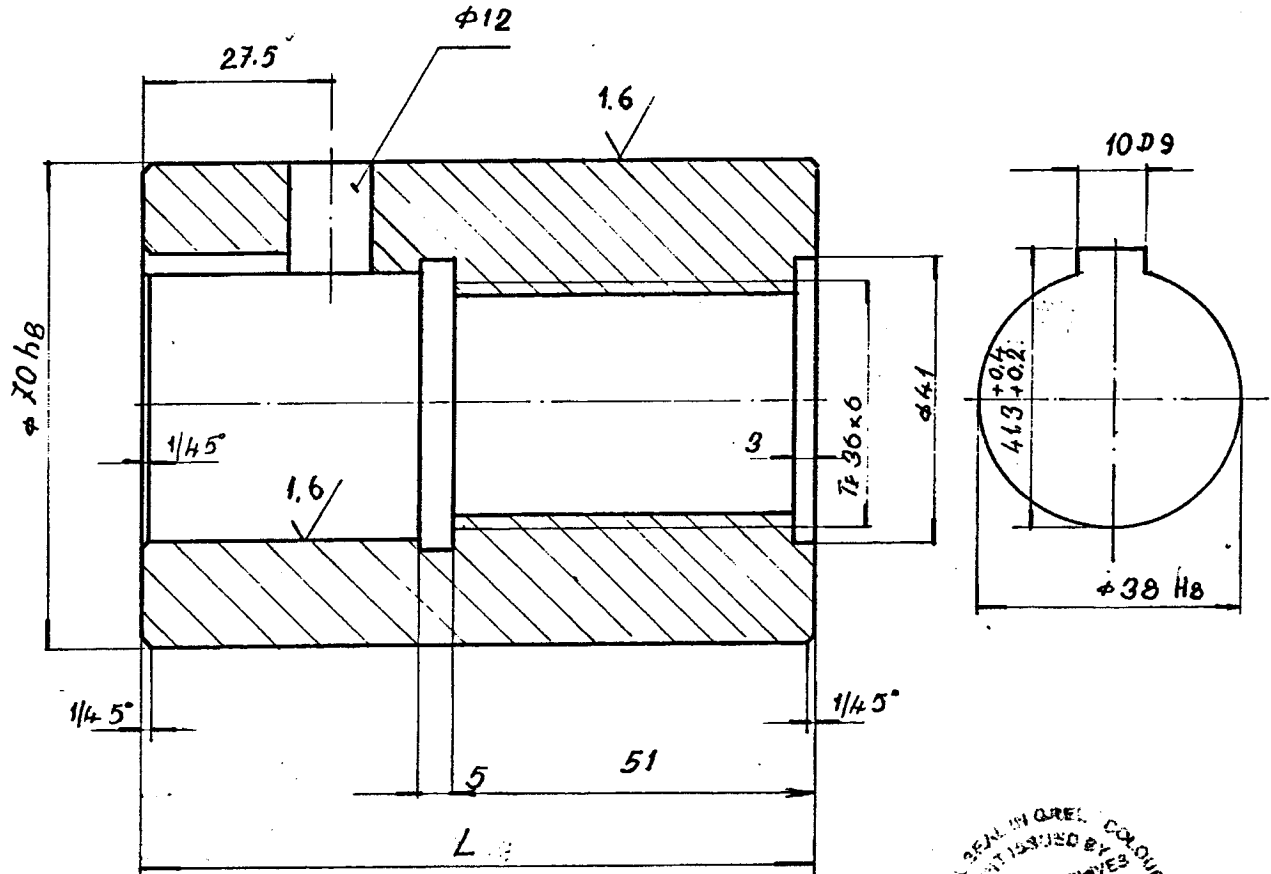

FOR MATING SCREW REFER DRG.NO: 3-M-046-1679

FOR MODIFIED DRG. REFER DRG. NO: 4-M-046-5627

170
40

NO. OF PIECES	DESCRIPTION	SEMI PRODUCT	FINAL MATERIAL	INITIAL MATERIAL	SCRAP SORT	NET WT	GROSS WT	DRAWING NO.	ITEM NO.
			PCU 317 18:28					1-M-046-0414	5
REMARKS			TOTAL NET wt (kg) CC-24 EC-05						
SCALE	DRAWN	CHECKED	APPROVED	STDS. OFFICER	DATE	ALTERATIONS	DATE	SIGNATURE	ALTERATION INDEX
1:1			<i>Randhasamy</i>	<i>DP Salo</i>	28.3.69	TAB. DCN REF 6/9/94		<i>R. Ramraj</i>	②
						ADDED 47			
MACHINE: RADIAL DRILLING			TYPE: VR-104A		INV. NO.				
TITLE: NUT Tr. 36x6 (COLUMN CLAMPING)			DRAWING NO: 4-M-046-3994⁰⁵		NO. OF SHEETS SHEET NO:				

CAUTION: THIS DRAWING IS OUR SELF PROPERTY. IT SHOULD NOT BE USED IN ANY FORM FOR ANY PURPOSE WITHOUT THE WRITTEN PERMISSION OF BHARAT HEAVY ELECTRICALS LIMITED TRICHURAPPALLI - 620 014.

ALL DIMENSIONS ARE IN MM

10D9	+0.076	φ70h8	-0.000	3.2//1.6//
	+0.040		-0.046	
		φ38H7	+0.025	
			+0.000	

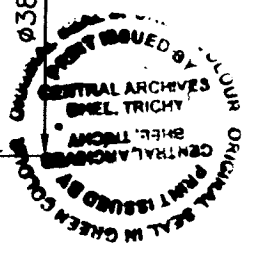
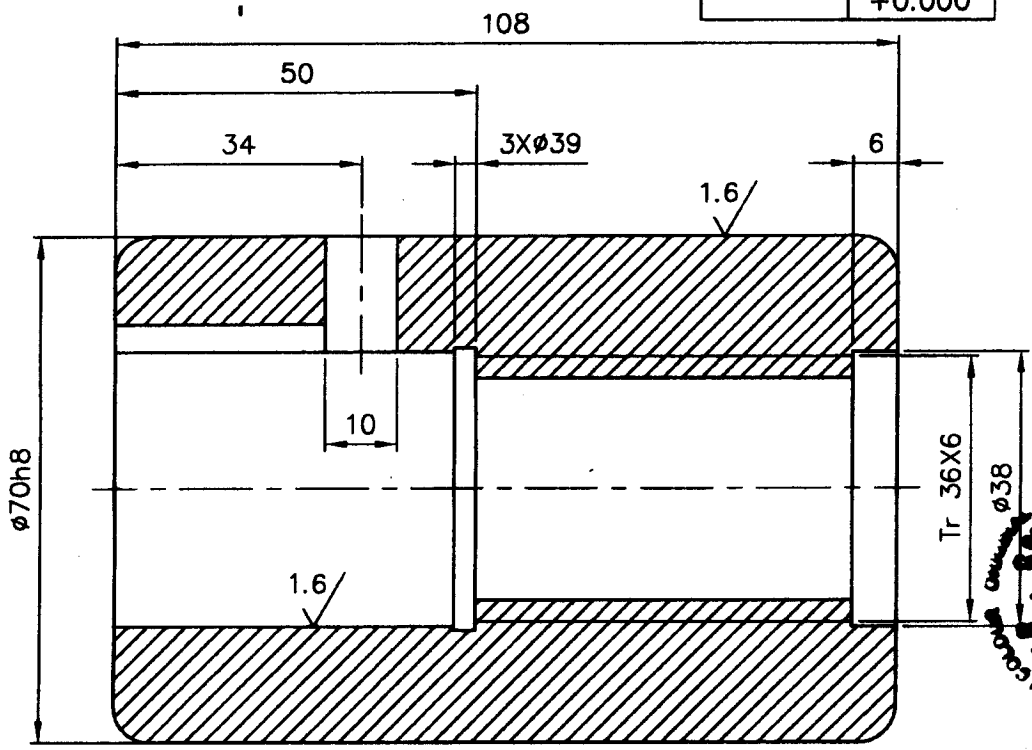

NOTE: -

- 01. FOR MATING SCREW
DRG.No. 3-M-04B05-01679
- 02. FOR ORIGINAL VERSION
DRG.No. 4-M-04B05-03994

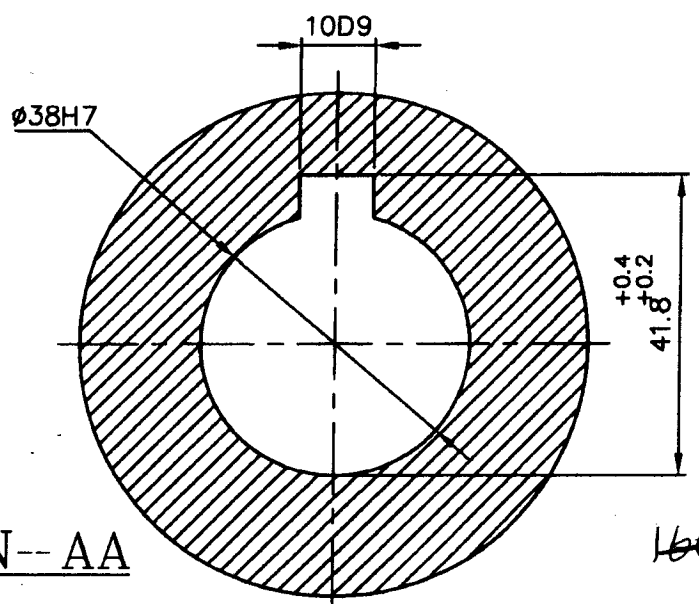

SECTION-- AA

		PCu Sn 7	IS: 28	2.88	1.M.04B05.05627	05
--	--	----------	--------	------	-----------------	----

No. of Pieces	DESCRIPTION	MATERIAL	STANDARD	NET.WT.IN KGS.	DRAWING No.	ITEM No.
	REFERENCE: 22513-35E1		ALTERATIONS:	DCN REF	DATE	SIGN.
SCALE	DRAWN/TCD	R. Narayanan				
1:1	CHECKED	R. Ramamurthy				
	APPROVED					
	DATE	13.05.70/23.11.04				

	MACHINE: RADIAL DRILLING	TYPE: VR 104A
	TITLE: NUT 36X6 (COLUMN CLAMPING ASSY.)	DRAWING No: 05
		4M04B05627
	Sheet No:	No. of Sheets:

Caution
 THIS DRAWING IS OUR SOLE PROPERTY AND
 IS NOT TO BE REPRODUCED OR COPIED IN
 ANY FORM OR BY ANY MEANS WITHOUT THE
 PERMISSION OF BHARAT HEAVY ELECTRICALS
 LTD., TRICHURAPALLE - 689 011.

39-609 A

± 0.018	± 0.000	± 0.011	- 0.000	± 0.018
± 0.002	- 0.020	± 0.004	- 0.020	± 0.002
- 0.018	± 0.021	± 0.007	± 0.021	- 0.018
- 0.031	± 0.000	± 0.007	± 0.000	- 0.031

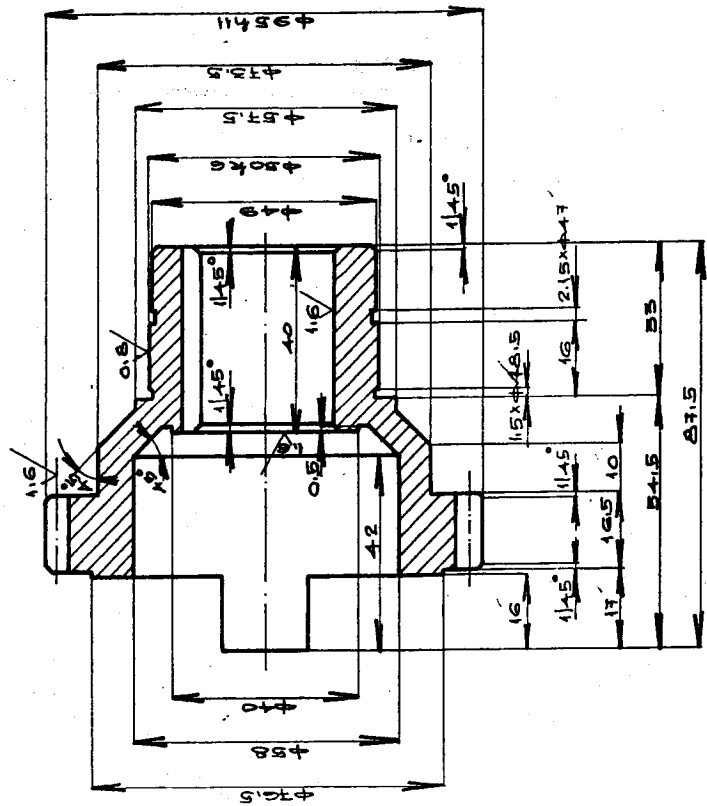
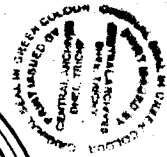
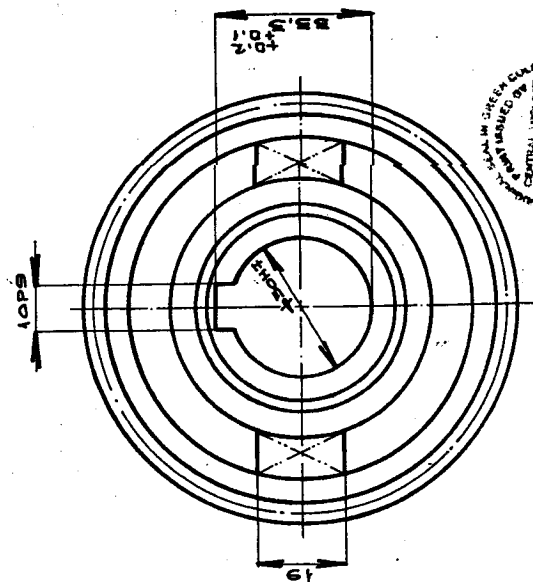

CASE HARDENED TO HRC 61 ± 1
 CASE DEPTH 0.8MM.
 THIS DRWG. ONLY FOR M/C. LOC. NO: 4662-0056.

NO. OF TEETH. 35
 MODULE. 2.5
 PRESSURE ANGLE. 20°
 CORRECTION FACTOR. 1.015
 WIDTH ACROSS 5 TEETH. 35.29
 QUALITY & TOL. ZONE. 9C DIN-3967
 MATING GEAR NO. OF TEETH. 70
 MATING GEAR DRWG. NO. 4-M-04B-2403B.
 CENTRE DISTANCE. 154.25

13M130169	13:4432	0-M-04B-0985	9
DESCRIPTION	MATERIAL	STD/RPS	DATE
ALTERATIONS			
DRAWN	CHECKED	APPROVED	DATE
1:1			18.05.1995
MACHINE: RADIAL DRILLING			
TYPE: VR 10			
DRAWING No.			
Total wt. (kg.)			

SPUR GEAR 35T ± 0.05
 (HEAD STOCK ASSY. SHAFT-IT)

Sheet No.

08

Caution
THIS DRAWING IS OUR SOLE PROPERTY AND SHOULD NOT BE USED IN ANY FORM FOR ANY OTHER PURPOSE WITHOUT THE WRITTEN PERMISSION OF BHARAT HEAVY ELECTRICALS LTD., TIRUCHIRAPALLI - 620 014.

$\phi 177 \text{ H11}$	-0.008	$\phi 30 \text{ H7}$	$+0.021$
	-0.050		$+0.000$
		10 P9	-0.015
			-0.051

32/16/08

39-607 A

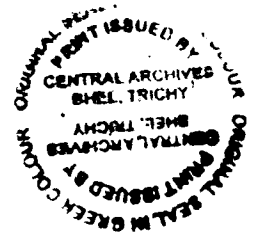
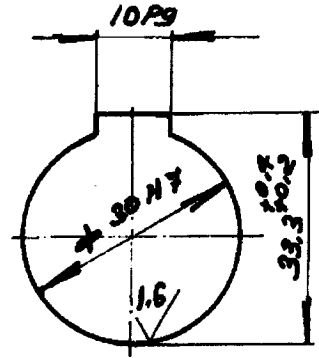
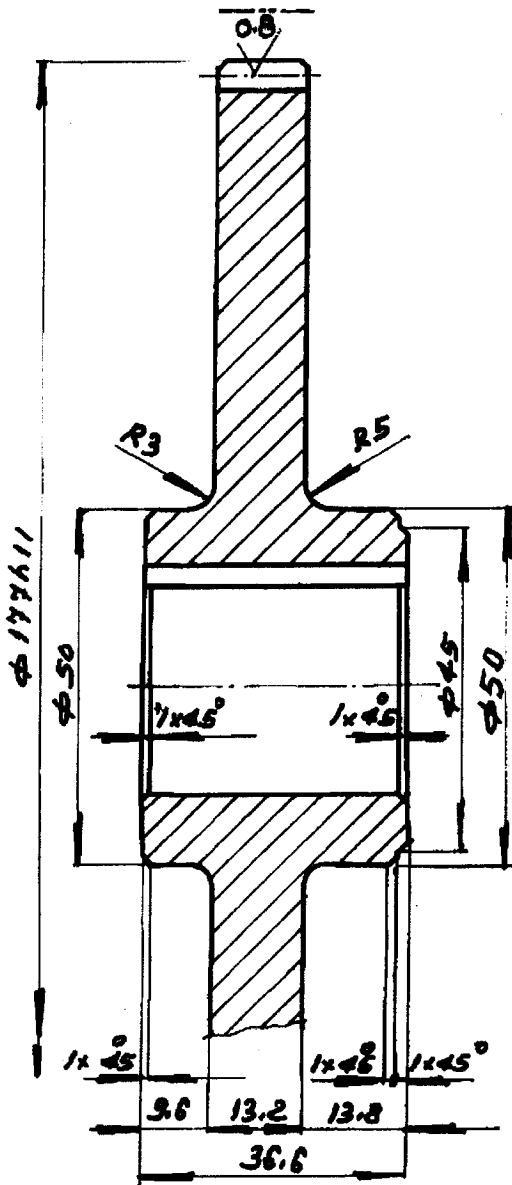

NO. OF TEETH	70
MODULE	2.5
PRESSURE ANGLE	20°
CORRECTION FACTOR	-0.4
WIDTH AC 9 TEETH	64.499
QUAL. AND TOL. ZONE	9C DM 095V
MATING GEAR NO. OF TEETH	35
MATING GEAR DRG NO	3-M-04B-13220
CENTRE DISTANCE	131.25

CASE HARDEN TO HRC 62^{±2}
CASE DEPTH - 0.18MM

THIS DRG. ONLY FOR MIC. LOC. NO: 4662-0056

$\phi 177 \times 37L$		13N13 C13	13:4432	2.6	0-M-04B-0763	10	
No. of pcs.	DESCRIPTION	MATERIAL	STD/BPS	Net wt. (kg)	Gross wt. (kg)	DRAWING No.	Item No.
REFERENCE:	EC. NO: 05 CC. NO: 08.		ALTERATIONS	DATE	SIGN.	Index	
SCALE	DRAWN	C. K.					
1:1	CHECKED	A. S. L.					
	APPROVED						
	DATE	24.06.90					
MACHINE: RADIAL DRILLING MACHINE		TYPE: VR-10		Total wt. (kg.)		REV.	
TITLE		DRAWING No.					
SPUR GEAR 70T/ $\phi 177$		4-M-04B-24058					
PART NO. 02511 1251 C1 L 31		No. of Sheets :		Sheet No.			
(SHAFT II)							

9

42H6	-0.000	72.8H11	-0.000	3.9/1.6/0.8
12P9	-0.018	40K6	-0.018	$\sqrt[3]{V_t \sqrt{V}}$
	-0.018	45K6	+0.018	
	-0.061	45K6	+0.002	

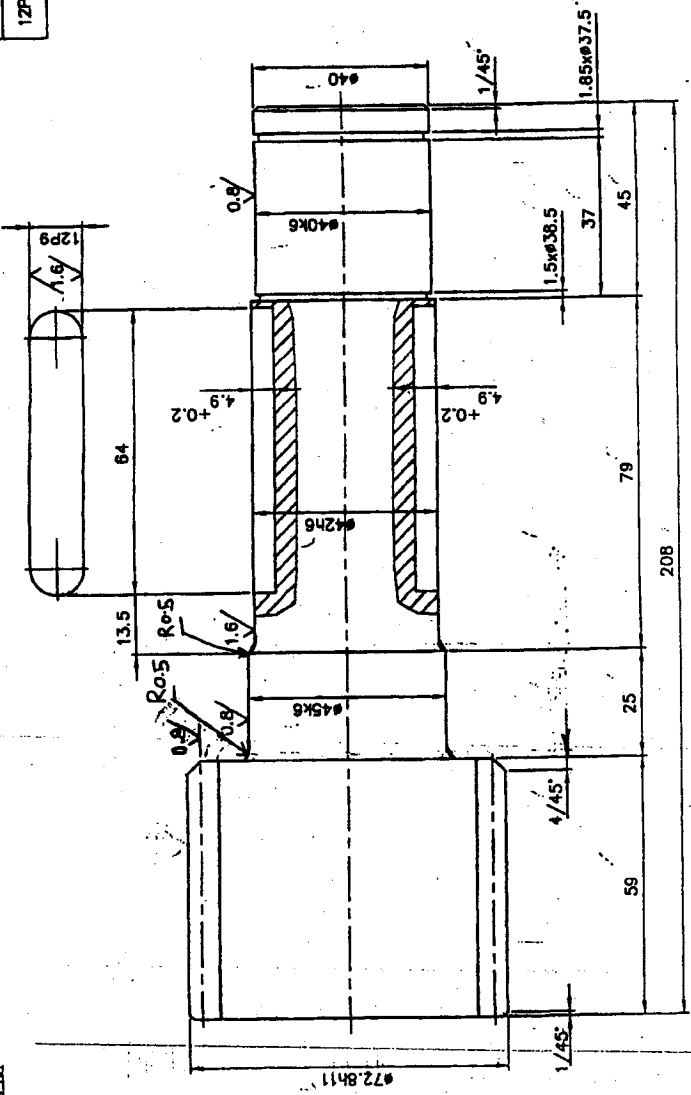

NOTE: HARDEN TO HRc52 ± 5

NO. OF TEETH	12
MODULE	5
PRESSURE ANGLE	20°
WIDTH ACROSS 2 TEETH	24.35
CORRECTION FACTOR	+0.28
Q.L.T. & TOL. ZONE	98 DIN 3967
MATING GEAR NO. OF TEETH	RACK
MATING RACK DRAWING NO.	
CENTRE DISTANCE	

972.8x208L	55C8	IS: 5517	5.06
MATERIAL		STANDARD	ACTIVITY IN KGS
DESCRIPTION		COMPONENT CODE	EQUIPMENT CODE
SCALE	DRAWN	CHECKED	APPROVED
1:1	DATE	09-08-02	
MACHINE: RADIAL DRILLING			
TITLE: PINION SHAFT #72.8x127 (BED LONG TRAVEL GEAR ASSY)			
DRAWING No: 3-M-04B-12320			
REV. 17			
Sheet No: 02			

ALL DIMENSIONS ARE IN MM

CAUTION: THIS DRAWING IS THE SOLE PROPERTY AND SHOULD NOT BE LOANED OR REPRODUCED IN ANY MANNER WITHOUT THE WRITTEN PERMISSION OF BENTON HEAVY ELECTRICAL LIMITED (INDIANPALLI - 620 04)

39-607 A

Caution

THIS DRAWING IS OUR SOLE PROPERTY AND SHOULD NOT BE USED IN ANY FORM FOR ANY OTHER PURPOSE WITHOUT THE WRITTEN PERMISSION OF BHARAT HEAVY ELECTRICALS LTD., TIRUCHIRAPALLI - 620 014.

$\phi 28 H7$	+0.021
	+0.000
$\phi 114 h11$	-0.000
	-0.220

3.2 / 1.6

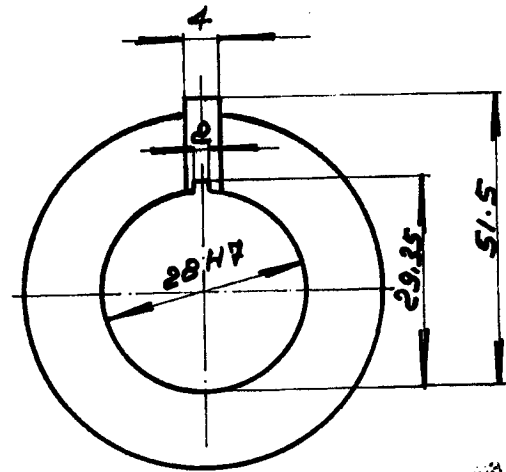
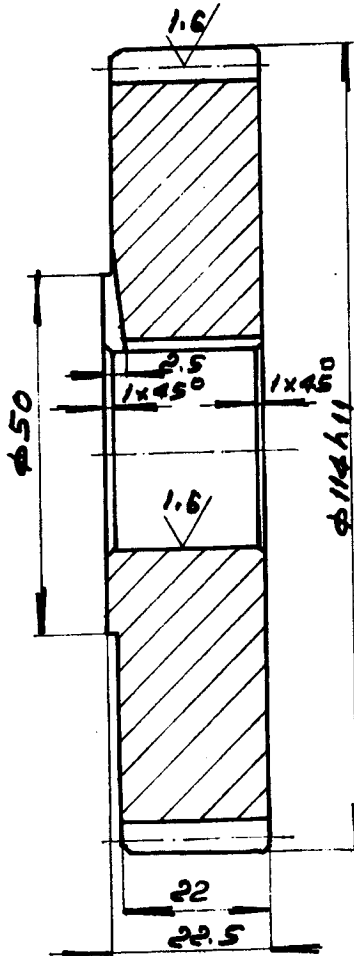

NO. OF TEETH	36
MODULE	3
PR. ANGLE	20°
QUAL. & TOL. ZONE	9c 314 3967
CORRECTION FACTOR	-
WIDTH A/c STEETH	41.366 ^{+0.158} _{-0.210}
MATING GEAR NO. OF TEETH: RACK & PINION	12T
MATING GEAR DRG. NO.	3.M.04B-10847 4.M.04B-24420
CENTRE DISTANCE	-

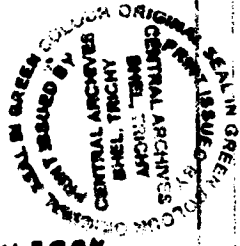

$\phi 114 \times 22.5L$

45C8

IS17283

1.64

No. of p/s	DESCRIPTION	MATERIAL	STD/BPS	Net wt. (kg)	Gross wt. (kg)	DRAWING No.	Item No.
REFERENCE:	ALTERATIONS		DATE	SIGN.	INDEX		
SCALE	DRAWN	Celkany	CHECKED	J. S. A.	APPROVED	DATE	09-05-91
1:1	MACHINE: RADIAL DRILLING		TYPE: DAT 10		REV.		
TITLE		DRAWING No.		17			
SPUR GEAR $\phi 114/367$		4-M-04B-24416					
No. of Sheets:		Sheet No.					

Caution

THIS DRAWING IS OUR SOLE PROPERTY AND SHOULD NOT BE USED IN ANY FORM FOR ANY OTHER PURPOSE WITHOUT THE WRITTEN PERMISSION OF BHARAT HEAVY ELECTRICALS LTD., TIRUCHIRAPALLI - 620 014.

$\phi 18H7$	+0.018	6D9	+0.060
	+0.000		+0.030
$\phi 23H11$	+0.130	$\phi 45.0h11$	-0.000
	+0.000		-0.160

32 16

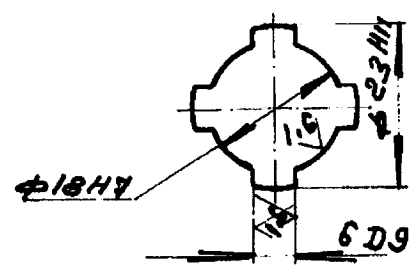
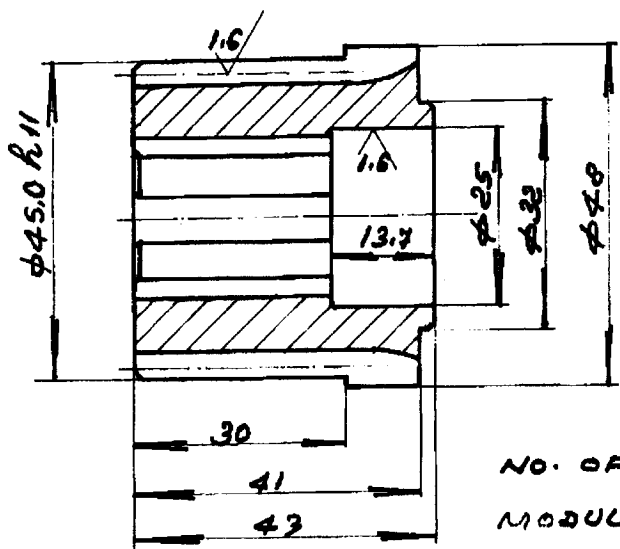
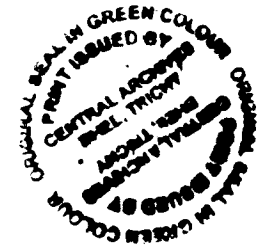

NO. OF TEETH	12
MODULE	3
PR. ANGLE	20°
QUAL. & TOL. ZONE	9c DIN 3967
CORRECTION FACTOR	+0.45
WIDTH A/C 2 TEETH	14.712 ^{-0.127} -0.169
MATING GEAR NO. OF TEETH	36
MATING GEAR DRG. No.	4-M-04B-24416
CENTRE DISTANCE	

CORNERS TO BE CHAMFER 1/45°

210
120

<p>45CB 25:7283 0.43</p>		<p>48X43L</p>	
NO. OF SHEETS	DESCRIPTION	MATERIAL	STANDARD
1/1			
DATE	11-05-98		
<p>MACHINE: RADIAL DRILLING</p>		<p>TYPE: 3RT 10</p>	
<p>TITLE: PINIDN-12T/$\phi 45.5$</p>		<p>DRAWING No.: 4-M-04B-24420¹⁷</p>	
<p>No. of Sheets:</p>		<p>Sheet No.:</p>	

32/15/88

12 F18	+0.016
12 P9	-0.026
Φ41 H7	+0.015
Φ50 H11	+0.060
Φ83 H11	-0.060
	-0.220

APPROVED FOR ISSUANCE BY
CENTRAL ARCHIVES
GENERAL TRICHY
REPRODUCED BY
CENTRAL ARCHIVES
GENERAL TRICHY

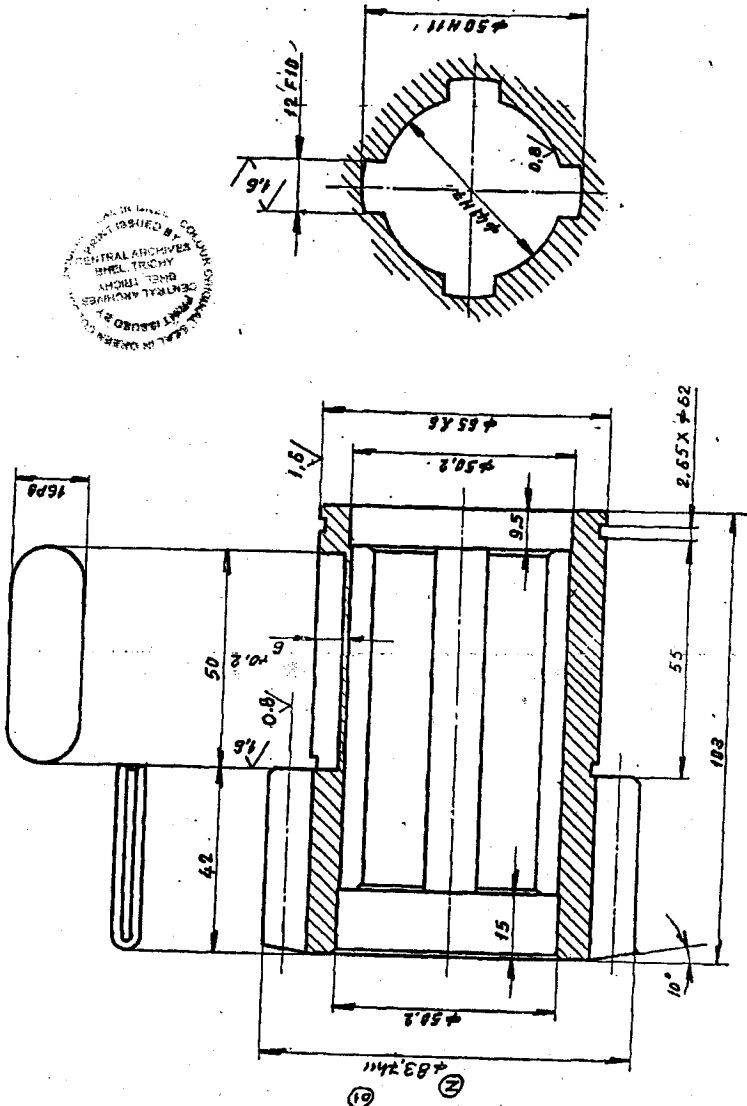

CASE HARDENED TO HRC 52 ± 2
CASE DEPTH 0.8mm

GEAR DATA

- NO OF TEETH : 15
- MODULE : 4.5
- PRESSURE ANGLE : 20°
- WIDTH ACROSS 2 TEETH : 25.33 - 0.278
- CORRECTION FACTOR : + 0.8
- QUALITY & TOL. ZONE : 9 C 3 J N 3 B 6 7
- MATING GEAR NO. OF TEETH : 60
- MATING GEAR Dwg. NO. : 3-M-048B-9086
- CENTRE DISTANCE : 169.75

DATE	30/12/83	DESIGNATION	3-M-048B-9086
SCALE	1:1	DRWING NO.	04-88-1984
CHECKED	[Signature]	DATE	04-08-1984
APPROVED	[Signature]	BY	OFFICER
REVISIONS		DATE	
INITIAL MATERIAL	3-M-15143	INITIAL MATERIAL	3-M-15143
TOTAL NET WT. (KG)	15:0422	TOTAL NET WT. (KG)	15:0422
ALTERNATIONS		ALTERNATIONS	
DATE		DATE	
BY		BY	
REASON		REASON	
TYPE	3-M-048B-9086	TYPE	3-M-048B-9086
NO. OF SHEETS	17	NO. OF SHEETS	17

SPUR GEAR-15T/486.2
(Sheet II)

VH

CAUTION
THIS DRAWING IS OUR SOLE PROPERTY AND
SHOULD NOT BE USED IN ANY FORM FOR ANY
PURPOSE WITHOUT THE WRITTEN PER-
MISSION OF THE DRAWING OFFICE, GENERAL
TRICHY, INDIA.

INDEX NO. 39 - 607

CAUTION

THIS DRAWING IS OUR SOLE PROPERTY AND SHOULD NOT BE USED IN ANY FORM FOR ANY OTHER PURPOSE WITHOUT THE WRITTEN PERMISSION OF
BHARAT HEAVY ELECTRICALS LTD.,
TIRUCHIRAPALLI-14

	3.2 / 0.8
φ 22 h9	-0.080
	-0.052

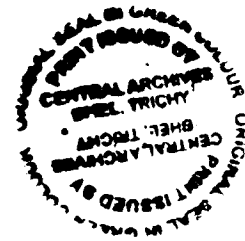
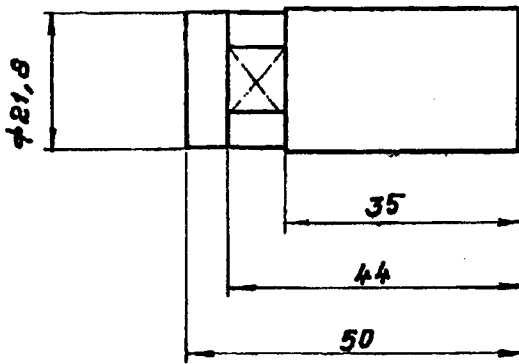
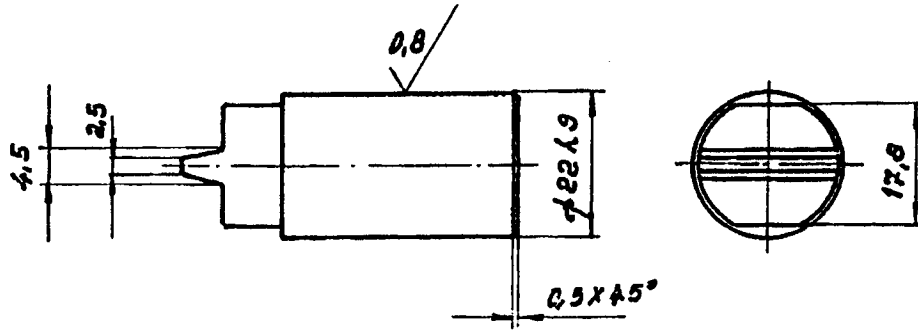

220
180

CASE HARDENING TO HRc 50^{±2}
CASE DEPTH : 0.6 MM

		① 13 Ni 13 Cr 3				0.15			
		IS: 4432							
NO. OF PIECES	DESCRIPTION	SEMI-PRODUCT	FINAL MATERIAL	INITIAL MATERIAL	SCRAP SORT	NET WT(kg)	GROSS WT(kg)	DRAWING NO.	ITEM NO.
REMARKS			TOTAL NET WT (kg)			EC: 06			
SCALE 1:1	DRAWN	<i>[Signature]</i>		REFERENCE	ALTERATIONS		DATE	SIGNATURE	INDEX
	CHECKED	<i>[Signature]</i>			MATERIAL CHANGED		220711	<i>[Signature]</i>	①
	APPROVED	<i>[Signature]</i>							
	STDS. OFFICER								
DATE		24-03-85							
MACHINE		RADIAL DRILLING		TYPE:		JR 10		INV. NO.	
TITLE:		AUTOMATIC TRIPPING JOG		DRAWING NO.		4.M.04B.22336		01	
AUTOMATIC FEEDING MACHINIS)				NO. OF SHEETS		SHEET NO.			

CAPITAL PURCHASE
COMMERCIAL TERMS AND CONDITIONS

1.0 QUOTATIONS

The Bidders shall submit the offer in **TWO INNER ENVELOPES** as indicated below which shall be sealed in one outer envelope.

Envelope I This sealed envelope should contain all the copies of technical bid together with un-priced commercial bid & annexure III. This envelope should be clearly marked "**Part I - Technical and commercial bid**",

Indicating Enquiry No., Due Date and Address & Reference of the Bidder.

Envelope II This sealed envelope should contain **price as per Annexure-IV format**. This envelope should be clearly marked "**Part II - Price bid**", indicating **Enquiry No., Due Date and Address & Reference of the Bidder**.

Both the envelopes (Part I & II) shall be put in one cover (**Envelope III**), duly sealed, superscribing as Part I and Part II of Enquiry No., due date of opening and the address and reference of the Bidder

The above offer should reach this office on or before the due date by 14.00 hours (IST). Late offers will not Be considered.

Tender should not be addressed to any individual's name but only by designation to

**SENIOR MANAGER /PURCHASE/ CP & SP/ MM / MFG
BHARAT HEAVY ELECTRICALS LIMITED
HIGH PRESSURE BOILER PLANT
TIRUCHIRAPALLI - 620 014
TAMIL NADU**

Tenders should be free from **CORRECTION AND ERASURES**, Corrections if any, must be attested. All Amounts shall be indicated both in words as well as in figures. Where there is difference between amount quoted in words and figures, amount quoted in words shall prevail.

Offers should be in **ENGLISH** and accompanied by detailed technical literature, catalogue and detailed dimensional drawings in **ENGLISH** or otherwise, the offers will not be considered.

2.0 OPENING OF TENDERS

The Part I - Technical & commercial bid alone would be opened on the Tender opening date.

The Part II - Price bid of technically suitable Bidders alone would be opened. The Technically Suitable Bidders would be informed about the tender opening date through e-mail.

Clarifications if any required by BHEL for Technical evaluation **would be** sought from Bidders before opening of Part II - price bid

For any queries clarifications the bidders may contact us through our FAX NO. +91 431 2520719 or through e-mail < mmcpmfg1@bheltry.co.in > & < chells@bheltry.co.in>

MM: CP & SP
Annexure For Techno Commercial Bid
 Check List - to be filled and submitted along with Technical Bid

BHEL Commercial Terms and Conditions for Indigenous Supplies	Vendor's Confirmation / Comments
Technical confirmation to BHEL's Specification as called for in BHEL Format shall be furnished. If needed additional sheets shall be used.	
Prices shall be quoted Item wise only as per the model format enclosed	
Prices shall be quoted on " FIRM PRICE " basis only The prices should be only on F.O.R / Despatching station basis with Packing & Forwarding charges if any. Applicable % of ED & Sales Tax, Freight & Insurance, Installation & Commissioning Charges should be clearly Indicated	
Validity of offer shall be for a minimum period of 120 days from the date of Tender opening	
Delivery period from the date of Letter of Intent / Purchase order shall be clearly mentioned in the offer	
Liquidated damages @ '0.5% per week subject to a maximum of 10% of the order value shall be applicable for delay in deliveries For Details Refer Annexure- v	
Following Risk Purchase clause shall be applicable The purchaser at his option will be entitled to terminate the contract and to purchase elsewhere at the risk and cost of the seller either the whole of the goods or any part which the supplier has failed to deliver or dispatch within the time stipulated or if the same were not available, the best and the nearest available substitute therefore The supplier shall be liable for any loss which the Purchaser may sustain by reason of such risk purchases	
Payment term for supply portion: Payment term is 100% direct payment after 45 days from the date of receipt and acceptance of materials For details Refer Annexure- v	
Erection / commissioning: (if applicable only) Erection / commissioning charges if any has been mentioned in the offer or else confirmation that Erection / commissioning shall be done at free of cost is available in the offer,	
The equipment shall be guaranteed for a period of 12 months from the date of commissioning	
Final inspection and acceptance of equipment will be after installation at BHEL, Trichy	
The vendor shall provide necessary drawings, Test Certificates and Operating Maintenance Manuals etc., as called for in the Technical Specification, in the required number of copies at no extra cost	
Any warranty replacement during warranty period shall be supplied free of charge on FOR BHEL, Trichy basis.	
Offers should be submitted only in sealed cover super-scribing clearly the Enquiry reference and due date.	
% of Excise Duty with cess	
% of TAX (CST/VAT)-(INGST with FORM-17 or CST with C-FORM)	
Packing & Forwarding Charges (if any in % only)	
Percentage of Freight& transit insurance charges, if any Freight charges from Dispatching station to BHEL, Tiruchirappalli • Supplier should quote for F.O.R-BHEL Trichy Stores.	
As per Commercial terms and conditions, acceptance for participation in Reverse auction (RA).Yes/No to be indicated	
Name of the person for participating reverse auction	
Land Line Number	
Fax Number	
Mobile Number	
E-mail ID	

NOTE:-

- It is confirmed that all the terms and conditions stipulated in the Enquiry have been fully understood by us and all clarifications & details have been obtained.
- Your offer should be indicating applicable if any P&F Charges, % of ED, Sales Tax -CST or VAT, Service Tax), Freight, Insurance and Installation and Commissioning Charges etc., as per our Price Format
- Your specific acceptance to our Payment terms, LD & Risk Purchase Clause are essential for consideration of your offer. Other wise your offer is liable for rejection.
- No row shall be left blank. Please indicate NA, in case the item is "not applicable"

Annexure For Price Bid

**Bharat Heavy Electricals Limited TIRUCHIRAPPALLI
MODEL PRICE BID FORMAT FOR INDIAN BIDDERS**

CAPITAL PURCHASE
Annexure-IV

Enquiry No. & Date:

Bidder's Offer No. & Date:

Sl No	Description of item	Unit	Quantity	Rate in Rs.	Value in Rs.
	TOTAL VALUE IN RS.				
	Packing & Forwarding charges in % if any				
	Freight & Insurance Charges In % if freight charges are not mentioned it will be considered as FOR-BHEL TRICHY.				
	Excise Duty (indicate in %)				
	A) TNGST — VAT (%)				
	B) CST with C-FORM — (%)				
	C) CST without C-Form — (%)				
	Approximate Net weight of the total consignment				
	Approximate Gross weight of the total consignment				
	Approximate Dimensions of the Consignment				
	The price indicated shall be inclusive of all accessories, spares etc. as given in the scope of supply. Individual item-wise break-up price shall be attached as an annexure to this price bid format.				

Signature & Seal of Vendor

NOTE:

- 1. The price bid should be submitted only as per the above format. No row shall be left blank. Please indicate NA, in case the item is "not applicable"**
- 2. Prices shall be quoted item-wise only as per the above format.**
- 3. If Price quoted is Inclusive of ED, the included ED Value and Base Value shall be indicated item-wise.**

Payment Term (Indigenous)	
If materials are receivable at Stores/Trichy without PBG	Payment term is 100% direct payment after 45 days from the date of receipt and acceptance of materials.
If materials are receivable at Stores/Trichy with PBG	Payment term is 100% direct payment after 45 days from the date of receipt and acceptance of materials and against 10% PBG valid for the warranty period.
Any deviation in the above payment term will attract loading as mentioned below. “Base rate of SBI (as applicable on the date of bid opening. Techno-commercial bid opening in case of two part bids) + 6% shall be considered for loading for the period of relaxation sought by bidders.	

Payment through Bank is not preferred. In case of Payment through Bank is opted by Supplier, BHEL prefers documents submission through bank with copy of LR and door delivery of Goods to Site/Stores with Consignee copy attached. In this case Loading will be 3% on the offered value.

Offers of indigenous Suppliers with payment terms as LC/Advance Payment are liable for rejection.

Liquidated Damages / Penalty -

Liquidated damages shall be 0.5% of the total order value per week or part thereof subject to a maximum of 10% of the total order value.

For staggered delivery schedule, LD shall be 0.5% of the undelivered portion per week of the delay or part thereof subject to a maximum of 10% of the total order value.

Any deviation from the above LD clause, loading will be applied to the extent to which it is not agreed by the bidder (at offered value).

Guarantee / Warranty Period – (if applicable)

Normally No deviation permitted and the deviated offers are liable for rejection.

Ranking-

BHEL will consider the ranking after the loading is applied as referred above wherever deviations are observed.

Performance Bank Guarantee – (if applicable)

Normally No deviation permitted and the deviated offers are liable for rejection.

NOTE:-

1. If the due date of tender opening happens to be a holiday, the tenders will be opened on the next working day.
2. BHEL reserves the right to go for a reverse auction (RA) instead of opening the submitted sealed bid which will be decided after technical evaluation. Information and general terms and conditions covering RA are given in commercial terms and conditions.
3. Corrigendum if any, with respect to this tender will be hosted only in the website <http://www.bhel.com> or <http://tenders.gov.in>. You are requested to visit the website regularly for updates.

Special Provisions for Micro and Small Enterprises (MSE)

1. 20% of the tendered quantity is earmarked for MSE suppliers in this tender.
2. Out of the 20% tendered quantity reserved for MSE suppliers, 4% shall be earmarked for procurement from MSE owned by SC/ST entrepreneurs.
3. In case MSE vendor participating in the tender quotes within the price band of L1+15%, they will be allowed to supply the portion of the requirement subject to acceptance of L1 price by MSE vendor. In case of more than one such MSE, the supply shall be shared proportionately.
4. "MSE suppliers can avail the intended benefits only if they submit along with the offer, attested copies of either EM II certificate having deemed validity (five years from the date of issue of acknowledgement in EM-II) or valid NSIC certificate or EM II certificate along with attested copy of a CA certificate (Format enclosed at Annexure -VII where deemed validity of EM II certificate of five Years has expired) applicable for the relevant financial year (latest audited). Date to be reckoned for determining the deemed validity will be the date of bid opening (Part I in case of two part bid). Non submission of such documents will lead to consideration of their bid at par with other bidders. No benefit shall be applicable for this enquiry if any deficiency in the above required documents are not submitted before price bid opening. If the tender is to be submitted through e-procurement portal, then the above required documents are to be uploaded on the portal. Documents should be notarized or attested by a Gazetted officer."

Certificate by Chartered Accountant on letter head

This is to Certify that MIS
(hereinafter referred to as 'company') having its registered office at
..... is registered under MSMED Act 2006, (Entrepreneur
Memorandum No (Part—II) dtd.
Category:,..... (Micro/Small)). (Copy enclosed).

Further verified from the Books of Accounts that the investment of the company
as per the latest audited financial year as per MSMED Act 2006 is as follows:

For Manufacturing enterprises: Investment in plant and machinery (i.e original cost
excluding land and building and the items specified by the Ministry of Small Scale Industries vide its
notification No.S.O,1722(E) dated October 6. 2006:
Rs... ..Lacs

2. **For Service Enterprises:** Investment in equipment (original cost excluding land and building and
furniture, fittings and other items not directly related to the service rendered Or as may be notified under the
MSMED Act, 2006.
Rs..... Lacs

(Strike off whichever is not applicable)

The above investment of Rs.....Lacs is within permissible limit of
Rs..... Lacs for Micro I 6mall (Strike off which Is not applicable)
Category under MSMED Act 2006.

Or

The company has been graduated from its original category (Micro/ Small) (Strike off which is not
applicable) and the date of graduation of such enterprise from its original category is
(dclimmiyyyy) which is within the period of 3 years from the date of graduation of such
enterprise from its original category as notified vide S.D. No. 3322(E) dated 01.11.2013
published in the gazette notification dated 04.11.2013 by Ministry of MSME.

Date:

(Signature)

Name -

Membership number -

Seal of Chartered Accountant