



BHARAT HEAVY ELECTRICALS LIMITED

(A Government of India Undertaking)
HIGH PRESSURE BOILER PLANT
PURCHASE DEPARTMENT - FOSSIL BOILERS
THIRUCHIRAPALLI - 620014
TAMILNADU (INDIA)

PHONE :2577938
GRAMS : BHARATELEC
FAX NO: 2520719
E-mail: tvenkat@bheltry.co.in
Web:

429-002/A

	Enquiry No	Enquiry Date	Due Date for Quotation
	2661600224 - 46	18.06.2016	13.07.2016
<p>Please quote Enquiry No, Date and due date in all correspondences. This is only a request for quotation and not an order. Bid should be submitted in two parts. 1.Techno-commercial bid (Part-I) and 2.Price bid(Part-II) in a separate sealed cover and both covers must be placed in a third cover and sealed. Our Enquiry No., Enq. date & Enq. Due date must be written on all three covers.</p>			

Item	Description	Unit	Quantity	Delivery Quantity	Schedule Date
10	4218A0300100	NO	30.000	30.00	30.12.16
<p>COVER AS PER DRG NO. 4-M-18A03-26328 COMMON NOTE FOR ITEM 10 TO 90: (1) MATERIALS SHOULD BE CRACK FREE AND MATERIAL WITH CRACKS AT BHEL ,TRICHY WILL NOT BE ACCEPTED. (2) TEST CERTIFICATE FOR MATERIAL CONFIRMITY AS PER DRAWING FROM GOVT. APPROVED LAB / LAB WITH ISO 9001-2008 CERTIFICATION SHALL BE PRODUCED DURING PRE-DESPATCH INSPECTION. (3) MATERIALS SHOULD BE SUPPLIED ALONG WITH ORIGINAL TEST CERTIFICATE. (4) BRICKS SHOULD HAVE IDENTIFICATION MARK LIKE MANUFACTURER COMPANY NAME AND BHEL DRAWING NUMBER(LAST FIVE DIGITS) ON IT. (5) ALL ITEMS HAVE TO BE OFFERED TO BHEL ENGINEER FOR PRE-DESPATCH INSPECTION AT VENDOR'S WORKS. (6) PREFERABLE DELIVERY PERIOD IS TO BE WITHIN 12 WEEKS FROM THE DATE OF PURCHASE ORDER. (7) BEING MEGER QUANTITY AND LESS VALUE,ITEMS MAY BE PROCURED FROM SINGLE SOURCE ON CUMULATIVE L1 BASIS. VENDOR QUALIFYING CRITERIA: Only those vendors who satisfy the following conditions will get qualified to participate in the tender: (1) Only those vendors, who have Supplied refractory items for atleast to one company in the past seven years for which supporting documents like order copies are to be submitted along with offer. (2) The vendor should submit following details which are necessary for qualifying their offer: (a)Name and postal address of the customer / company where refractory items were supplied. (b)Name and designation of the contact person of the customer. (c)Phone no. and Email address of the contact person of the customer.</p>					

The offers should reach us 30 minutes before the time of opening of tenders. The offers will be opened at 14.30 hrs on the due date of tender in the presence of tenderers who have submitted their offer and who may like to be present for the tender opening.Late and delayed offers are liable to be rejected.

Yours faithfully,
For **BHARAT HEAVY ELECTRICALS LIMITED**

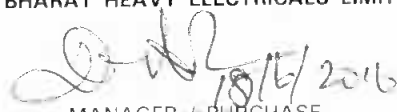
18/6/2016
MANAGER / PURCHASE
(FOSSIL BOILERS)
Yours faithfully,
BHEL, TIRUCHY - 620 014.



BHARAT HEAVY ELECTRICALS LIMITED

(A Government of India Undertaking)
HIGH PRESSURE BOILER PLANT
PURCHASE DEPARTMENT - FOSSIL BOILERS
THIRUCHIRAPALLI - 620014
TAMILNADU (INDIA)

PHONE :2577938
GRAMS : BHARATELEC
FAX NO: 2520719
E-mail: tvenkat@bheltry.co.in
Web:

2661600224 / 18.06.2016

23505

(3) BHEL reserves the right to verify the information provided by vendor. In case the information provided by vendor is found to be false / incorrect, the offer shall be rejected.

20	4218A1300100	NO	8.000	8.00	30.12.16
	BOTTOM FIRE BRICKS AS PER DRG NO. 3-M-18A13-0173				
30	4218A1300200	NO	8.000	8.00	30.12.16
	SIDE FIRE BRICKS AS PER DRG NO. 3-M-18A13-0172				
40	4218A1300300	NO	4.000	4.00	30.12.16
	TOP ARCH FIRE BRICKS AS PER DRG NO. 3-M-18A13-0171				
50	4218A0500200	NO	12.000	12.00	30.12.16
	BOTTOM FIRE BRICK AS PER DRG. NO. 3-M-18A05-13827				
60	4218A0500400	NO	12.000	12.00	30.12.16
	TOP FIRE BRICK AS PER DRG NO. 3-M-18A05-0588				
70	4218A1800100	NO	10.000	10.00	30.12.16
	ARCH BRICK AS PER DRG NO. 4-M-18A18-28436				
80	4218A2200300	NO	100.000	100.00	30.12.16
	CERAMIC BUSH AS PER DRG NO. 4-M-18A22-26024				
90	4218A2200200	NO	100.000	100.00	30.12.16
	CERAMIC WASHER AS PER DRG NO. 4-M-18A22-26218				

General Note:

IMPORTANT NOTE:

(i) THIS ENQUIRY IS FLOATED / PROCESSED ON "CUMULATIVE L1 BASIS"- FROM ITEM NO. 10 TO 90 AS A PACKAGE ONLY.

(ii) YOU SHOULD CONFIRM LD CLAUSE, VALIDITY, PAYMENT TERMS AND DELIVERY PERIOD AS PER BHEL COMMERCIAL TERMS AND CONDITIONS. OTHERWISE YOUR OFFER WILL BE REJECTED.

(iii) 'DOCUMENTS SUBMITTED WITH THE OFFER MUST BE SIGNED AND STAMPED IN EACH PAGE BY AUTHORIZED REPRESENTATIVE OF THE BIDDER'

ENCLOSURES

The offers should reach us 30 minutes before the time of opening of tenders. The offers will be opened at 14.30 hrs on the due date of tender in the presence of tenderers who have submitted their offer and who may like to be present for the tender opening. Late and delayed offers are liable to be rejected.

Yours faithfully,
For **BHARAT HEAVY ELECTRICALS LIMITED**

P. CHANDRAMOHAN
MANAGER / PURCHASE
Purchase / CR & SP / MM / RM
BHEL, TIRUCHY - 620 014



BHARAT HEAVY ELECTRICALS LIMITED

(A Government of India Undertaking)
HIGH PRESSURE BOILER PLANT
PURCHASE DEPARTMENT - FOSSIL BOILERS
THIRUCHIRAPALLI - 620014
TAMILNADU (INDIA)

PHONE :2577938
GRAMS : BHARATELEC
FAX NO: 2520719
E-mail: tvenkat@bheltry.co.in
Web:

2661600224 / 18.06.2016

23505

(i) ANNEXURE - 'A':- COMMERCIAL TERMS AND CONDITIONS MUST BE FILLED AND SUBMITTED ALONG WITH TECHNO COMMERCIAL BID.

(ii) ANNEXURE- 'V': CERTIFICATE BY CHARTERED ACCOUNTANT ON LETTER HEAD.

(iii) DRAWINGS: - 9 NOs

All the tenders may be addressed to the following address:

**The Tender Opening Cell / MM
Room No: 26, Building 24, Ground Floor
Bharat Heavy Electricals Limited
TIRUCHIRAPALLI 620014**

In case personal delivery of the offer, it shall be dropped into the respective box kept in Room No: 26, after duly entering the data in the system.

Offers will be accepted only up to 14.00 Hrs on the due date. Therefore, vendors shall ensure to submit the offers well before this time. All due date extension requirements should be addressed to the respective Purchase mail IDs. All the due date extension requests from vendors will be considered only up to 48 hours before the due date and time.

Vendors are requested to avoid submission of offers through e mail / fax. In case of any unavoidable situation, offers shall be sent through e mail to the following mail ID only tender_cell@bheltry.co.in.

As tenders are being opened by Common Tender Opening Cell, offer covers should be sealed with tenderer's distinctive seal and super scribed with correct Tender No. item of supply and due date of opening.

The offers will be opened at 14.30 hrs on the due date of the tender in the presence of tenderers who have submitted their offer and who may like to be present for the tender opening. Late and delayed offers are liable to be rejected.

The bidder along with its associate/ collaborators/ sub-contractors/ sub-vendors/ consultants/ service providers shall strictly adhere to BHEL fraud prevention policy displayed on BHEL website <http://www.bhel.com> and shall immediately bring to the notice of BHEL management about any fraud or suspected fraud as soon as it comes to their notice.

The supplier shall submit EI/EII forms to BHEL time to time as indicated by the BHEL and in case of inordinate delay in issuing EI/EII forms, then BHEL reserves the right to deduct 5% of the value of the supplied items against which EI/EII forms pending to be issued

Enclosures:

"LD clause has to be confirmed without fail."

The offers should reach us 30 minutes before the time of opening of tenders. The offers will be opened at 14.30 hrs on the due date of tender in the presence of tenderers who have submitted their offer and who may like to be present for the tender opening. Late and delayed offers are liable to be rejected.

Yours faithfully,
For **BHARAT HEAVY ELECTRICALS LIMITED**

MANAGER / PURCHASE
(FOSSIL BOILERS)
Purchase
Yours faithfully, M / RM
BHEL TIRUCHIRAPALLI

CAUTION: THIS DRAWING IS OUR SOLE PROPERTY AND SHOULD NOT BE USED IN ANY FORM FOR ANY PURPOSE WITHOUT THE WRITTEN PERMISSION OF BHARAT HEAVY ELECTRICALS LIMITED TRICHIRAPPALLI - 620 014.

ALL DIMENSIONS ARE IN MM

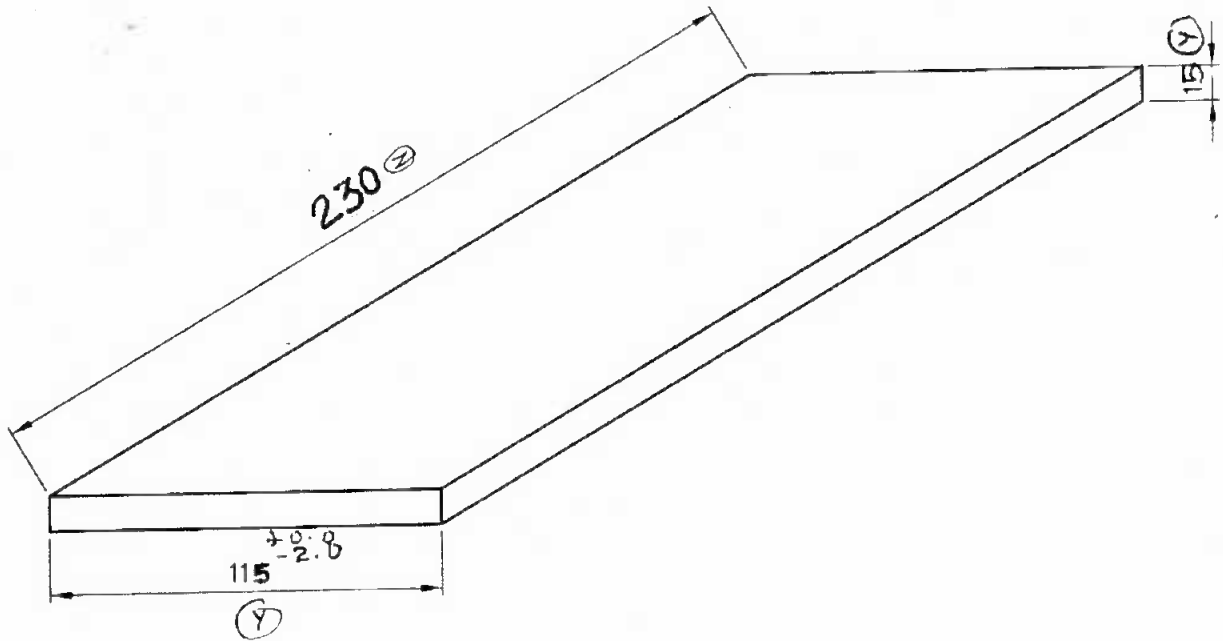

NOTE :- MATERIAL SHOULD BE MANUFACTURED TWIST FREE.

* MATERIAL SILLIMANITE WITH FOLLOWING SPECIFICATIONS.

- Al₂O₃ - 61%.
- SiO₂ - 36.5%.
- Fe₂O₃ - 1.5%.
- Ap - 20%.
- CCS - 400 kg/cm² (MIN) %.
- PCE - 36 (ORTON CONE)

		*							
X									
No. of Pieces	DESCRIPTION			MATERIAL	STANDARD	NET.WT.IN KGS.	DRAWING No.		ITEM No.
REFERENCE:	SKS-200117-97-B				COMPONENT CODE: 00	EQUIPMENT CODE: 03			
SCALE	DRAWN	R. Narayanan		DIMENSIONS 240X115 WAS 230		DCN REF	DATE	SIGN.	INDEX
1:2	CHECKED	R. Ramamurti		DIM 115/15 WAS 110, 10			20/10/91	RLM	Y
	APPROVED			* MATL. WAS SILICON CARBIDE					X
	DATE	14/2.98		IS: 2044					
MACHINE: ROD HEATING FURNACE						TYPE: THERELEK 450 KW			
TITLE: COVER (115X240X15t)						DRAWING No: 03		REV.	
						4-M-18A-26328			
						No. of Sheets		Sheet No	

762

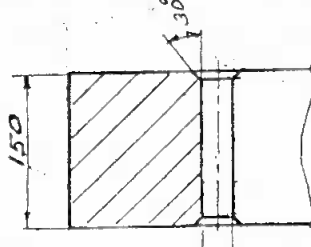
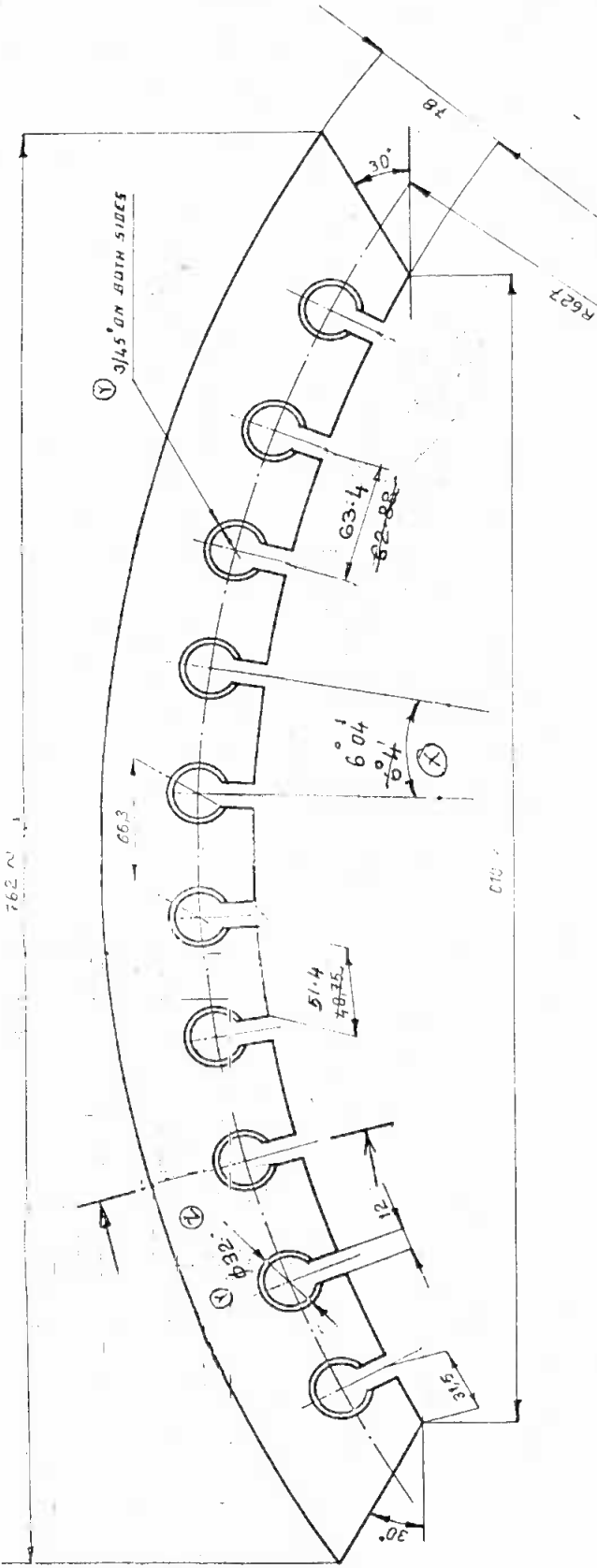

NOTE FOR SUPPLIERS:

1. COIL HOLES IN ALL BRICKS SHOULD BE ALIGNED FOR STRAIGHTNESS SO THAT A SINGLE COIL COULD BE INSERTED THROUGHOUT.

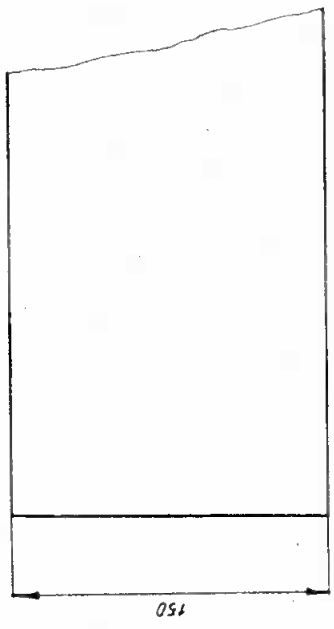

PHYSICAL PROPERTIES

MAX. TEMPERATURE : 1200°C
 P. C. S : 350 Kg/cm²
 APPARENT POROSITY : 24 To 29%

CHEMICAL PROPERTIES

Al₂O₃ : 57 To 60%
 Fe₂O₃ : 2%
 P. C. E. : + 36

8	DESCRIPTION	SEMI PRODUCT	FINAL MATERIAL	INITIAL MATERIAL	SCRAP	NET GROSS WT	DRAWING NO	ITEM NO.
			KYRNITE					
REMARKS		REFERENCE		TOTAL NET WT (KG)		ALTERATIONS		
SCALE	DRAWN	CHECKED	APPROVED	STDB. OFFICER	DATE	SIGNATURE	DATE	ITEM NO.
2:5	<i>Wankar</i>	<i>Wankar</i>	<i>Wankar</i>		15-7-67		6-10-68	34-609-A
NO. OF PIECES		MACHINE		TITLE		ALTERATIONS		
8		UNITED SINGLE CHAMBER FURNACE		METCO - 45 EN		HOLE # 28 WAS # 22 HOLES MODIFIED 17-12-67 SECTION XX APPROVED 18/11/68		
		TOP FIREBRICK		3-M-18A-0588				

CAUTION: THIS DRAWING IS OUR SOLE PROPERTY AND SHOULD NOT BE USED IN ANY FORM FOR ANY PURPOSE WITHOUT THE WRITTEN PERMISSION OF BHARAT HEAVY ELECTRICALS LIMITED TRICHIRAPPALLI - 620 014.

ALL DIMENSIONS ARE IN MM

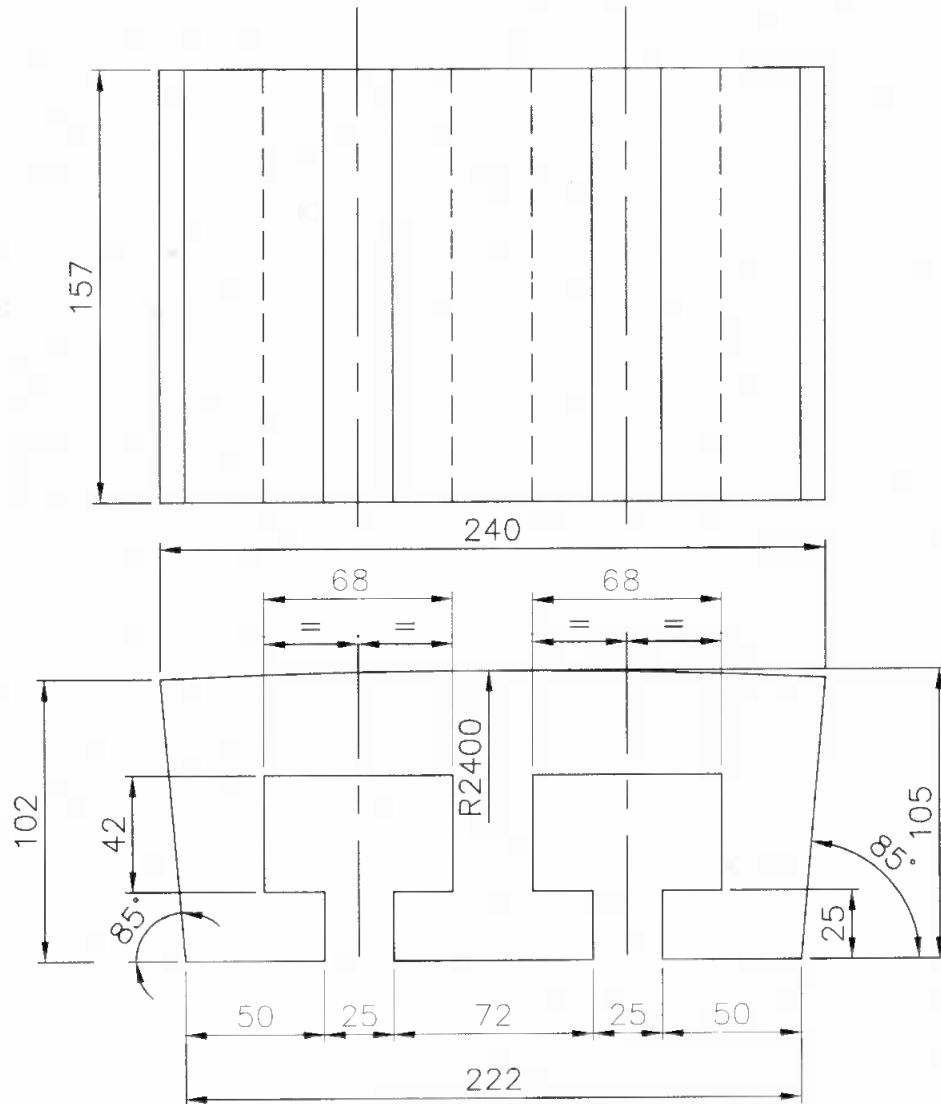

CHEMICAL COMPOSITION

Al₂O₃ : 56-60%, Fe₂O₃ : 1% PCE : +35
 CCS : 350 kgf/cm², App.Porosity : 24 to 29% ,
 Bulk density : 2.3 to 2.5 gm/cc.

No. of Pieces		DESCRIPTION		MATERIAL	STANDARD	NET.WT.IN KGS.	DRAWING No.	ITEM No.
SCALE		DRAWN		T.T.Balakrishnan		ALTERATIONS:		DCN REF
1:2.5		CHECKED		R.Ramamoorthy		DATE		SIGN.
		APPROVED		C.S.Jayasheelan		INDEX		
DATE		10.11.09						
MACHINE: ELE.SINGLE CHAMBER		TITLE:		ARCH BRICK		TYPE: ELECTRO THERME-60KW		REV.
DRAWING No:		4M18A1828436		Sheet No:		No. of Sheets:		

Caution

THIS DRAWING IS OUR SOLE PROPERTY AND SHOULD NOT BE USED IN ANY FORM FOR ANY OTHER PURPOSE WITHOUT THE WRITTEN PERMISSION OF BHARAT HEAVY ELECTRICALS LTD., TIRUCHIRAPALLI - 620 014.

[Handwritten signature]

39-607 A

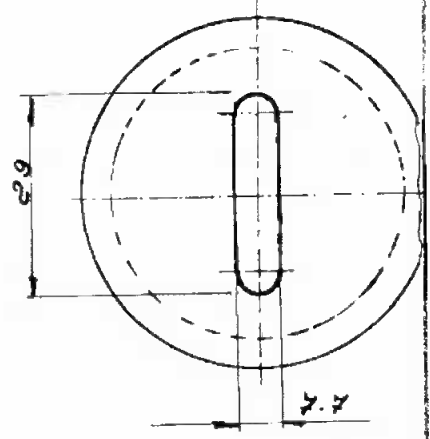
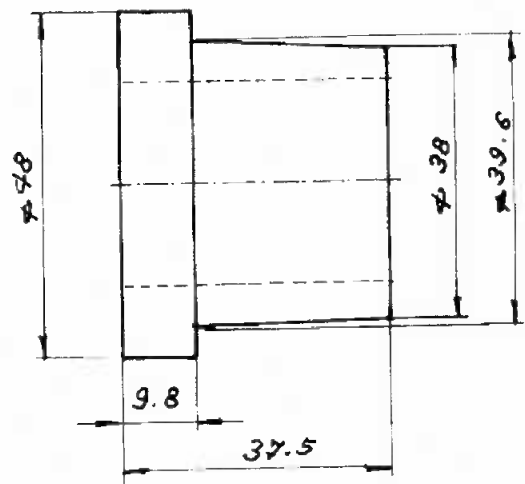

NOTE:-

PHYSICAL PROPERTIES.
 MAX. TEMPERATURE - 1600°C
 CCS - 350 kg/cm²
 APPARENT - 24% TO 29%

CHEMICAL COMPOSITION

Al₂O₃ - 57% TO 60%
 Fe₂O₃ - 2% MAX
 PCE - + 36

		SILLIMINITE (OR) MULLITE (OR) KYANITE		IS: 2044							
No. of PCS.	DESCRIPTION	MATERIAL	STD/BPS	Net wt. (kg)	Gross wt. (kg)	DRAWING No.		Item No.			
REFERENCE :			ALTERATIONS	EC: 22	CC: 17	DCN	DATE	SIGN.	Index		
SCALE	DRAWN	<i>[Signature]</i>									
1:1	CHECKED	<i>[Signature]</i>									
	APPROVED	<i>[Signature]</i>									
	DATE	08-08-97									
MACHINE: PIT TYPE HIGH TEMP.				TYPE: THE RELER 120 KW				Total wt. (kg.)			
TITLE		DRAWING No.		22		REV.					
		CERAMIC BUSH		4-M-18A-26024							
(HEATING ELEMENT TERMINAL)		ID: 77X0D48X382		No. of Sheets :		Sheet No.					

Caution

THIS DRAWING IS OUR SOLE PROPERTY AND SHOULD NOT BE USED IN ANY FORM FOR ANY OTHER PURPOSE WITHOUT THE WRITTEN PERMISSION OF PHARAT HEAVY ELECTRICALS LTD., TIRUCHIRAPALLI 620 014.

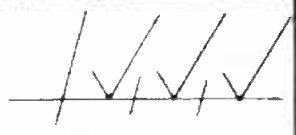

ALL DIMENSIONS ARE IN MM

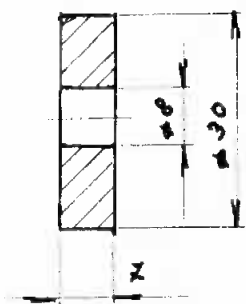

CHEMICAL COMPOSITION :-

- AL₂O₃ - 56-60 %
- FE₂O₃ - 1%
- P.C.E +36
- C.C.S - 350 kgf/cm²
- APPARENT POROSITY 24-29%
- BULK DENSITY - 2.3-2.5 gm/cc

AVOID SHARP CORNERS

		SILLIMINATE IS: 2044							
NO. of pcs.	DESCRIPTION	MATERIAL	STD/BPS	Net wt. (kg)	Gross wt. (kg)	DRAWING No.		Item	
REFERENCE:			ALTERATIONS	CC:	FC 22	DATE	SIGN.	Index	
SCALE	DRAWN								
1:1	CHECKED	R. R. Mammanna							
	APPROVED	[Signature]							
	DATE	17-06-98							
MACHINE PIT TYPE HIGH TEMP			TYPE: THERIALEX 120 KW			Total wt. (kg.)			
 <p style="font-size: 24pt; font-weight: bold; text-align: center;">CERAMIC WASHER</p> <p style="text-align: center;">(1278 00430-Xt)</p>			22			REV.			
			4-M-18A-26218			No. of Sheets :		Sheet No.	

BHARAT HEAVY ELECTRICALS LIMITED TIRUCHIRAPALLI
CAPITAL PURCHASE

Annexure-A

PART - I

ACCEPTANCE OF COMMERCIAL TERMS AND CONDITIONS BY THE VENDORS.

(This should be essentially filled in and sent along with the techno-commercial offer without fail. If this check list is not filled and submitted along with techno-commercial offer (Part I) or if the vendor does not confirm acceptance to the terms and conditions proposed herein, BHEL reserves the right to reject such offers)

CHECK-LIST FOR INDIGENOUS VENDORS

DESCRIPTION

The Bidders shall submit their offer in **TWO INNER ENVELOPES** as indicated below which shall be sealed in one outer envelope.

- ❖ **Envelope I:** This sealed envelope should contain all the copies of technical bid together with un-priced commercial bid. This envelope should be clearly marked "**Part I - Technical and commercial bid**", indicating Enquiry No., Due Date and Address & Reference of the Bidder.
- ❖ **Envelope II:** This sealed envelope should contain **price details**. This envelope should be clearly marked "**Part II - Price bid**", indicating Enquiry No., Due Date and Address & Reference of the Bidder. This part should contain the schedule of price particulars and must be co-related to the technical details provided in Part I.

All the two envelopes (Part I&II) shall be put in one cover, duly sealed, super scribing as "**Part I and Part II of Enquiry No., due date of opening**" and the address and reference of the Bidder. The offer received without the above guidelines, will not be considered for opening.

The above offer should reach this office on or before the due date by 14.00 Hrs (IST). Late offers will not be considered.

Tender should not be addressed to any Individual's name but only by designation to:

1) Please submit your offer on **F.O.R - BHEL, TRICHY** (Tamilnadu) basis and in two part (part-i: techno-commercial bid and part-ii: price bid) in a separate covers and both covers to be placed in an envelope which is super scribed with enquiry no, enquiry date and due date of tender opening.

2) If the offer is submitted in single part and the same will be liable for rejection.

3) All the Tenders may be addressed to the following address to
The Tender Opening Cell/MM
Room No-26, Building – 24, Ground Floor
Bharat Heavy Electrical Limited
Tiruchirappalli- 620014.,
TAMILNADU, INDIA

4) In case personal delivery of the offer, it shall be dropped into the respective box after duly entering the data in the system kept in room no. 26.

5) Offers will be accepted received till 14.00 hrs on the due date. Therefore Vendors shall ensure to submit the offers before this time.

6) Vendors are requested to avoid submission of offers thro email / fax. In case of any unavoidable situation, offers shall be sent thro email to the following mail ID only "**tender_cell@bheltry.co.in**"

Tenders should be free from **CORRECTIONS AND ERASURES**. Corrections if any, must be attested. All amounts shall be indicated both in words as well as in figures. In case of any difference between amount quoted in words and figures, amount quoted in words shall prevail.

Offers should be in **ENGLISH** and accompanied by detailed technical literature, catalogue and detailed dimensional drawings in **ENGLISH** or otherwise, the offers will not be considered.

OPENING OF TENDERS

The Part I- Technical & commercial bid would be opened on the Tender opening date.

Part-II, Price bid of technically suitable Bidders alone would be opened after complete evaluation of Part-I. Hence the Bidders are required to submit their best competitive price in the price bid in a sealed cover (Part-II).

Date and time of Price Bid (Part-II) opening date shall be intimated to the technically and commercially acceptable bidders only. Clarifications if any required by BHEL for Technical evaluation would be sought from bidders before opening of Part II - Price Bid

D. CHANDRAMOHAN
General Manager
Purchase (CP & SP) / MM / RM
BHEL, TIRUCHY - 620 014.

TAXES AND DUTIES :

All Taxes and Duties payable as extra to the quoted price should be specifically stated in offers along with CST & TIN No / Tariff No. etc., failing which the purchaser will not be liable for payment of such Taxes and Duties. Our TIN No. 33243560005, TNGST No. 3560005, CST. No. 239383 Dt. 11-06-1991 & BHEL ECC No. AAACB4146PXM012, Service Tax Reg No (STC)- AAACB4146PST006. Assessment circle Tiruverambur.

Cenvat credit & VAT credit (for Indian Bidders only): If any Excise Duty is payable, the chapter head / sub-head reference and the rate of the duty should be quoted. If the tenderer is availing **CENVAT** credit for his input materials, the effect of Proforma credit should be passed on to the purchaser

Income Tax applicable

Any service charges payable towards supervision of E&C, training, performance prove-out etc., will be released after deduction of Income Tax as per Indian Income Tax Act / as per the Govt. of India rules and TDS certificate will be issued by BHEL for such deductions. Applicable service tax on E&C charges will be payable extra. The liability of depositing the same to the Govt. will be of the supplier

SL. NO.	<u>BHEL COMMERCIAL TERMS AND CONDITIONS FOR INDIGENOUS SUPPLIES</u>	Vendor's Confirmation / Comments
1	<p><u>Bid should be submitted in Two Parts.</u></p> <p>1. Techno-commercial Bid (Part-I) and 2. Price Bid (Part-II) in a separate sealed cover and both the covers must be placed in a Third Cover and Sealed. Our Enquiry No., Enq. Date & Enq. Due date must be written on all Three covers</p>	
2	<p><u>ARBITRATION:</u> All disputes or differences whatsoever which may arise at any time during execution of the Contract shall be mutually settled by BHEL and Contractor as per provision of the Contract. However, in the event such disputes cannot be settled mutually, such disputes shall be settled as per the Arbitration and reconciliation Act, 1996 of the Govt. of India and it's subsequent amendments. In case of disputes with the Central PSUs, the same shall be settled at Tiruchirappalli as per the Guidelines of the Govt. of India.</p> <p>However, during the period such disputes are settled either by mutual discussions between the parties or by legal means, Contractor shall continue to do the work as per terms & conditions of Contract.</p>	
3	<p>If offer is received from both OEM/Manufacturer and authorized dealers or Agent, then OEM/Manufacturer offer will only be considered and dealers or Agent offer will be ignored.</p>	
4	<p>Technical confirmation to BHEL's Specification shall be furnished. If needed additional sheets shall be used.</p>	
5	<p>Prices shall be quoted item wise only. THIS ENQUIRY IS FLOATED / PROCESSED ON "CUMULATIVE L1 BASIS" - FROM ITEM NO. 10 TO 90 AS A PACKAGE ONLY.</p>	
6	<p>Delivery INCO TERMS- Price quoted - F.O.R - BHEL, TRICHY STORES or ex-WORKS Basis or, FOR WORKS (DESPATCHING STATION) In case of EX works / FOR WORKS basis, indicate the Despatching station.</p> <p>Prices shall be quoted on "FIRM PRICE" basis only.</p>	
7	<p>Validity of offer shall be for a minimum period of 120 days from the date of Tender opening</p>	
8	<p>Delivery period from the date of Letter of Intent / Purchase order (write in DAYS/WEEKS)</p>	

(Signature)
P. CHANDRAMOHAN
 Dy. General Manager
 Purchase (CP & SP) / MM / RM
 Tiruchirappalli - 620 014

<p>9</p>	<p>Liquidated damages shall be 0.5% of the total order value per week or part thereof subject to a maximum of 10% of the total order value.</p> <p>For staggered delivery schedule, LD shall be 0.5% of the undelivered portion per week of the delay or part thereof subject to a maximum of 10% of the total order value.</p> <p>** In case of single delivery date , Order should be completed 100% for processing the bill, otherwise LD will be calculated based on Total PO Value restricted to Max % as mentioned in the PO Condition column.</p> <p>Material Despatched after Due date: Once the delivery due date is crossed, <u>bills have to be clubbed till final despatch and forwarded for processing of payment as a single bunch.</u> LD percentage will be calculated from Delivery due date to final despatch date.</p> <p>For staggered delivery schedule, LD shall be 0.5% of the undelivered portion per week of the delay or part thereof subject to a maximum of 10% of the total order value.</p> <p>Any deviation from the above LD clause, loading will be applied to the extent to which it is not agreed by the bidder (at offered value).</p>	
<p>10</p>	<p><u>Payment term for supply portion:</u></p> <p>Payment term is 100% direct payment after 45 days from the date of receipt and acceptance of materials.</p> <p>Note: Only Direct Payment after goods receipt & acceptance will be accepted .Above payment term acceptance is essential for consideration of your offer</p> <p>Any deviation in the above payment term will attract loading as mentioned below. “Base rate of SBI (as applicable on the date of bid opening. Techno-commercial bid opening in case of two part bids) + 6% shall be considered for loading for the period of relaxation sought by bidders.</p> <p>Payment through Bank is not preferred. In case of Payment through Bank is opted by Supplier, BHEL prefers documents submission through bank with copy of LR and door delivery of Goods to Stores with Consignee copy attached. In this case Loading will be 3% on the offered value. Offers of indigenous Suppliers with payment terms as <u>LC/Advance Payment are liable for rejection.</u></p> <p><u>Important Note:</u> BHEL will consider the ranking after the loading is applied as referred vide Sl. No. 9 &10 above wherever deviations are observed.</p>	
<p>11</p>	<p><u>Following Risk Purchase clause shall be applicable:</u></p> <p>The purchaser at his option will be entitled to terminate the contract and to purchase elsewhere at the risk and cost of the seller either the whole of the goods or any part which the supplier has failed to deliver or dispatch within the time stipulated or if the same were not available, the best and the nearest available substitute therefore. The supplier shall be liable for any loss which the Purchaser may sustain by reason of such risk purchases.</p>	
<p>12</p>	<p><u>Erection / commissioning: (if applicable only)</u></p> <p>Erection / commissioning charges if any has been mentioned in the offer or else confirmation that Erection / commissioning shall be done at free of cost is available in the offer.</p>	

D. CHANDRAMOHAN
 Dy. General Manager
 Purchase (CP & SP) / MM / RM
 TIRUCHY - 620 014.

13	The equipment shall be guaranteed as per tender condition from the date of receipt & acceptance /(commissioning date ,if applicable as per tender condition). Normally No deviation permitted and the <u>deviated offers are liable for rejection.</u>											
14	Equipment will be inspected at vendor's works prior to dispatch if applicable. However final inspection and acceptance of equipment will be after installation at BHEL, Trichy and Tamilnadu.											
15	The vendor shall provide necessary drawings, Test Certificates and Operating Maintenance Manuals etc., as called for in the Technical Specification, in the required number of copies at no extra cost.											
16	Any warranty replacement during warranty period shall be supplied free of charge on FOR BHEL, Trichy, Tamilnadu basis.											
17	<p>The bidder may also be a Micro and Small Enterprises (MSE) vendor registered as per MSE act. As per the public procurement policy notified by the Central government.</p> <p>20% of the tendered quantity is earmarked for MSE suppliers in this tender. Out of the 20% tendered quantity reserved for MSE suppliers, 4% shall be earmarked for procurement from MSE owned by SC / ST entrepreneurs. In case MSE vendor participating in the tender quotes within the price band of L1+ 15%, they will be allowed to supply the portion of the requirement subject to acceptance of L1 price by MSE vendor. In case of more than one such MSE, the supply shall be shared proportionately.</p> <p>"MSE suppliers can avail the intended benefits only if they submit along with the offer, attested copies of either EM II certificate having deemed validity (five years from the date of issue of acknowledgement in EM, II) or valid NSIC certificate or EM II certificate along with attested copy of a CA certificate (Format enclosed at Annexure -V where deemed validity of EM II certificate of five years has expired) applicable for the relevant financial year (latest audited). Date to be reckoned for determining the deemed validity will be the date of bid opening (Part 1 in case of two part bid). Non submission of such documents will lead to consideration of their bid at par with other bidders. No benefit shall be applicable for this enquiry if any deficiency in the above required documents are not submitted before price bid opening. Documents should be notarized or attested by a Gazetted officer for consideration of MSE certificate."</p> <p><u>KINDLY FILL THE FOLLOWING BOX:</u></p> <table border="1" data-bbox="268 1444 1359 2049"> <tr> <td data-bbox="268 1444 794 1550">MSME Type (Please Tick the type of MSME) or Non-MSME</td> <td data-bbox="794 1444 1359 1550">Micro / Small / Medium / Non-MSME</td> </tr> <tr> <td data-bbox="268 1550 794 1677">MSME Certificate no/Date (Details must be given) for MSME vendor. Certificate needs to be attached</td> <td data-bbox="794 1550 1359 1677"></td> </tr> <tr> <td data-bbox="268 1677 794 1814">Whether SC/ST (please tick the relevant category) (Community Certificate issued by competent authority shall be attached)</td> <td data-bbox="794 1677 1359 1814"></td> </tr> <tr> <td data-bbox="268 1814 794 1908">If the Firm is SC/ST category, whether Proprietary or Partnership</td> <td data-bbox="794 1814 1359 1908">Proprietary / Partnership</td> </tr> <tr> <td data-bbox="268 1908 794 2049">If partnership firm, % share held (Value must be entered)</td> <td data-bbox="794 1908 1359 2049"></td> </tr> </table>	MSME Type (Please Tick the type of MSME) or Non-MSME	Micro / Small / Medium / Non-MSME	MSME Certificate no/Date (Details must be given) for MSME vendor. Certificate needs to be attached		Whether SC/ST (please tick the relevant category) (Community Certificate issued by competent authority shall be attached)		If the Firm is SC/ST category, whether Proprietary or Partnership	Proprietary / Partnership	If partnership firm, % share held (Value must be entered)		
MSME Type (Please Tick the type of MSME) or Non-MSME	Micro / Small / Medium / Non-MSME											
MSME Certificate no/Date (Details must be given) for MSME vendor. Certificate needs to be attached												
Whether SC/ST (please tick the relevant category) (Community Certificate issued by competent authority shall be attached)												
If the Firm is SC/ST category, whether Proprietary or Partnership	Proprietary / Partnership											
If partnership firm, % share held (Value must be entered)												

D. Chandramohan 18/6/2016

18

Cost Evaluation

- Evaluation will be done on the basis of "Total landed cost to BHEL"
- BHEL will consider the ranking after the loading is applied as referred above, wherever deviations are observed. Ranking (L-1, L-2 etc.) will be done only for the Techno-Commercially acceptable offers.
- Normally BHEL reserves the right to place order for individual items with different vendors . At special circumstance ranking shall be done on compatible basis which will be indicated through Enquiry special instruction General Notes.
- In the event of more than one vendor becoming L-1 for any of the item / items, the enquiry quantity for those item / items may be shared equally among all the L1 vendors.
- BHEL reserves the right to increase or decrease the tender quantity and split up the tender quantity among more than one vendor at the lowest acceptable price to BHEL and place order accordingly in any proportion at our own discretion.
- Lowest price received against BHEL tenders need not be the technically acceptable one and in that case BHEL reserves the right not to consider the same. The purchaser shall be under no obligation to accept the lowest or any other tender and shall be entitled to accept or reject any tender in part or full without assigning any reason whatsoever.
- BHEL reserves the right to negotiate or refloat the tender opened, if L1 price is not the lowest acceptable price to BHEL due to inter-alia other reasons.



D. CHANDRAMOHAN
Manager
P
014.

<u>OTHER DETAILS REQUIRED</u>		
19	% of Excise Duty with cess (EXTRA / INCLUSIVE / NIL)	
20	% of TAX (VAT) (TNGST with FORM-17)	
21	% of TAX (VAT) without form	
22	% of TAX (CST) (CST with C-FORM)	
23	% of TAX (CST) without form	
24	Packing & Forwarding Charges (in % only)	
25	Freight& transit insurance charges , if any((in % only) Freight charges from Dispatching station to BHEL,TRICHY (TN) (Note: If the delivery terms is Ex Works the materials has to be sent through BHEL approved carrier only ,in this case the freight will be borne by BHEL) ➤ PACKING AND MARKING: The supplier shall arrange for securely protecting and packing the stores to avoid loss or damages during transit.	
26	Approximate Net weight of the total consignment	
27	Approximate Gross weight of the total consignment	
28	Approximate Dimensions of the Consignment	
29	Name of the contact person	
30	Land Line Number	
31	Fax Number	
32	Mobile Number	
33	E-mail ID	
34	PAN No.	
35	CST No.	TIN No.

- a) It is confirmed that all the terms and conditions stipulated in the Enquiry have been fully understood by us and all clarifications & details have been obtained.
- b) Applicable % of ED, Sales Tax -CST or VAT, Service Tax), Freight, Insurance and Installation and Commissioning Charges etc., are indicated in offer.

Full postal Address:

Signature & Office Seal of the vendor

Note:-

Your specific acceptances to our Payment terms, LD & Risk Purchase (RP) Clause are essential for consideration of your offer. Otherwise your offer is liable for rejection.

No row shall be left blank. Please indicate NA, in case the item is “not applicable”

 18/6/2016

D. CHANDRAMOHAN
 Dy. General Manager
 Purchase (CP & SP) / MM / RM
 BHEL, TIRUCHY - 620 014.

Page 6 of 7
 Bidder's Seal & Signature

PART - II**MODEL PRICE BID FORMAT FOR INDIAN BIDDERS**

Enquiry No. & Date:

Bidder's Offer No. & Date:

Sl No	Description of item	Unit (SET /No)	QTY	Rate /Qty in Rs. (excluding of all taxes)	VAT/CST in % (TNGST with FORM-17 or CST with C-FORM)	ED in %	Service Tax in %	Total Value in Rs. (inclusive of all taxes)
	Packing & Forwarding charges (if any) in percentage (or) Lumpsum							
	FOR Dispatching station value in Rs.							
	Percentage of Freight & transit insurance charges, if any (Lumpsum or %) Freight & Insurance charges from Dispatching station BHEL, TRICHY (TN) (Note: If the delivery terms is Ex Works the materials has to be sent through BHEL approved carrier only, in this case the freight & Insurane will be borne by BHEL)							
	Approximate Net weight of the total consignment							
	Approximate Gross weight of the total consignment							
	Approximate Dimensions of the Consignment							

Signature & Seal of Vendor

The price bid should be submitted only as per the above format. No row shall be left blank. Please indicate NA, in case the item is "not applicable"



D. CHANDRAMOHAN
Dy. General Manager
Purchase (CP & SP) / MM / RM
BHEL, TIRUCHY - 620 014.

Page 7 of 7

Bidder's Seal & Signature