



429-002/A

(A Government of India Undertaking)
 HIGH PRESSURE BOILER PLANT
 PURCHASE DEPARTMENT - FOSSIL BOILERS
 THIRUCHIRAPALLI - 620014
 TAMILNADU (INDIA)

PHONE :2577645
 GRAMS : BHARATELEC
 FAX NO: 2520719
 E-mail: srchandran@bheltry.co.in
 Web:

Vendor Code :	Enquiry No	Enquiry Date	Due Date for Quotation
Vendor Name :	2681300005 - 79	28.01.2013	21.02.2013
Please quote Enquiry No, Date and due date in all correspondences. This is only a request for quotation and not an order			

Item	Description	Unit	Quantity	Delivery Quantity	Schedule Date
10	SUPPLY OF JOB PEDESTALS FOR FURNACES AS PER SPECIFICATION & SCOPE OF WORK (PART B) AS PER ANNEXURE II. VENDOR SHALL MEET THE QUALIFYING CRITERIA (PART A) AS IN ANNEXURE I. PEDESTAL AS PER DRG # 3M18B1114965	NO	200.000	200.00	30.03.13

General Note:
 Note:

- Please submit your detailed offer in two part bid system i.e Part-I. Technical and commercial bid along with unpriced bid (Annexure-B), indicating all taxes & duties in a sealed cover Part-II. Priced offer in another separate sealed cover.
- Both the covers shall be duly super-scribed with tender reference and due date of opening. These covers shall be put in a single cover duly super-scribed with tender reference and due date of opening and addressed to us.
- Point-to-point confirmation to BHEL's specification and commercial terms & conditions shall be provided Annexure-A. All the Annexures should be filled and submitted along with the technical bid (no row shall be left blank), else your offer is liable for rejection.
- Offers with validity of less than 180 days and non-acceptance of LD , RP clause, PBG & Payment terms, will lead to rejection of submitted offer.
- If the due date of tender opening happens to be a holiday, the tenders will be opened on the next working day.
- All clarifications may be sought at least ten days prior to tender due date, from the undersigned with due written request.
- BHEL reserves the right to go for a reverse auction (RA) instead of opening the submitted sealed bid, which will be decided after technical

The offers should reach us 30 minutes before the time of opening of tenders. The offers will be opened at 14.30 hrs on the due date of tender in the presence of tenderers who have submitted their offer and who may like to be present for the tender opening. Late and delayed offers are liable to be rejected.

Yours faithfully,
 For **BHARAT HEAVY ELECTRICALS LIMITED**

[Signature]
 MANAGER / PURCHASE
 (FOSSIL BOILERS)
 THIRUCHIRAPALLI

Manager / Purchase
 Bharat Heavy Electricals Limited
 Tiruchirappalli - 620 014



BHARAT HEAVY ELECTRICALS LIMITED

(A Government of India Undertaking)
HIGH PRESSURE BOILER PLANT
PURCHASE DEPARTMENT - FOSSIL BOILERS
THIRUCHIRAPALLI - 620014
TAMILNADU (INDIA)

Page
2/2

PHONE :2577645
GRAMS : BHARATELEC
FAX NO: 2520719
E-mail: srchandran@bheltry.co.in
Web:

2681300005 / 28.01.2013

evaluation. Information and general terms and conditions covering RA are given in commercial terms and conditions (Annexure-A/Point no.15)

7. Corrigendum if any, with respect to this tender will be hosted only in the website <http://www.bhel.com> or <http://tenders.gov.in>. You are requested to visit the website regularly for updates.

List of Attachments:

1. Qualifying Criteria Annexure-I
2. Technical Specification Annexure-II+ Dwg3h
3. Commercial Terms and Conditions - Annexure-A
4. Price Format-Annexure-B

Enclosures:

"LD clause has to be confirmed without fail."
"Payment to vendors will be made only thro E-Payment mode"

The offers should reach us 30 minutes before the time of opening of tenders. The offers will be opened at 14.30 hrs on the due date of tender in the presence of tenderers who have submitted their offer and who may like to be present for the tender opening. Late and delayed offers are liable to be rejected.

Yours faithfully,
For **BHARAT HEAVY ELECTRICALS LIMITED**

MANAGER / PURCHASE
(FOSSIL BOILER) TOR
PG AB
Manager / Purchase / MFG
Bharat Heavy Electricals Limited,
Tiruchirappalli - 620 014

ANNEXURE - I
PART A

**QUALIFYING CRITERIA FOR THE SUPPLY OF
JOB PEDESTALS FOR FURNACES**

The BIDDER / VENDOR has to compulsorily meet the following requirements to get qualified for submitting an offer for supply of Pedestal castings:

S. No.	PARTICULARS	VENDOR's RESPONSE
1.0	The BIDDER / VENDOR shall have a minimum of FIVE Years of Continuous Experience of in the Field of castings of Alloy metals. [Furnish Details]	
2.0	Profile of the Company bringing-out the years of Experience and Capability of the BIDDER in the field of pattern design and capacity. [Furnish Details]	
3.0	Details on the Firm's Registration and the FINANCIAL STRENGTH of the COMPANY (Balance Sheet for the last 3 years) shall be submitted with the TECHNICAL OFFER	
4.0	Any Additional Data to supplement the manufacturing capability of the BIDDER for the subject equipment.	

ANNEXURE - II
PART B

**SPECIFICATION FOR THE SUPPLY OF
JOB PEDESTALS FOR FURNACES**

BIDDER shall give Complete technical Details, to meet the BHEL specification requirements:

S. No.	PARTICULARS	VENDOR's RESPONSE
1.0	Pedestal casting as per drawing no. 3M-18B-11-14965. The material of the casting is IS-4522 Gr 11.	
2.0	Certificate for material composition from Govt. approved lab to be provided along with material supply. However BHEL will also check at BHEL lab for final acceptance.	
3.0	All the castings to be offered for inspection by BHEL before dispatch at vendor's works.	

CAUTION: THIS DRAWING IS OUR SOLE PROPERTY AND SHOULD NOT BE USED IN ANY FORM FOR ANY PURPOSE WITHOUT THE WRITTEN PERMISSION OF BHARAT HEAVY ELECTRICALS LIMITED TRICHIRAPPALLI - 620 014.

ALL DIMENSIONS ARE IN MM

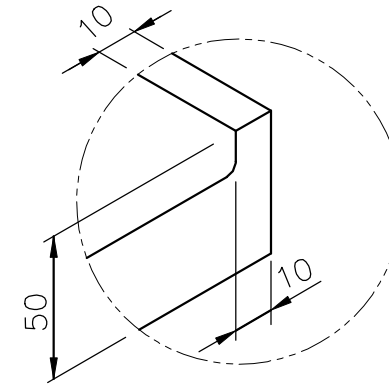
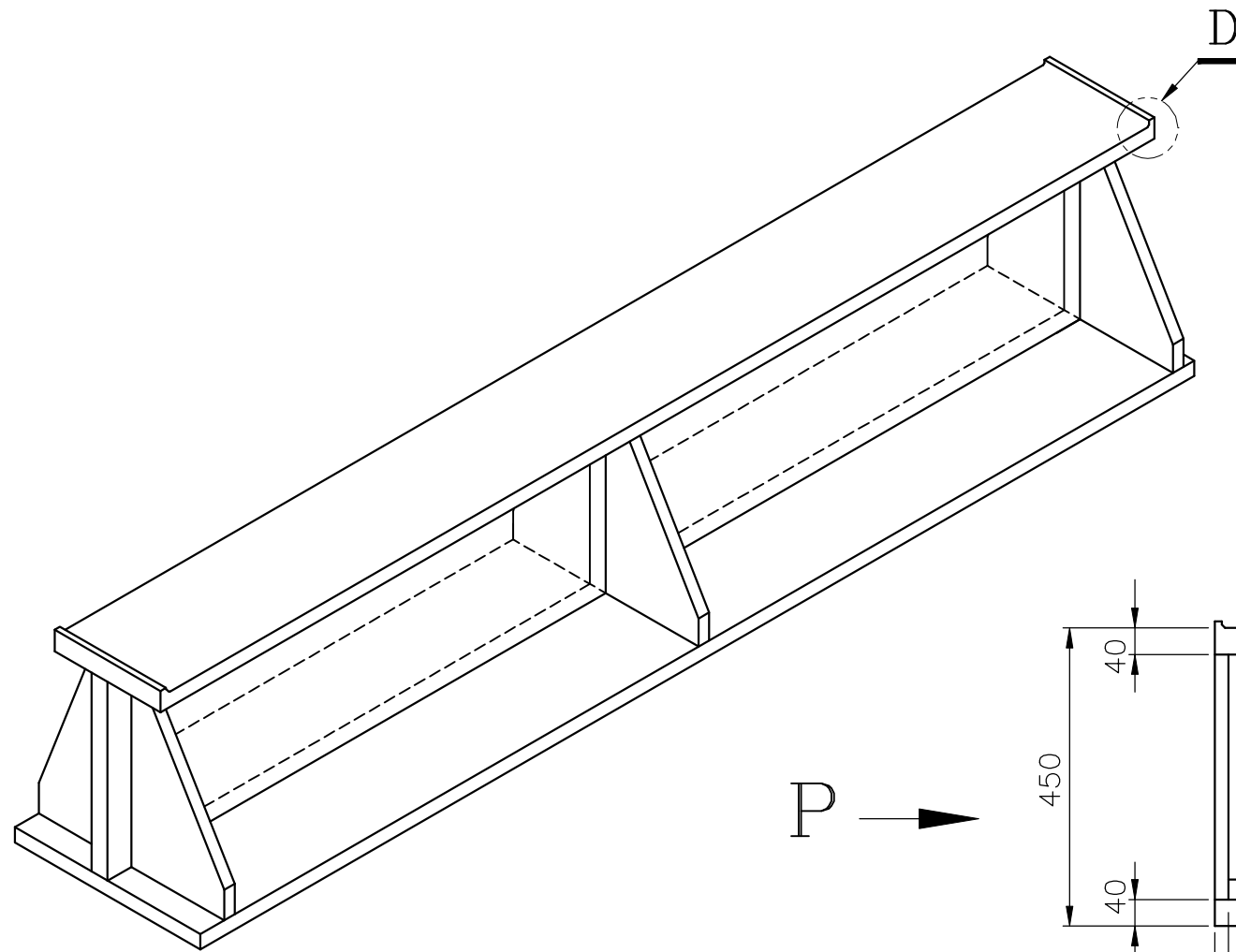

DETAIL-D

P →

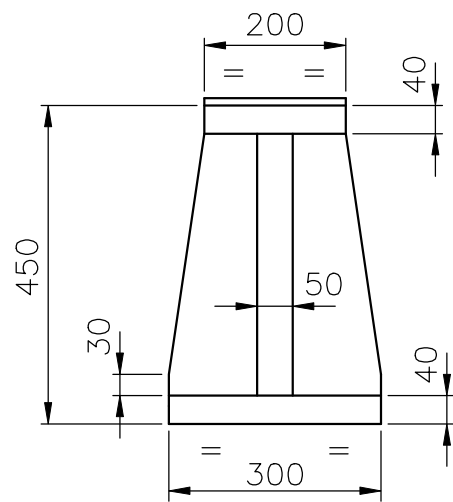
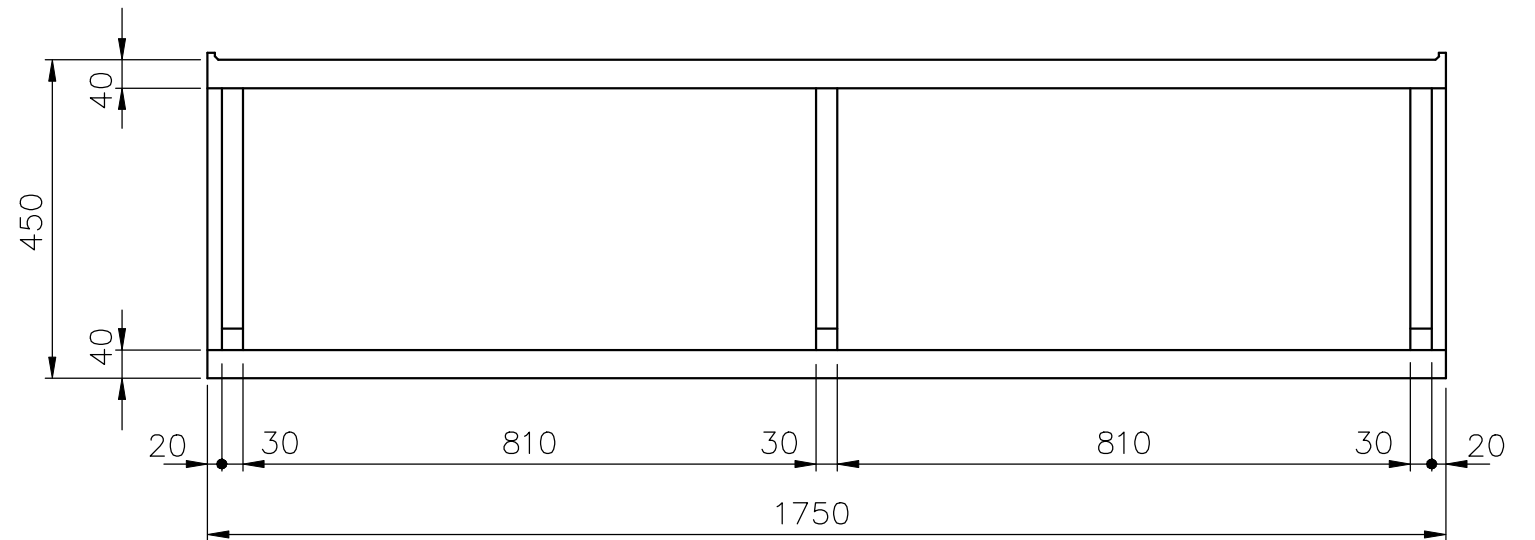

VIEW-P

FINAL DRG. TO BE SUBMITTED BY SUPPLIER FOR BHEL APPROVAL

* HEAT RESISTANT STEEL CASTING

FOR TENDERING PURPOSE ONLY

No. of Pieces		DESCRIPTION		* IS: 4522 GR.11	581.88	DRAWING No.		ITEM No.
REFERENCE:		MATERIAL		STANDARD	NET.WT.IN KGS.	DCN REF	DATE	SIGN.
ALTERATIONS:								INDEX
SCALE	DRN/TCD	S.Selvamanickam						
1:10	CHE.D.	G.Govindaraj						
1:2	APP.D.	K.Ramanan						
	DATE	23.08.12'						
MACHINE: PLATE HEATING FURNACE				TYPE: BHEL 40T (LPG)				
TITLE: PEDESTAL (JOB SUPPORT)				DRAWING No: 3M18B1114965				
Sheet No:				No.of Sheets:				

BHARAT HEAVY ELECTRICALS LIMITED TIRUCHIRAPALLI
CAPITAL PURCHASE

Annexure-A

ACCEPTANCE OF COMMERCIAL TERMS AND CONDITIONS BY THE VENDORS.

(This should be essentially filled in and sent along with the techno-commercial offer without fail. If this check list is not filled and submitted along with techno-commercial offer (Part I) or if the vendor does not confirm acceptance to the terms and conditions proposed herein, BHEL reserves the right to reject such offers)

CHECK-LIST FOR VENDORS

SI No	DESCRIPTION
1.	<p>The Bidders shall submit their offer in TWO INNER ENVELOPES as indicated below which shall be sealed in one outer envelope.</p> <ul style="list-style-type: none">❖ Envelope I: This sealed envelope should contain all the copies of technical bid together with un-priced commercial bid. This envelope should be clearly marked "Part I - Technical and commercial bid", indicating Enquiry No., Due Date and Address & Reference of the Bidder.❖ Envelope II: This sealed envelope should contain price details. This envelope should be clearly marked "Part II - Price bid", indicating Enquiry No., Due Date and Address & Reference of the Bidder. This part should contain the schedule of price particulars and must be co-related to the technical details provided in Part I. <p>All the two envelopes (Part I&II) shall be put in one cover, duly sealed, super scribing as "Part I and Part II of Enquiry No., due date of opening" and the address and reference of the Bidder. The offer received without the above guidelines, will not be considered for opening.</p> <p>The above offer should reach this office on or before the due date by 14.00 Hrs (IST). Late offers will not be considered.</p> <p>Tender should not be addressed to any Individual's name but only by designation to:</p> <p style="text-align: center;">MANAGER / CAPITAL PURCHASE / MFG 24 BUILDING, 4TH FLOOR BHARAT HEAVY ELECTRICALS LIMITED HIGH PRESSURE BOILER PLANT TIRUCHIRAPALLI - 620 014 TAMIL NADU, INDIA</p> <p>Tenders should be free from CORRECTIONS AND ERASURES. Corrections if any, must be attested. All amounts shall be indicated both in words as well as in figures. In case of any difference between amount quoted in words and figures, amount quoted in words shall prevail.</p> <p>Offers should be in ENGLISH and accompanied by detailed technical literature, catalogue and detailed dimensional drawings in ENGLISH or otherwise, the offers will not be considered.</p>
2.	<p><u>OPENING OF TENDERS</u></p> <p>The Part I- Technical & commercial bid would be opened on the Tender opening date.</p> <p>Part-II, Price bid of technically suitable Bidders alone would be opened after complete evaluation of Part-I. BHEL reserves the right to go for a reverse auction (RA) instead of opening the submitted sealed bid, which will be decided after technical evaluation. Information and general terms and conditions covering RA are given in this Annexure- I (Point no.15).</p> <p>Date and time of Price Bid (Part-II) opening / RA conducting date shall be intimated to the technically and commercially acceptable bidders only. Clarifications if any required by BHEL for Technical evaluation would be sought from bidders before opening of Part II - Price Bid/ RA</p>
3.	<p><u>TAXES AND DUTIES :</u></p> <p>All Taxes and Duties payable as extra to the quoted price should be specifically stated in offers along with CST & TIN No / Tariff No. etc., failing which the purchaser will not be liable for payment of such Taxes and Duties. Our TIN No. 33243560005, TNGST No. 3560005, CST. No. 239383 Dt. 11-06-1991 & BHEL ECC No. AAACB4146PXM012, Service Tax Reg No (STC)- AAACB4146PST006. Assessment circle Tiruverambur.</p> <p>Cenvat credit & VAT credit (for Indian Bidders only): If any Excise Duty is payable, the chapter head / sub-head reference and the rate of the duty should be quoted. If the tenderer is availing CENVAT credit for his input materials, the effect of proforma credit should be passed on to the purchaser</p> <p>Income Tax applicable</p> <p>Any service charges payable towards supervision of E&C, training, performance prove-out etc., will be released after deduction of Income Tax as per Indian Income Tax Act / as per the Govt. of India rules and TDS certificate will be issued by BHEL for such deductions. Applicable service tax on E&C charges will be payable extra. The liability of depositing the same to the Govt. will be of the supplier</p>

No row shall be left blank. Please indicate NA, in case the item is “not applicable”		Vendor’s confirmation
4.	Validity: Validity of the offer should be 180 days from the date of tender opening.	
5.	<p>Release of Purchase Order:</p> <ul style="list-style-type: none"> ➤ Purchase Orders will be released on the successful vendor (L1 vendor) ➤ In case L1 vendor is non MSME and participation of MSME vendor with L2 or beyond ranking and the price competitiveness of MSME vendor is within L1+15%, the quantity will be split-up into 80:20 ratio; 20% of quantity will be considered for MSME vendors provided they match the price as per MSME guidelines. 	
6.	<p>Terms of Payment: 100% payment, within 45 to 90 days, after receipt, acceptance of equipment at BHEL, Tiruchi against submission of 10% PBG for total order value.</p>	
7.	<p>Performance Bank Guarantee (PBG): The Bidder, in the event of an order, should furnish a Bank Guarantee from an Indian Bank approved by BHEL, at no extra cost in a format prescribed by BHEL, along with the order, for an amount equivalent to 10% (Ten percent) of the value of the contract. The PBG shall be valid for a period of 18 months from the date of dispatch or 12 months from the date of receipt / acceptance / commissioning of the equipment at BHEL, Tiruchi whichever is more, with a claim period of two months.</p> <p>The Performance Bank Guarantee shall be obtained from any one of the following banks which is a member bank in our consortium of banks.</p> <p>LIST OF CONSORTIUM BANKS 1.DEUTSCHE BANK 2.HDFC BANK 3.ANZ GRINDLAYS BANK 4.CITI BANK 5.STANDARD CHARTERED BANK 6.BANK OF AMERICA 7.ABN AMRO BANK 8.IDBI LTD 9.ICICI BANK LTD 10.THE HONGKONG AND SHANGHAI BANKING .CORPORATION LTD.</p> <p>LIST OF NATIONALISED BANKS 1.ALLAHABAD BANK 2.ANDHRA BANK 3.BANK OF INDIA 4.BANK OF BARODA 5.BANK OF MAHARASTRA 6.BHARATH OVERSEAS BANK 7.CANARA BANK 8.CENTRAL BANK OF INDIA 9.CORPORATION BANK 10.DENA BANK 11.INDIAN BANK 12.INDIAN OVERSEAS BANK 13.OREINTAL BANK OF COMMERCE 14.PUNJAB NATIONAL BANK 15.PUNJAB & SIND BANK 16.STATE BANK OF INDIA 17.STATE BANK OF TRAVANCORE 18.STATE BANK OF MYSORE 19.STATE BANK OF BIKANER & JAIPUR 20.STATE BANK OF HYDERABAD 21.STATE BANK OF PATIALA 22.STATE BANK OF MAHARASTRA 23.STATE BANK OF SOURASTRA(SBI-13.09.08) 24.SYNDICATE BANK 25.UCO BANK 26.UNION BANK OF INDIA 27.UNITED BANK OF INDIA 28.VIJAYA BANK</p> <p><u>If PBG is issued by a Foreign counter part of the BHEL consortium Indian Bank, in case of claim against the PBG , it will be lodged in any one of the Indian counters of the Foreign Bank which issued the PBG.</u></p>	
8.	<p>Liquidated damages (LD):</p> <p>It is clearly understood among the parties to the contract that “Time is the essence of the contract”. Therefore, the delivery of the goods specified in the purchase order should be made within the time prescribed. Where the seller supplies or dispatches the goods, beyond the delivery period specified, the purchaser will have no obligation to accept the goods. If accepted, Liquidated Damages at the rate of ½ % of the value of goods delayed for each week of delay subject to a maximum of 15% of the order value will be levied.</p> <p>For the purpose of Imposing LD, the FOB delivery (B/L date) shall be considered. <u>BHEL reserves the right to reject offers from vendors not accepting the above LD clause, with maximum LD as 15%.</u></p>	
9.	<p>Risk Purchase:</p> <p>Alternatively the purchaser at his option will be entitled to terminate the contract and to purchase elsewhere at the risk and cost of the seller either the whole of the goods or any part which the supplier has failed to deliver or dispatch within the time stipulated as aforesaid or if the same were not available from the best and the nearest available substitute. The supplier shall be liable for any loss which the Purchaser may sustain by reason of such risk purchases.</p>	
10.	<p>Delivery terms and evaluation process:</p> <p>Indian Bidders should submit their offer on FOR BHEL, Tiruchy basis. Packing & Forwarding and Freight & Insurance charges from works to BHEL, Tiruchy to be indicated separately if extra from basic rate. Applicable % of ED & Sales Tax , Commissioning Charges should be clearly indicated.</p> <p>Evaluation of offers shall be on the basis of delivered cost (Net cash outflow to BHEL)</p>	

	<p>No row shall be left blank. Please indicate NA, in case the item is “not applicable”</p>	<p>Vendor's confirmation</p>
<p>11. Guarantee:</p>	<p>Vendors shall provide a guarantee for a period of 12 months from the date of commissioning of the equipment or 18 months from date of supply, whichever is earlier. The date of B/L or AWB shall be taken as the date of supply.</p> <p>Also, a PBG has to be given which shall cover the guarantee period (with additional 2 months as claim period).</p> <p><u>Offers from vendors not accepting the requested guarantee period will be rejected.</u></p>	
<p>12. Short shipment / Warranty replacement:</p>	<p>In case of any short shipment in the main equipment / spares, Customs Duty levied on such supplies, shall be borne by the supplier. Any warranty replacement during the warrantee period shall be on FOR, BHEL, Tiruchirappalli, basis.</p>	
<p>13. Inspection & Testing:</p>	<p>All goods shall be subject to inspection by BHEL or its authorized representatives at supplier's works or at BHEL stores or at any other place in India indicated by BHEL as the case may be. The supplier will not charge for the facilities provided for inspection of goods. In case of machine tools, the machine would be inspected and proved at supplier's works prior to dispatch however, final inspection and acceptance of the machine will be carried after installation of the machine at BHEL, Tiruchirappalli.</p>	
<p>14. Test certificates / Operating and Maintenance manuals:</p>	<p>The Bidders shall clearly mention in their offer, that Test Certificates and Operating Maintenance Manuals, etc., as called for in the Technical Specification, in the required number of copies will be provided at no extra cost.</p>	
<p>15. Reverse Auction (RA):</p>	<p>BHEL reserves the right to conduct on-line internet Reverse Auction for finalizing the Tender. This decision will be communicated to the technically qualified vendors after technical evaluation. Details / General terms / guidelines for conduct of RA are shown below Vendors are requested to confirm their acceptance for BHEL proceeding with RA route for finalization of the enquiry.</p> <ol style="list-style-type: none"> 1. For the proposed reverse auction, technically and commercially acceptable bidders only shall be eligible to participate. 2. BHEL will engage the services of a service provider who will provide all necessary training and assistance before commencement of on line bidding on internet. 3. BHEL will inform the vendor in writing in case of reverse auction, the details of Service Provider to enable them to contact & get trained. 4. Business rules like event date, time, Start price, bid decrement, extensions etc. also will be communicated through service provider for compliance. 5. Vendors have to fax the Compliance form in the prescribed format (provided by Service provider) before start of Reverse auction. Without this, the vendor will not be eligible to Participate in the event. 6. BHEL will provide the calculation sheet (e.g., EXCEL sheet) which will help to arrive at “Total Cost to BHEL” like Packing & forwarding charges, Taxes and Duties, Freight charges, Insurance, Service Tax for Services and loading factors (for non-compliance to BHEL standard Commercial terms & conditions) for each of the vendor to enable them to fill-in the price and keep it ready for keying in during the Auction. 7. Reverse auction will be conducted on scheduled date & time. 8. At the end of Reverse Auction event, the lowest bidder value will be known on the network. 9. The lowest bidder has to Fax the duly signed Filled-in prescribed format as provided on case-to-case basis to BHEL through Service provider within 24 hours of Auction without fail. 10. Any variation between the on-line bid value and the signed document will be considered as sabotaging the tender process and will invite disqualification of vendor to conduct business with BHEL as per prevailing procedure. 11. In case BHEL decides not to go for Reverse Auction procedure for this tender enquiry, the Price bids and price impacts, if any, already submitted and available with BHEL shall be opened as per BHEL's standard practice. 12. BHEL reserves the right to negotiate if need be, with the “L1” vendor of the Reverse Auction 13. <u>BHEL reserves the right not to consider offers from vendors not complying with the RA process for finalization of the enquiry.</u> 	

16.	<ul style="list-style-type: none"> ➤ Point to point confirmation for the Technical Specification enclosed has to be provided. If there are any deviations, the same should be clearly specified. Offers received without confirmation to our specification will be liable for rejection. If needed additional sheets shall be used. ➤ Indian bidders should submit the prices only in Indian Rupees. ➤ List of customers to whom same or similar equipment have been supplied along with performance certificates to be enclosed ➤ Relevant catalogues to be attached ➤ List of spares parts (if it is specified in the enquiry sheet) for smooth operation and maintenance should be attached with part numbers. ➤ Prices shall be quoted item wise only as per the model format enclosed. An unpriced copy shall be submitted along with technical bid where in the applicable Taxes and Duties Shall be clearly specified ➤ Equipment offered shall be "New". Re-built / Re-conditioned / Used equipments will not be accepted. Incomplete offers will not be considered for further processing Fixed price: ➤ Prices quoted by the bidder shall be fixed and not subject to any escalation whatsoever during the period of bid validity and execution of the Purchase Order. A bid submitted with an adjustable price will be treated as non - responsive and rejected. Prices shall be written in words and figures. In the event of difference, the price in words shall be valid and binding. Unit prices shall be considered correct in the event of any discrepancy with regard to total price. ➤ The Supplier shall arrange for securely protecting and packing the stores to avoid loss or damages during transit. ➤ Evaluation of offers shall be on the basis of delivered cost (Net cash outflow to BHEL). ➤ BHEL reserves its right to reject a tender due to unsatisfactory past performance in the execution of a contract at any of BHEL projects / units. ➤ BHEL shall be at liberty to reject or accept any tender, part or in full, at their own discretion and any such action is not liable for any question or claim against BHEL. ➤ All Equipments / Services including concern Personal for carrying out the erection and commissioning of the Equipment shall be arranged by the vendor. If any Services is availed from BHEL, it is only on chargeable basis unless otherwise specified. ➤ The vendor shall provide necessary drawings, Test Certificates and Operating Maintenance Manuals etc., as called for in the Technical Specification, in the required number of copies at no extra cost ➤ Any replacement during warranty period shall be supplied free of charge on FOR BHEL, Trichy basis. 	
17.	Company Details & Contact	
	Full Address of the company for future correspondence.	
	Company Email ID:	
	Phone No.:	
	Fax No	
	PAN No	
	CST /TIN No	
	Service Tax No.	

	Name of the contact person:	
	Mobile No.:	
	e-mail ID	
18.	TO BE CONFIRMED BY VENDOR	
	Country of origin:	
	Station of dispatch/Port of Shipment	
	Delivery Terms (For destination or Ex-works)	
	Packing & Forwarding Charges, if any (in % or Lumpsum) ie. extra from basic rate	
	% of Excise Duty with cess	
	% of TAX (CST/VAT) (TNGST with FORM-17 or CST with C-FORM)	
	Freight & Transit Insurance charges (if any, in Lumpsum (or) percentage) from Dispatching station to BHEL Tiruchirappalli, (Note:If the delivery terms is Ex Works the materials has to be sent through BHEL approved carrier only, in this case the Freight & Insurance will be borne by BHEL)	
19.	Delivery from the date of Letter of Intent / Purchase Order. (This should be inclusive of Order acceptance, drawing approval and time period required for dispatch (B/L or AWB date) etc.,	
20.	Weight & Cubage of package: Approximate Net weight of the total consignment: Approximate Gross weight of the total consignment: Approximate volume of the total consignment:	
<p>For any queries / clarifications the bidders may contact us through our FAX NO. +91 431 2520719 or through e-mail <pgavictor@bheltry.co.in> or <srchandran@bheltry.co.in></p>		

NOTE:-

- a) Your specific acceptance to our Payment terms, LD, Risk Purchase Clause & Submission of PBG for 10% of the order value are essential for consideration of your offer. Otherwise your offer is liable for rejection.
- b) **No row shall be left blank. Please indicate NA, in case the item is “not applicable”**

Declaration:-

I/We have gone through and understood the ‘General guidelines & instructions to bidders for submitting offer’ enclosed as a part of the Tender and confirm that our offer has been made in line with the same.

(AFFIX OFFICIAL SEAL HERE)

Signature with date:

Name:

Designation:

Department:

(PLEASE AFFIX YOUR SIGNATURE WITH SEAL ON EACH PAGE)

MODEL PRICE BID FORMAT FOR INDIAN BIDDERS

Enquiry No. & Date:

Bidder's Offer No. & Date:

Sl No	Description of item	Unit (SET /No)	QTY	Rate /Qty in Rs. (excluding of all taxes)	VAT/CST in % (TNGST with FORM-17 or CST with C-FORM)	ED in %	Total Value in Rs. (inclusive of all taxes)
1		No	200				
	Packing & Forwarding charges (if any) in percentage (or) Lumpsum						
	FOR Dispatching station value in Rs.						
	Percentage of Freight & transit insurance charges, if any (Lumpsum or %) Freight & Insurance charges from Dispatching station to BHEL, Tiruchirappalli (Note: If the delivery terms is Ex Works the materials has to be sent through BHEL approved carrier only, in this case the freight & Insurance will be borne by BHEL)						
	Approximate Net weight of the total consignment						
	Approximate Gross weight of the total consignment						
	Approximate Dimensions of the Consignment						

Signature & Seal of Vendor

he price bid should be submitted only as per the above format. No row shall be left blank. Please indicate NA, in case the item is "not applicable"