

The information on this document is the property of BHARAT HEAVY ELECTRICALS LIMITED. It must not be used directly or indirectly in any way detrimental to the interest of the company.

00-97-79-272-62-26-00  
DRAWING No.

First Angle Projection

ISA 32x32x3t

All dimensions are in MM

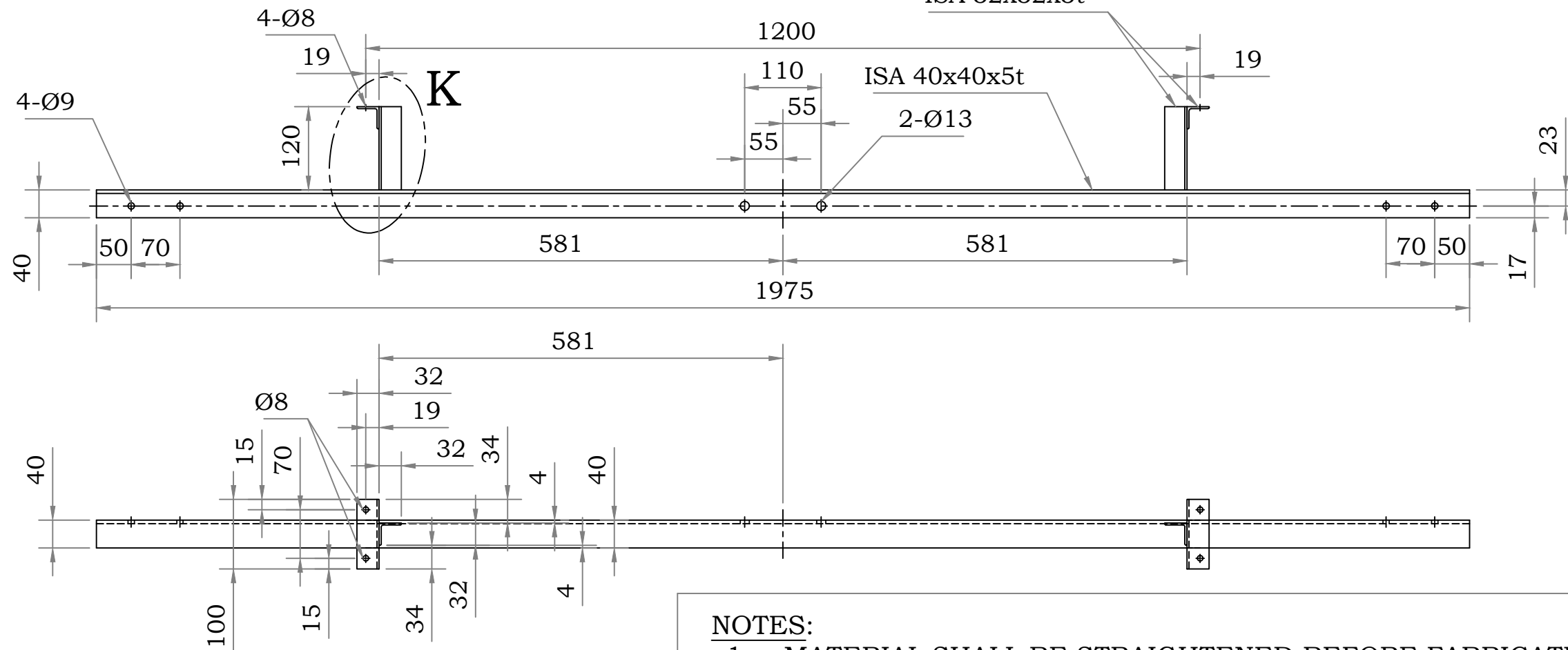

**NOTES:**

1. MATERIAL SHALL BE STRAIGHTENED BEFORE FABRICATION.
2. **"DETAIL - K"** SHALL BE MIRROR IMAGED FOR OTHER END.
3. ALL JOINTS ARE TO BE WELDED UNLESS OTHERWISE SPECIFIED.
4. SHARP CORNERS AND BURRS SHALL BE REMOVED/ SMOOTHENED.
5. MATERIAL SHALL BE HOP DIP GALVANISED.

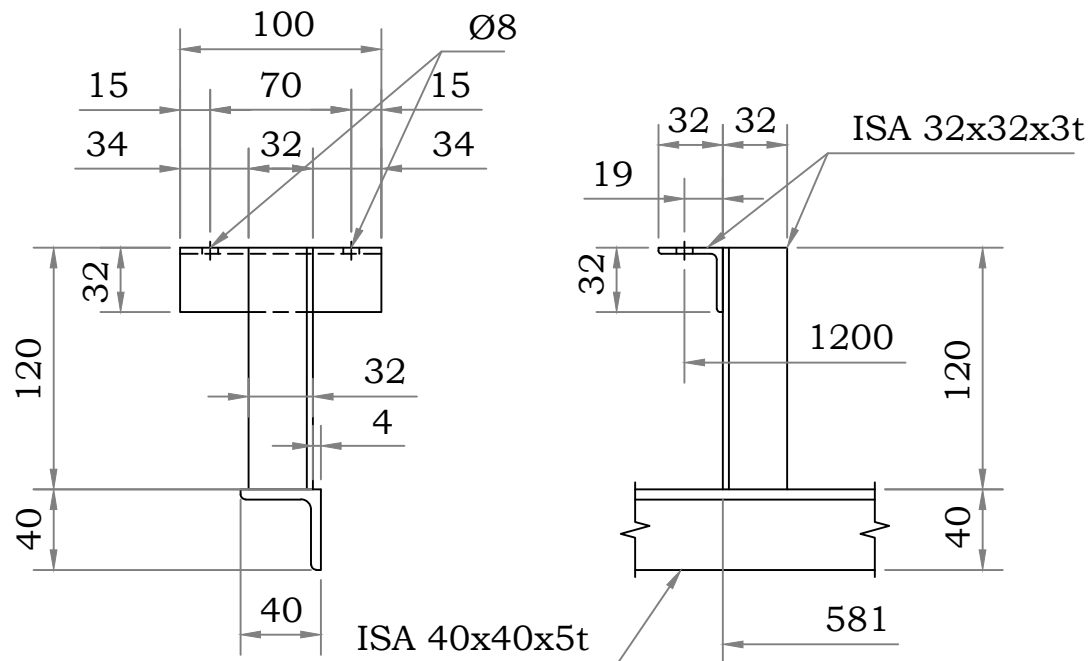

**DETAIL - K**

**MATERIAL : M.S.**  
**QUANTITY : 72 Nos.**

| ITEM No.   | DESCRIPTION     | DRAWING No.        | MTL. SPCN. MTL. CODE                    | QTY.         | UNIT WT. (Kg.)   |
|--|-----------------|--------------------|---|--------------|------------------|
| TYPE OF PRODUCT OR NAME OF THE CUSTOMER/ PROJECT<br><b>Field Demonstration of 100 kWp SPV System with Solar Thermal Sun Trackers</b> |                 |                    |   |              |                  |
| <b>BHARAT HEAVY ELECTRICALS LTD.</b><br>CORPORATE RESEARCH AND DEVELOPMENT   |                 | NAME               | SIGN                                    | DATE         | No. OF VAR       |
| DEPT FCR   |                 | DRN                | KVPR RAO                                |              |                  |
| CODE 62  |                 | CKD                | SURYA ASP                               |              |                  |
| MATERIAL M.S.  |                 | APPD               | M R PAWAR                               |              |                  |
| SCALE  | TOTAL WT. (Kg.) | REF. TO ASSY. DRG. | ITEM No.                                | No. OF ITEM  |                  |
| NTS  |                 |                    |   |              |                  |
| TITLE<br><b>MAIN FRAME (3 &amp; 4)</b><br>(50 kWp HORIZONTAL AXIS PASSIVE TRACKERS)  |                 |                    | DRAWING No.<br><b>3-13-572-62-26-00</b> |              | REV.<br><b>0</b> |
|  |                 |                    | SHT. No.                                | No. OF SHTS. |                  |