

CAUTION THE INFORMATION ON THIS DOCUMENT IS THE PROPERTY OF BHARAT HEAVY ELECTRICALS LIMITED. IT MUST NOT BE USED DIRECTLY OR INDIRECTLY IN ANY WAY DETRIMENTAL TO THE INTEREST OF THE COMPANY

3-80-399-28915

DRAWING No

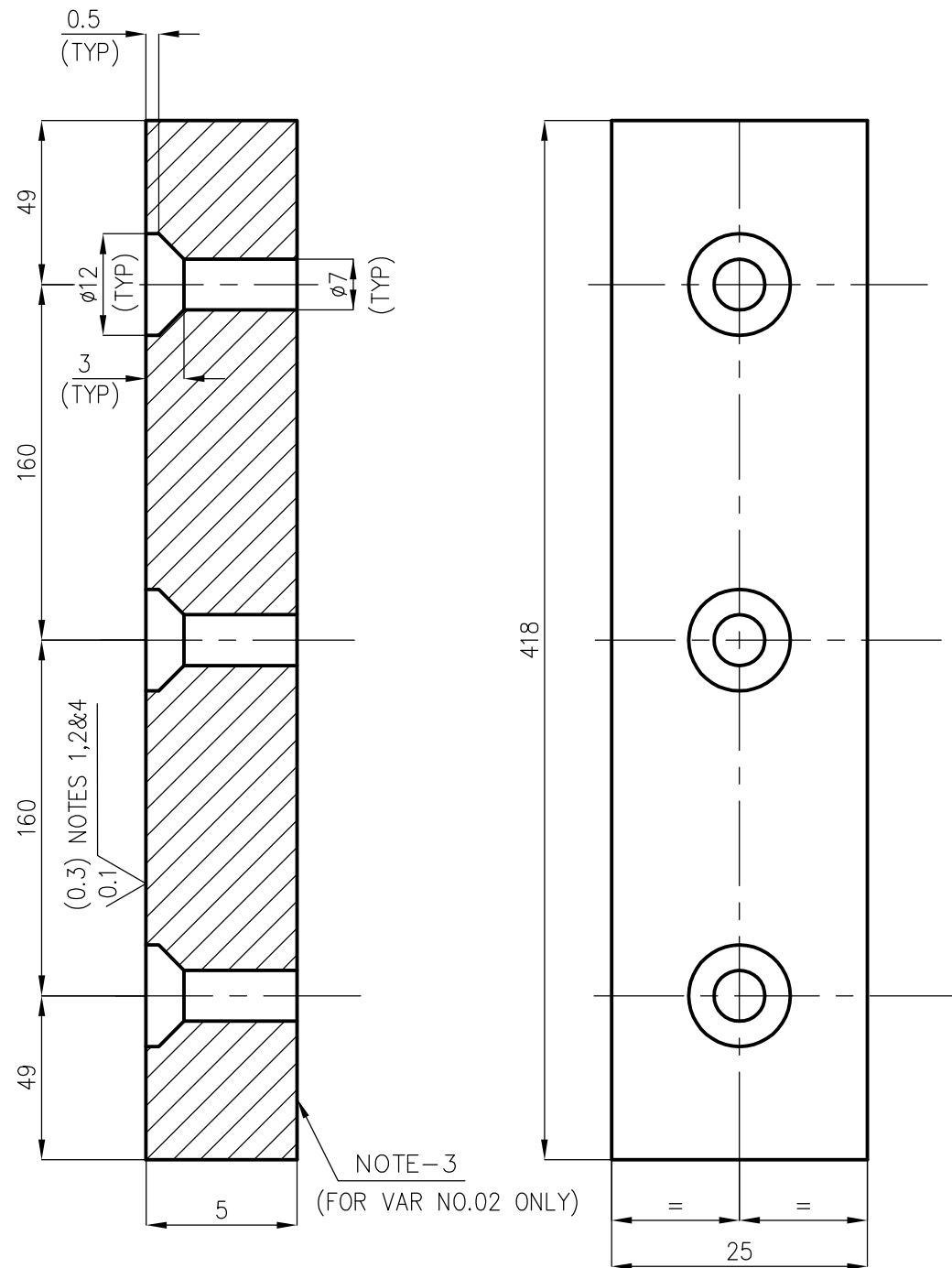
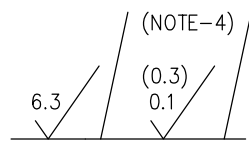

NOTES:-

- 01. THIS SURFACE SHOULD BE GROUND AND BUFFED TO MIRROR FINISH. NO TOOL MARK OR SCRATCH SHOULD BE VISIBLE WHEN VIEWED THROUGH MAGNIFICATION LENSE.
- 02. PROTECT THIS SURFACE WITH PLASTIPEEL OR EQUIVALENT.
- 03. PUNCH MARK HERE AS "SS" FOR STAINLESS PLATES. THIS IS FOR IDENTIFICATION AND TO AVOID MIX UP. CARE MUST BE EXERCISED WHILE PUNCHING SUCH THAT
 - a) POLISHED SURFACE SHOULD NOT BE AFFECTED,
 - b) PUNCH MARK SHOULD NEVER BE DONE ON POLISHED SURFACE.
- 04. $\sqrt{0.3}$ FINISH IS TO BE MAINTAINED FOR CARBON STEEL (VAR No.01)
- 04. $\sqrt{0.1}$ FINISH IS TO BE MAINTAINED FOR STAINLESS STEEL (VAR No.02)

VAR NO.	ITEM NO.	DESCRIPTION	DRAWING NO.	ITEM NO. / VAR NO.	MATERIAL CODE / MATERIAL SPEC.	A / C	UNIT WT. / QTY.
	02	PLATE 6 25 x 418	3-80-399-28915	02	15 011 206 0000 SA 240 TYP.310	C	0 410 1
	01	PLATE 6 25 X 418	3-80-399-28915	01	15 011 092 0000 IS 2062 Fe410A		0 410 1

TYPE OF PRODUCT
OR NAME OF
CUSTOMER/PROJECT

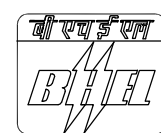

BHARAT HEAVY ELECTRICALS LTD.,
PIPING CENTRE,
CHENNAI 600 017

DRN	NAME	SIGN	DATE	NO OF ITEMS
	G.DINESH	-sd-	24.10.11	
CHD	LALIT	-sd-	24.10.11	
APPD	C.S	-sd-	24.10.11	

REV	DATE	ALTERED / APPROVED	DEPT.	GRADE OF UN TOL. DIM	SCALE	WEIGHT (Kg)	REF TO ASSY / OLD DRG	ITEM No.
01				C/M/F	NTS	0.820	-	
ZONE								
TITLE							CARD CODE	REV
TARGET PLATE (NB 400)							U 01	3-80-399-2891500

CAUTION THE INFORMATION ON THIS DOCUMENT IS THE PROPERTY OF BHARAT HEAVY ELECTRICALS LIMITED. IT MUST NOT BE USED DIRECTLY OR INDIRECTLY IN ANY WAY DETRIMENTAL TO THE INTEREST OF THE COMPANY

3-80-399-31103

DRAWING No

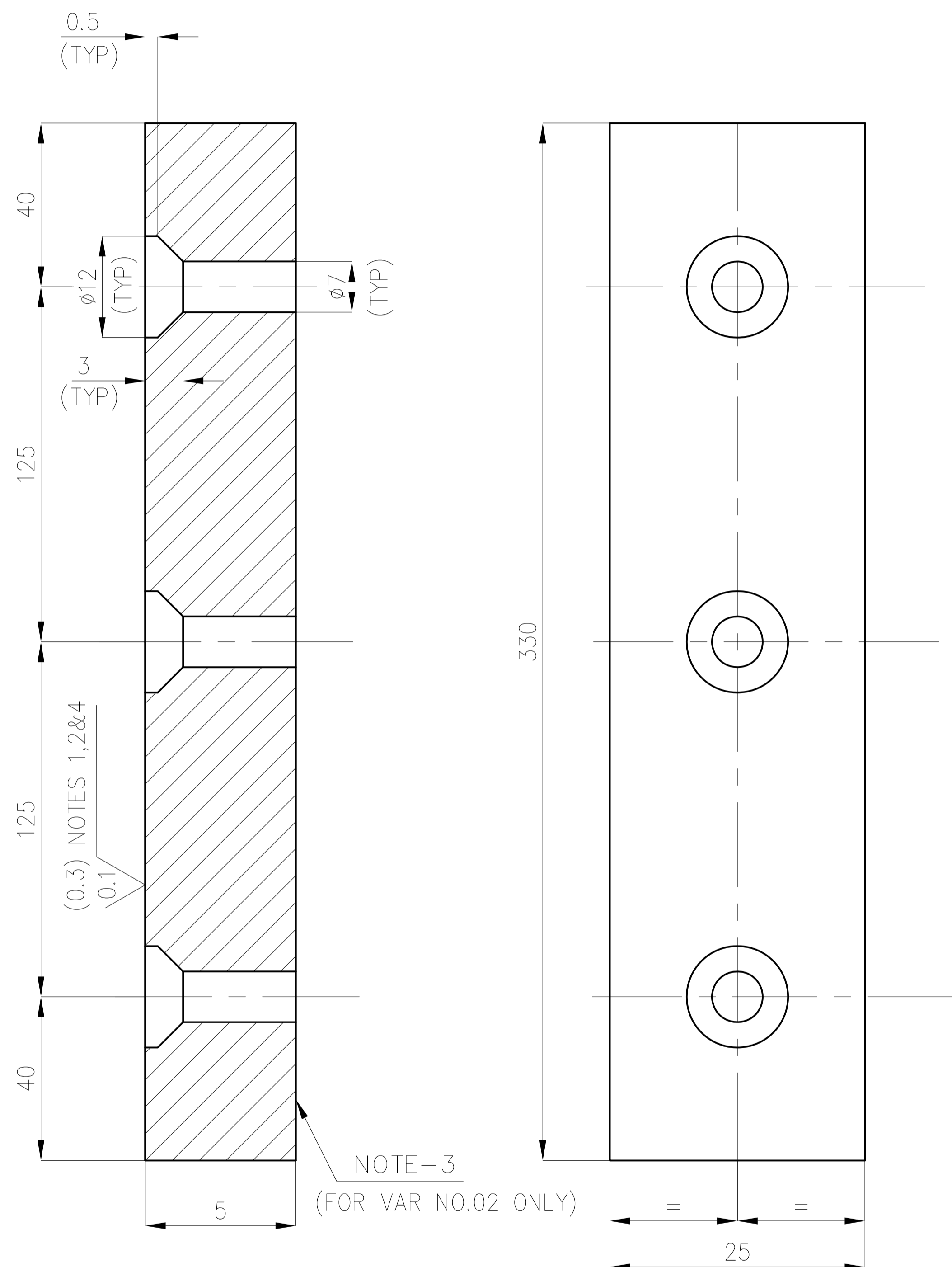
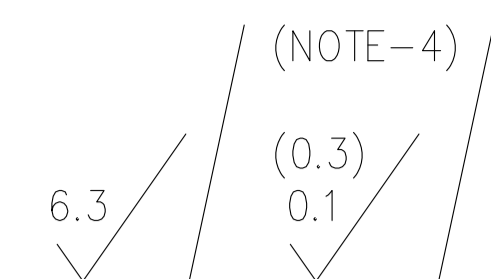

NOTES:-

- 01. THIS SURFACE SHOULD BE GROUND AND BUFFED TO MIRROR FINISH. NO TOOL MARK OR SCRATCH SHOULD BE VISIBLE WHEN VIEWED THROUGH MAGNIFICATION LENSE.
- 02. PROTECT THIS SURFACE WITH PLASTIPEEL OR EQUIVALENT.
- 03. PUNCH MARK HERE AS "SS" FOR STAINLESS PLATES. THIS IS FOR IDENTIFICATION AND TO AVOID MIX UP. CARE MUST BE EXERCISED WHILE PUNCHING SUCH THAT
 - a) POLISHED SURFACE SHOULD NOT BE AFFECTED,
 - b) PUNCH MARK SHOULD NEVER BE DONE ON POLISHED SURFACE.

- 04. $\sqrt{0.3}$ FINISH IS TO BE MAINTAINED FOR CARBON STEEL (VAR No.01)
- $\sqrt{0.1}$ FINISH IS TO BE MAINTAINED FOR STAINLESS STEEL (VAR No.02)

VAR NO.	ITEM NO.	DESCRIPTION	DRAWING NO.	ITEM NO.	MATERIAL CODE	A/C	UNIT WT.
				VAR NO.	MATERIAL SPEC.	C	QTY.
02	-	PLATE 6 THK 25 x 330	3-80-399-31103	02	15 011 206 0000 SA 240 TY304	C	0 300 1
01	-	PLATE 6 THK 25 X 330	3-80-399-31103	01	15 011 092 0000 IS 2062 Fe410A	C	0 300 1

TYPE OF PRODUCT
OR NAME OF
CUSTOMER/PROJECT

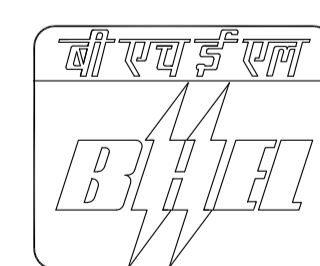

BHARAT HEAVY ELECTRICALS LTD.,
PIPING CENTRE,
CHENNAI 600 017

DRN	NAME	SIGN	DATE	NO OF ITEMS
CHD	BAHADUR S B	-sd-	21.11.13	
APPD	SARAVANAN C	-sd-	21.11.13	
	K V RAMANI	-sd-	21.11.13	

REV	DATE	ALTERED	DEPT.	GRADE OF UN TOL. DIM	SCALE	WEIGHT (Kg).	REF TO ASSY / OLD DRG	ITEM No.
01		APPROVED		C/M/F	NTS	0.600	-	
ZONE								
TITLE							CARD CODE	REV
TARGET PLATE (NB 300)							U 01	00
							DRAWING No.	
							3-80-399-31103	