

**Ref:** BHE/PW/PUR/WNT2-CVL/1663/Corr-03

Date: 23/09/2016

-----Page 1 of 1-----

To

ALL BIDDERS

**Sub:** Corrigendum-03: Issue of Revised Jack well Pump House Mechanical GA and Time Extension

**Job:** DESIGN ,ENGINEERING, PROCUREMENT, CONSTRUCTION OF COMPLETE CIVIL, STRUCTURAL AND ARCHITECTURAL WORKS OF RIVER WATER INTAKE WELL CUM PUMP HOUSE, APPROACH BRIDGE AT MAHI RIVER, AND OTHER ASSOCIATED WORKS FOR 1 X 800 MW WANAKBORI

**Tender Specification Nos:** BHE/PW/PUR/WNT2-CVL/1663

Bidders to kindly take note of the following:

**AA) ISSUE OF REVISED JACK WELL PUMP HOUSE MECHANICAL GA:**

Bidders to kindly Note that the BHEL Drawing No PE-DG-408-172-N004 for Jack Well Pump House Mechanical GA has been Revised and has been attached here for reference. This drawing will supersede the earlier GA drawing no PE-DG-408-172-N004 (Rev-01) of Vol-IE-1- Technical Specifications & Drawings.

**BB) Extension of Last Date for Tender Submission:**

The last date for submission of Tender has been re-scheduled to 06/10/2016, 15.00 hrs. Technical Bid shall be opened on 06/10/2016 at 16.00 hrs.

=====

All other Terms and conditions of the Tender Specification shall remain unaltered unless expressly amended by BHEL in writing.

Bidders are requested to submit as a part of their offer, a copy of this corrigendum duly digitally countersigned by the authorized signatory as a token of Bidder's unqualified acceptance of this corrigendum.

**BIDDERS MAY PLEASE NOTE THAT SUBJECT TENDER IS E-TENDER AND THE OFFER IS TO BE SUBMITTED ONLY IN [E-PROCUREMENT PORTAL https://bheleps.buyjunction](https://bheleps.buyjunction)**

**BIDDERS WHO HAVE ALREADY SUBMITTED THEIR OFFERS PRIOR TO ISSUANCE OF THIS CORRIGENDUM IN E-TENDER PORTAL ARE REQUIRED TO RE-SUBMIT THEIR OFFER AFTER TAKING COGNIZANCE OF THIS CORRIGENDUM.**

Thanking you,

Yours faithfully,

AGM (Purchase)

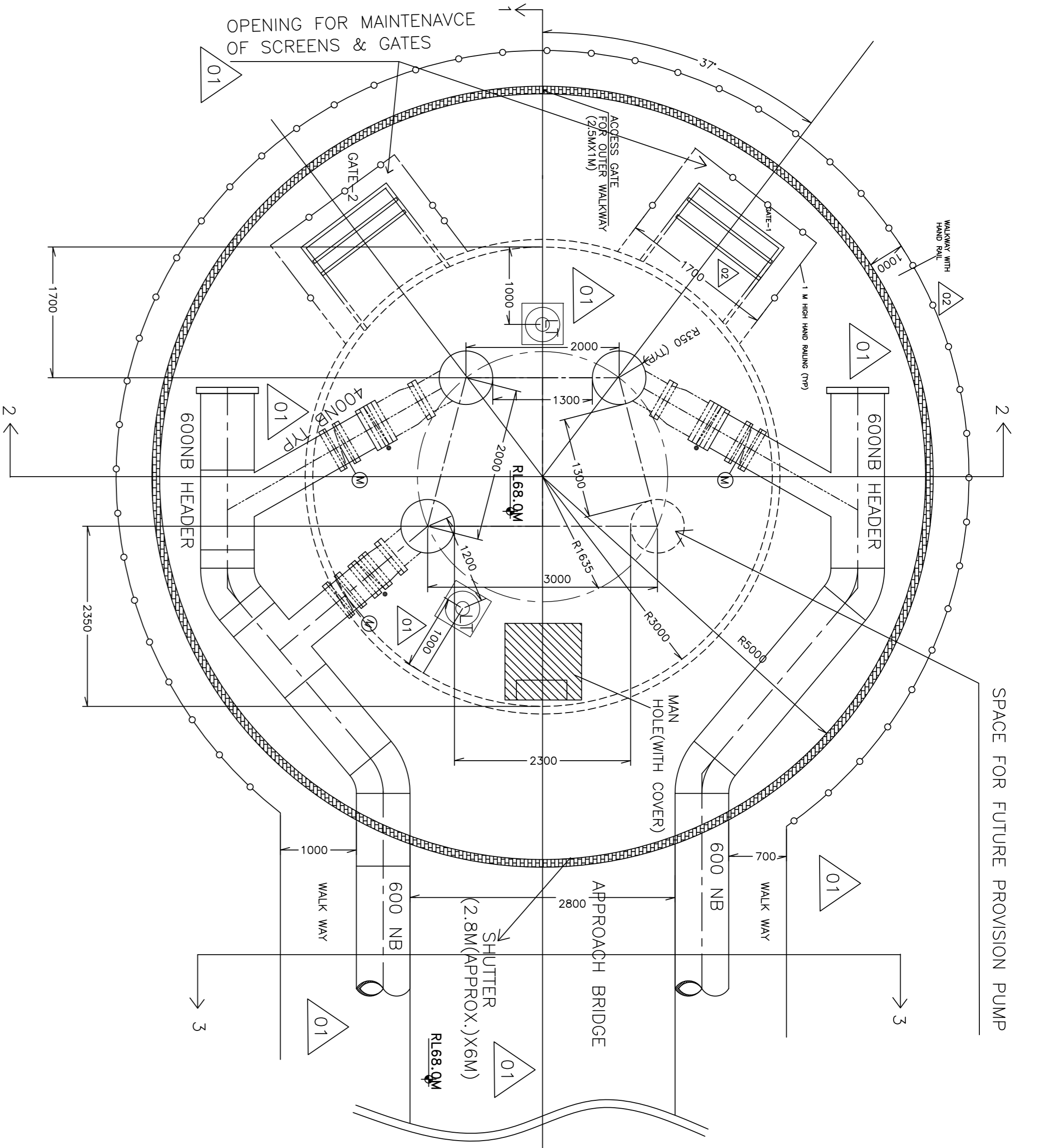

PLAN OF PUMP  
NOT TO SCALE

NOTES

01. INTAKE PUMPS DATA FOR INTAKE PUMP HOUSE SLUMP MODEL STUDY :  
PUMP FLOW : 1190 CUM/HR. (EACH PUMP).  
PUMP HEAD: 56 MWC(EACH PUMP).
02. PUMP BELL MOUTH DIAMETER : 500 MM (APPROX.)  
MINIMUM SUBMERGENCE OF PUMP (ELEVATION DIFFERENCE BETWEEN MIN WATER LEVEL AND BELL MOUTH LEVEL) : 2800 MM (APPROX.)  
STATIC LOAD OF PUMP & MOTOR: 11 TON (APPROX.)  
DYNAMIC LOAD OF PUMP & MOTOR : 17 TON (APPROX.)
03. ALL DIMENSIONS INDICATED ARE IN MILLIMETRES AND ELEVATIONS ARE IN METRES, UNLESS OTHERWISE SPECIFIED.
04. CONCRETE PLATFORM SHALL BE DESIGNED FOR OPERATING, HANDLING, UNLOADING AND TEMPORARY STORAGE OF STOP LOGS AND SCREENS.
05. OPENING FOR FUTURE PROVISION TO BE COVERED WITH REMOVABLE GRATING/CHECKER PLATE.
06. STOP LOG GATE MOC SHALL BE IS2062 & BAR SCREEN (25MMX25MM) MOC SHALL BE MS GALVANIZED
07. CRANE CAPACITY 10 TON, SPAN OF 7.6 METER, LIFT 42 M & TRAVEL OF 6.5 FOR MAINTENANCE & HANDLING OF PUMP AND MOTOR.
08. HOISTS OF CAPACITY 2 TON EACH SHALL BE PROVIDED FOR MAINTENANCE & HANDLING OF STOP LOG GATE & SCREENS.
09. ONE NO. 5 TON ELECTRIC HOIST/GANTRY CRANE ALONG THE BRIDGE WITH RAIL EXTENDED UPTO EOT CRANE APPROACH SHALL BE PROVIDED.
10. REFERENCE DRAWINGS:-  
GA DRAWING FOR EOT CRANE: PE-V0-408-524-A003  
HOIST DETAILS: PE-V0-408-553-A202  
STOP LOG GATE: PE-V0-408-655-C020  
SCREEN: PE-V0-408-655-C021  
SWITCHGEAR/MCC ROOM/CABLING DETAILS: PE-DG-408-100-E021

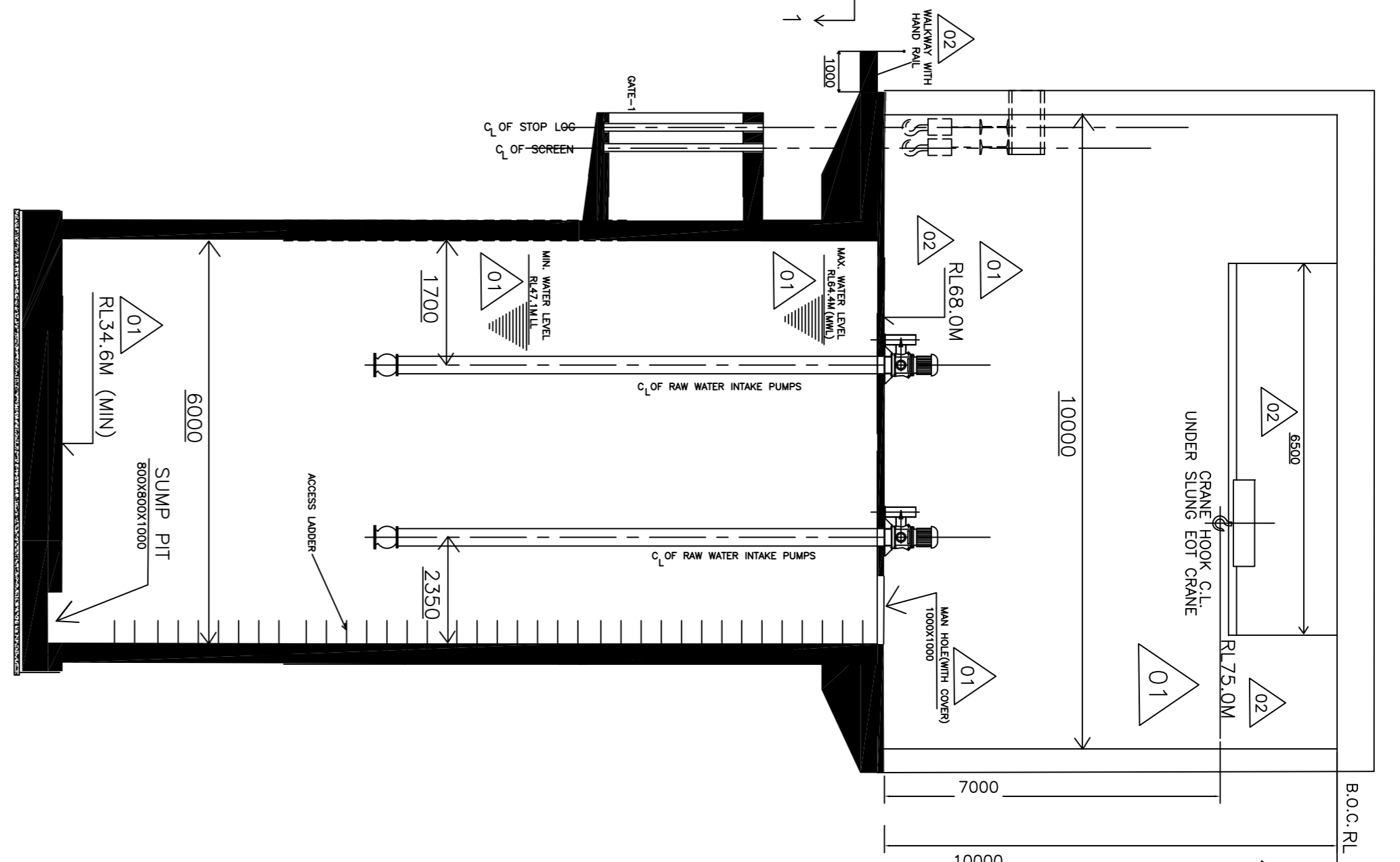

SECTION 1-1  
NOT TO SCALE

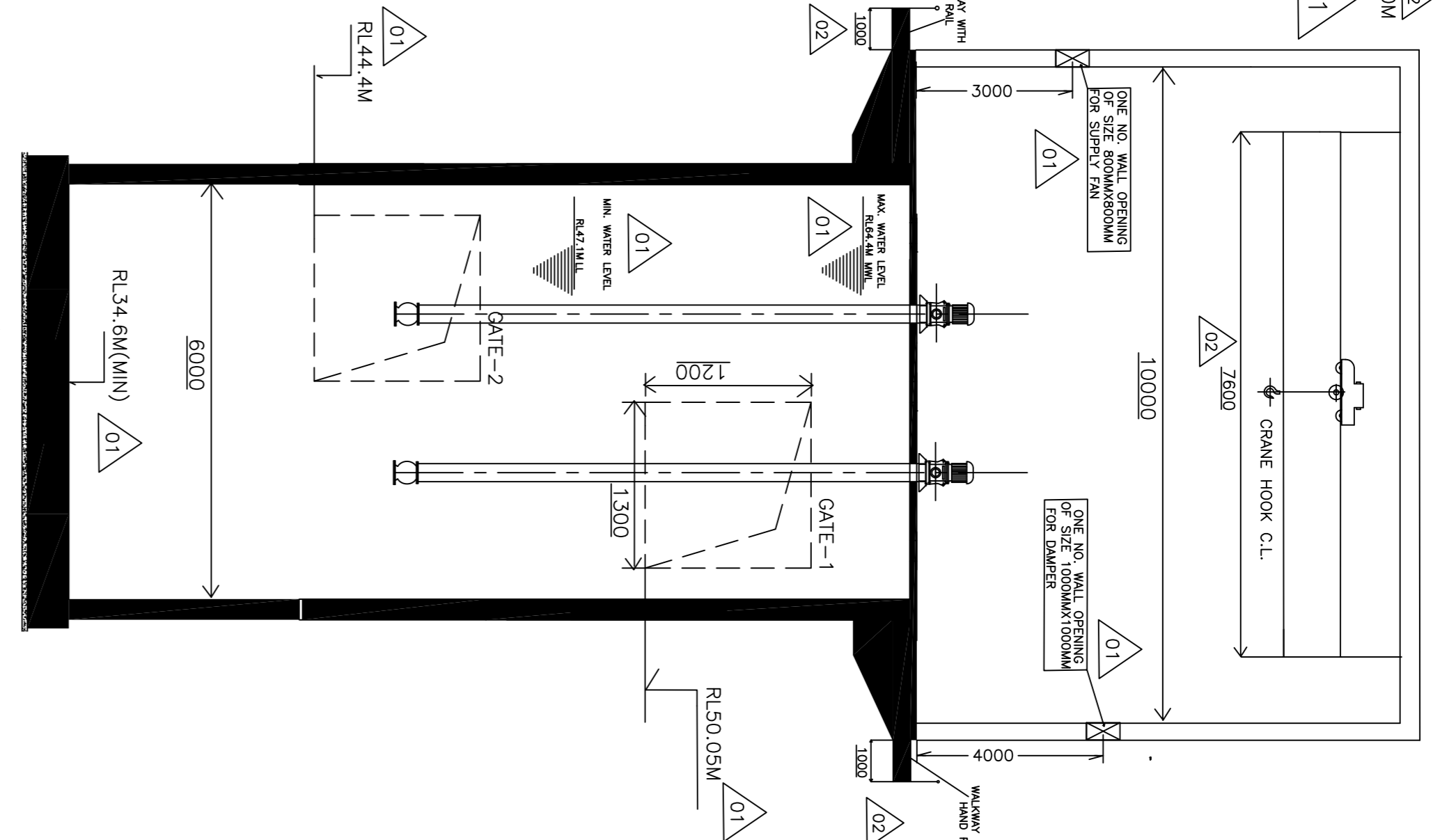

SECTION 2-2  
NOT TO SCALE

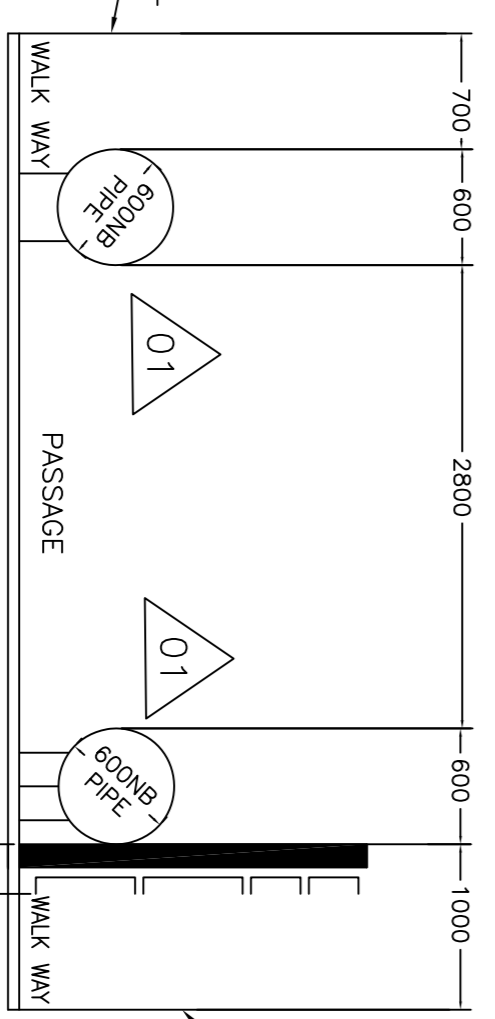

SECTION 3-3

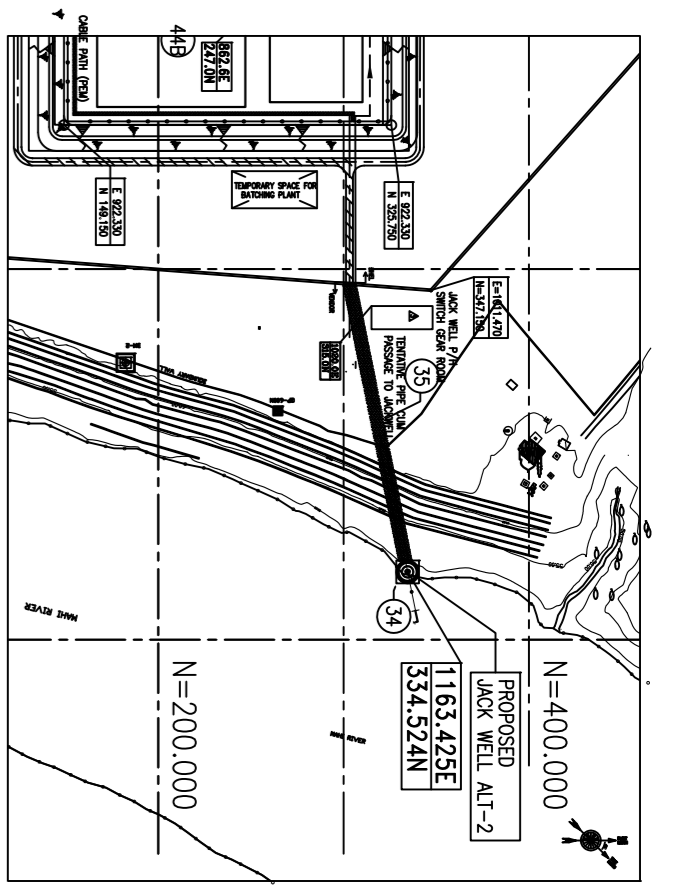
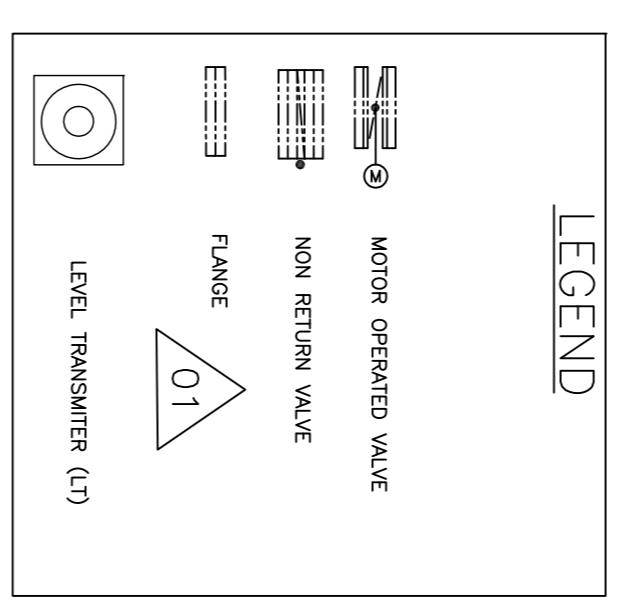
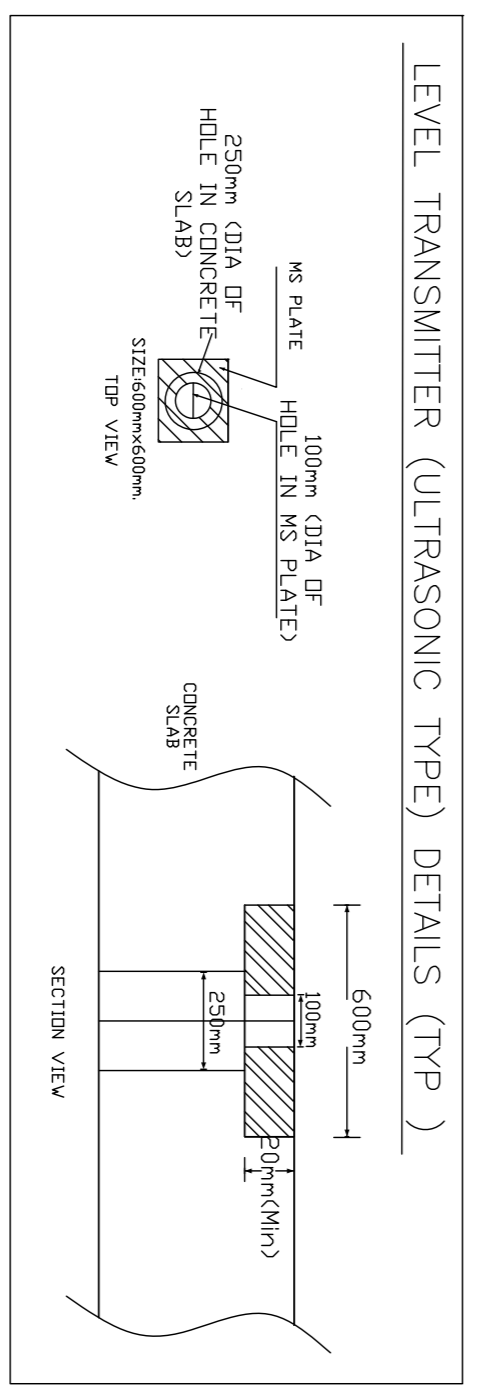

GUARANT STATE ELECTRICITY CORPORATION LIMITED VADODARA, GUJARAT 14800 MW Wambhoi Thermal Power Station Etn. Unit-8		BHARAT HEAVY ELECTRICALS LTD. KOLKATA, MUMBAI, CHENNAI, NEW DELHI	
DEVELOPMENT CONSULTANTS PVT. LTD. CONSULTING ENGINEERS		BHARAT HEAVY ELECTRICALS LTD. CONSULTING ENGINEERS	
TITLE : JACQUELL PUMP HOUSE MECHANICAL GA	DATE : 02/07/15	DATE : 02/07/15	DATE : 02/07/15
PREPARED BY : MR. J. K. PATIL	CHECKED BY : MR. J. K. PATIL	DATE : 02/07/15	DATE : 02/07/15
APPROVED BY : MR. J. K. PATIL	APPROVED BY : MR. J. K. PATIL	DATE : 02/07/15	DATE : 02/07/15