

Ref: BHE/PW/PUR/MANUT-CVL (Levelling & Grading)/1446/Corrigendum-04 Date 04/05/2015

-----Page 1 of 1-----
To

ALL BIDDERS

Sub: Corrigendum-04: Clarification and Drawings

JOB: Leveling, Grading and Road Work up to Water Bound Macadam Level including Excavation, Backfilling, filling with borrowed soil and/or Morrum, disposal of unserviceable earth and all associated works, complete as per specification of entire Plant Area at 4x270 MW Bhadradri TPS, Manuguru Telangana state.

Tender Specification Number: BHE/PW/PUR/MANUT-CVL (Levelling & Grading)/1446

Bidders to kindly take note of the following:

=====

AA) Clarification:

Sl. No.	Bidder's query	BHEL's clarification
1	Please provide the status of land acquisition and position of land available with BHEL	TSGENCO (Customer) has acquired
2	Kindly provide us with contour maps and finished grading level	Attached with this corrigendum

BB) Drawings

Drawings and Construction Plan are attached with this corrigendum.

=====

All other Terms and conditions of the Tender Specification shall remain unaltered unless expressly amended by BHEL in writing.

Bidders are requested to submit as a part of Technical Bid, a copy of this corrigendum duly countersigned by the authorized signatory and stamped with the Official seal as a token of Bidder's unqualified acceptance of this corrigendum.

This letter is hosted as file titled "Corrigendum-04 (Clarification - 1446)" against NIT-22261 in BHEL web page (www.bhel.com→Tender Notifications → View Corrigendum).

Thanking you,

Yours faithfully,

AGM (Purchase)

Encl: Drawings

Construction Plan for works to be completed BEFORE MONSOON in order to ensure continuous works during Monsoon period by main civil/mechanical agencies:

Following work plan shall be followed in order to completed priority area works before monsoon.

Ref Document: Sketch no LG-1, Leveling-Grading drawing & contour drawing

1. The Road R1 (7 Mtr + 2 x 1.5 Mtr= 10 Mtr Total Width) shall be developed first as per existing contours at elevation RL 74.25 M / RL 71.25 M (Refer drawing of leveling & Grading).
2. The shaded area as per enclosed sketch contains **MAIN POWER BLOCK AREA** which needs to be developed so that further construction works can be carried out even during monsoon. Part of this area (hatched area) shall be cut up to a depth of approx.. 2.5 Mtr (1 Mtr below RL as per drawing of leveling and grading) and a smaller area (double hatched) would be cut up to a depth of approx.. 1 Mtr (1 Mtr below RL as per drawing of leveling and grading). Refer sketch LG-1 and contour drawing for better clarity for cutting and filling.
3. Subsequently, the entire area (**MAIN POWER BLOCK AREA**) shall be filled with soil obtained from Borrow Pit free from any external impurities such as organic matter/vegetation/clay lumps etc up to a height of 700mm with each layer not exceeding 300 mm in loose thickness. The area shall be compacted up to 95% of Modified proctor density.
4. Thereafter, upon completion of 700 mm height filling; the entire area (**MAIN POWER BLOCK AREA**) shall be filled with 300 mm depth (compacted depth) good quality Murram approved by BHEL Engineer.
5. The Road R2/R3/R4/R5/R6 surrounding the MAIN POWER BLOCK AREA shall be developed at an elevation of RL 69.25 M.
6. The roads surrounding the MAIN POWER BLOCK AREA shall be developed concurrently with the development of enclosed area in a manner such that entire works is completed before onset of Monsoon Period.

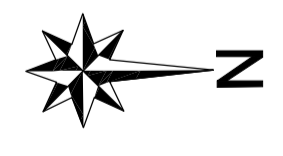

0.5km. Approx



Legend	
Open Boundary Line	
Boundary / Shed	
Road	
Ground Level	
Contour	
Electric Post (with line)	
Tripole	
Telephone Pole	
Cart Track	
Fencing	

ADVANCE COPY

- Drawing Orientation and Grid System in GPS UTM / WGS84
- All Dimensions & Levels Are in Meters
- Contour Interval 10.00m
- Contour Interval 0.50m
- Contour Interval 0.25m

Topographical Survey Plan of Proposed 4x270 MW Thermal Power Project Site At Vill. Chikidugurama, Manguru, Dist. Khammam, Telangana State For Bharat Heavy Electricals Ltd.

Nagadi Consultants Pvt. Ltd.
106/1D, Kishanpeth Vasant Kunj New Delhi-110070
Tele/Fax: 011-26891980, 26897403

Scale: 1:500
Date: 28-11-2013
ASB/ENR/157/01

COPY RIGHT AND CONFIDENTIAL
 The information on this document is the property of BHARAT HEAVY ELECTRICALS LIMITED
 It must not be used directly or indirectly in any way detrimental to the interest of the company.

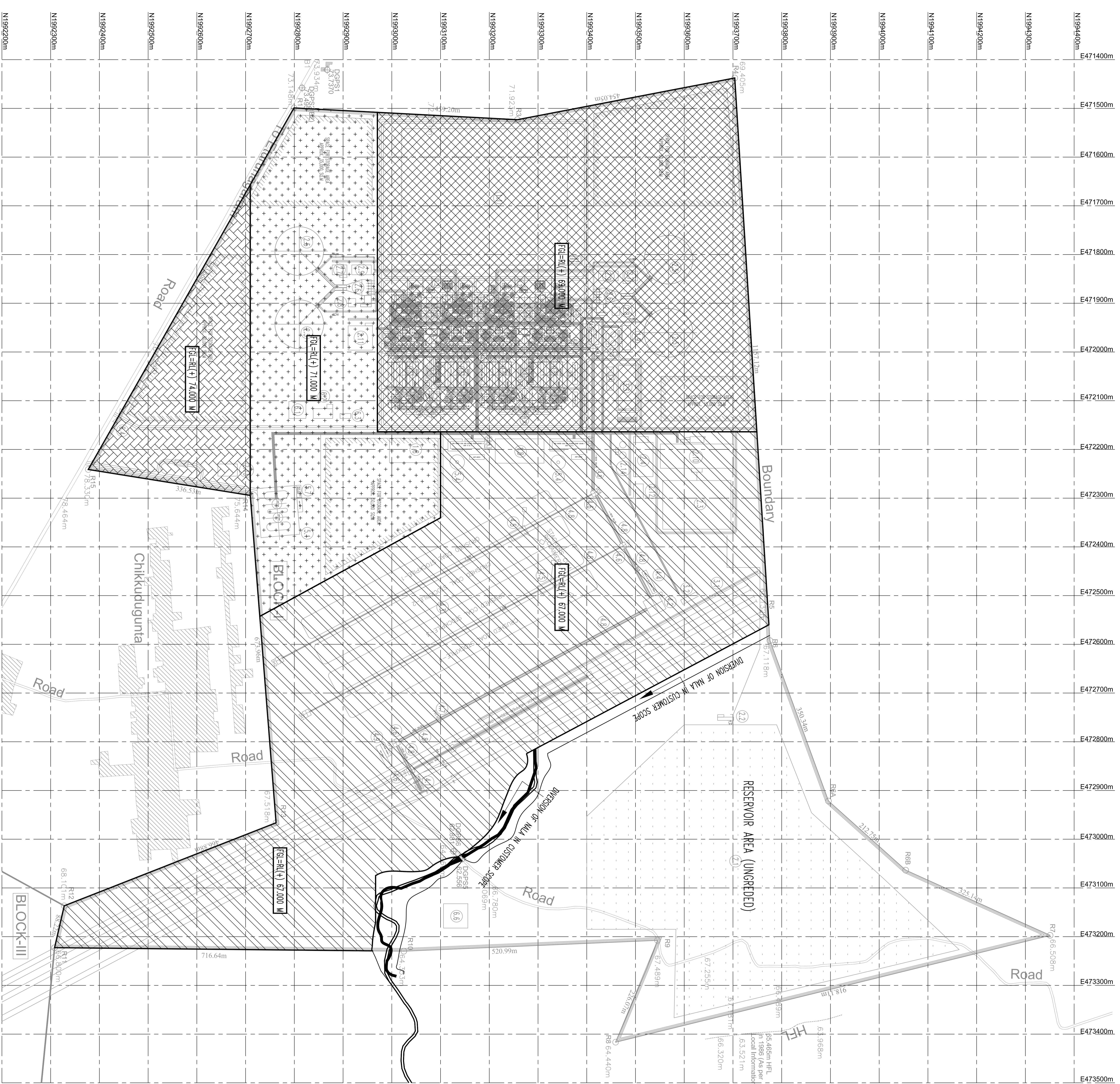

LEGEND (For BHEL Scope) :-

-  AREA OF GRADING WITH FINISHED LEVEL R.L. (+)67.000 M
-  AREA OF GRADING WITH FINISHED LEVEL R.L. (+)69.000 M
-  AREA OF GRADING WITH FINISHED LEVEL R.L. (+)71.000 M
-  AREA OF GRADING WITH FINISHED LEVEL R.L. (+)74.000 M

REF. DRG. :
 DRAWING NO. PE-DG-411-100-M001 TITLED "PILOT PLAN".

AREA GRADING PLAN FOR BHEL SCOPE

FOR TENDER PURPOSED ONLY

CUSTOMER		TSGENCO	
CUSTOMER'S CONSULTANT			
JOB No.	411		
STATUS	CONTRACT		
DISTRIBUTION			
REV	DATE	AUTH	CHKD
TITLE		GRADING PLAN	
PROJECT		BHARAT HEAVY ELECTRICALS LTD	
PRODUCT		POWER SECTION MANAGEMENT	
SHEET		C	
DRAWING No.		PE-DG-411-603-TI	
SCALE		AS SHOWN	
DATE			
SHEET		1 OF 1	
REV		00	

Boun

1157.12m

69.405m
R4

454.05m

71.923m
R3

459.20m
72.251m

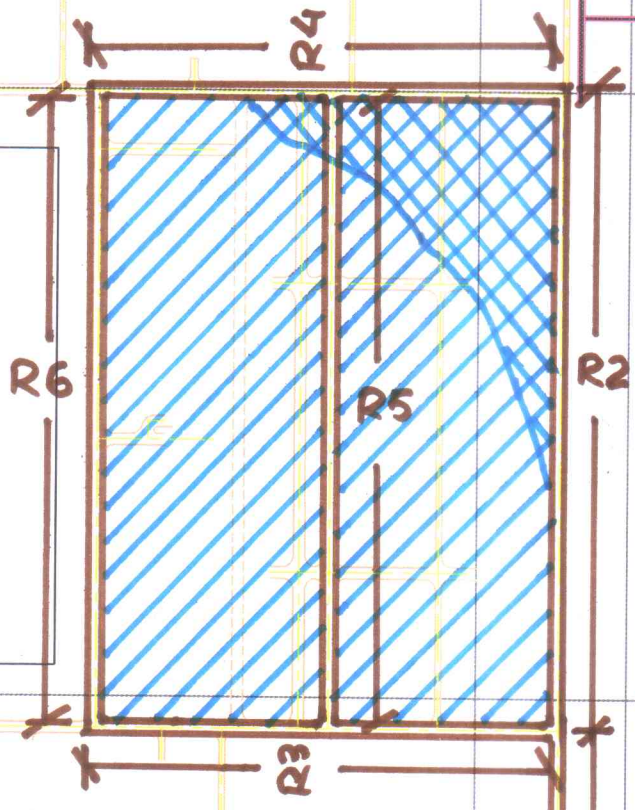

DGPS1
73.7370

73.934m
B1

DGPS2 (B2)
73.499

R1
73.148m

To Eturunagaraan

853.66m

Road

76.325m

R1

336.53m

R15
78.330