



Bharat Heavy Electricals Limited

Centralised Stamping Unit, Jagdishpur

Tender No.:- TE/630730001/C-46

Date: 01/08/2013

TENDER NOTICE

Sealed Tenders are invited in Single-part bid system for **Portable Shop Cabins** as per below details:

A. General:

- **SUBMISSION OF TENDER** : **TILL 14.30 HRS. 22/08/2013**
- **OPENING OF TECHNO-COMMERCIAL BID** : **AT 1500 HRS. ON 22/08/2013**
- Bids can be deposited in the Tender Box kept at

**Office of AGM-MM
Administrative Building,
Fabrication Plant
Bharat Heavy Electricals Ltd.
Industrial Area Jagdishpur
Dist. Sultanpur-227817, UP.**

- **Instruction/procedure for submission of bids**

The offer is to be submitted by the vendors in Two-parts in sealed envelop as per following details:

1. **Envelop-1: Techno-commercial Bid:** On the top of this envelop, vendor to write "Techno-Commercial Bid", Tender Enquiry No. & Date, Due date of opening. This envelop should contain following documents:
 - i. Tender Enquiry duly signed with stamp on each page as a token of acceptance of all terms and conditions.
 - ii. Un-priced copy of Price bid.
 - iii. Covering Letter on company's Letter Head giving index interlinking all the documents with all the pages signed and stamped, contact person's details like Name, Contact No., Email Address, Contact Address, etc.
 - iv. Copy of PAN, Certificate of registration and allotment of TIN, STC, etc.
2. **Envelop-2: Price Bid:** On the top of this envelop, vendor to write "Price Bid", Tender Enquiry No. & Date, Due date of opening. This envelop should contain following documents:
 - i. Priced Copy of Price Bid. No terms and conditions should be mentioned in Price Bid.

ENVELOP -1 & 2 should be sealed in a bid envelop. Vendor to write Tender Enquiry No. & Date, Due date of opening, complete mailing address of the vendor.

3. Offers with deviations from terms and conditions & specification of the tender may not be considered.
4. BHEL takes no responsibility for any delay / loss of documents or correspondence sent by courier or post.
5. BHEL reserves the right to accept or reject any of the bid / all bids with or without deviation, or cancel / withdraw the invitation for bid without assigning any reason whatsoever and in such case no bidder shall have any claim arising out of such action by BHEL.
6. Duly completed offers should reach following address on or before due date and time. to
7. In case you are not quoting, please send your regret letter positively for our reference.
8. Tender received after the specified time of their "SUBMISSION" will be treated as "late tender" and shall not be considered under any circumstances.
9. Supplier shall quote for all the items in the enclosed price bid format only.

Upmull
01/08/2013



Bharat Heavy Electricals Limited

Centralised Stamping Unit, Jagdishpur

The tender document consists of following sections:

Section – 1: Techno-Commercial bid which consists of followings:

- A. Item Description
- B. Technical Specification
- C. Commercial requirement
- D. Special Instructions
- E. Un-priced Bid Format

Section – 2: Price bid format

SECTION-1

A. ITEM DESCRIPTION

| SL. NO. | ITEM DESCRIPTION | UNIT | QTY. REQD. |
|---------|--|------|------------|
| 1. | Portable Shop Cabins as per Annexure-A | Nos. | 5 |

B. TECHNICAL CONDITIONS:

| S. No. | Description | Required |
|--------|--------------------------|--|
| 1. | Delivery Schedule | 4 weeks from date of LOI/P.O. Earlier delivery schedule is also acceptable. |
| 2. | Pre –dispatch Inspection | BHEL Engineer/Inspector will inspect the Cabins at supplier's works. The Supplier shall give the Engineer/ Inspector 21 day's written notice of Equipment being ready for testing. |
| 3. | Guarantee Certificate | Guarantee of the Cabins shall be provided by the vendor for 1 year against manufacturing defects and defective materials from the date of acceptance at BHEL. |

C. COMMERCIAL CONDITIONS:

| | | |
|-----|--------------------------|--|
| 1. | Transportation | Deliveries shall be FOR BHEL, CSU, Jagdishpur. |
| 2. | Insurance | Insurance shall be arranged by vendor. |
| 3. | Price | The basic prices shall be firm. All taxes & duties to be specified specifically. Supplier shall quote for all the items in the enclosed price bid format only. |
| 4. | Evaluation | On the basis of landed cost to BHEL, CSU Stores, Jagdishpur inclusive of loading, if any |
| 5. | Terms of Payment | 100% payment within 45 days after successful acceptance of items at BHEL CSU, Jagdishpur. Payment shall be done through E-payment. |
| 6. | Validity of offer | Offer validity will be for 90 days from date of opening of Tender enquiry. |
| 7. | Penalty for Delay | The delivery of material shall be made within the time prescribed. Failure to deliver the material in time as per the delivery specified above would make the vendor liable to an un-conditional penalty at the rate of half percent (1/2%) of the basic value of delayed item per week (or part thereof) subjected to a maximum of ten percent (10%). |
| 8. | Rejections | The supplier shall arrange replacement/repair within one month from the date of rejection intimation upon failure on supplier's part to comply. BHEL will take whatever appropriate action they may think fit in addition to repair/return of rejected material at the cost and risk of the supplier. |
| 9. | Risk purchase | In case of delays in supply of materials/defective materials not fulfillment of any other terms and conditions given in the purchase order, the purchase may cancel the full or part thereof, and may also make purchase of such material from elsewhere/alternate source at the risk and cost of supplier. |
| 10. | Arbitration | Any dispute arising out of this contract shall be referred to the sole arbitration |

Handwritten signature and date: 01/08/2013



Bharat Heavy Electricals Limited

Centralised Stamping Unit, Jagdishpur

| | | |
|-----|------------------------|--|
| | | of GM- CSU & FP, BHEL, Jagdishpur. Its award shall be final and binding on the parties. The venue of arbitration in all cases shall be at Administrative building, BHEL, FP, Jagdishpur. |
| 11. | Jurisdiction | In case of any suit or other legal proceedings arising under or relating to the contract, the Jurisdiction of Sultanpur (UP) district court shall apply. |
| 12. | Consignee | The Stores Officer, CSU, BHEL, IA Jagdishpur, Dist.-Sultanpur-227817 (UP) |
| 13. | Billing Address | The Purchase officer, CSU&FP, BHEL, IA Jagdishpur, Dist.-Sultanpur-227817 (UP) |
| 14. | Documentation | One set of all required documents (ink signed) must accompany the supply and one set (Ink-Signed) to be sent to Purchase officer before the dispatch. |

D. SPECIAL INSTRUCTION:

| |
|---|
| 1. All taxes/duties/levies etc. must be specified separately in amount or in percentage. Incomplete offer shall not be acceptable. |
| 2. Duly filled & signed with company seal on all documents to be submitted along with offer. |
| 3. Please quote price in figures & words both. In case the prices quoted in words and figures are different, the value indicated in words will be considered for evaluation and establishing L1 status. |

E. UN-PRICE BID

Offer No. :

Tender No. :

| Sl. No. | Item description | Unit | Qty. | Price, Ex-Works | | Excise Duty | Sales tax/VAT | Freight Charges | Any other charges | FOR Price |
|---------------------------|--|------|------|-----------------|-------------|-------------|---------------|-----------------|-------------------|-----------|
| | | | | Unit Rate | Total Price | | | | | |
| Supply of following item: | | | | | | | | | | |
| 1. | Portable Shop Cabins as per Annexure-A | Nos. | 5 | | | | | | | |
| | | | | | | @ % | @ % | | | |

Note:

1. Applicable rates of Taxes & duties (all in percentage) are to be mentioned.
2. Please fill all the columns. Write "QUOTED" in the columns where rates are quoted in the Priced copy of Price Bid. No cell should be left blank.

Chandra
01/08/2013

Seal and Sign of Bidder



Bharat Heavy Electricals Limited
Centralised Stamping Unit, Jagdishpur

SECTION-2

PRICE BID

(To be submitted on Vendor's Letter Head)

Offer No. :
Tender No. :

| Sl. No. | Item description | Unit | Qty. | Price, Ex-Works | | Excise Duty | Sales tax/VAT | Freight Charges | Any other charges | FOR Price | |
|---------------------------|--|------|------|-----------------|-------------|-------------|---------------|-----------------|-------------------|-------------|--|
| | | | | Unit Rate | Total Price | | | | | | |
| | | | a | b | c=axb | d (on c) | e (on c+d) | f | g | h=c+d+e+f+g | |
| Supply of following item: | | | | | | | | | | | |
| 2. | Portable Shop Cabins as per Annexure-A | Nos. | 5 | | | | | | | | |
| | | | | | | @ _____ % | @ _____ % | | | | |
| GRAND TOTAL (in Value): | | | | | | | | | | | |
| GRAND TOTAL (in Words): | | | | | | | | | | | |

Note:

3. Applicable rates of Taxes & duties (all in percentage) are to be mentioned.
4. Please fill all the columns. Write NA if not applicable, Inclusive if the taxes, freight, etc. are inclusive in basic price. No cell should be left blank.
5. Evaluation: On the basis of landed cost to BHEL, CSU Stores, Jagdishpur inclusive of loading, if any.

Seal and Sign of Bidder



01/08/2013

Technical Specification for Shop Cabins,

Annexure-A

| Sr.No. | Components | Description |
|--------|-------------------------|---|
| 1 | Bottom Frame | 100mm X 50mm "C" channel |
| 2 | Top Frame | 50mm X 50mm MS Sq. Pipe |
| 3 | Stiffener Bottom | 75X40mm "C" channel |
| 4 | Stiffener Top | 40X20mm MS Sq. Pipe |
| 5 | Side Post | Specially formed 1.2mm C.R.C. Post Section-18 swg |
| 6 | Side wall Stiffners | Specially formed 1.2mm C.R.C. Post Section-18 swg |
| 7 | Panelling outside wall | Specially C.R.C. Sheet 1.2mm thick |
| 8 | Internal Wall Panelling | 8mm MDF OSL Sheet |
| 9 | Roof Outside | Specially C.R.C. Sheet 0.6mm thick miner sloped (3" in 8ft. Length) |
| 10 | Bottom Flooring | Vinyl Carpet |
| 11 | Aluminium Windows | Double Shutter Sliding aluminium Powder coated windows 2 mm thick polycarbonate sheet with Safety Grills |
| 12 | Door | Hold drafts and handles |
| 13 | Wiring | All wiring shall be concelead type & shall be of PVC insulated copper wire |
| 14 | Electrical Fittings | All electrical fittings in the portable Cabin shall be 220-240 V, AC 50 Hz Tubes, Door light, Fan, Switches, Sockets, Telephone point |
| 15 | Earthing | Earthing point shall be provided for seftey |
| 16 | Outside Painting | Phosphet the cabin and painting with coat of epoxy primer with two coat of epoxy paint. |
| 17 | Legs | 5 inch height, four legs at all four corners. |
| 18 | hooks | Specially formed hooks for easy lifting and shifting |

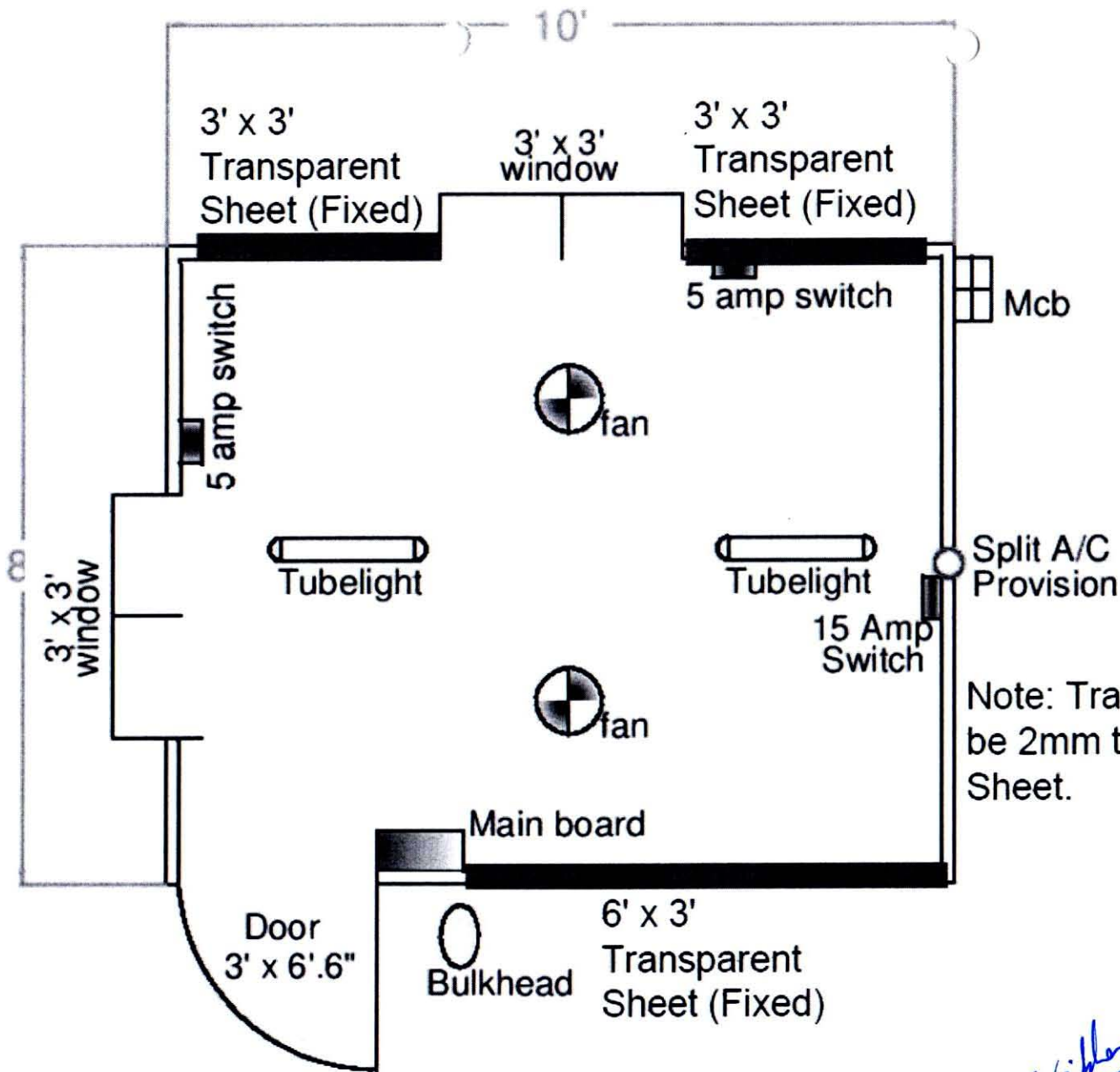
Vidha



Note: Transparent Sheet shall be 2mm thick Polycarbonate Sheet.

Vaibhav

L10' x W8' x H8'.6" Cabin