

020-6150-5349 RDDC NO. DRG. NO.

FIRST ANGLE PROJECTION

(ALL DIMENSIONS ARE IN mm)

(~1.6)

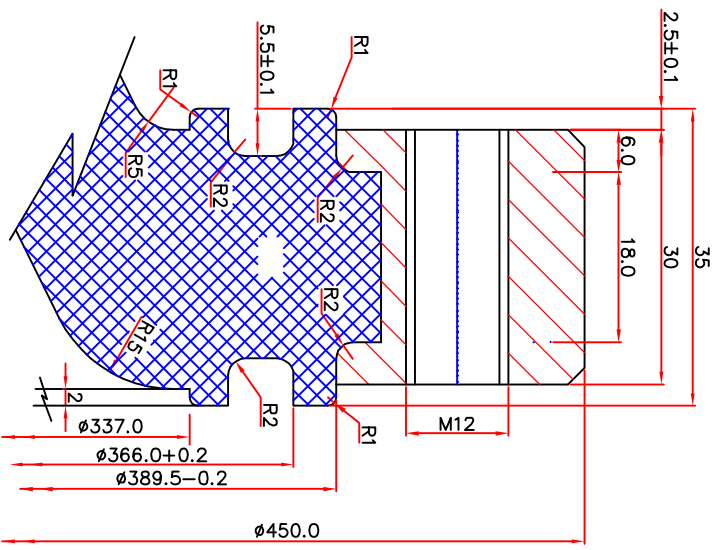
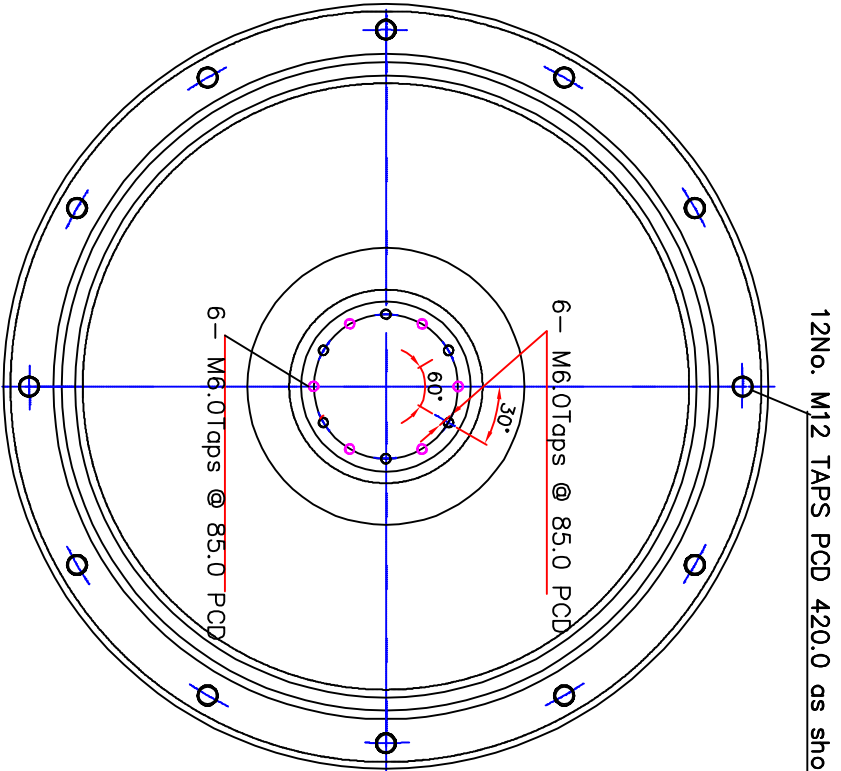
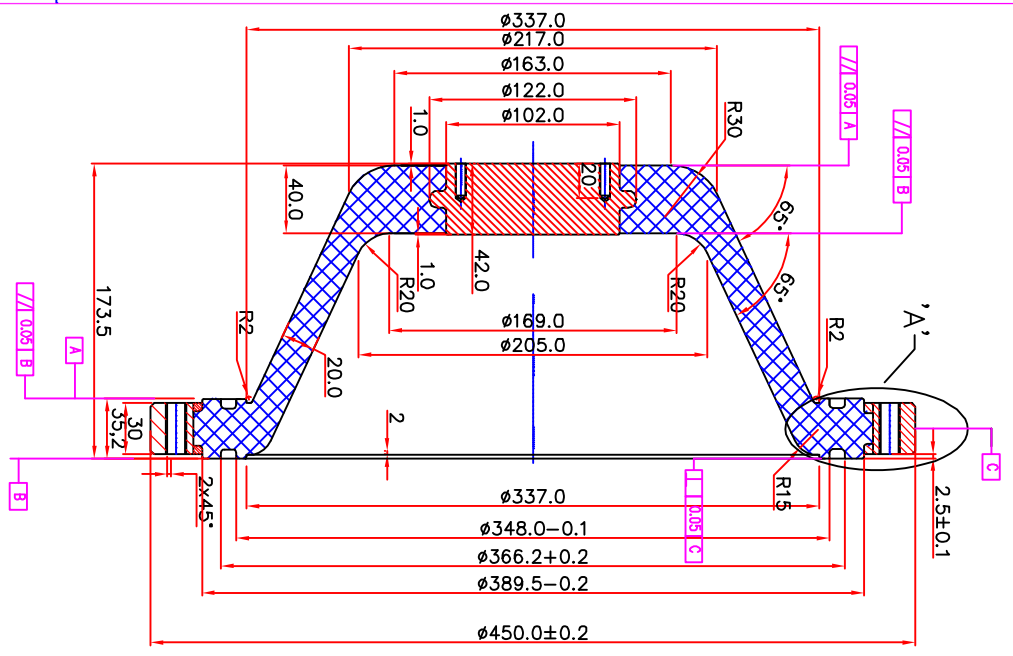

ENLARGED VIEW 'A'

1. MOULD INNER SURFACE SHALL BE GROUNDED TO RA0.6
2. MOULD INNER SURFACE SHALL BE PLATED SUITABLY FOR SMOOTH SURFACE OF INSULATORS
3. FINISHED INSULATOR SHALL BE IN ITS NATURAL COLOUR.
4. O-RING GROOVE DIMENSIONS SHALL BE AS PER DRAWING
5. INSULATOR SHALL BE PROCESSED SUCH THAT THERE SHALL BE NO GAS LEAKAGE THROUGH LT AND HT INSERTS.

VAR. NO.	REMARKS	VAR. NO.	ITEM NO.	DESCRIPTION	DRAWING NO.	IT. NO.	MATL. CODE	UNIT	WT.	QTY.	ZONE
03	EPOXY BODY			RDDG435-0519-020			EPOXY BODY		01		
02	LT INSERT			RDDG435-0519-021			HE-30		01		
01	HT INSERT			RDDG435-0519-022			ETP COPPER		01		

TYPE OF PRODUCT: **GSM-245**
 NAME OF CUSTOMER: **BHARAT HEAVY ELECTRICALS LTD. HYDERABAD**

DEPT. CODE: **NTS**
 SCALE: **1:1**
 WEIGHT(KG): **1**

REV.	DATE	ALTERED CHECKED	REV.	DATE	ALTERED CHECKED
01	25.04.13				

INVENTORY NO. SIGN. AND DATE REF. DRG. NO.

REV.	DATE	ALTERED CHECKED	REV.	DATE	ALTERED CHECKED

CONE INSULATOR ASSY
 SHEET NO. NO. OF SHEETS