

THE INFORMATION ON THIS DOCUMENT IS THE PROPERTY OF BHARAT HEAVY ELECTRICALS LIMITED. IT MUST NOT BE USED DIRECTLY OR INDIRECTLY IN ANY WAY DETRIMENTAL TO THE INTEREST OF THE COMPANY

GENERAL DIMENSIONAL LIMITS/FITS & TOLERANCES AS PER HY0230261

INVENTORY NO	SIGN AND DATE	REF	DRG NO	COMPUTER FILE NAME
1-134				

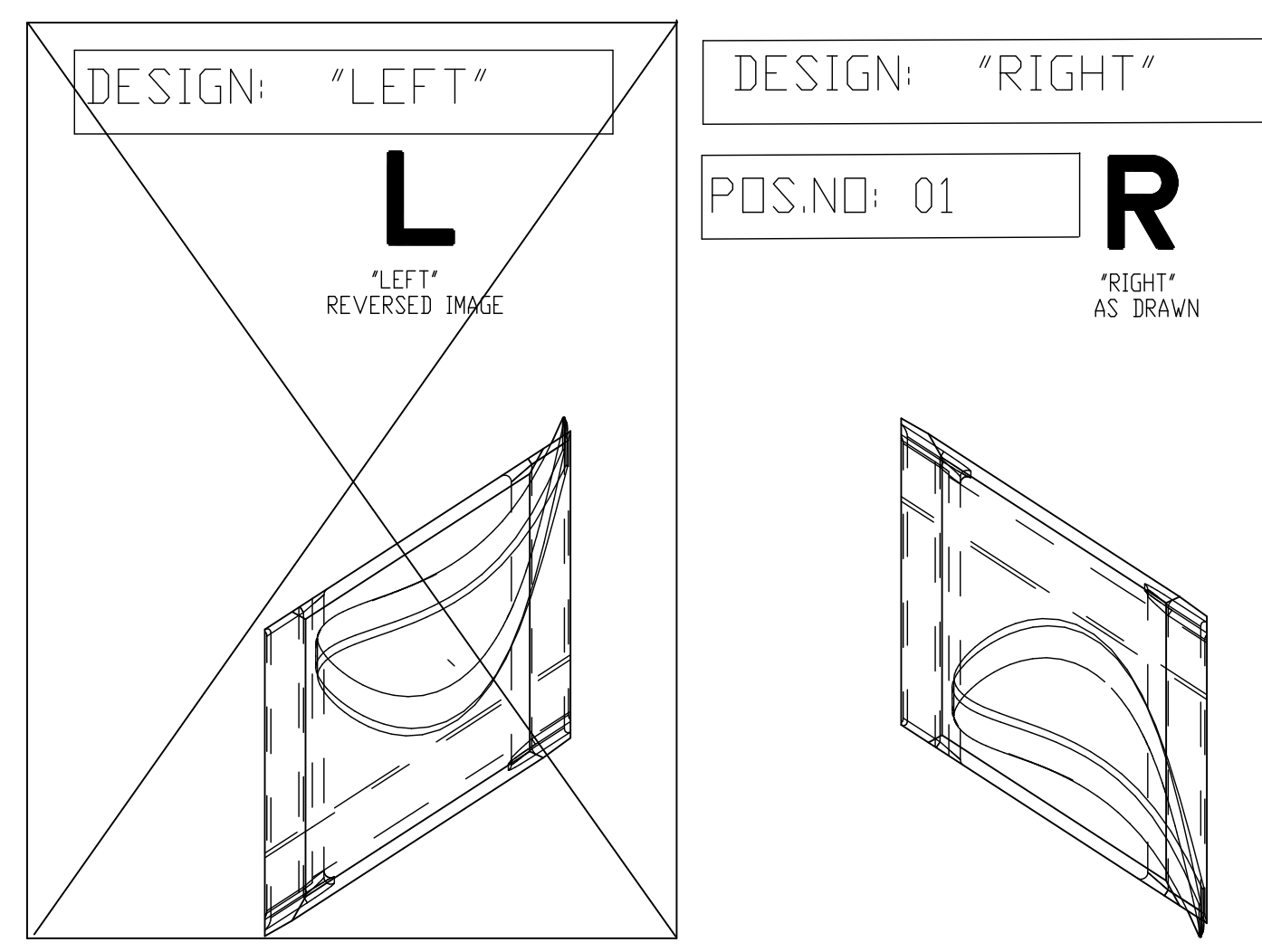
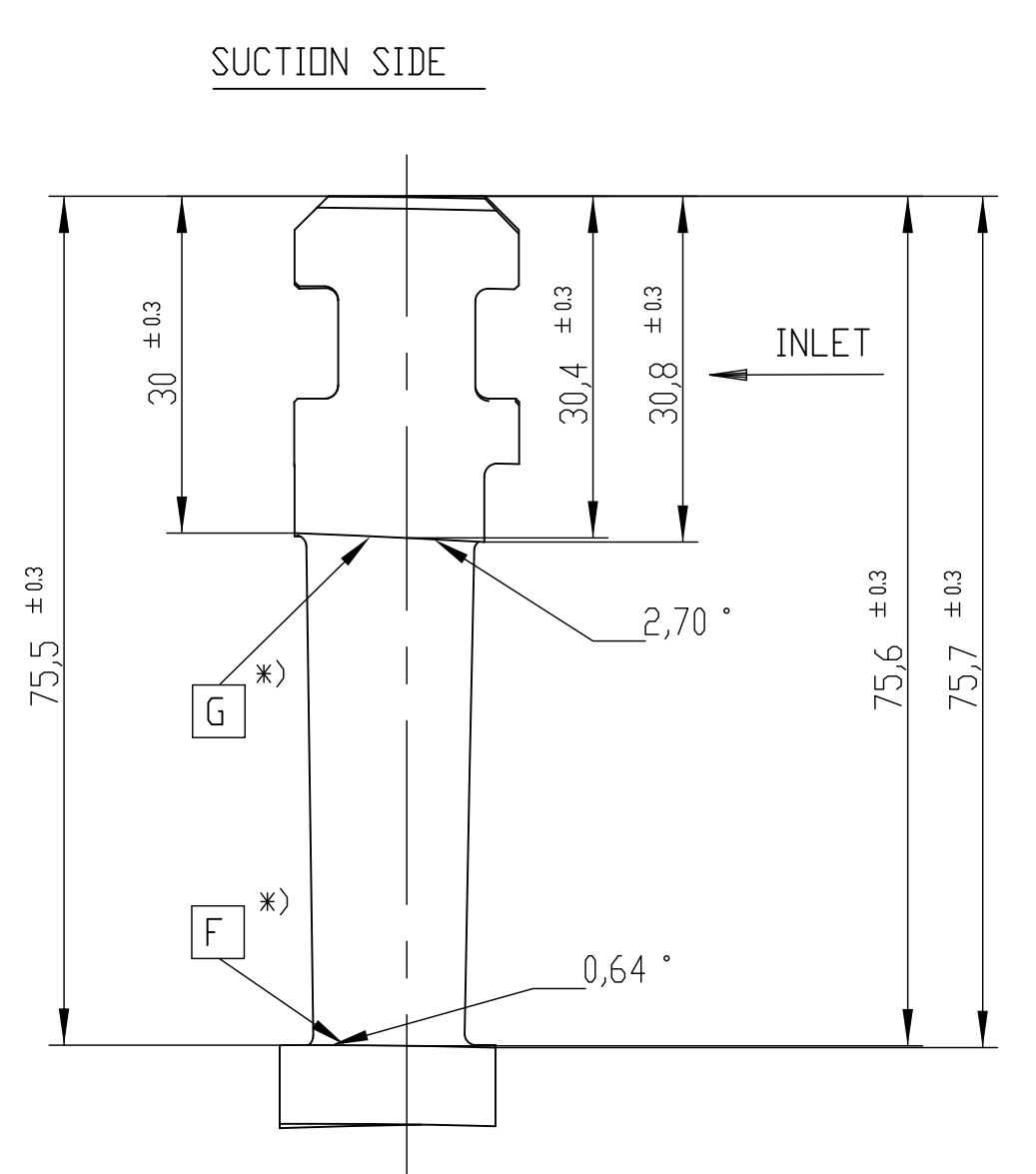
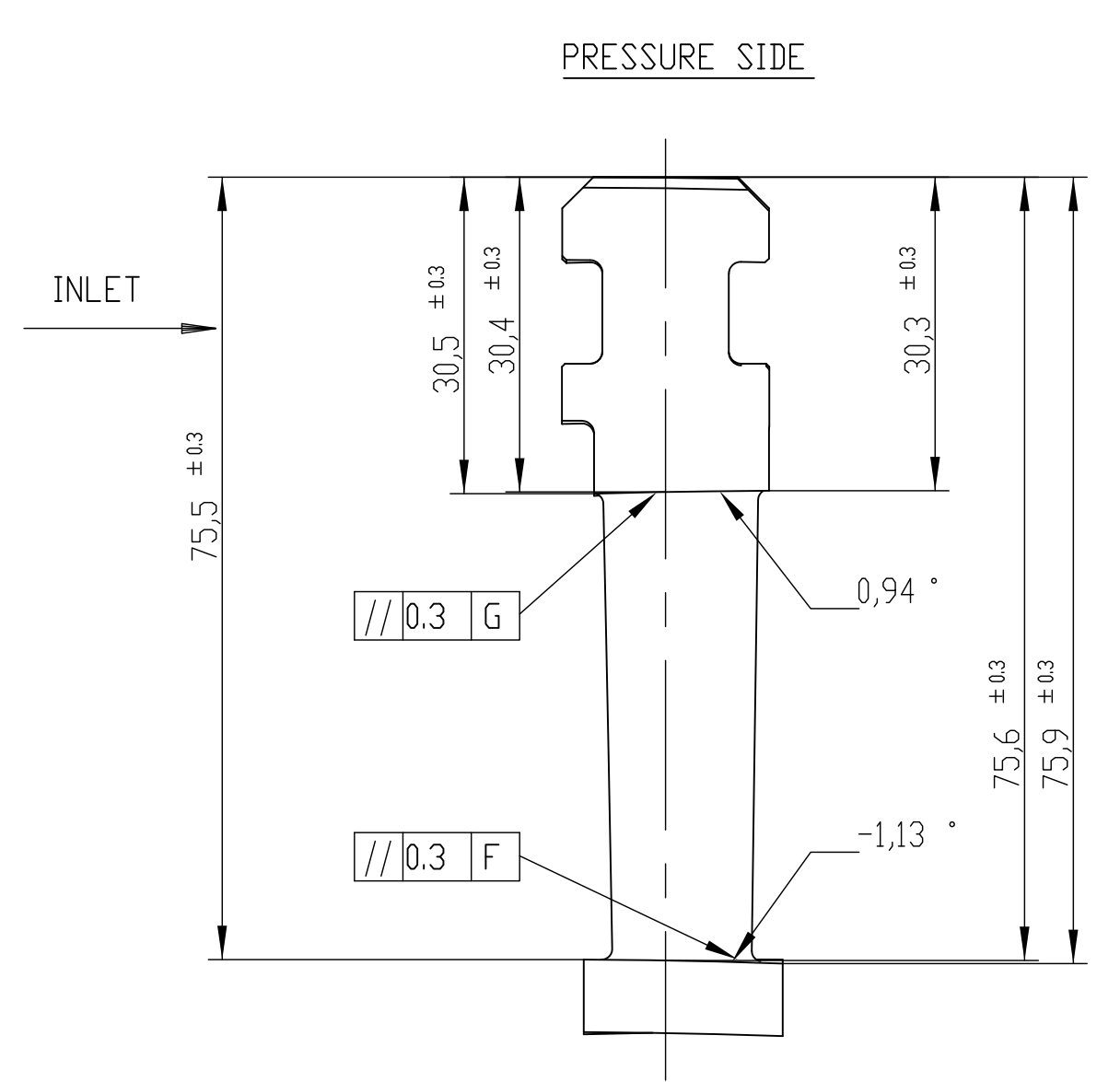
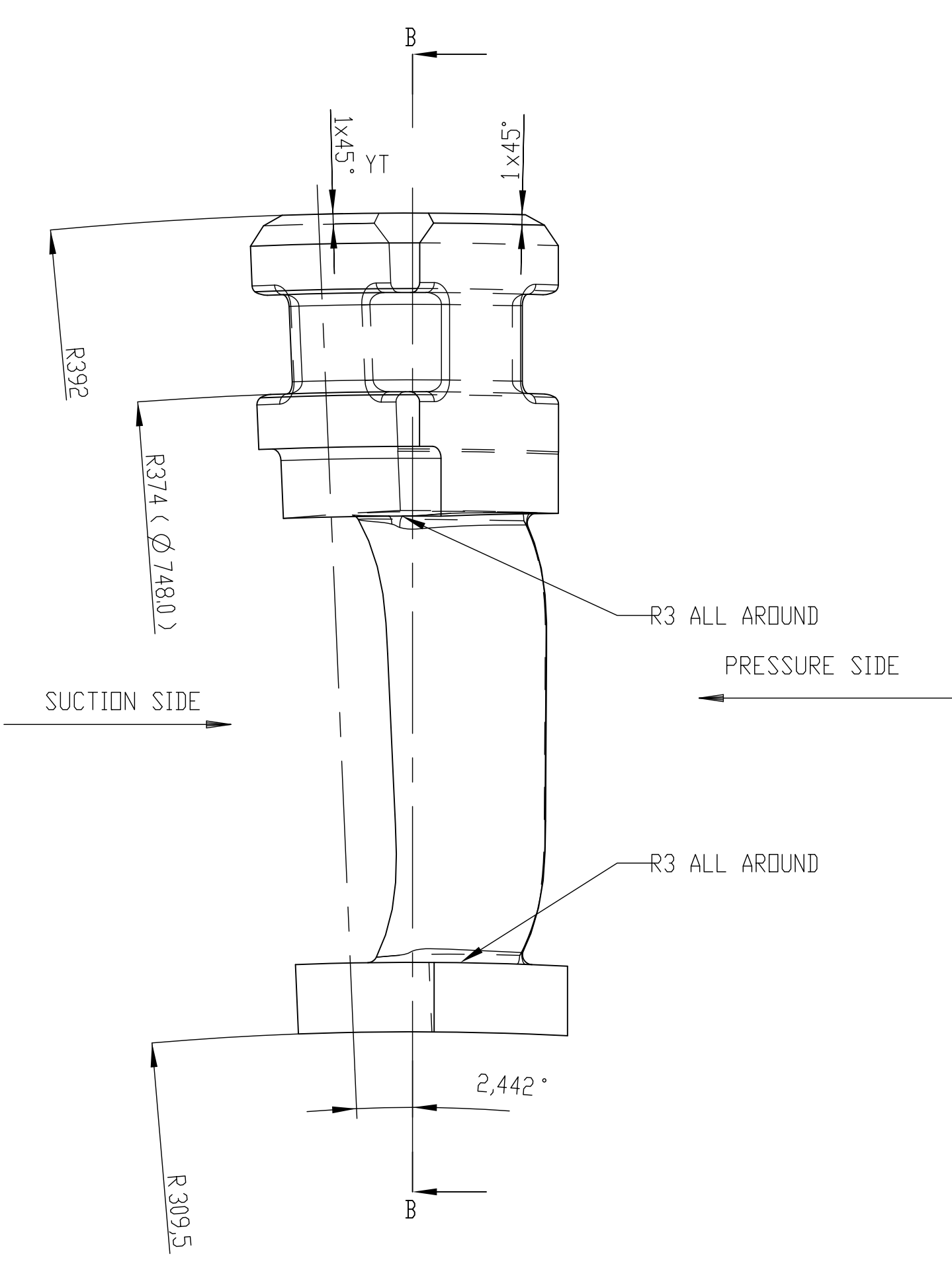
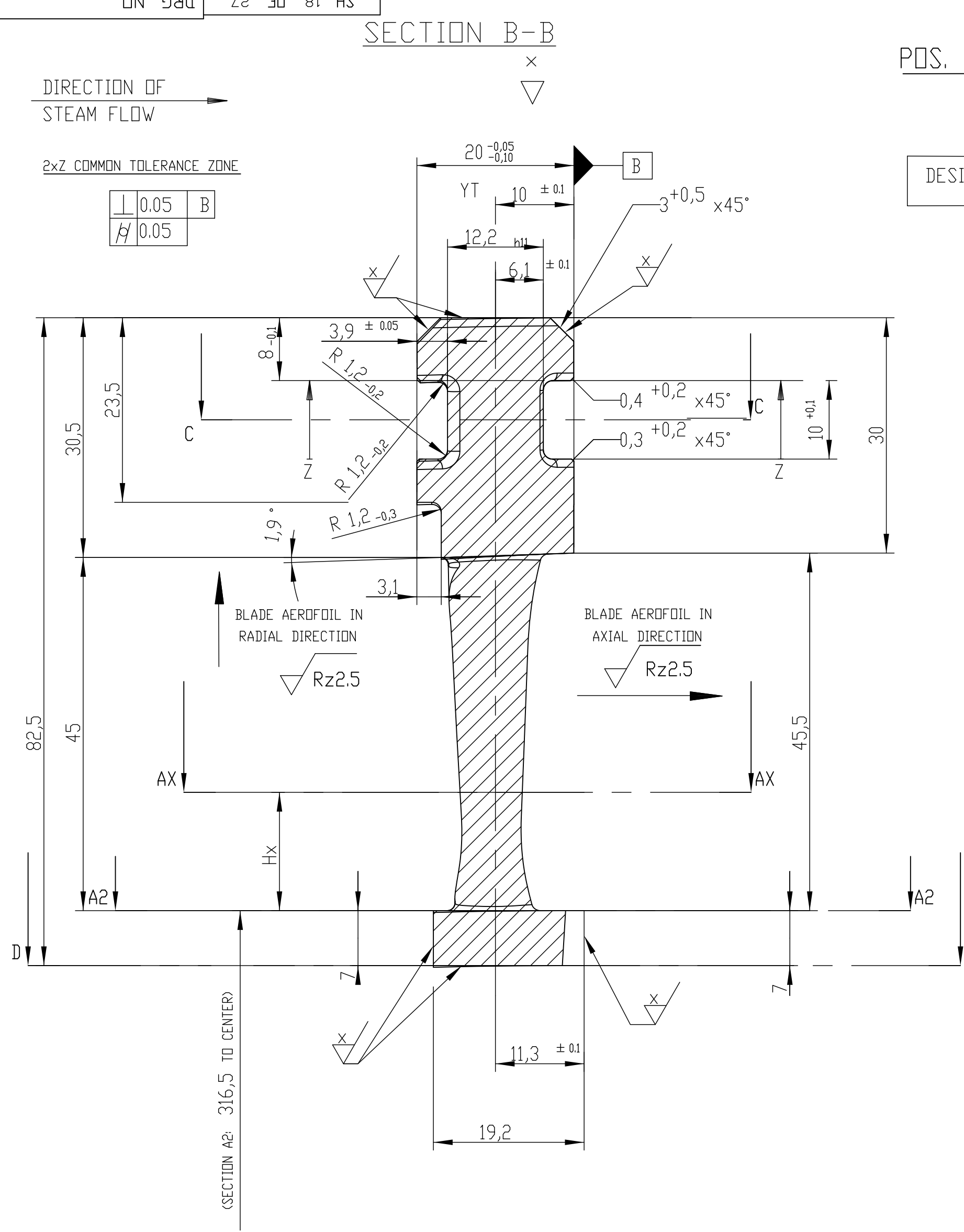

SECTION AX	Hx	Lges	AMI	UMA	RHk	BBI	D
A1 - A1	-10.0	17.33	4.96	9.24	0.09	51.25	5.58
A2 - A2	0.0	17.84	5.14	3.91	0.10	50.86	5.75
A12-A12	10.0	18.37	5.32	1.63	0.10	50.49	5.92
A25-A25	23.0	19.08	5.57	2.14	0.10	50.00	6.15
A37-A37	35.0	19.76	5.82	2.74	0.11	49.56	6.37

LOCAL SMALLEST RADIUS OF CURVATURE ON PRESSURE SIDE: 11.4 MM

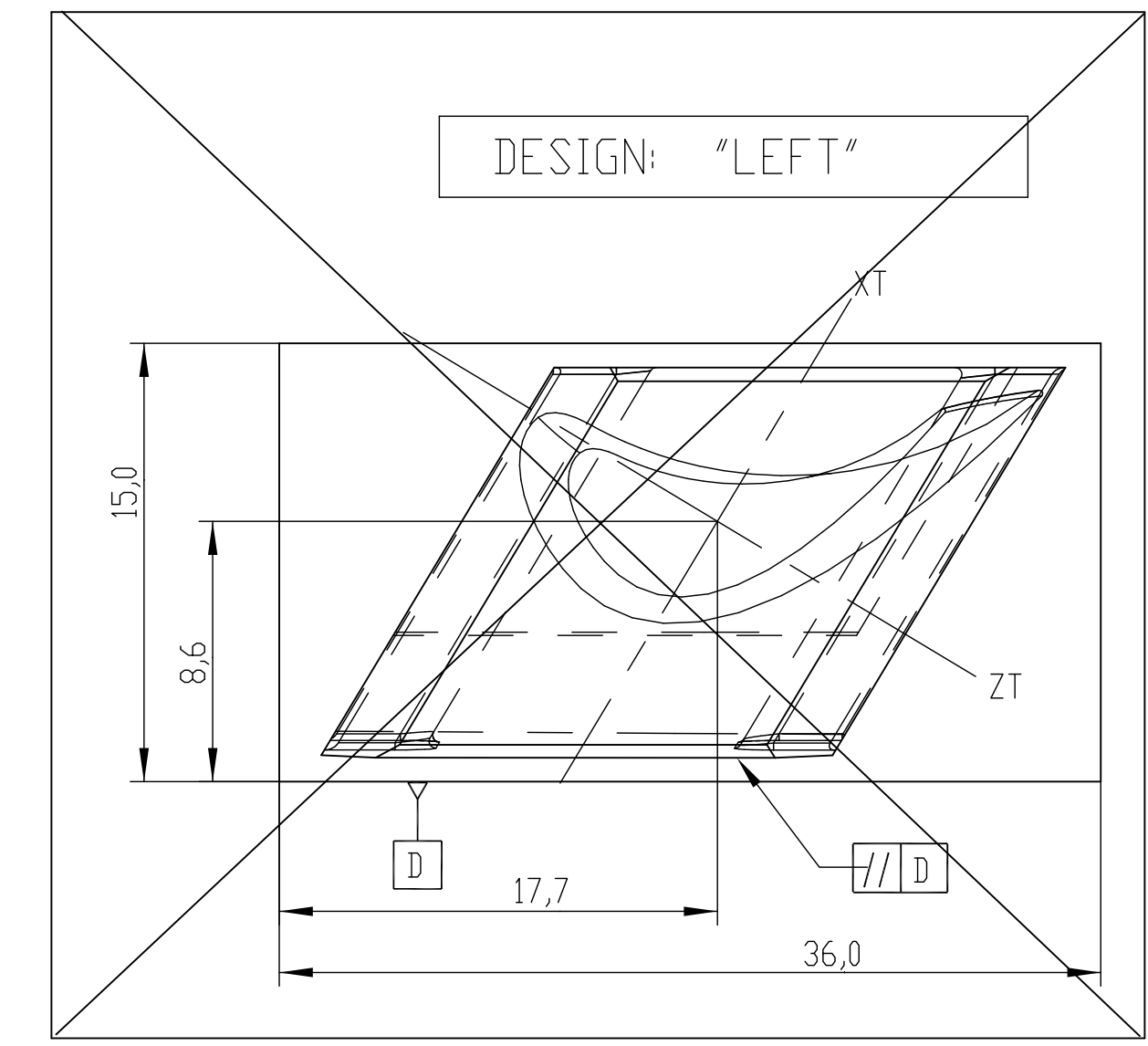
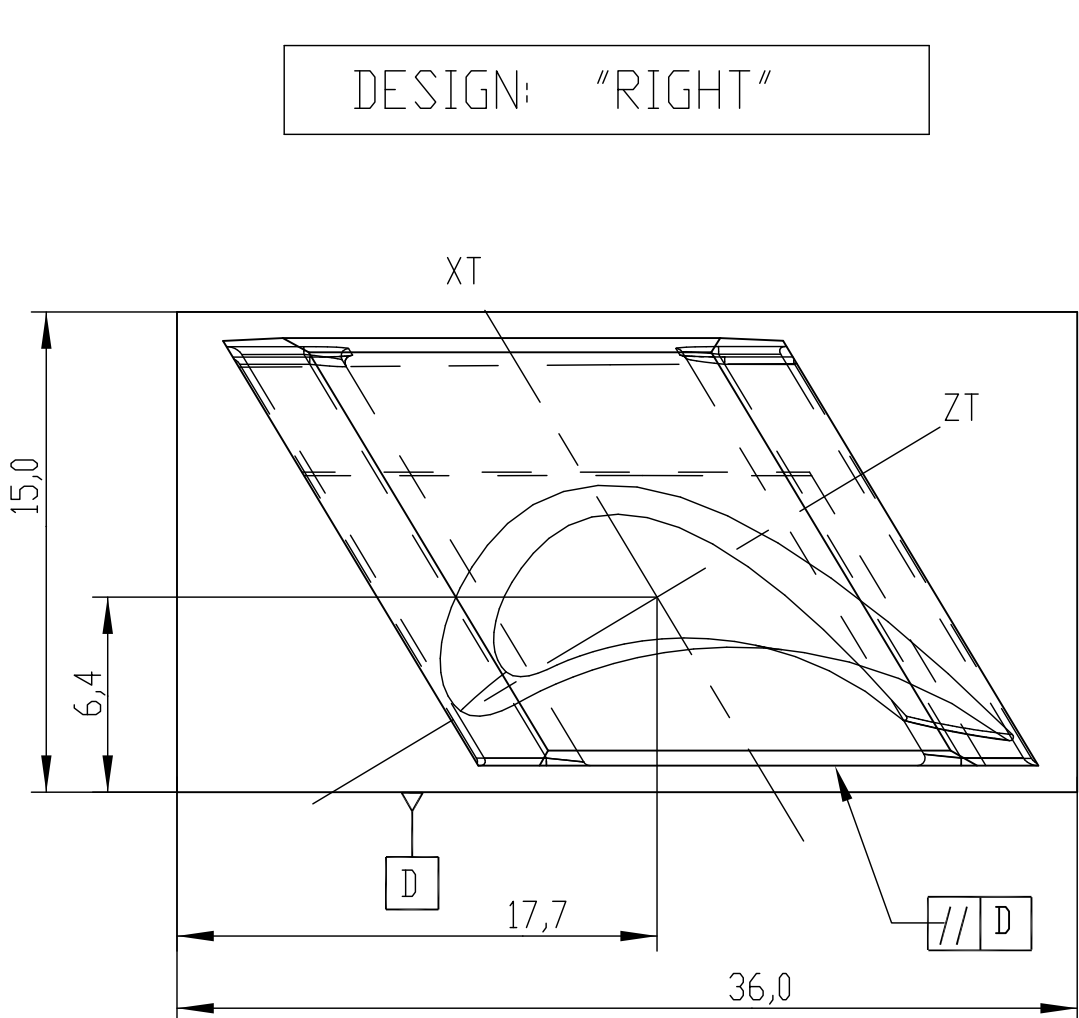
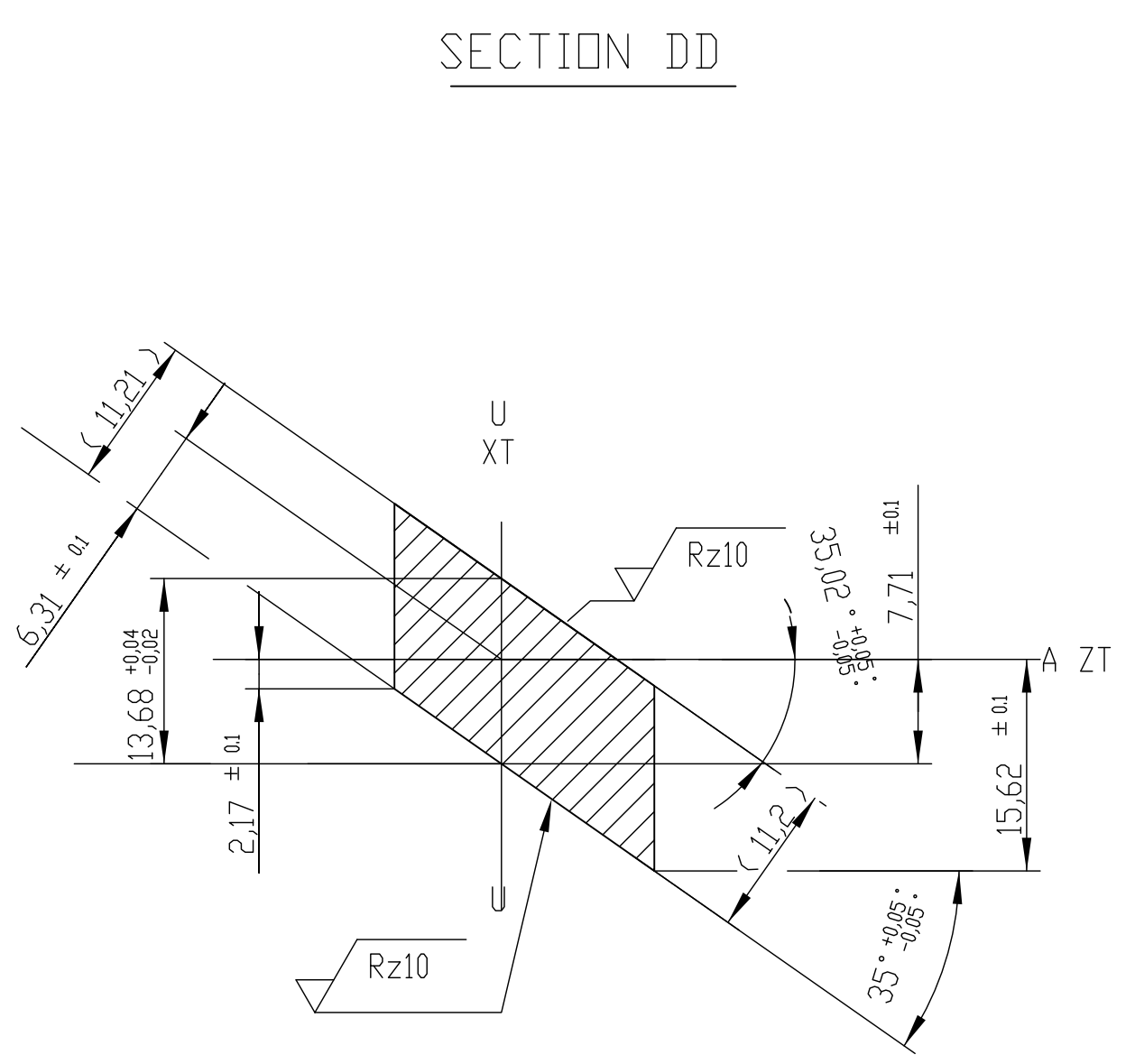
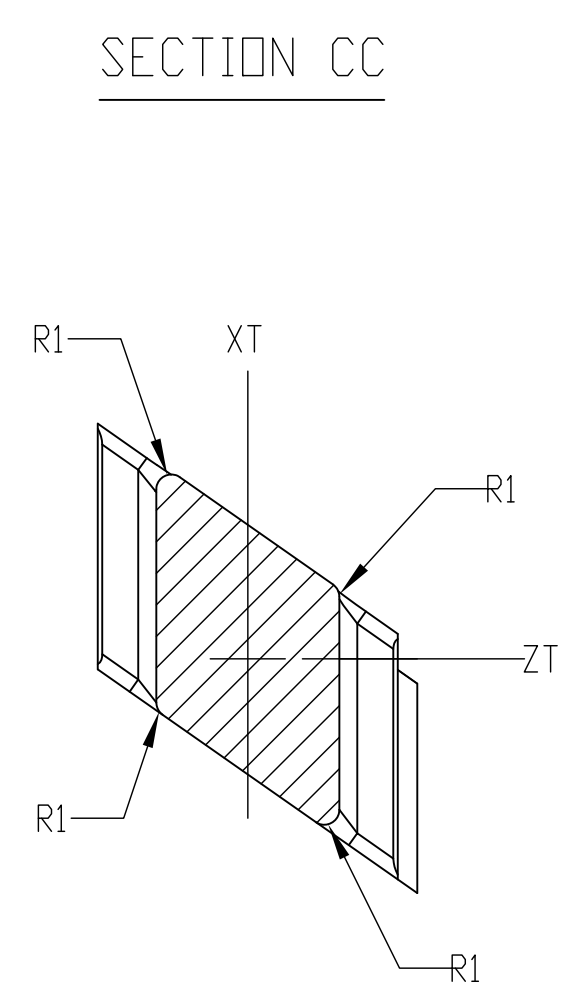
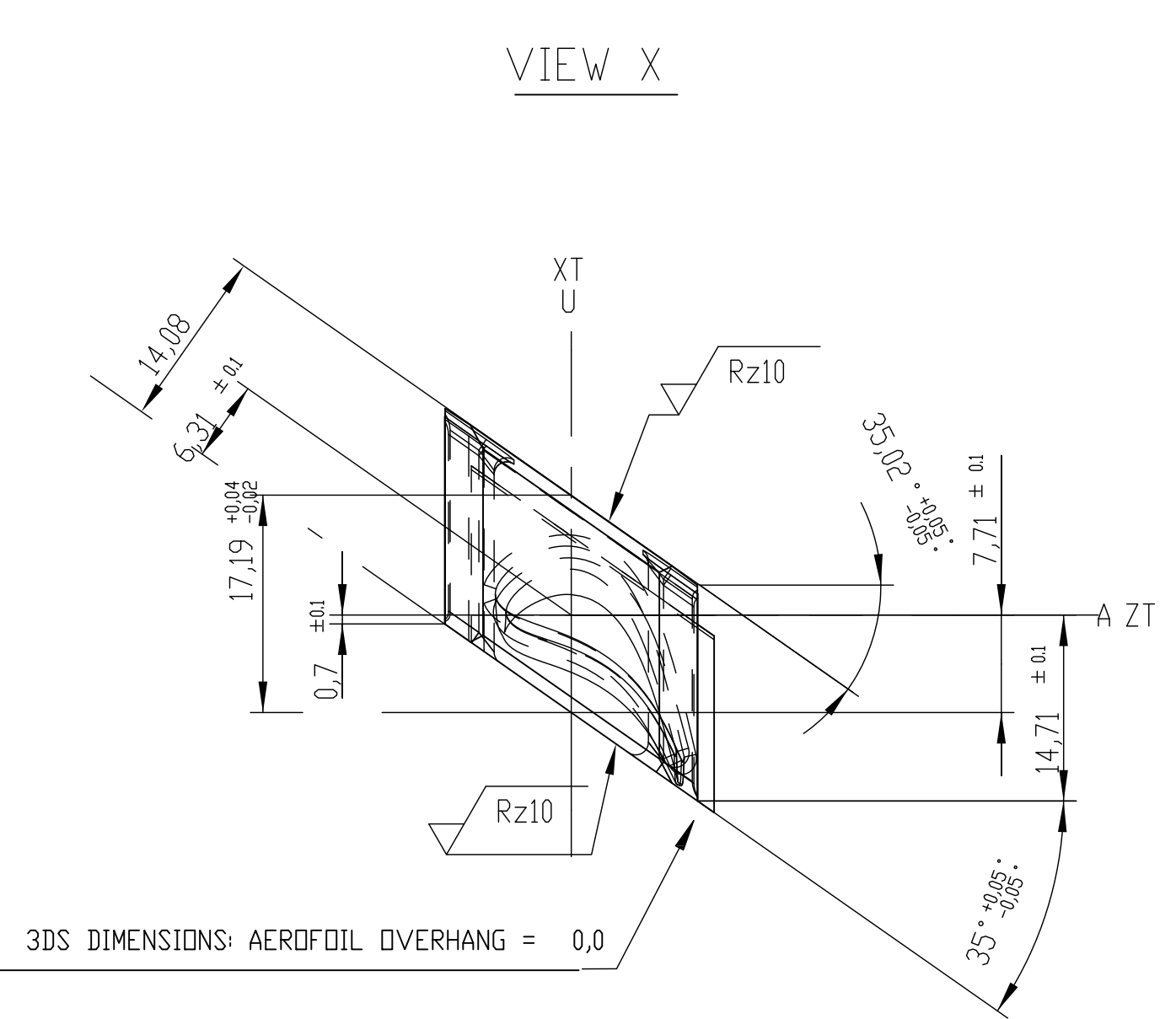
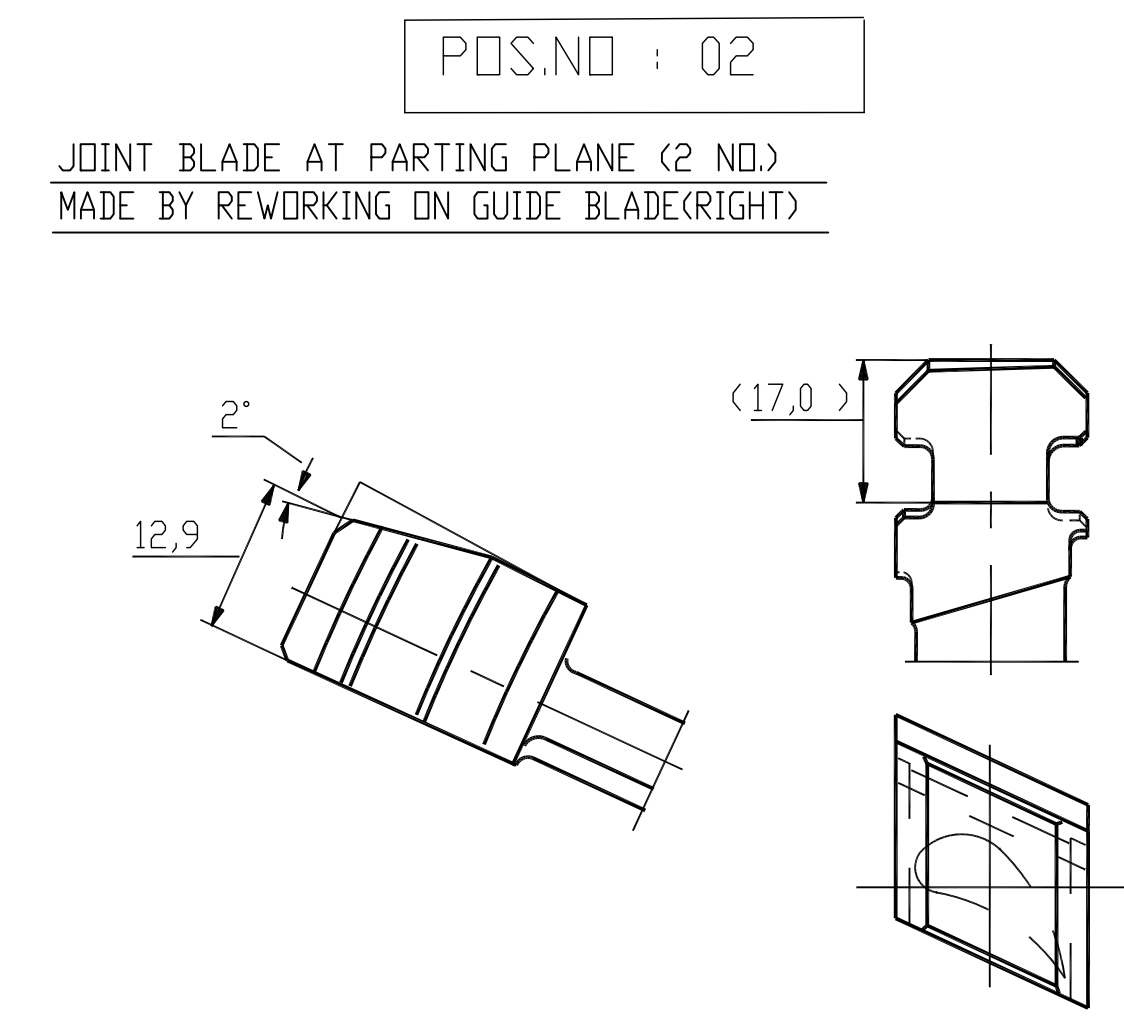
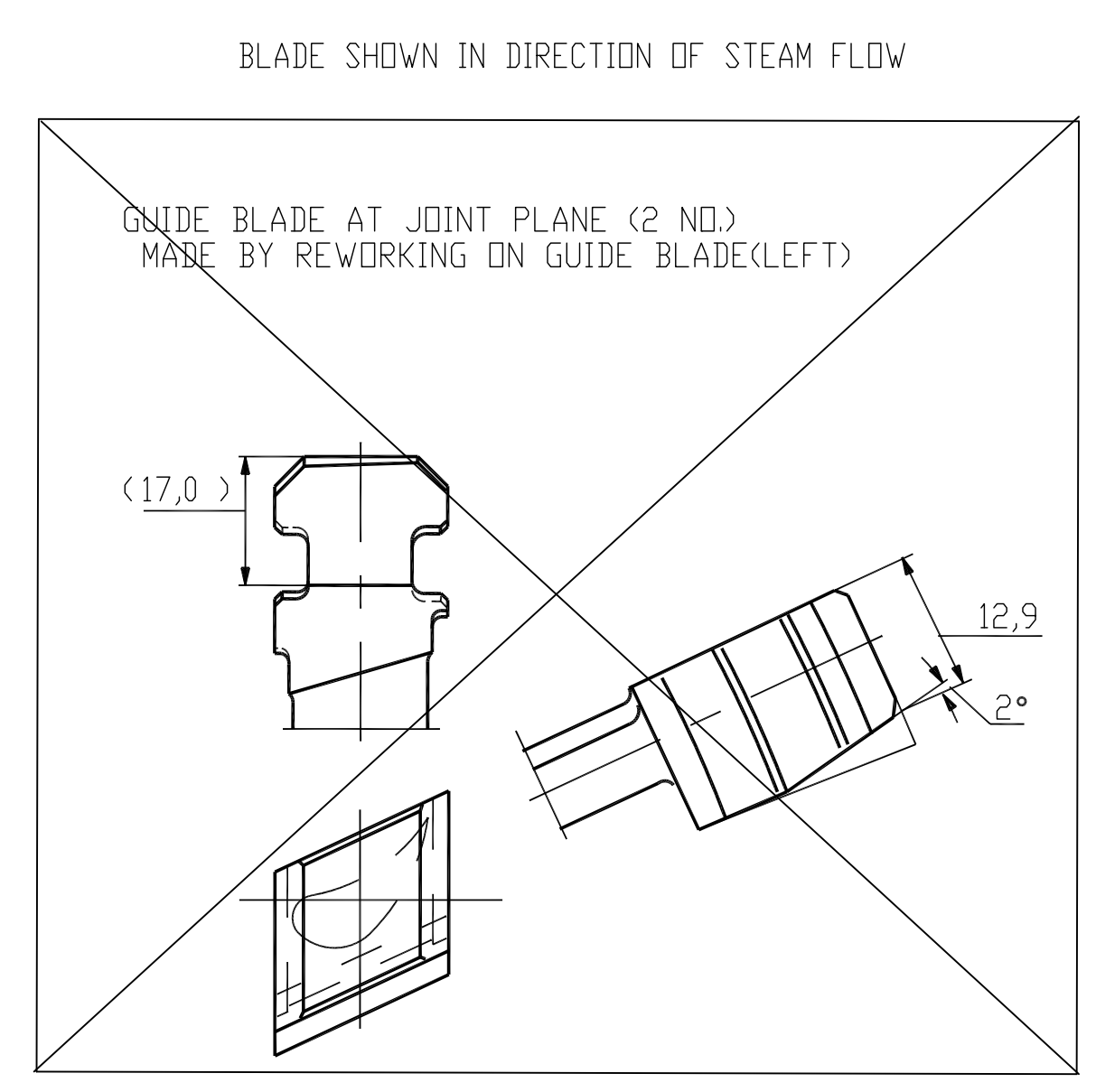

TECHNICAL REQUIREMENTS

- TOLERANCES:  
 $\pm 0.10$   
 $\pm 0.20$  U/A
- STRAK NUMBER: 80577
- NUMBER OF BLADES/ROW: 144  
(INCLUDING JOINT BLADES)

TYPE OF PRODUCT OR NAME OF CUSTOMER/PROJECT		NAME		DATE	NDIF VAR.
BHARAT HEAVY ELECTRICALS LTD. HYDERABAD		DRN	A HEMASUNDAR	15/05/2015	18
APPD		CHD	K THIRUMURUGAN	15/05/2015	18
DEPT		UNIT	DIMS.	SCALE	WEIGHT
415	415	OR C/W/F	NTS	0.090	-NA-
TITLE		DRAWING NO.		REV	
S-135-S20-TR083/046A2S		0-105-18-62012_00		NDIF	
SHT. NO 18		ND. OF SHT. 27		VAR.	