

INVENTORY NO. S-135-828-TR15/10828M S-135-828-TR15/10828M THE INFORMATION ON THIS DOCUMENT IS THE PROPERTY OF BHARAT HEAVY ELECTRICALS LIMITED. IT MUST NOT BE USED DIRECTLY OR INDIRECTLY IN ANY WAY DETRIMENTAL TO THE INTEREST OF THE COMPANY.

GENERAL DIMENSIONAL LIMITS, FITS & TOLERANCES AS PER HY0230261

FIRST ANGLE PROJECTION

(ALL DIMENSIONS ARE IN mm)

SECTION B-B

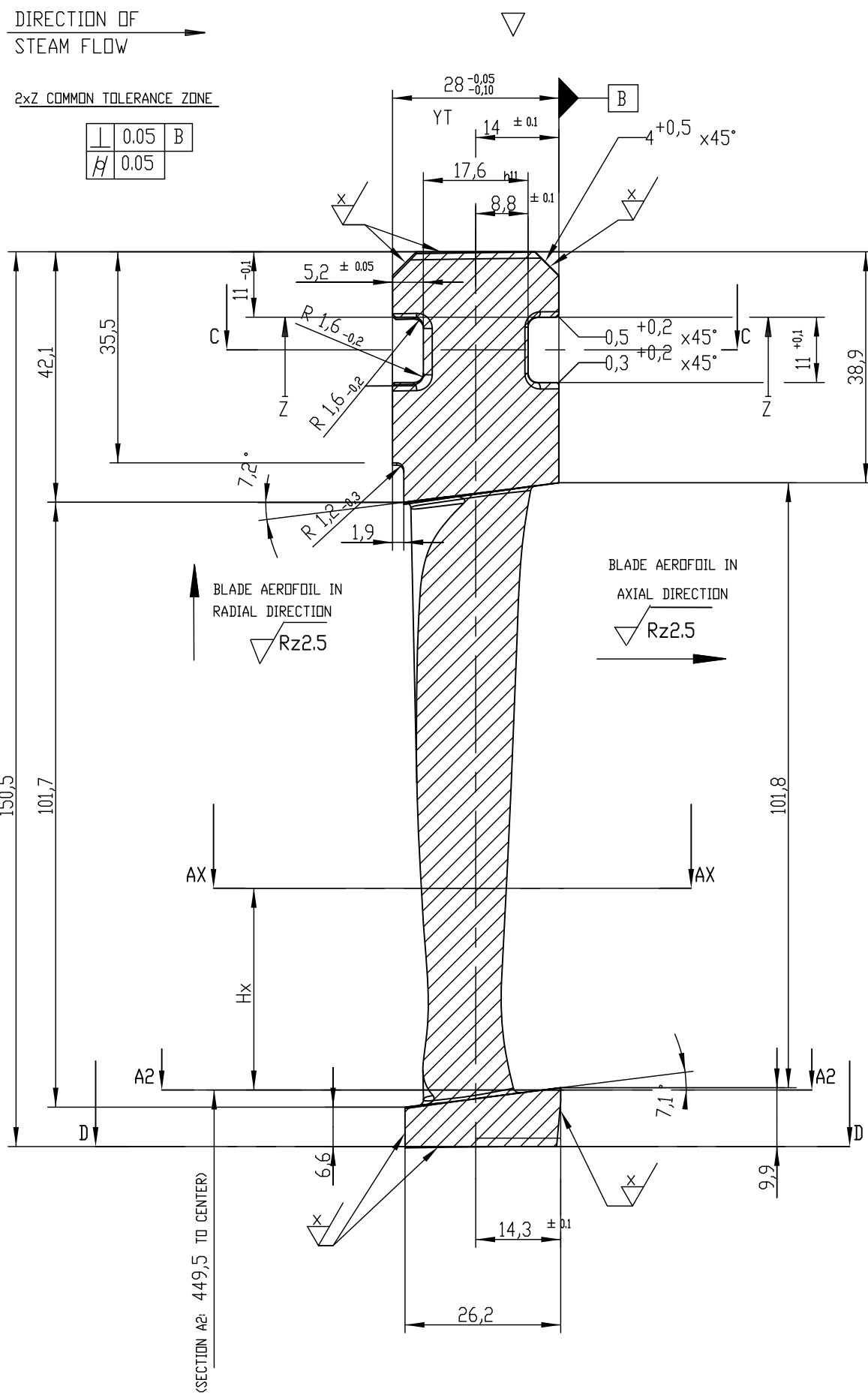

POS. NO: 1

DESIGN 'RIGHT'

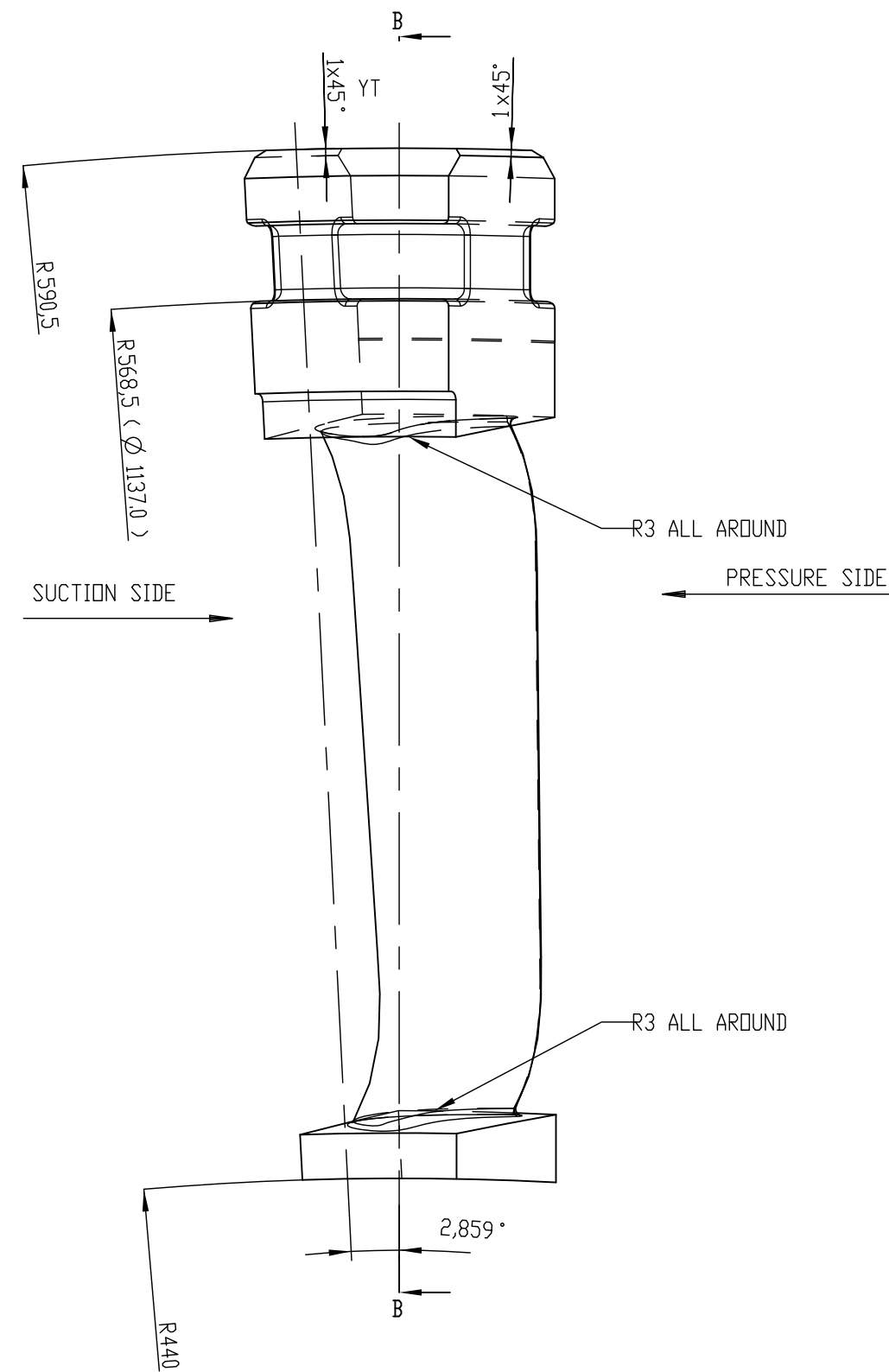

SCHEME FOR D AND S DIMENSIONS

\*) REFERED TO ADJACENT BLADE

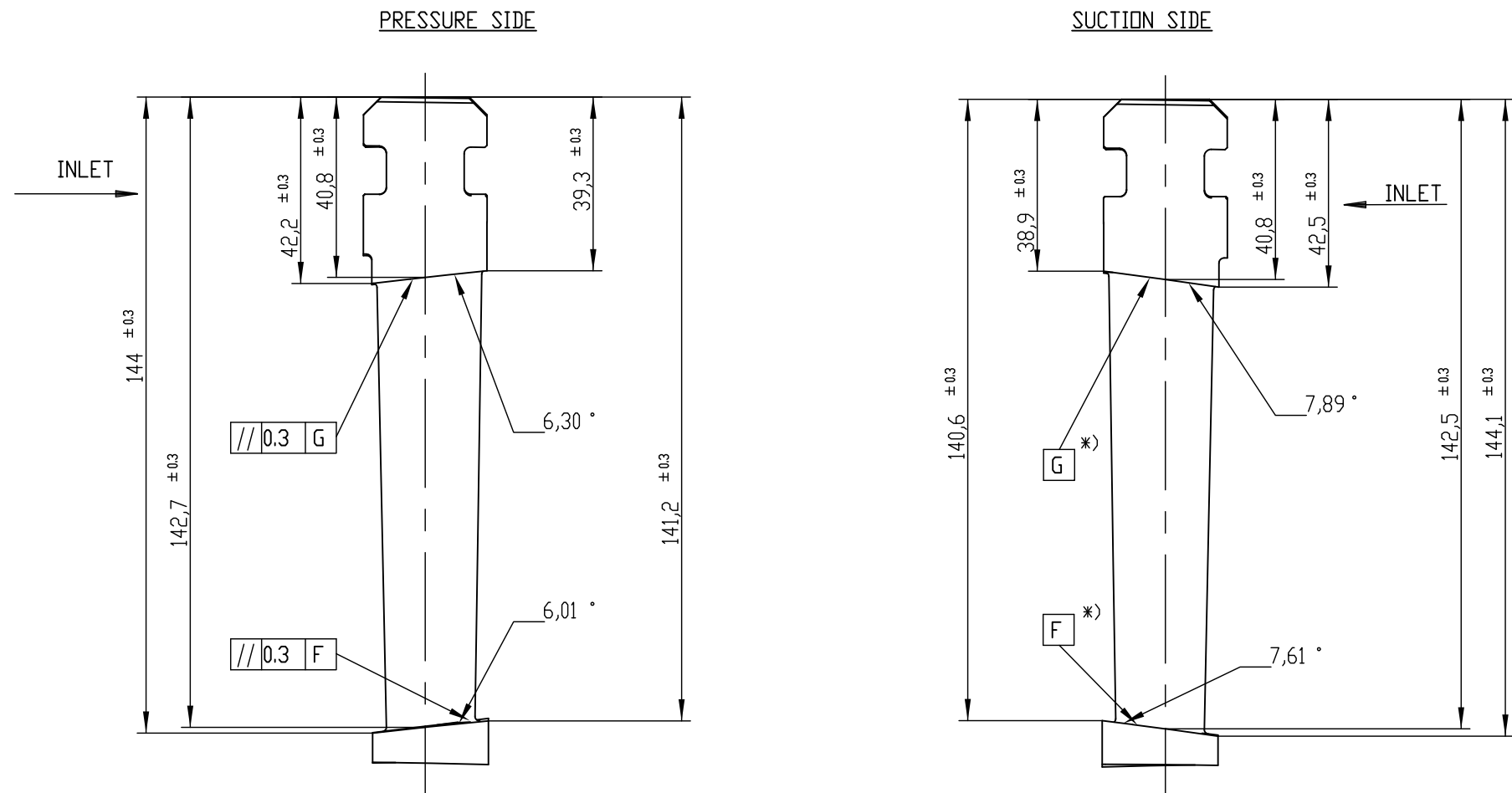

DESIGN: 'LEFT'

DESIGN: 'RIGHT'

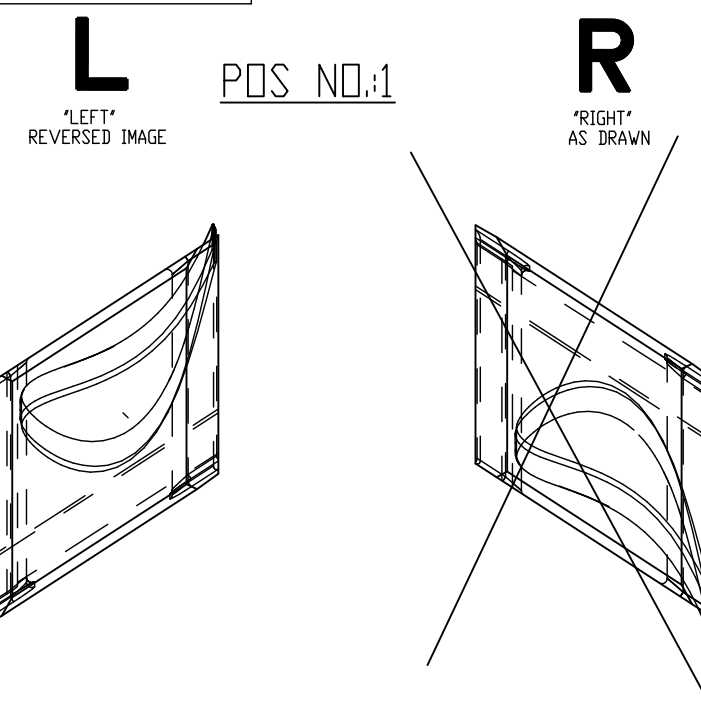

POS. NO:2

JOINT BLADES SHOWN IN DIRECTION OF STEAM FLOW MADE BY REWORKING ON GUIDE BLADE(LEFT)

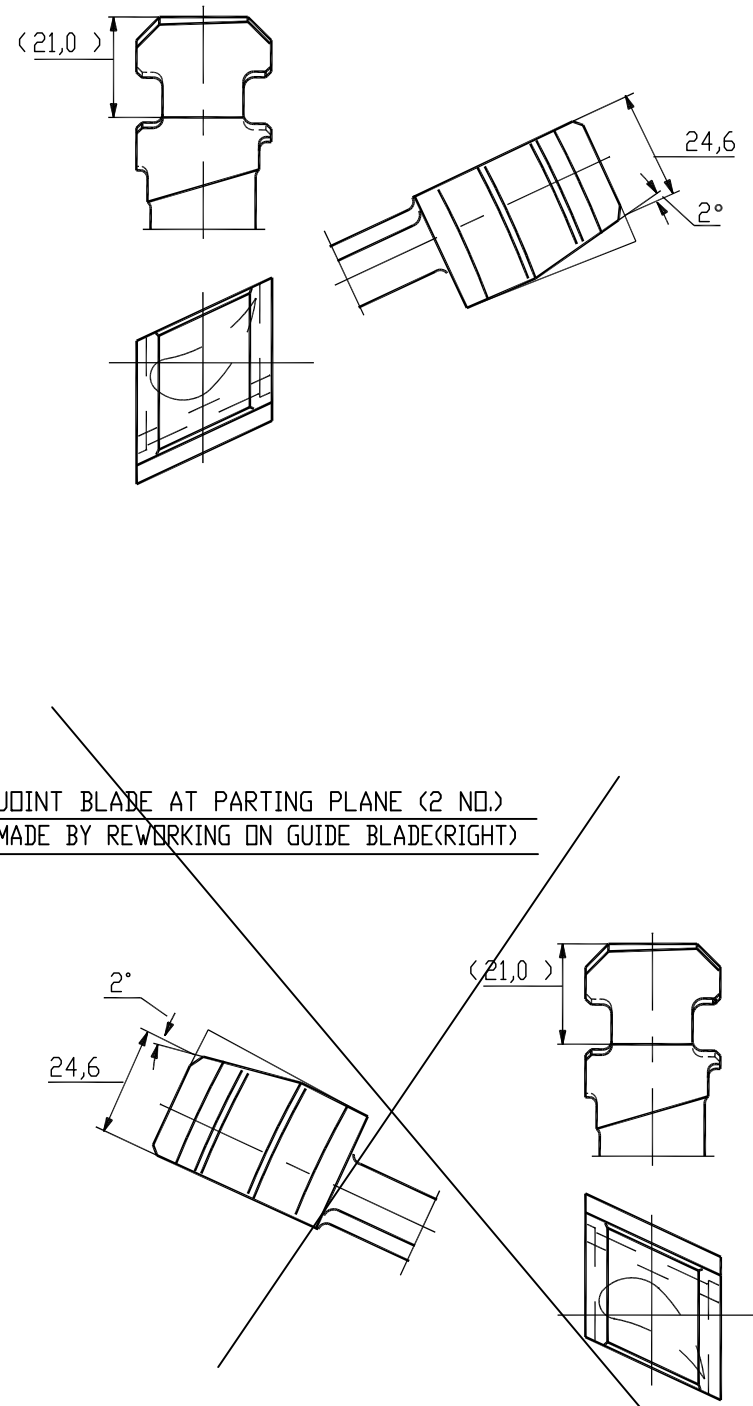

JOINT BLADE AT PARTING PLANE (2 NO.) MADE BY REWORKING ON GUIDE BLADE(RIGHT)

SECTION D-D

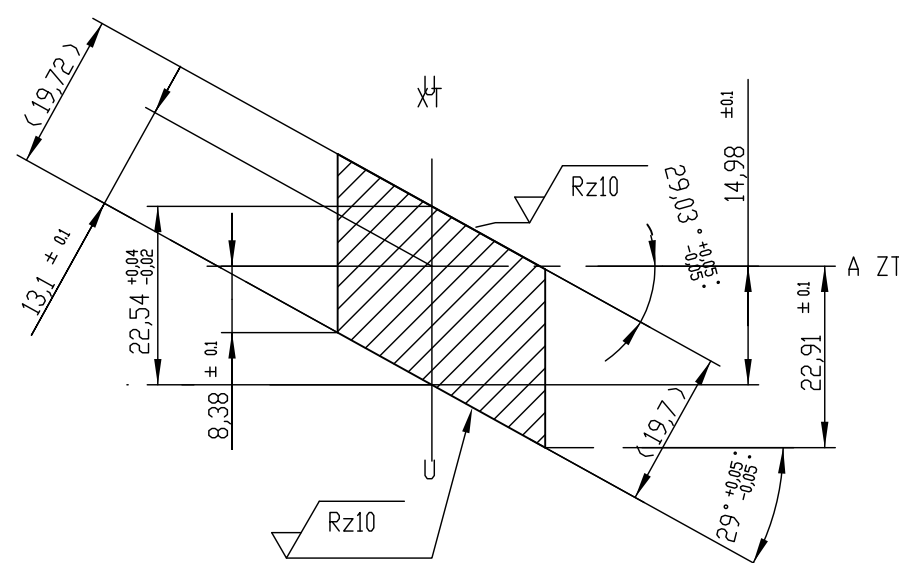

SECTION C-C

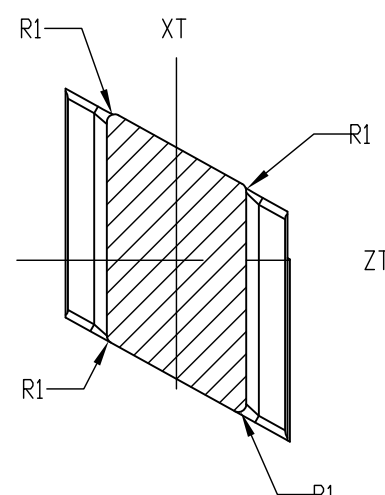

VIEW X

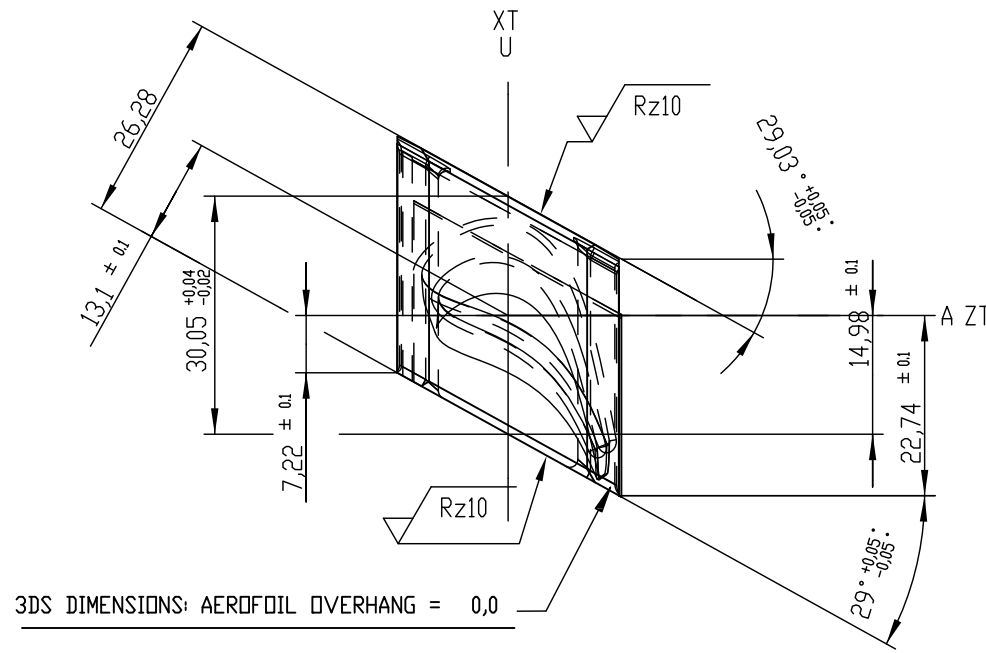

CENTRE DISTANCES IN SEMI-FINISHED CONDITION

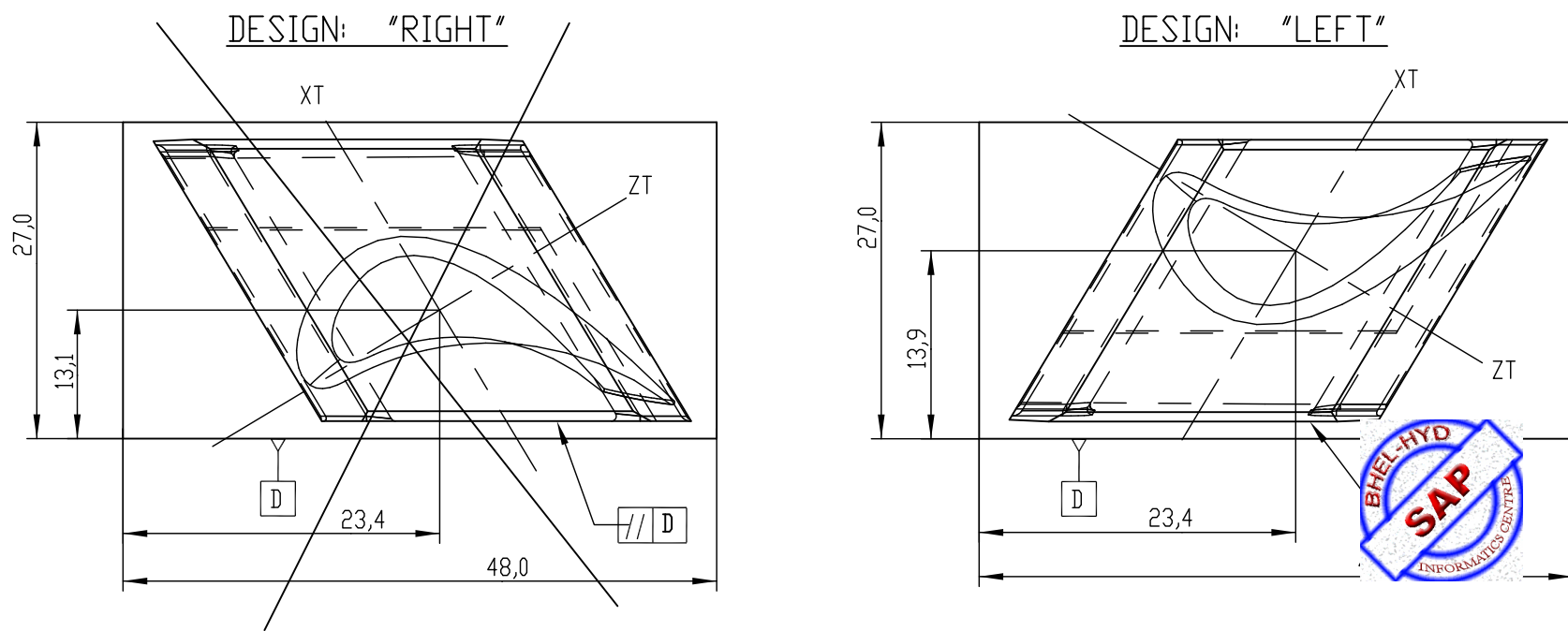

TECHNICAL REQUIREMENTS

1. TOLERANCES:

2. STRAK NUMBER: 80549  
3. NUMBER OF BLADES/ROW: 124 (INCLUDING JOINT BLADES)

TYPE OF PRODUCT OR NAME OF CUSTOMER/PROJECT

BHARAT HEAVY ELECTRICALS LTD. HYDERABAD

NAME: A. HEMASUNDAR, SIGN: K. THIRUMATHULU, DATE: 09/02/2005, IND. OF VAR. -NA-

REF. TO ASSY. DRG. -NA-, ITEM NO. -NA-, REV. 00

TITLE: GUIDE BLADE - LEFT, DRAWING NO. 0-105-18-62011, SHT. No. 11, NO. OF SHT. 21