



**PLANT STANDARD
HYDERABAD**

HY 724 25 78

REV. NO: 01

PAGE 1 OF 7

NIPPLE, ONE SIDE NPT (MALE), OTHER SIDE BUTT WELDING

1.0 SCOPE :

This standard covers designation, material, dimensions and sizes of Nipple one side NPT male threaded, other side suitable for butt welding, made from pipe.

2.0 DESIGNATION :

Eg: A reducing nipple to this standard, carbon steel material, nominal size 1/4", Schedule 80 and length 100 mm shall be designated as follows:

2.1 On drawings :

- i) Material specification column : HY 724 25 78
- ii) Description column : NIPPLE 1/4" X 100 SCH 80 NPT BW CS

2.2 For placing indents on purchase:

Nipple one side NPT, other side suitable for butt welding, nominal size 1/4", Schedule 80, Length 100, carbon steel, HY 724 25 78.

2.3 For issuing enquiries and purchase orders:

The above description shall be specified and a copy of this standard shall be enclosed.

3.0 COMPLIANCE WITH STANDARDS :

3.1 Sizes : To this standard

3.2 Materials:

Carbon steel : ASME: SA106 Gr.B
Alloy steel : ASME: SA335 Gr:P11
Stainless steel : ASME: SA312 Gr:TP321

3.3 Threading: ANSI : B 2.1

**Revisions:
BROUGHT UPTO DATE**

**Issued :
STANDARDS ENGINEERING
DEPARTMENT**

Rev.No.	Rev.Date.	Revised:	Prepared:	Approved:	Date:
01	MAR '86		NAR PDP	KLM	April '83.

**4.0 TEST CERTIFICATES :**

Test certificates covering chemical composition and physical properties attested by M/s Lloyds shall be furnished by the suppliers.

5.0 MARKING :

The following details shall be punched on each nipple:

- a) Standard No.: HY 724 25 78
- b) Nominal size and Schedule No.
- c) Material specification
- d) Manufacturer's name or trade mark
- e) Mark of inspecting authority

6.0 PRESERVATION :

Before despatch, the nipples shall be dried and cleaned and the entire surface shall be well covered with a good quality rust preventive material that will not become fluid and run off at 65°C. threads shall be protected with suitable grease.

7.0 PACKING :

The nipples shall be properly packed to avoid mechanical damages during transport.

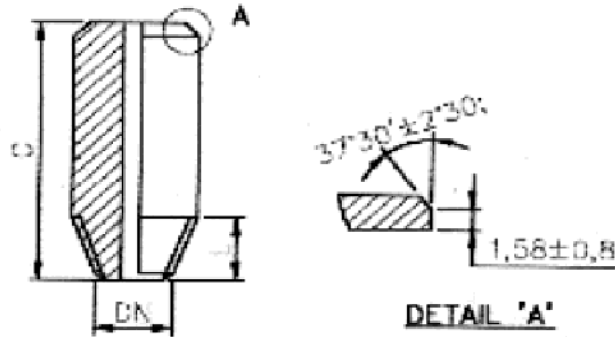

i) NIPPLE, ONE SIDE NPT, OTHER SIDE BW, CARBON STEEL

All dimensions are in 'mm' unless other wise specified.

NOM. SIZE DN INCHES	SCHE-DULE	LENG-TH C	L	Wt./ pc kg	Pref./ Stock Symbol	NEW CODE		MAIN USER DIVISIONS				
						OLD CODE	TC	OE	HE	FP		
1/8	80	100	10					√				
1/4	80	100	15			HY 724 25 78 027		√	√			
						776 00 21 203						
3/8	80	100	15									
1/2	80	100	20			HY 724 25 78 043		√	√			
						776 00 41 203						
	HY 724 25 78 051						√					
	N 72 42 30 149											
	HY 724 25 78 060					√						
	776 00 41 603											
3/4	80	100	20			HY 724 25 78 078		√				
						776 00 41 903						
	HY 724 25 78 086					√	√			√		
	776 00 51 203											
	HY 724 25 78 094					√						
	77600 51 603											
1	80	100	25			HY 724 25 78 108		√				
						776 00 51 903						
	HY 724 25 78 116					√						
	776 00 61 203											
	HY 724 25 78 124					√						
	776 00 61 603											
1 1/2	80	100	26			HY 724 25 78 132		√	√			
						776 0041 903						
	HY 724 25 78 140						√					
	776 00 81 203											
	HY 724 25 78 159						√					
	N72 42 30 152											
11/2	80	150	26			HY 724 25 78 167		√				
						776 00 81 603						
	HY 724 25 78 175					√						
	776 00 81 903											

**PLANT STANDARD
HYDERABAD**



NOM. SIZE DN INCHES	SCHE-DULE	LENG-TH C	L	Wt./ pc kg	Pref./ Stock Symbol	NEW CODE	MAIN USER DIVISIONS			
						OLD CODE	TC	OE	HE	FP
2	80	100	27			HY 724 25 78 783		√		
						N72 42 30 153				
	80	250				HY 724 25 78 191		√		
						N72 42 30 154				
	80	350				HY 724 25 80 205		√		
						N72 42 30 155				
	80	500				HY 724 25 78 213		√		
						N72 42 30 156				
80	700	HY 724 25 78 221		√						
		N 72 42 30 157								
160	100									
XXS	100									
3	80	100	42			HY 724 25 78 256		√		
						776 01 11 003				
	40	150				HY 724 25 78 264		√		
						N72 42 30 158				
160	85	HY 724 25 78 272		√						
-										
4	40	150	44			HY 724 25 78 279		√		
		200				965 37 94 530				
						HY 724 25 78 302		√		
						N72 42 30 159				
¾	80	100	20			HY 724 25 78 310				√
						779 40 51 203				
6	80	150	50			HY 724 25 78 329		√		
						-				
6	40	150	50			HY 724 25 78 337		√		
						965 37 94 600				
4	40	75	44			HY 724 25 78 345		√		
						965 37 94 650				
8	20	150	55			HY 724 25 78 353		√		
						965 37 94 620				

Copyright and Confidential
 The information on this document is the property of BHARAT HEAVY ELECTRICALS LIMITED. It must not be used directly in any way determined to the interest of the company.





**PLANT STANDARD
HYDERABAD**

HY 724 25 78

REV. NO.01

PAGE 5 OF 7

ii) NIPPLE, ONE SIDE NPT, OTHER SIDE BW, ALLOY STEEL

(All dimensions are in 'mm' unless other wise specified.)

NOM. SIZE/DN INCHES	SCHE-DULE	LENG-TH C	L	Wt./ pc kg	Pref./ Stock Symbol	NEW CODE	MAIN USER DIVISIONS			
						OLD CODE	TC	OE	HE	FP
1/8	80	100	10							
1/4	80	100	15			HY 724 25 78 620	√			
						776 00 21 234				
3/8	80	100	15							
1/2	80	100	20			HY 724 25 78 647	√			
	160	100				776 00 41 234				
	XXS	100								
3/4	80	100	20			HY 724 25 78 663	√			
	160	100				776 00 41 934				
	XXS	100								
1	80	100	25			HY 724 25 78 671	√			
	160	100				776 00 51 234				
	XXS	100								
1 1/2	80	100	26			HY 724 25 78 698	√			
	160	100				77600 51 934				
	XXS	100								
	80	100				HY 724 25 78 701	√			
	160	100				776 00 61 234				
	XXS	100								
	80	100				HY 724 25 78 728	√			
	160	100				776 00 61 934				
	XXS	100								
	80	100				HY 724 25 78 736	√			
	160	100				776 00 81 234				
	XXS	150								
	80	100				HY 724 25 78 752	√			
	160	100				776 00 81 934				
	XXS	150								

Copyright and Confidential
The information on this document is the property of BHARAT HEAVY ELECTRICALS LIMITED. It must not be used directly in any way determined to the interest of the company.





ii) NIPPLE, ONE SIDE NPT, OTHER SIDE BW, STAINLESS STEEL

(All dimensions are in 'mm' unless other wise specified.)

NOM. SIZE DN INCHES	SCHE- DULE	LENG- TH C	L	Wt./ pc kg	Pref./ Stock Symbol	NEW CODE	MAIN USER DIVISIONS			
						OLD CODE	TC	OE	HE	FP
1/8	80 S	100	10							
1/4	80 S	100	15			HY 724 25 78 825	√			
						776 00 22 6144				
3/8	80 S	100	15							
1/2	80 S	100	20			HY 724 25 78 841	√			
						776 00 42 6144				
	160 S	100				HY 724 25 78 850				
						776 00 43 014				
	XXS	100				HY 724 25 78 868	√			
						776 00 41 914				
3/4	80 S	100	20			HY 724 25 78 876	√			
						776 00 52 614				
	160 S	100				HY 724 25 78 884				
						776 00 53 014				
	XXS	100				HY 724 25 78 892	√			
						776 00 51 914				
1	80 S	100	25			HY 724 25 78 906	√			
						776 00 62 614				
	160 S	100				HY 724 25 78 914				
						776 00 63 014				
	XXS	100				HY 724 25 78 922	√			
						776 00 61 914				
1 1/2	80 S	100	26			HY 724 25 78 930	√			
						776 00 82 614				
	160 S	100				HY 724 25 78 949				
						776 00 83 014				
	XXS	100				HY 724 25 78 957	√			
						776 00 81 914				
3/4	40 S	100	20			HY 724 25 78 965	√			
1/2	40 S	100	20			HY 724 25 78 973				
1	40 S	100	25			HY 724 25 78 981				



**PLANT STANDARD
HYDERABAD**

HY 724 25 78

REV. NO.01

PAGE 7 OF 7

NOTE:

STANDARD AND STOCK SIZE

STANDARD AND NON-STOCK SIZE

STANDARD SIZE NOT USED

NON-STANDARD AND STOCK SIZE

NON-STANDARD AND NON-STOCK SIZE

Copyright and Confidential
The information on this document is the property of BHARAT HEAVY ELECTRICALS LIMITED. It must not be used directly in any way determined to the interest of the company.

RESTRICTED USE

