



**PLANT STANDARD
HYDERABAD**

HY 960 12 07

REV. NO: 03

PAGE 1 OF 3

PLUG, METRIC THREAD

DESIGNATION : PLUG d1xpitch HY960 12 07
MATERIAL : 080M40 (En8) BS:970 (PtI)-1972 (AA 102 08)
DIMENSIONS : DIN 910
SIZE : d1xpitch
THREADS : IS:4218,6g

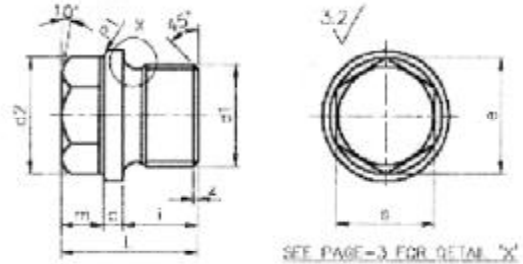

ALL DIMENSIONS IN 'mm'

Nom. Size d1xPitch	c	d2	e Min	i	l	m ±1/2 IT5	s	z	Wt/Kgs 1000 Pcs	Raw Material Size	Raw Material code	Sub code		
M10x1	3	14	10.89	8	17	6	10	0.1	02.0	16	AA 102 02 08 082	015		
M10x1.25												252		
M12x1.25		17	14.20	12	21	6	13		20.3	20	AA 102 02 08 104	260		
M12x1.5												023		
M16x1.5	4	21	18.72	12	21	6	17		35.2	25	AA 102 02 08 120	031		
(M18x1.5)		23	18.72	12	24	8	17					48.6	040	
M20x1.5		25	20.88	14	26	8	19		64.5	32	AA 102 02 08 147	058		
M20x2												066		
M24x1.5	5	29	23.91	14	27	9	22	93.5	127.0	36	AA 102 02 08 155	074		
(M27x2)		32	26.17	16	30	10	24	148.0				40	AA 102 02 08 163	082
M30x1.5		36	26.17	16	30	10	24	195.0				50	AA 102 02 08 180	090
M30x2														104
(M33x2)	39 42	29.56	16	32	11	27	220.0	50	AA 102 02 08 180	119				
M36x1.5										120				
M36x2										139				
(m39x2)	46	29.56	16	32	11	27	255.0							

Revisions:
M48x2 SIZE OS ADDED

Issued :
STANDARDS ENGINEERING
DEPARTMENT

Rev.No.03	Amd.No.	Reaffirmed.	Prepared:	Approved:	Date.
Dt. MAY 85	Dt.	Year:	VNR	DYM (STDS)	MARCH .80

The information on this document is the property of BHARAT HEAVY ELECTRICALS LIMITED. It must not be used directly in any way determined to the interest of the company.

RESTRICTED USE



HY 960 12 07

REV. NO.03

PAGE 2 OF 3

**PLANT STANDARD
HYDERABAD**

Nom. Size d1xPitch	c	d2	e Min	i	l	m ±1/2 IT5	s	z	Wt/Kgs 1000 Pcs	Raw Material Size	Raw Material code	Sub code	
M42x1.5	5	49	32.95	16	33	12	30	0.2	300.0	16	AA 102 02 08 201		
M42x2													
(M45x1.5)	5	52	32.95	16	33	12	30		340.0	20			
(M45x2)													
M48x1.5	5	55	32.95	16	33	12	30		375.0	25			201
M48x2													
(M52x1.5)	5	60	32.95	16	33	12	30		430.0	32			
(m52x2)													
(m60x2)	5	68	39.55	20	40	15	36		695.0	80	AA 102 02 08 244		
M64x2		72	39.55	20	40	15	36		774.0				

NOTE :

1. FOR OBTAINING 12 DIGIT CODE, SUFFIX SUB CODE TO STANDARD NUMBER.
2. NON PREFERRED SIZES ARE INDICATED IN BRACKETS.
3. RAW MATERIAL AS PER PLANT RATIONALISED SIZES.
4. DIMENSIONS NOT AS PER DIN 910.
5. WEIGHTS INDICATED IN THE STANDARD ARE APPROXIMATE.
6. DESIGNERS SHALL INDICATE 'M' AND RAW MATERIAL CODE IN THE PIECE LIST.

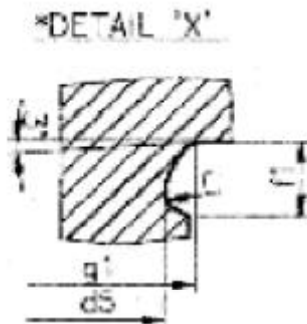

NOM SIZE d1xpitch	d5 -0.3	g1 -0.2	fl +0.3	r	NOM SIZE d1xPITCH	d5 -0.3	g1 -0.2	fl +0.3	r
M10x1	10.3	8.4	2	1	M36x2	36.3	33	4	1.6
M12x1.5	12.3	9.7	3	1.2	M39x2	39.3	36	4	1.6
M16x1.5	16.3	13.7	3	1.2	M42x2	42.3	39.7	3	1.2
M18x1.5	18.3	15.7	3	1.2	M42x2	42.3	39	4	1.6
M20x1.5	20.3	17.7	3	1.2	M45x1.5	45.3	42.7	3	1.2
M20x2	20.3	17.7	3	1.2	M45x2	45.3	42	4	1.8
M24x1.5	24.3	21.7	3	1.2	M48x1.5	48.3	45.7	3	1.2
M27x2	27.3	24	4	1.6	M48x2	48.3	45	4	1.6
M30x1.5	30.3	27.7	3	1.2	M52x1.5	52.3	49.7	3	1.2
M30x2	30.3	27	4	1.6	M52x2	52.3	49	4	1.6
M33x2	33.3	30	4	1.6	M60x2	60.3	57	4	1.6
M36x1.5	36.3	33.7	3	1.2	M64x2	64.3	61	4	1.6

* AS PER DIN 3852, FORM A

RESTRICTED USE

