

09ZJH AS

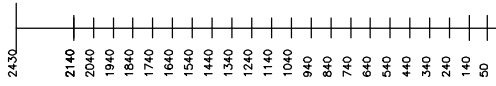

○ = MECHANICALLY COUPLED DOOR
 V = VACANT

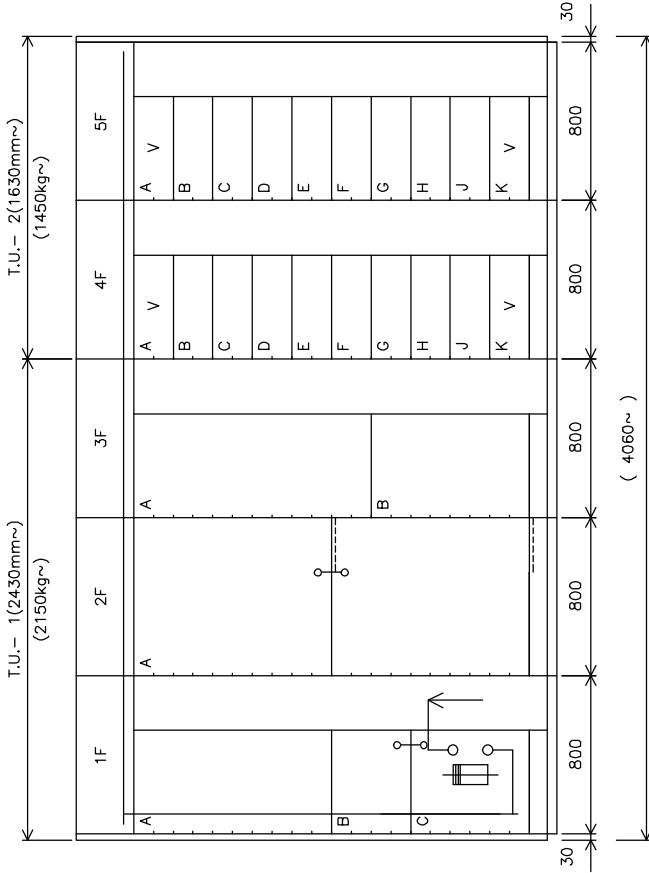

FRONT VIEW

DOP :IP54/IP42
 FORM IV TYPE-6

BOARD MFGD.
 AS PER REV-3
 SIGN | GNK
 DATE | 21.01.2015

EXT.:LIGHT GREY-631 INT.:PEBBLE/FLINT GREY(RAL7032)		
TYPE	PANEL NO.	
TOP	----	
BOTTOM	ALL	
ENTRY		
MAIN EARTHBAR : 6 X 50 CU		
PACKING : REQUIRED		
RECOMMENDED REAR ACCESS : 1500		
RECOMMENDED TOP ACCESS : 1500		
RECOMMENDED FRONT ACCESS : 1500		
DEPTH	PANEL NO.	
644	1F-5F	
HEIGHT	: 2430	
TOTAL LENGTH : (4060~)		
SWBD.DESIGN:		
TO(SF)-FIX		
DRN.BY	AKK	REVISED AS
CHD.BY	HAD	PER BOARD
REV.	3	MFD
DATE	21/01/15	
AKK	REVISED AS	GNK
HAD	PER BOARD	AK
REV.	CUSTOMER	PER CUSTOMER
DATE	COMMENTS	COMMENTS
09/10/14		17/06/14
AKK	REVISED AS	GNK
HAD	PER BOARD	AK
REV.	CUSTOMER	PER CUSTOMER
DATE	COMMENTS	COMMENTS
17/06/14		17/06/14
DRN.BY	AKK	25690
CHD.BY	HAD	
APPD.BY	PER	NOT TO SCALE
DATE	19/05/14	

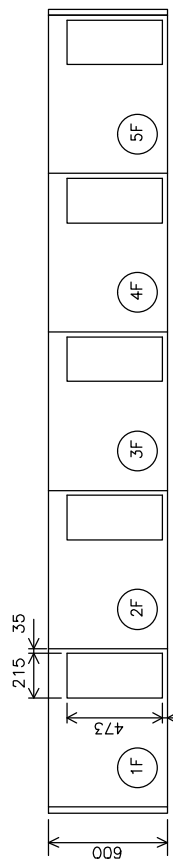

FOUNDATION PLAN

TAG NO:- EC-DSEC-BHL-B003-A
 CUSTOMER : BHEL-H A/C RUPPL
 PROJECT : STG PACKAGE FOR HAZIRA & DAHEJ
 CONSULTANT : BECHTEL
 LARSEN & TOUBRO LIMITED, ENGINEERS, MUMBAI.
 220V DCDB-1
 (FOR DMD)
 (GENERAL ARRANGEMENT DRAWING)
 SY HJ260 3
 SHEET 1 OF 3 REV.

SY YE046

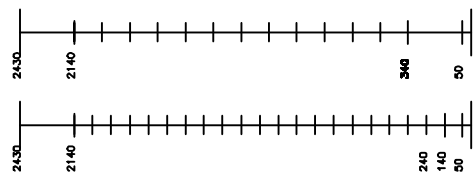

○ = MECHANICALLY COUPLED DOOR
 V = VACANT

FORM IV TYPE-6

DOP - IP42/54

PAINT	EXT.:LIGHT GREY-631 INT.:PEBBLE/FLINT GREY(RAL7032)
TYPE	PANEL NO.
TOP	---
BOTTOM	ALL
CABLE	
MAIN EARTHBAR : 6 X 50 CU	
PACKING : REQUIRED	
RECOMMENDED REAR ACCESS : 1500	
RECOMMENDED TOP ACCESS : 1500	
RECOMMENDED FRONT ACCESS: 1500	
DEPTH	PANEL NO.
944	1F-5F, 7F-8F,10F-15F
1254	6F,9F
HEIGHT	
: 2430	
TOTAL LENGTH :	(11680~)
SWBD.DESIGN: TF+TQ(DF)-DO,TQ(DF)-FIX	

DRN.BY	AKK	REVISED AS PER CUSTOMER COMMENTS	26/06/14
CHD.BY	AKK	REVISED AS PER CUSTOMER COMMENTS	26/06/14
REV.	3	CUSTOMER COMMENTS	14/07/14
DATE	24/07/14		

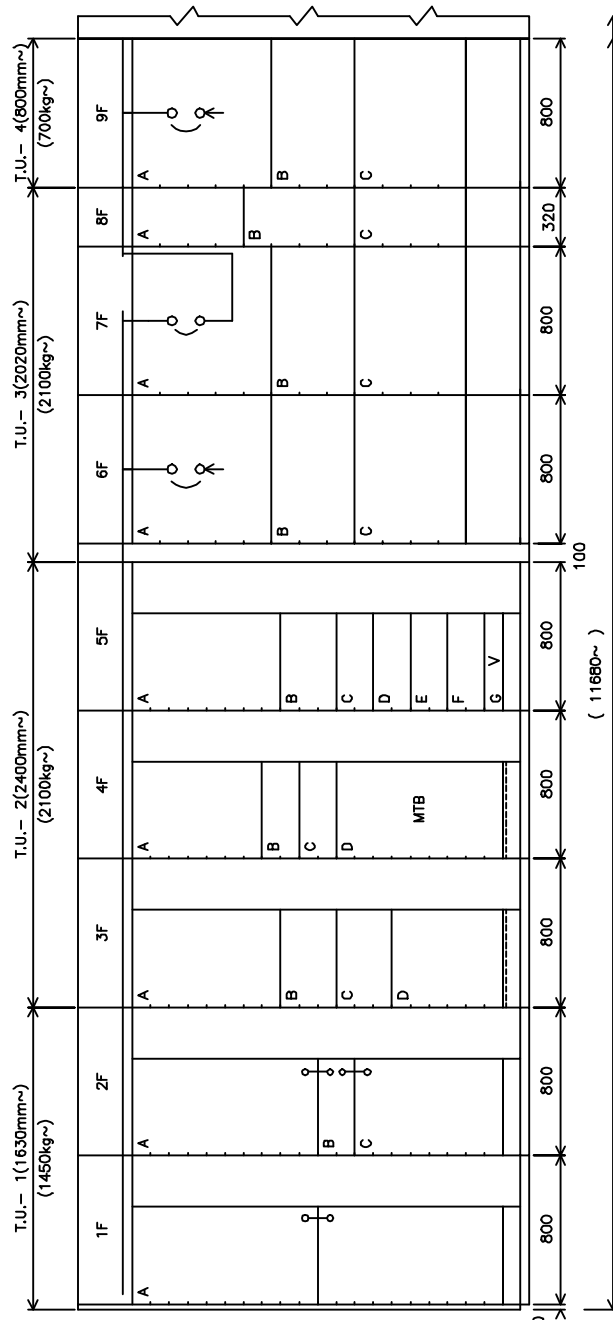

FRONT VIEW

BOARD MFGD. AS PER REV-4
 SIGN /AKK
 DATE 20.11.2014

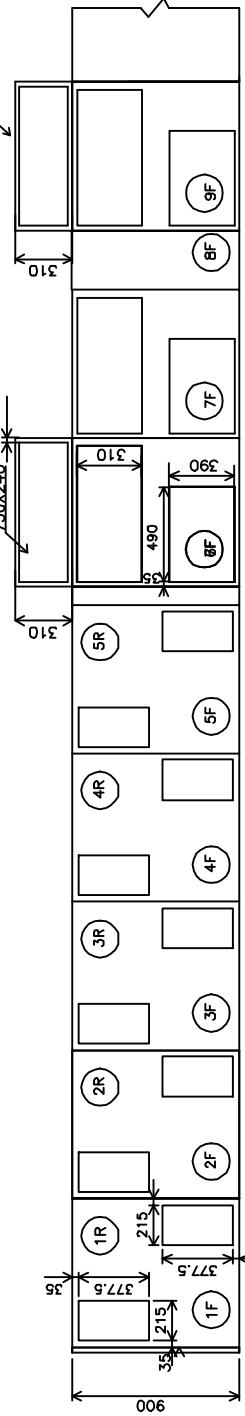

FOUNDATION PLAN

TAG NO.:- EC-DSEC-BHL-B002-A	CUSTOMER : BHEL-HYD A/C RUPPL
	PROJECT : STG PACKAGE FOR HAZIRA & DAHEJ
	CONSULTANT : BECHTEL
LARSEN & TOUBRO LIMITED, ENGINEERS, MUMBAI.	
STG-1 MCC	SY YE046 4
(FOR DMD)	SHEET 1 OF 8
(GENERAL ARRANGEMENT DRAWING)	REV.

SY YE046

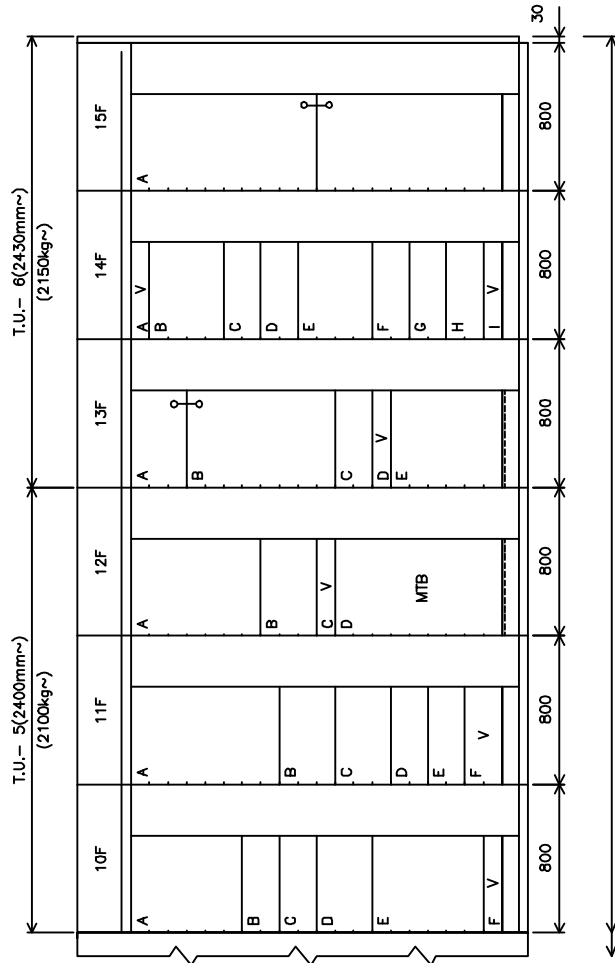

FRONT VIEW

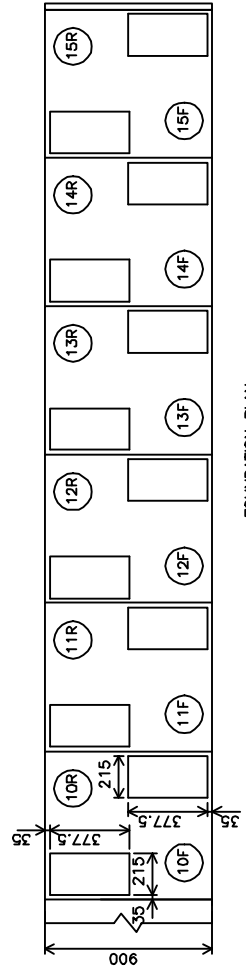

FOUNDATION PLAN

CUSTOMER : BHEL-HYD A/C RUPPL
 PROJECT : STG PACKAGE FOR HAZIRA & DAHEJ
 CONSULTANT : BECHTEL

LARSEN & TOUBRO LIMITED, ENGINEERS, MUMBAI.

STG-1 MCC (FOR DMD) (GENERAL ARRANGEMENT DRAWING)	SY YE046 4
	SHEET 2 OF 8
	REV.

TAG NO:-- EC-DSEC-BHL-B002--A

DRN.BY :AKK	25668
CHD.BY :	
APPD.BY:	NOT TO SCALE
DATE: 07/05/14	

AKK	REVISED AS PER CUSTOMER COMMENTS	DATE
HAD		
4		09/09/14

SY YE046

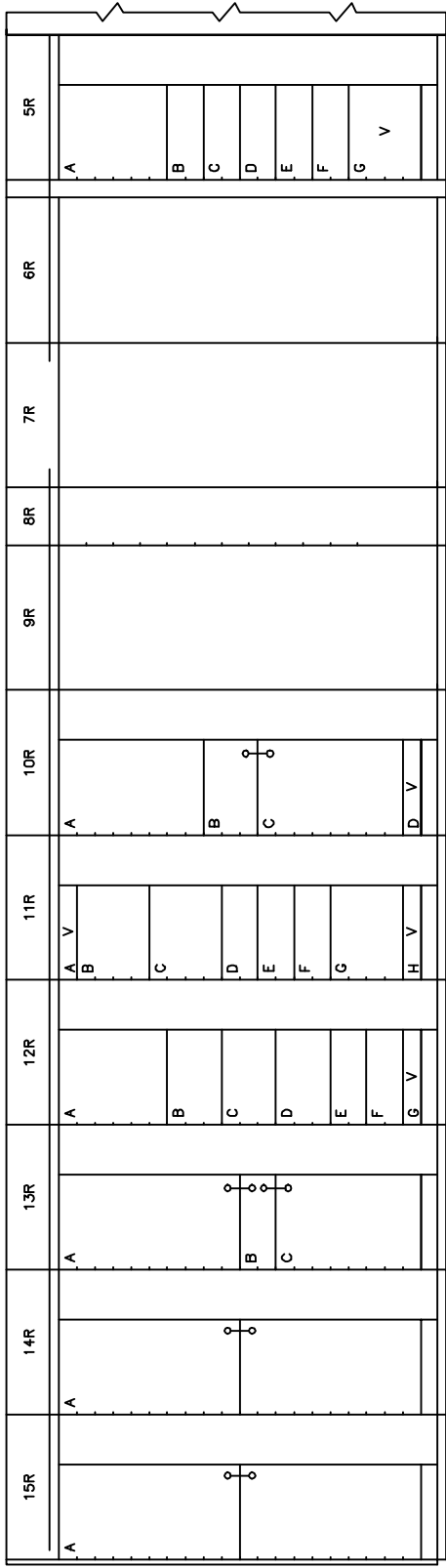

REAR VIEW

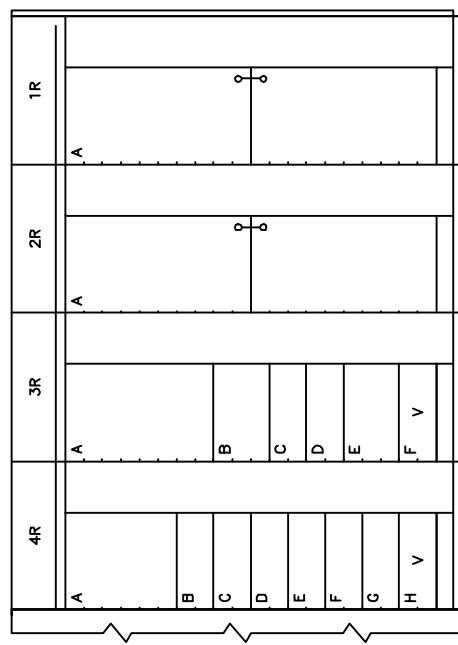

CUSTOMER : BHEL-HYD A/C RUPPL
 PROJECT : STG PACKAGE FOR HAZIRA & DAHEJ
 CONSULTANT : BECHTEL

TAG NO:-- EC-DSEC-BHL-B002--A

LARSEN & TOUBRO LIMITED, ENGINEERS, MUMBAI.

DRN.BY :AKK	25668
CHD.BY :	
APPD.BY:	NOT TO SCALE
DATE: 07/05/14	

STG-1 MCC
 (FOR DMD)
 (GENERAL ARRANGEMENT DRAWING)

SY YE046	4
SHEET 3 OF 8	REV.

SY HB537

2430	2430
2140	2140
2040	1990
1940	1840
1840	1740
1740	1680
1640	1540
1540	1440
1440	1390
1340	1240
1240	1090
1140	1040
1040	940
940	840
840	790
740	640
640	540
540	440
440	340
340	240
240	140
140	50

○ = MECHANICALLY COUPLED DOOR

V = VACANT

V1 = VACANT CANNOT BE USED

DOP:IP54/IP42

FORM IV TYPE-6

EXT.:LIGHT GREY-631	
INT.:PEBBLE/FLINT GREY(RAL7032)	
PAINT	
TYPE	PANEL NO.
TOP	----
BOTTOM	ALL
CABLE ENTRY	
MAIN EARTHBAR : 6 X 50 CU	
PACKING : REQUIRED	
RECOMMENDED REAR ACCESS : 1500	
RECOMMENDED TOP ACCESS : 1500	
RECOMMENDED FRONT ACCESS : 1500	
DEPTH	PANEL NO.
944	1F-2F,13F
1444	3F,4F,6F-7F,9F-12F
1754	5F,8F
HEIGHT : 2530~ WITH HOOD	
TOTAL LENGTH : (9660~)	
SWBD:DESIGN:	
TF, TO(DF)-DO	

DRN.BY	AK	REVISED AS	AK	GNK	REVISED AS	AK	DRN.BY	AKK	25688
CHD.BY	AK	PER	AK	AK	PER	AK	CHD.BY	AKK	
REV.	3	CUSTOMER	2	COMMENTS	1	CUSTOMER	APPD.BY:HAD		NOT TO SCALE
DATE	14/07/14	COMMENTS	07/07/14	COMMENTS	16/06/14	COMMENTS	DATE	05/05/14	

ALL DIMENSIONS ARE IN mm

GEN. NOTES & MBOM : SCH0900A

STD. GENERAL NOTES :

DUCT ENTRY DRAWING :

REFERENCE DRAWINGS

FOUNDATION PLAN

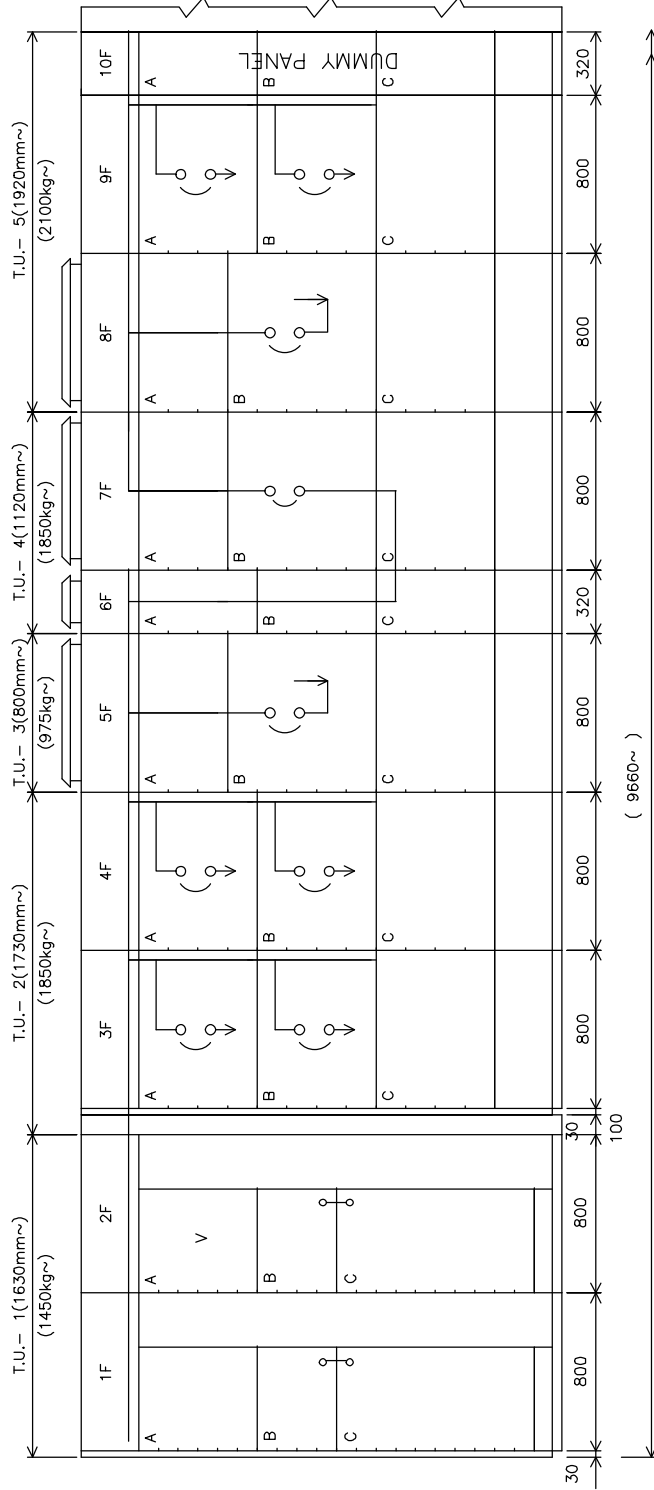

FRONT VIEW

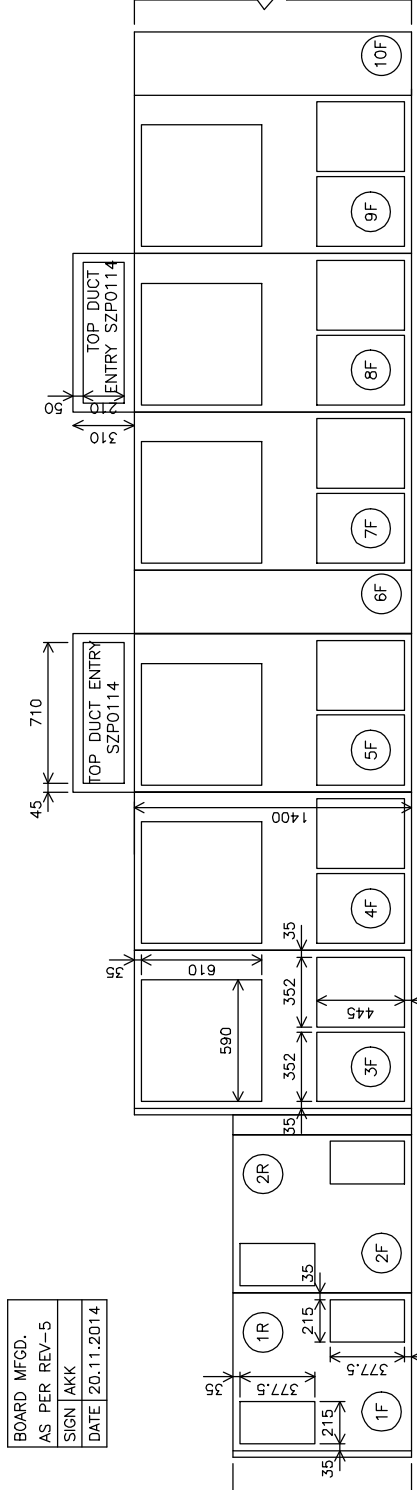

TAG NO:- EC-DSEC-BHL-B001-A

CUSTOMER : BHEL-HYD A/C RUPPL
PROJECT : STG PACKAGE FOR HAZIRA & DAHEJ
CONSULTANT : BECHTEL

LARSEN & TOUBRO LIMITED, ENGINEERS, MUMBAI.
415V STG-1/2 PCC
(FOR DMD)
(GENERAL ARRANGEMENT DRAWING)

SY HB537 5
SHEET 1 OF 6
REV.

SY HB537

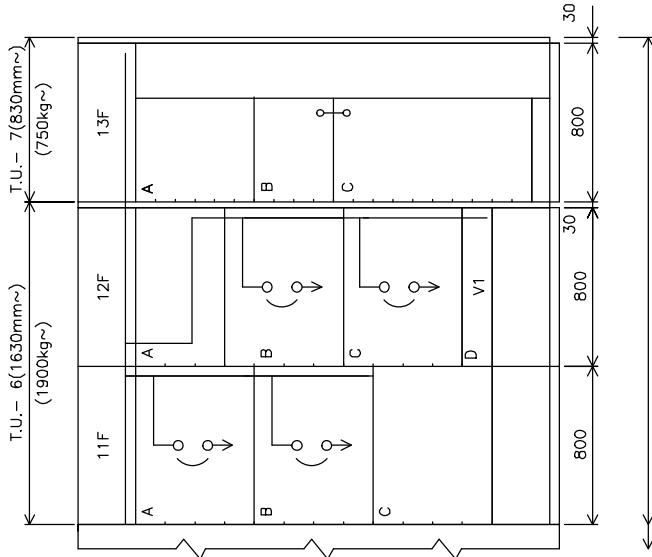

FRONT VIEW

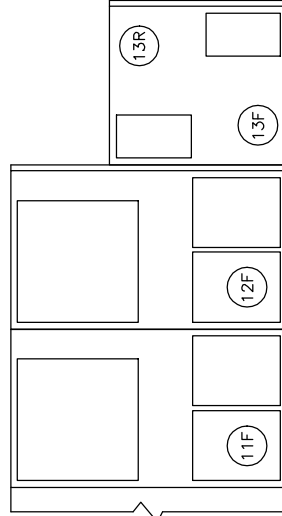

FOUNDATION PLAN

TAG NO:- EC-DSEC-BHL-B001-A

CUSTOMER : BHEL-HYD A/C RUPPL
 PROJECT : STG PACKAGE FOR HAZIRA & DAHEJ
 CONSULTANT : BECHTEL

LARSEN & TOUBRO LIMITED, ENGINEERS, MUMBAI.

415V STG-1/2 PCC
 (FOR DMD)
 (GENERAL ARRANGEMENT DRAWING)

SY HB537 5
 SHEET 2 OF 6
 REV.

REVISED AS PER CUSTOMER COMMENTS	AKK	DATE	DRN.BY :AKK	25688
REVISED AS PER CUSTOMER COMMENTS	AKK	09/09/14	CHD.BY :AKK	
REVISED AS PER CUSTOMER COMMENTS	AKK	20/11/14	APPD.BY:HAD	NOT TO SCALE
	5		DATE: 05/05/14	

SY HB537

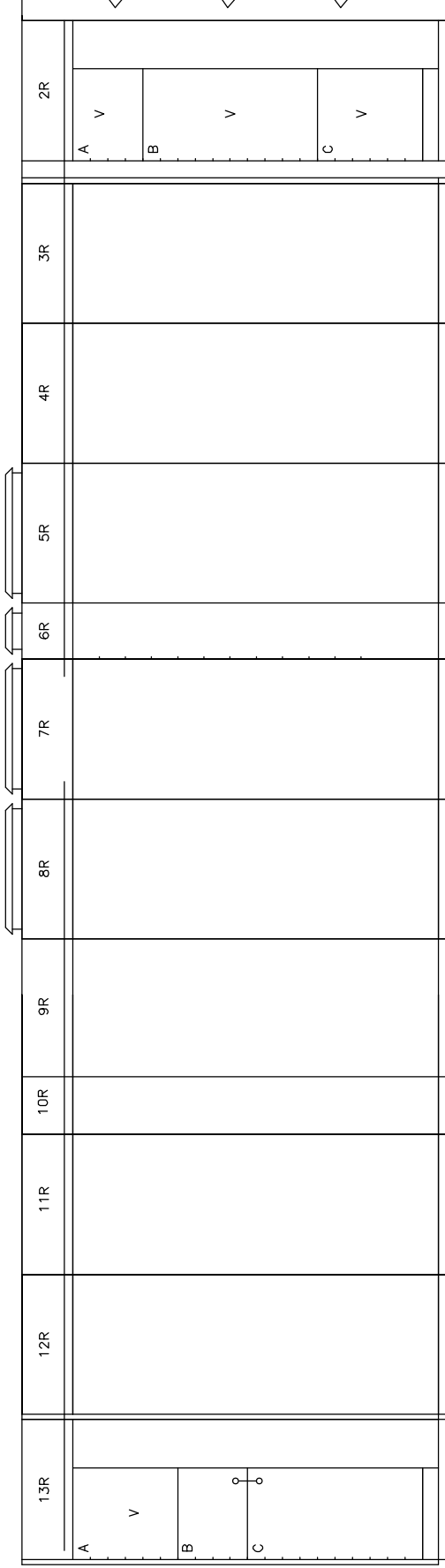

REAR VIEW

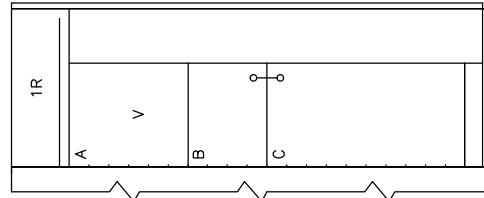

TAG NO:- EC-DSEC-BHL-B001-A

CUSTOMER : BHEL-HYD A/C RUPPL
 PROJECT : STG PACKAGE FOR HAZIRA & DAHEJ
 CONSULTANT : BECHTEL

LARSEN & TOUBRO LIMITED, ENGINEERS, MUMBAI.

DRN.BY :AKK	25688
CHD.BY :AKK	
APPD.BY:HAD	NOT TO SCALE
DATE: 05/05/14	

415V STG-1/2 PCC (FOR DMD) (GENERAL ARRANGEMENT DRAWING)	SY HB537 5
	SHEET 3 OF 6
	REV.

SY HJ263

2430	2430
2140	2140
2040	1980
1940	1840
1840	1740
1740	1680
1640	1540
1540	1390
1440	1240
1340	1090
1240	940
1140	790
1040	640
940	490
840	340
740	240
640	140
540	50
440	
340	
240	
140	
50	

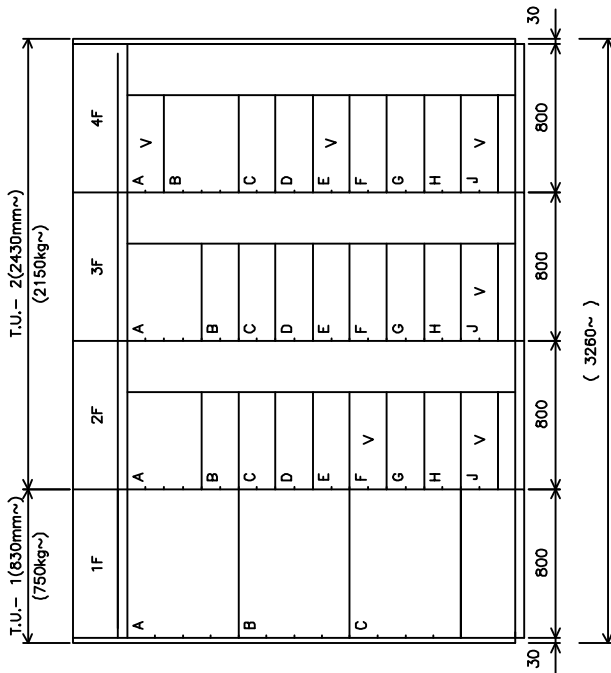

FRONT VIEW

V = VACANT

DOP : IP54

FORM IV Type-6

BOARD MFGD.
AS PER REV-3
SIGN /GNK
DATE 21.01.2015

EXT.:LIGHT GREY-631
INT.:PEBBLE/FLINT GREY(RAL7032)

TYPE	PANEL NO.
TOP	---
BOTTOM	ALL
MAIN EARTHBAR	: 6 X 50 CU
PACKING	: REQUIRED
RECOMMENDED REAR ACCESS	: 1500
RECOMMENDED TOP ACCESS	: 1500
RECOMMENDED FRONT ACCESS	: 1500
DEPTH	PANEL NO.
644	2F-4F
944	1F
HEIGHT	: 2430
TOTAL LENGTH	: (3260~)

FOUNDATION PLAN

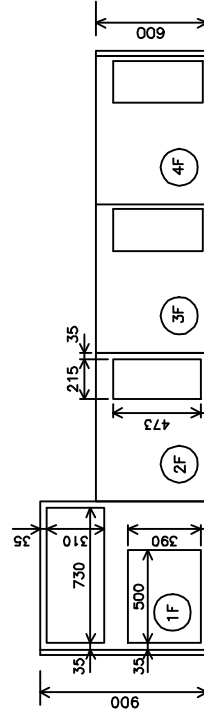

FOUNDATION PLAN

TAG NO:- EC-DSEC-BHL-B004-A

CUSTOMER : BHEL-H A/C RUPPL
PROJECT : STG PACKAGE FOR HAZIRA & DAHEJ
CONSULTANT : BECHTEL

LARSEN & TOUBRO LIMITED, ENGINEERS, MUMBAI.

UPS DB-1
(FOR DMD)
(GENERAL ARRANGEMENT DRAWING)

DRN.BY :AKK
CHD.BY :AKK
REV. :3
DATE :24/10/14

REVISED AS PER CUSTOMER COMMENTS
REVISED AS PER CUSTOMER COMMENTS
REVISED AS PER CUSTOMER COMMENTS

DRN.BY :AKK
CHD.BY :AKK
REV. :1
DATE :16/05/14

REVISED AS PER CUSTOMER COMMENTS
REVISED AS PER CUSTOMER COMMENTS
REVISED AS PER CUSTOMER COMMENTS

DRN.BY :AKK
CHD.BY :HAD
REV. :2
DATE :08/10/14

REVISED AS PER CUSTOMER COMMENTS
REVISED AS PER CUSTOMER COMMENTS
REVISED AS PER CUSTOMER COMMENTS

DRN.BY :AKK
CHD.BY :HAD
REV. :3
DATE :24/10/14

SY HJ263
SHEET 1 OF 3
REV.

The contents of this Drawing are the sole property of C&S ELECTRIC LTD. and they should neither be copied nor given to a third person without the prior permission of Company.

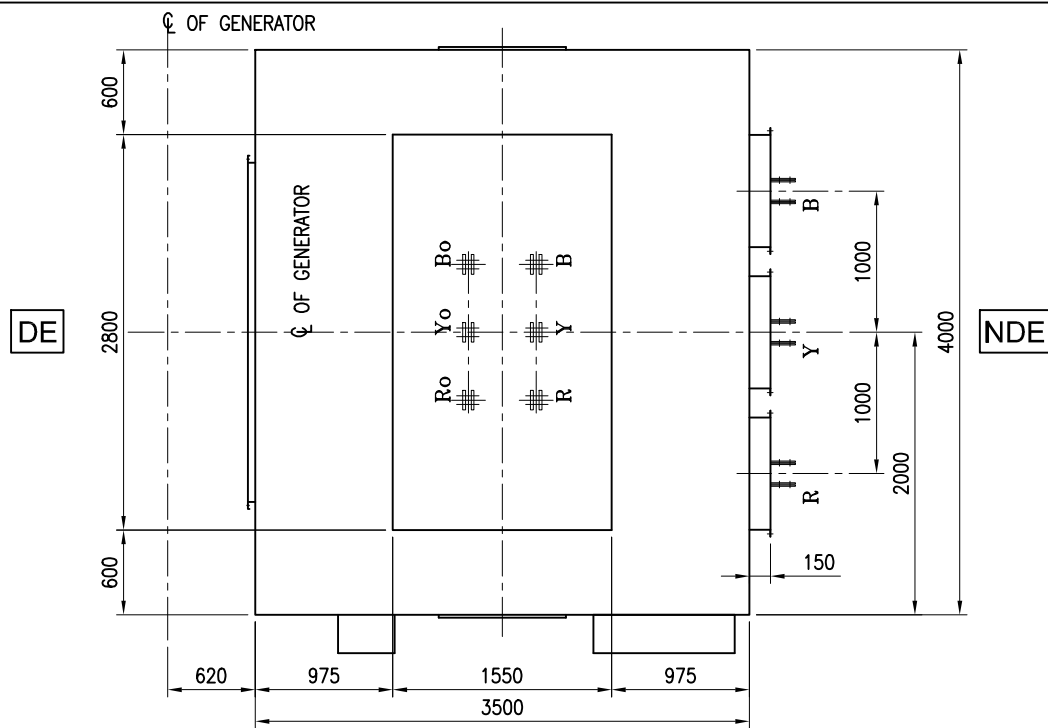

PLAN
(CIVIL DETAILS NOT SHOWN FOR CLARITY)

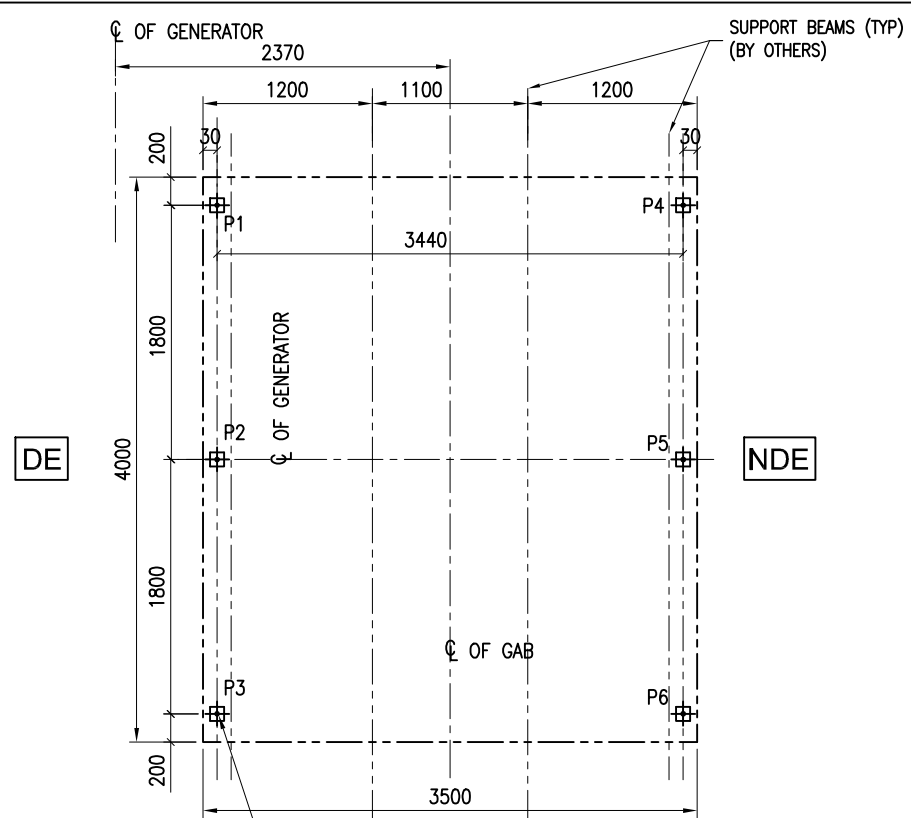

FOUNDATION PLAN

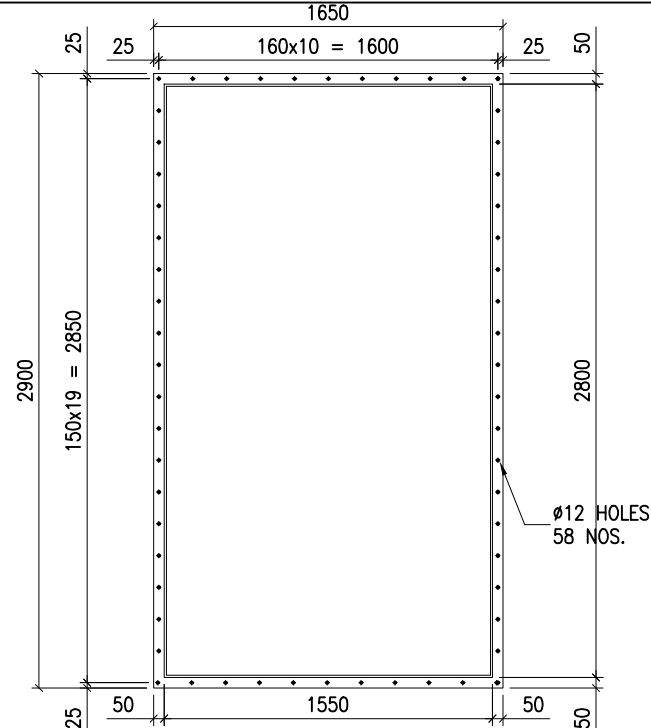

DETAIL: G
(ONLY FLANGE DETAILS SHOWN FOR CLARITY)

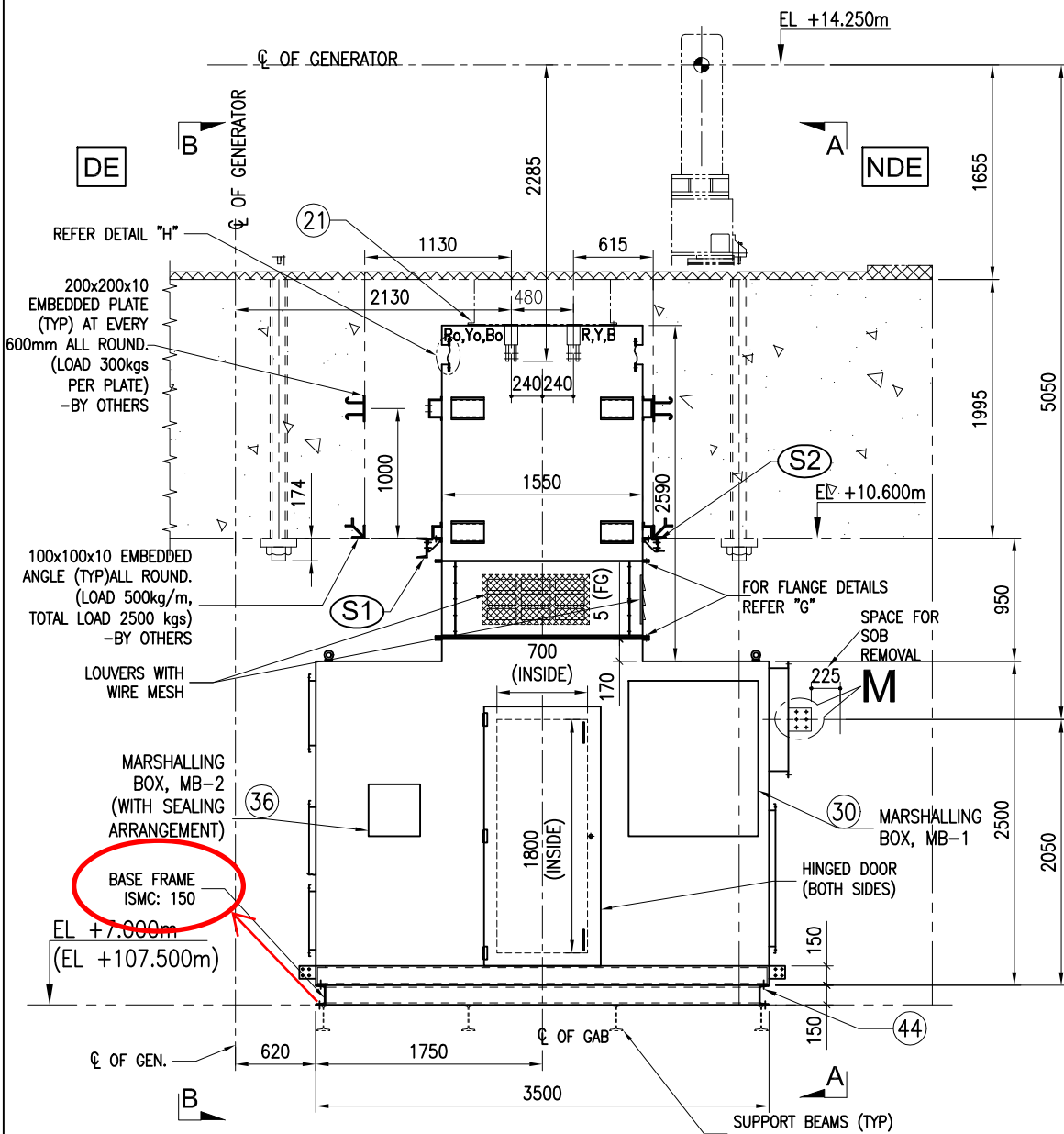

ELEVATION

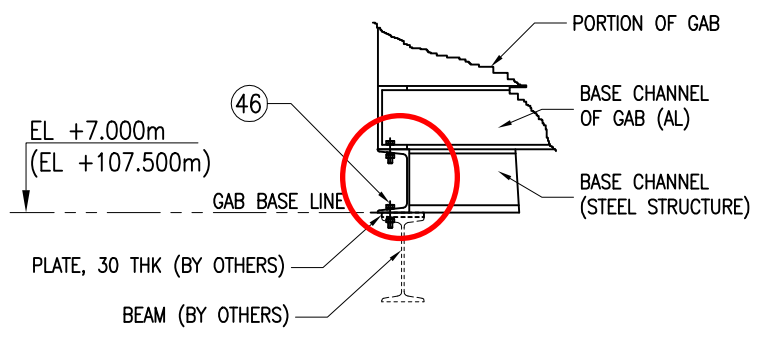

FOUNDATION FIXING DETAIL OF GAB

LOAD DATA:

DEAD LOAD : 12,000 kgf
LIVE LOAD : 215 kgf/m
SEISMIC : ZONE III

LOAD TABLE						
SUPPORT LOCATION	L/C	Horizontal			Moment	
		Fx kg (-/+)	Fy kg (-/+)	Fz kg (-/+)	Mx kgm (-/+)	Mz kgm (-/+)
P1	301 DL+LL	27	1871	0	0	2.76
P2	301 DL+LL	0	3306	0	0	0
P3	301 DL+LL	-53	3220	0	0	76.06
P4	301 DL+LL	-53	3220	0	0	76.06
P5	301 DL+LL	0	3306	0	0	0
P6	301 DL+LL	-53	3220	0	0	76.06

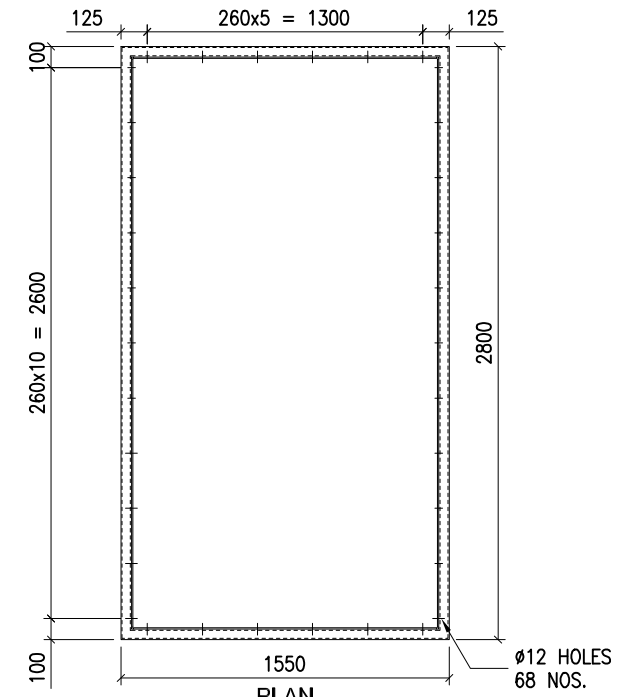

PLAN

ELEVATION

DETAIL: H

RUPPL Doc. Num: 10090-6239976-HSAC-E-BHG-H02-004-05
BHEL Doc. Num: HY-DG-3-54111-83449/REV 05

C&S Electric Ltd.
B-1, SITE-IV, SURAJPUR INDL. AREA, KASNA ROAD, GREATER NOIDA
GAUTAM BUDDH NAGAR (U.P.)
BUSDUCT DIVISION

CUSTOMER	BHEL HYDERABAD
P.O. NO.	LOI Dated 15.02.14
PROJECT	4X93.1MW STG, CCPP, Hazra Manufacturing Division (HMD).
CONSULTANT	-
DRG. TITLE	GA. & FOUNDATION PLAN OF GENERATOR ADAPTOR BOX FOR 4X93.1MW STG. (GAB)
DATE:	13.03.14
DRG. NO.:	C-1694-0314-18742
SCALE:	N.T.S
REV. 05	SHEET: 6 CONT. 7

ALL DIMENSIONS ARE IN mm UNLESS OTHERWISE SPECIFIED