



PRODUCT STANDARD
INDUSTRIAL TURBINES & COMPRESSORS

TC 5 6212

PAGE: 1 OF 8

CONTROLLED COPY

NIPPLE REDUCER

BW NPT

1.0 SCOPE

THIS STANDARD COVERS REQUIREMENTS OF NIPPLE REDUCERS FOR COMPRESSOR PROJECTS. GENERALLY INSTRUMENT/MACHINE CONNECTIONS ARE SMALLER THAN PIPE LINES. BY THE HELP OF NIPPLE REDUCERS/ INSTRUMENTS / MACHINES SHALL BE CONNECTED TO PIPE LINES TO THE SYSTEM.

2.0 MATERIAL SPECIFICATION

THE RAW MATERIAL SPECIFICATION SHALL BE AS PER ENQUIRY WHICH CAN BE ANY ONE OF THE FOLLOWING

- 2.1 ASTM A 106 GR B (C.S) (CARBON SHALL BE RESTRICTED TO 0.22% MAX.)
- 2.2 ASTM A 312 TP 321 (S.S)

3.0 SIZES AND DIMENSIONS

AS INDICATED IN THE DRAWING BELOW

4.0 PROCESS

THE NIPPLE REDUCERS SHALL BE MANUFACTURED BY HOT PRESSING/FORGING

5.0 TESTS AND HEAT TREATMENT

TESTS AND HEAT TREATMENT SHALL BE AS PER THE RELAVANT MATL. STDS. ACCEPTANCE TO ANY DEVIATIONS/OPTIONS SHALL BE OBTAINED FROM PURCHASER

6.0 THREADING

THREADING SHALL BE AS PER ANSI STANDARED (NPT) TAPER PIPE THRADING CONFORMING TO ANSI B 2.1 - 1968.

7.0 INSPECTION

THESE ITEMS SHALL BE INSPECTED FOR EXTERNAL DIMENSIONS AND MANUFACTURING DEFECTS:AS SURFACE CRACKS ETC. BY M/o LLOYDS.

COPYRIGHT AND CONFIDENTIAL
 The information on this document is the property of **BHARAT HEAVY ELECTRICALS LIMITED.**
 It must not be used directly or indirectly in any way detrimental to the interest of the company

h No: TD-106-1 REV.1
 Ref. Doc:

Concured: STANDARDS	Revision: 01	Issued: EDC (INDUSTRIAL TURBINES & COMPRESSORS) HYDERABAD	Prepared: SBB	Approved: RBC	Date: 02-09-1982
	Date: 02-09-1982				



PRODUCT STANDARD
INDUSTRIAL TURBINES & COMPRESSORS

TC 5 6212

PAGE: 2 OF 8

REV 01

NIPPLE REDUCER

BW NPT

8.C TEST CERTIFICATES

TEST CERTIFICATES SHALL BE SUPPLIED ALONG WITH SUPPLIES IN TRIPPLICATE WITH ONE REPRODUCIBLE COPY WITH M/S LLOYDS ATTESTATION

9.0 DESIGNATION

9.1 NAME OF THE PART SHALL BE AS BELOW
C.S. NIP. REDUCER 1 1/2 BW X 1/2 NPT SCH XXS.

9.2 MATERIAL SPECIFICATION SHALL BE AS BELOW
TC 5 6212 VAR. NO.

10.0 MARKING

EACH ITEM SHALL BE MARKED (BY PUNCH MARKING) GIVING THE FOLLOWING DETAILS

10.1 MANUFACTURERS TRADE MARK

10.2 TITLE AS NIPPLE REDUCER

10.3 SIZE X X X X X

10.4 SCHEDULE NUMBER

10.5 TC 56212X

10.6 VAR NO

10.7 MATERIAL SPECIFICATION

10.8 COMPONENT CODE

10.9 INSPECTION AUTHORITY MARKING

11.0 PROTECTION

ITEMS SHALL BE PROTECTED FROM RUST PREFERABLY TREATED WITH PLASTIC COATING PEEL-OFF TYPE

12.0 PACKING AND DISPATCH

ALL ITEMS SHALL BE PACKED PROPERLY TO PROTECT FROM MECHANICAL DAMAGE DURING TRANSPORT AND STORAGE

COPYRIGHT AND CONFIDENTIAL
The information on this document is the property of BHARAT HEAVY ELECTRICALS LIMITED. It must not be used directly or indirectly in any way detrimental to the interest of the company.

No:
TD-106-2 REV.1

Ref. Doc:

Concured:
STANDARDS



REV 01

Form No: TT-10P-2 RE/1
Ref. Doc:
Copyright and Confidential
The information on this document is the property of BHARAT HEAVY ELECTRICALS LIMITED.
It must not be used directly or indirectly in any way detrimental to the interest of the company

NIPPLE REDUCER
BW, NPT

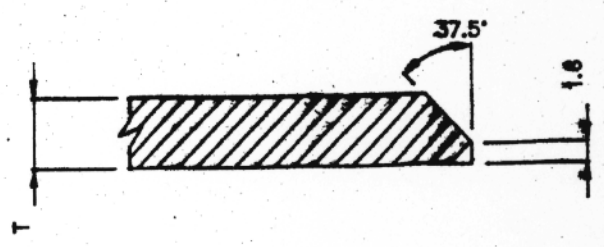
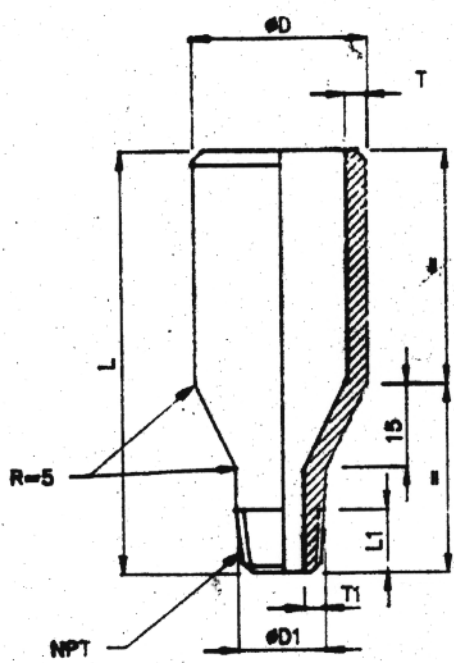

REFERENCE DRAWING

METAL-A

Concured:
STANDARDS

Concured:

STANDARDS

COPYRIGHT AND CONFIDENTIAL

The information on this document is the property of **BRAT HEAVY ELECTRICALS LIMITED.** It must not be used directly or indirectly in any way detrimental to the interest of the company

Ref. Doc:

Part No:

TD-106-2 REV.1

NIPPLE REDUCER

BW NPT



PRODUCT STANDARD
INDUSTRIAL TURBINES & COMPRESSORS

TC 5 6212

PAGE: 4 OF 8

ALL DIMENSIONS IN mm
Wt IN KGS.

REV 01

VAR NO	SIZE	SCH NO	D	D1	T	T1	L	L1	MATL SPN	WT/ Pc	COMPONENT CODE
01	1/2" BW x 1/4" NPT	80	21.34	13.72	3.73	3.02	70	15	A106B	0.1	TC 9756 212 012
02	3/4" BW x 1/4" NPT	80	26.67	13.72	3.91	3.02	76	15	A106B	0.1	TC 9756 212 020
03	3/4" BW x 1/2" NPT	80	26.67	21.34	3.91	3.73	76	20	A106B	0.15	TC 9756 212 039
04	1" BW x 1/4" NPT	80	33.4	13.72	4.55	3.02	90	15	A106B	0.19	TC 9756 212 047
05	1" BW x 1/2" NPT	80	33.4	21.34	4.55	3.73	90	20	A106B	0.23	TC 9756 212 055
06	1" BW x 3/4" NPT	80	33.4	26.67	4.55	3.91	90	20	A106B	0.25	TC 9756 212 063
07											
08	1 1/2" BWx1/2" NPT	80	48.26	21.34	5.08	3.73	115	20	A106B	0.42	TC 9756 212 080
09	1 1/2" BWx3/4" NPT	80	48.26	26.67	5.08	3.91	115	20	A106B	0.45	TC 9756 212 098
10	1 1/2" BWx1" NPT	80	48.26	33.4	5.08	4.55	115	20	A106B	0.51	TC 9756 212 101

COPYRIGHT AND CONFIDENTIAL
 The information on this document is the property of BHARAT HEAVY ELECTRICALS LIMITED.
 It must not be used directly or indirectly in any way detrimental to the interest of the company

Ref. Doc: TD-106-2 REV.1
 Item No:

NIPPLE REDUCER
 BW NPT



ALL DIMENSIONS IN mm
 WT IN KGS.

PRODUCT STANDARD
 INDUSTRIAL TURBINES & COMPRESSORS

TC 5 6212
 PAGE: 5 OF 8

REV 01

VAR NO	SIZE	SCH NO	D	D1	T	T1	L	L1	MATL SPN	Wt/Pc	COMPONENT CODE
11											
12	3/4"BW x 1/2" NPT	XXS	26.67	21.34	7.82	7.47	76	20	A106B	0.24	TC 9756 212 128
13											
14											
15	1"BW x 1/2" NPT	XXS	33.4	21.34	9.09	7.47	90	20	A106B	0.37	TC 9756 212 152
16	1"BW x 3/4" NPT	XXS	33.4	26.67	9.09	7.82	90	20	A106B	0.42	TC 9756 212 160
17											
18	1 1/2"BWx1/2"NPT	XXS	48.26	21.34	10.16	7.47	115	20	A106B	0.71	TC 9756 212 187
19	1 1/2"BWx3/4"NPT	XXS	48.26	26.67	10.16	7.82	115	20	A106B	0.77	TC 9756 212 195
20	1 1/2"BWx1"NPT	XXS	48.26	33.4	10.16	9.09	115	25	A106B	0.87	TC 9756 212 209

DARDS

Concured:

STANDARDS

COPYRIGHT AND CONFIDENTIAL

The information on this document is the property of BEARAT HEAVY ELECTRICALS LIMITED. It must not be used directly or indirectly in any way detrimental to the interest of the company

Ref. Doc:

Form No:

TD-106-2 REV.1.

NIPPLE REDUCER

BW NPT



PRODUCT STANDARD
INDUSTRIAL TURBINES & COMPRESSORS

TC 5 6212

PAGE: 6 OF 8

REV 01

ALL DIMENSIONS IN mm
WT IN KGS.

VAR NO	SIZE	SCH NO	D	D1	T	T1	L	L1	MATL SPN	Wt/Pc	COMPONENT CODE
21	1/2"BW x 1/4" NPT	80s	21.34	13.72	3.73	3.02	70	15	TP321	0.1	TC 9756 212 217
22	3/4"BW x 1/4" NPT	80s	26.67	13.72	3.91	3.02	76	15	TP321	0.11	TC 9756 212 225
23	3/4"BW x 1/2" NPT	80s	26.67	21.34	3.91	3.73	76	20	TP321	0.15	TC 9756 212 233
24	1"BW x 1/4" NPT	80s	33.4	13.72	4.55	3.02	90	15	TP321	0.19	TC 9756 212 241
25	1"BW x 1/2" NPT	80s	33.4	21.34	4.55	3.73	90	20	TP321	0.23	TC 9756 212 250
26	1"BW x 3/4" NPT	80s	33.4	26.67	4.55	3.91	90	20	TP321	0.25	TC 9756 212 268
27											
28	1 1/2"BWx1/2"NPT	80s	48.26	21.34	5.08	3.73	115	20	TP321	0.42	TC 9756 212 284
29	1 1/2"BWx3/4"NPT	80s	48.26	26.67	5.08	3.91	115	20	TP321	0.45	TC 9756 212 292
30	1 1/2"BWx1"NPT	80s	48.26	33.4	5.08	4.55	115	25	TP321	0.51	TC 9756 212 306

Concured:
STANDARDS

The information on this document is the property of BEHARAT HEAVY ELECTRICALS LIMITED. It must not be used directly or indirectly in any way detrimental to the interest of the company.

Ref. Doc:
TD-106-2 REV.1

In No:

NIPPLE REDUCER
BW NPT



PRODUCT STANDARD
INDUSTRIAL TURBINES & COMPRESSORS

TC 5 6212
PAGE: 7 OF 8

REV 01

ALL DIMENSIONS IN mm
WT IN KGS.

VAR NO	SIZE	SCH NO	D	D1	T	T1	L	L1	MATL SPN	Wt/Pc	COMPONENT CODE
31											
32											
33	3/4"BW x 1/2" NPT	XXS	26.67	21.34	7.82	7.47	76	20	TP321	0.24	TC 9756 212 330
34											
35	1"BW x 1/2" NPT	XXS	33.4	21.34	9.09	7.47	90	20	TP321	0.37	TC 9756 212 367
36	1"BW x 3/4" NPT	XXS	33.4	26.67	9.09	7.82	90	20	TP321	0.42	TC 9756 212 365
37											
38	1 1/2"BWx1/2"NPT	XXS	48.36	21.34	10.16	7.47	115	20	TP321	0.71	TC 9756 212 381
39	1 1/2"BWx3/4"NPT	XXS	48.36	26.67	10.16	7.82	115	20	TP321	0.77	TC 9756 212 390
40	1 1/2"BWx1"NPT	XXS	48.36	33.4	10.16	9.09	115	25	TP321	0.87	TC 9756 212 408

