

TECHNICAL SPECIFICATION AGAINST BHEL ENQUIRY NO. 7458/S/6220/13/5847A

Sl. No.	ITEM DESCRIPTION	QUANTITY	UNIT	LOT NO	DELIVERY SCHEDULE
1	HW8137143424 BELLOW COVER GUIDES AS PER DRG NO.-BACH-SP-3 , REV-00 . SIZE: - DIM.: -	10	NO	1	30.08.2014
2	HW8137340025 BELLOW COVER AS PER DRG. NO. BRV-70-SP-4	2	NO	1	30.08.2014
3	HW8137342354 LONG BED SLIDE BELLOW COVER(NY LON) AS PER DRG. NO. BRV-70-SP-09. REV.00 N.STD: SURFACE GRINDER, BRV-70 SIZE: - DIM.: -	4	NO	1	30.08.2014
4	HW8169920019 BELLOW COVER AS PER DRG. NO. KO5239-SP-12	4	NO	1	30.08.2014
5	HW8117540037 TELESCOPIC COVER AS PER DRG. NO.: D1800-SP-14	1	NO	1	30.08.2014
6	HW8117533642 TELESCOPIC COVER X AXIS GUIDEWAYS AS PER DRG NO D-2300-SP-3 2 REV 00 FOR CNC LATHE MODEL D-2300 .	1	NO	1	30.08.2014
7	HW8117592398 TELESCOPIC COVER (X-AXIS) KV2-1100-SP-4 (REV.01)	1	ST	1	30.08.2014
8	HW8126543205 SUPPLY AND FITTING OF TABLE FRONT AND BACK TELESCOPIC COVER AS PER DRG. NO: W200-HB-SP-09	1	ST	1	30.08.2014
9	HW8126543213 SUPPLY AND FITTING OF LONGITUDINAL LEFT AND RIGHT TELESCOPIC COVER AS PER DRG. NO:HW200-SP-10	1	ST	1	30.08.2014
10	HW8136220298 SUPPLY AND COMMISSIONING OF BELLOW COVER AS PER DRG. NO. RX-7-SP-1	1	NO	1	30.08.2014
11	HW8115920975 SUPPLY AND COMMISSIONING OF BELLOW COVER AS PER DRG. NO. TMD-40-50-SP-10	1	NO	1	30.08.2014

Note:

1. Drawings are for estimation purpose only. Vendors are advised to take dimensions and other details at their own before execution of order.

2. Any outside modification / repair required for fitment of supplied covers will be done by vendor.

3. Vendor shall use existing support or provide / repair the support required for fitment of covers.

4. For item nos. 1 to 4 of the tender enquiry:

(a) Commissioning will be done by BHEL. (Vendor will only supply material as per specification however, commissioning will be in the scope of BHEL).

(b) Warranty certificate required for 18 months from the date of material despatch.

5. For item nos. 5 to 11 of the tender enquiry:

(a) Commissioning will also be done by vendor at HEEP, BHEL, Haridwar. (Material will be supplied by vendor and commissioning will also be in the scope of vendor)

(b) Warranty certificate required for 12 months from the date of commissioning.

BACH-SP-3

DRAWING No.

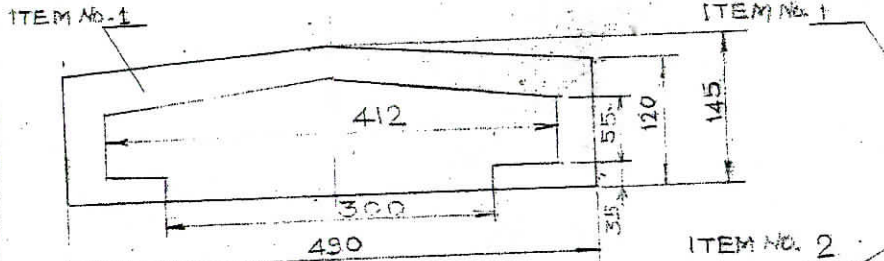

MATERIAL - STEEL SHEET 3mm THICK
END PLATE

ITEM No.	DESCRIPTION	QTY
1	STEEL SHEET 3mm THICK END PLATE	2 Nos
2	BELLOW	1 No.
3	SUPPORT	25 Nos

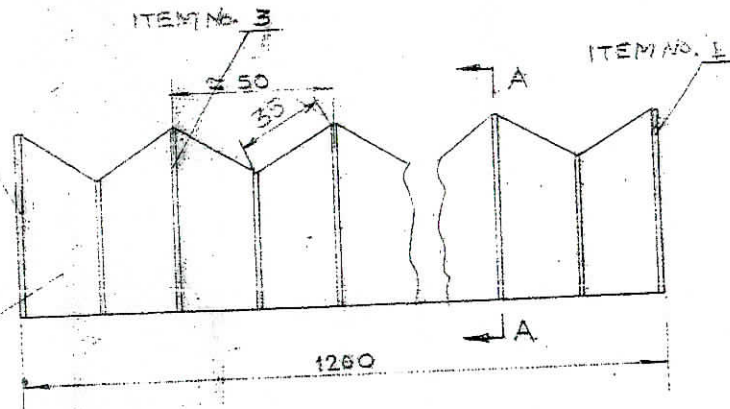

LENGTH IN CLOSED CONDITION

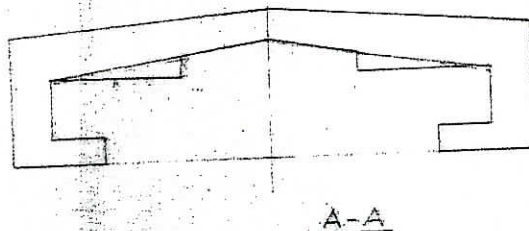

- NOTE - MATERIAL OF BELLOW SHOULD BE WATERPROOF NYLON / EQUIVALENT MATERIAL
- 2- BELLOW COVERS ARE USED ON C.H. BACK GRINDING M/C WHERE COOLANT (WATER BASE) DIRECTLY FALL ON THE BELLOW COVERS
 - 3- SUPPLIER SHOULD CHOOSE SUITABLE MATERIAL
 - 4- DRG. DIMENSIONS ARE APPROX. FINAL DRG. DIMENSIONS SHOULD BE TAKEN BY THE SUPPLIER FROM THE M/C

withdral
In Date 2013/3/06

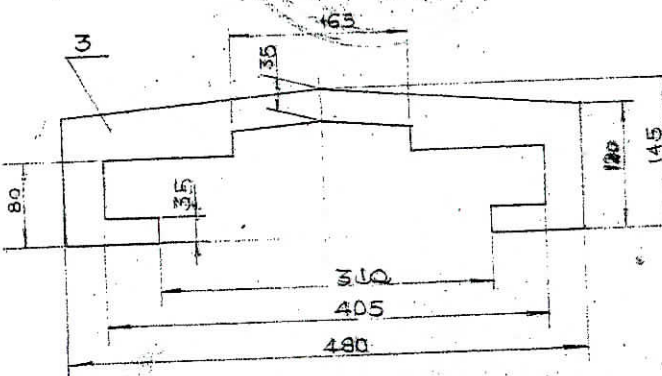

MATERIAL - PLASTIC/NYLAM SHEET 1mm THICK
OR SIMILAR MATERIAL
SUPPORT

VAR OQ		REMARKS		ITEM No.	DESCRIPTION	STD	DRAWING No.	MATERIAL CODE		UNIT	UNIT WEIGHT
59 64 65		75 25 27 29		58 59 60	77	32 33 46	54	55 56 57 66	58	59	60
CARD TYPE-3		28		28		CARD TYPE-1		CARD TYPE-2			
GMS No./GR. SP. No.				STATUS OF DRG.		TYPE OF PRODUCT OR NAME OF CUSTOMER/PROJECT					
AGREED DEPT				NAME SIGN DATE		C.H. BACH GRINDER (DS-600)					
						BHARAT HEAVY ELECTRICALS LTD.					
						HARDWAR					
REV DATE ALTERED CHECKED				DEPT. WEX		GRADE OF INTOLDIM C/M/F		SCALE		WEIGHT (KG)	
ZONE				CODE DESIGN		TITLE: BELLOW		REF. TO ASSY. DRG.		ITEM No.	
								DRAWING No. BACH-SP-3		SHEET No. 1	
								No. OF SHEET			

The information on this document is the property of BHARAT HEAVY ELECTRICALS LIMITED. It must not be used directly or indirectly in any way detrimental to the interest of the company

REF. DRG. No.

SIGN & DATE

INVENTORY No.

492

6

खंड 1 (A) का नक्शा

खंड 1 (A) का नक्शा

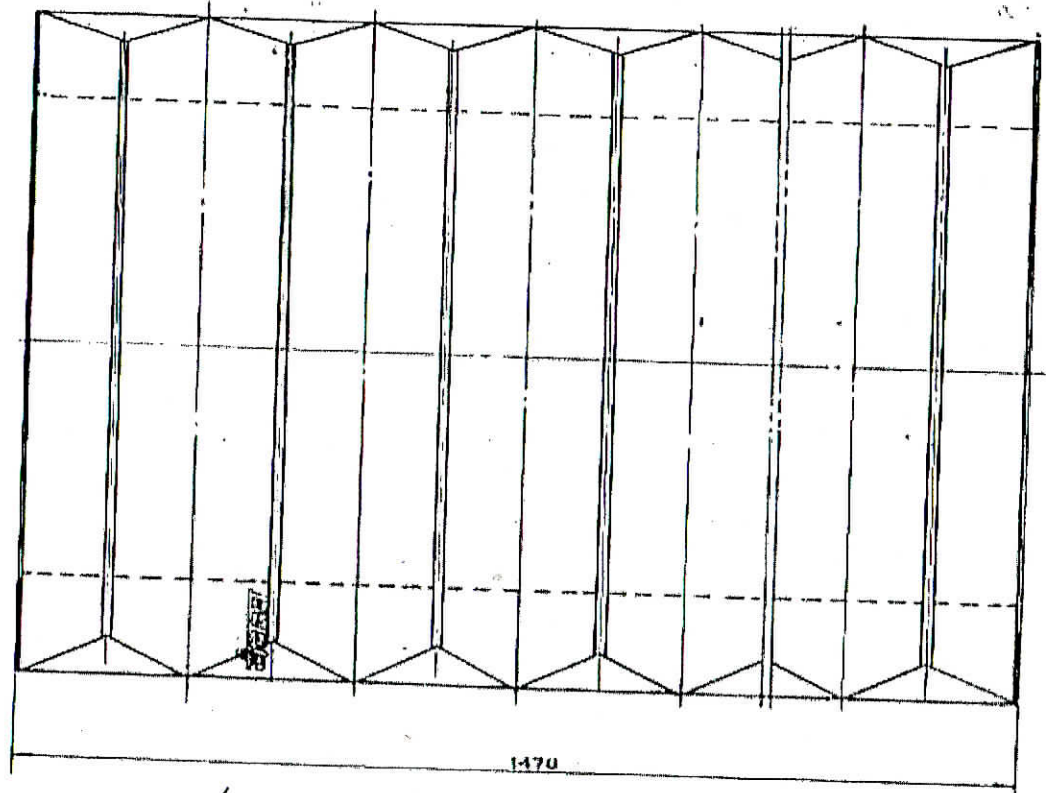
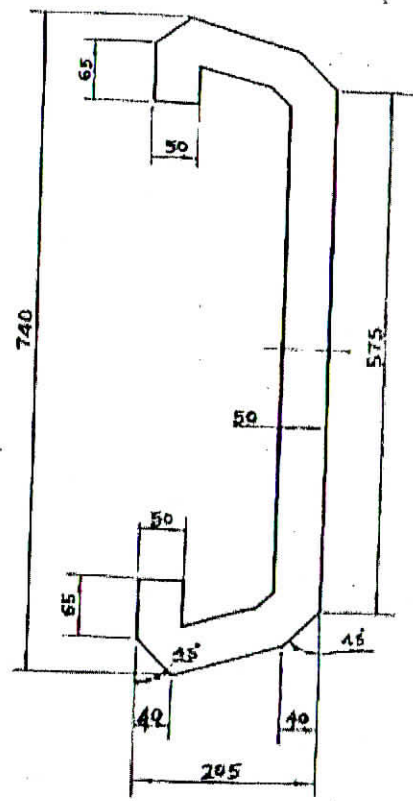

संख्या

सं. नं. 024/128



विलंबित
Inlet No. 2013/13506

VERTICAL SURFACE GRILLER		BLOCK-IV	BASED ON-	
BHEL HARDWARE		BHARAT HEAVY ELECTRICALS LTD		
WEX (PLG)				
BELLOW		MAT -		
DRW.	RAHAT	2	14.20	
CHD.	SHANOMA	1	14.51	
ENGR.	R. SINGH			
DRO. NO. -		BRV-70-5P-4		

खंड 1 (A) का नक्शा
लेखक

DRAWING NO. BRV-70-SP-09

COPYRIGHT AND CONFIDENTIAL
THE INFORMATION ON THIS DOCUMENT IS THE PROPERTY OF
BHARAT HEAVY ELECTRICALS LIMITED. IT MUST NOT BE USED DIRECTLY
OR INDIRECTLY IN ANY WAY DETRIMENTAL TO THE INTEREST OF THE COMPANY.

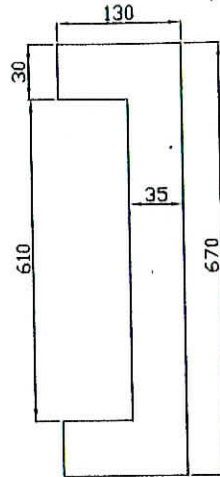
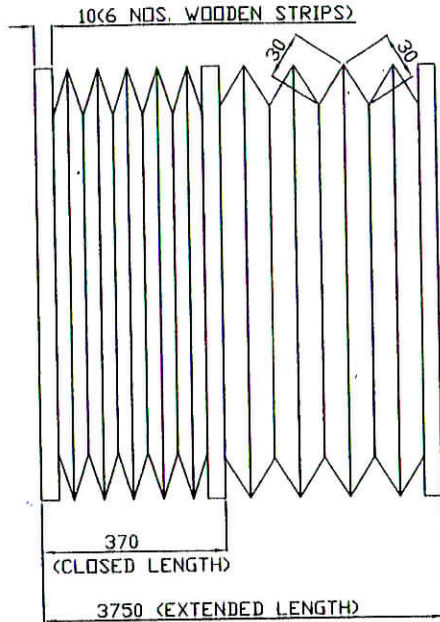

NOTES:

- 1-CLOSED LENGTH-370.
- 2-TRAVERSE-2500.
- 3-EXTENDED LENGTH-3750.
- 4-BELLOW ASSEMBLY COMPRISES OF 5 BELLOWS EACH OF 12 FOLDS.
- 5-MOVEMENT OF BELLOWS SHOULD BE SMOOTH
- 6-PARTY SHOULD GIVE PERFORMANCE GUARANTEE FOR 12 MONTHS.
- 7-MATERIAL OF BELLOWS SHOULD BE CHIPS, OIL AND COOLANT RESISTANT FABRIC.

Index No: 2013/3506
Wahid

06-08-03/188 INVENTORY NO.
SIGN & DATE
SAMPLE REF. DRG NO.

GRADE OF UNTOL. DIM.:-		CBOM NO.		STATUS OF DRG.		TYPE OF PRODUCT VERT. SURFACE GRINDER				PLAN NO.-2-310	
M/CG- X/Ø/M/P AA 0230208		AGREED DEPT.		NAME		SIGN		DATE		NO. OF VAR.	
WELDING-A/B/C/D-AA621104		NAME		SIGN		DATE		NO. OF VAR.		NO. OF ITEMS	
GAS CUTTING-'T3'AA0621101		NAME		SIGN		DATE		NO. OF VAR.		NO. OF ITEMS	
REV. DATE ALTERED CHECKED		REV. DATE ALTERED CHECKED		DEPT. WEX		SCALE N.T.S.		WEIGHT(Kg.)		REF. TO ASSY. DRG.	
				CODE DESIGN		N.T.S.				ITEM NO.	
				TITLE		L.H. & R.H. BELLOW COVER (BED)		DRAWING NO. BRV-70-SP-09		SHEET NO. 01 NO. OF SHEETS 01	
										22 23 24	

FIRST ANGLE PROJECTION

(ALL DIMENSIONS ARE IN mm)

FORM: DG-38(B)

DRAWING NO. K05239-SP-

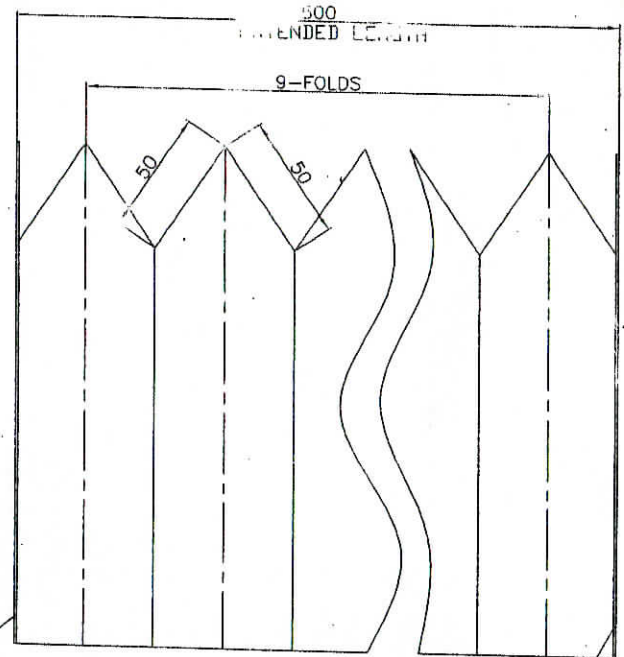
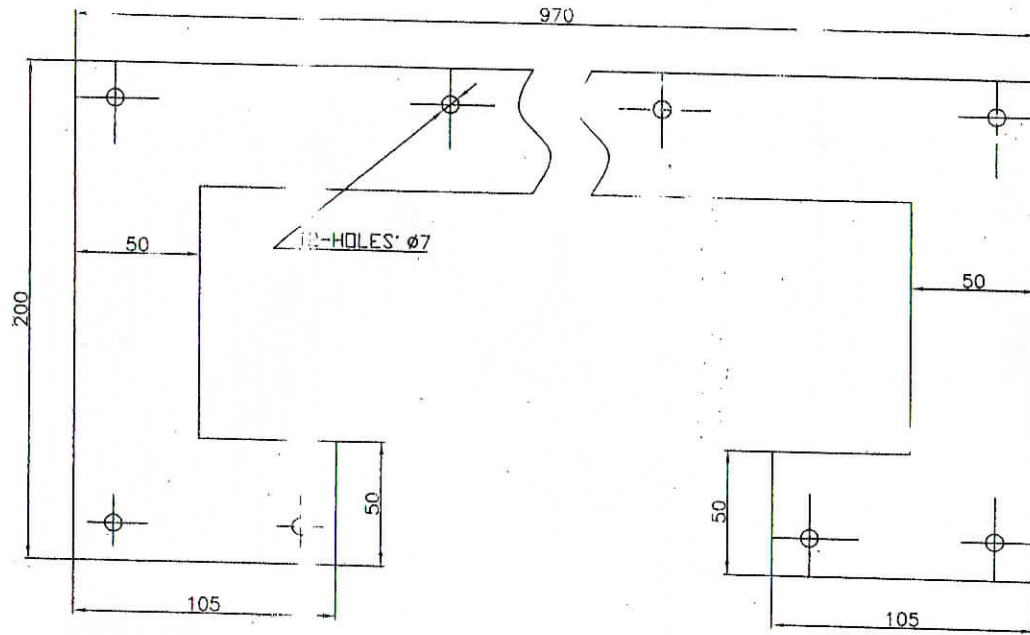

STEEL SHEET 1mm THICK

1. CLOSED LENGTH 200
2. TRAVERSE 250
3. EXTENDED LENGTH 450
4. MATERIAL OF BELLOW SHOULD BE OIL AND WATER PROOF RUBBERISED RAYON.
5. PARTY SHOULD VISIT THE SITE AND TAKE ALL NECESSARY MEASUREMENTS REQUIRED FOR MANUFACTURE AND FITTING OF BELLOW.
6. PARTY SHOULD GIVE PERFORMANCE GUARANTEE FOR 12 MONTHS.



SAMPLE REF. DRG NO.

SIGN & DATE

INVENTORY NO.

MAT.-
PLAN NO.-2-378
BLOCK-III

GRADE OF UNTOL. M.:-		CBOM NO.		STATUS OF DRG.		TYPE OF PRODUCT OR 3-SPINDLE COPYING MILLING M/C				MAT.-	
M/CG-X/Y/M/P 0230208		NAME		SIGN		DATE		NAME OF CUSTOMER/ PROJECT		PLAN NO.-2-378	
WELDING-A/B/C/D AA621104		AGREED DEPT.		NAME		SIGN		DRN G.PRASAD		DATE 27-07-2000	
GAS CUTTING-T3A 0621101		V. DATE		ALTERED		CHECKED		CHD MALHOTRA		NO. OF VAR.	
REV. DATE ALTERED CHECKED		DEPT. WEX		SCALE 1:2		WEIGHT(Kg.)		REF. TO ASSY. DRG.		73, 74	
TITLE BELLOW COVER (COLUMN)		CODE/DESIGN		APD		ITEM NO.		NO. OF ITEMS		75, 77	
DRAWING NO. K05239-SP-12		SHEET NO. 01		NO. OF SHEETS 01		A3					

20/03/06
Invt No. 2003/464
Maha...

WEX

2000 03-019/464

8

THE INFORMATION ON THIS DOCUMENT IS THE PROPERTY OF BHARAT HEAVY ELECTRICALS LIMITED. IT MUST NOT BE USED DIRECTLY OR INDIRECTLY IN ANY WAY DETRIMENTAL TO THE INTEREST OF THE COMPANY.

COPYRIGHT AND CONFIDENTIAL

DRAWING NO.

W 163

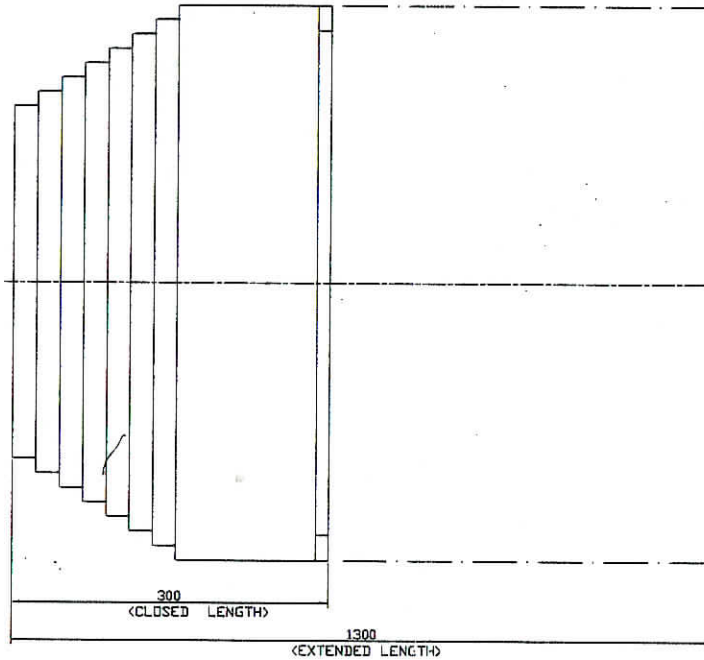
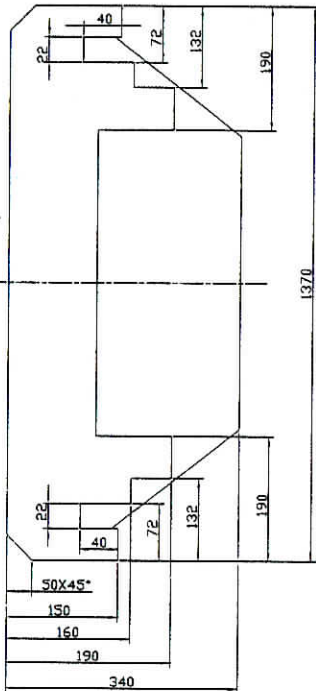

1. NO. OF COVERS. - 08
2. CLOSED LENGTH. - 300
3. TRAVERSE. - 1000
4. EXTENDED LENGTH. - 1300.
5. MAX. TRAVERSING SPEED. - 3-4M/MIN.
6. ALL TELESCOPIC COVERS SHOULD BE PROVIDED WITH POLYURETHANE WIPERS. THESE WIPERS SHOULD BE TEMPERATURE RESISTANT FROM 0°C TO 100°C AND SHOULD BE RESISTANT TO OIL, WATER AND COOLANT.
7. COVERS SHOULD BE MADE OF 3 MM THICK OR GAUGE 11 ANTI-RUST STEEL PLATES HAVING ZINC COATING OF 0.5 MM MINIMUM.
8. COVERS SHOULD BE OF WALK ON TYPE.
9. THE COVERS SHOULD BE SUFFICIENT RIGID AND SLIDABLE AND SHOULD HAVE ROLLERS WITH BALLBEARINGS/NEEDLE BEARINGS ETC. FOR SMOOTH RUNNING.
10. THE PROFILE OF THE COVER SHOULD BE AS PER DRG.
11. THE WIPER LIPS SHOULD HAVE STEEL COVERING FOR PROTECTION AGAINST HOT CHIPS. THIS WIPER PROTECTION COVERING SHOULD BE FITTED BY SPOT WELDING TECHNIQUE. PLEASE CONFIRM.
12. WORKING CONDITION OF M/C INVOLVES WATER, COOLANT AND OIL SPILLAGE ON THE COVERS. THE SEALING OF COVERS BETWEEN SLIDING MOVEMENT SHOULD BE ENSURED SUCH THAT THERE IS NO SPILLAGE OF ANY FORGM MATERIAL.
13. ALL THE DIMENSIONS OF THE DRG. ARE APPROX. DIMENSIONS. THE SUPPLIER SHOULD NOTE DOWN THE FINAL DIMENSIONS FROM THE M/C ITSELF FOR PROPER FITTING ON THE M/C AND TO AVOID FITTMENT AND RUNNING PROBLEM OF THE SITE FOR TROUBLE FREE RUN.
14. THE SUPPLIER SHALL ARRANGE TO FIT THE TELESCOPIC COVERS ON THE M/C WITHIN TWO WEEKS TIME.
15. PROFILE OF THE COVERS SHOULD BE PREFERABLY MANUFACTURE ON PROFILE FORMING M/C IF POSSIBLE. PLEASE CONFIRM.
16. THE PROFILE OF THE FIRST COVER OF TELESCOPIC COVERS OF LEFT SIDE OF M/C AND RIGHT SIDE OF M/C ARE DIFFERENT DUE TO TYPICAL PROFILE OF DIFFERENT SUB-ASSEMBLIES FITTED ON THE M/C.
17. CHECKERRED PLATE PLATFORM THICKNESS OF PLATE 5MM IS TO BE PROVIDED ON BOTH ENDS.



MAT.-M.S.

CBOM NO.		STATUS OF DRG.		TYPE OF PRODUCT MFD LATHE		PLAN NO.-2-394	
AGREED DEPT.		NAME SIGN DATE		OR NAME OF CUSTOMER/ PROJECT		BLOCK-III	
GRADE OF UNTOL. DIM.:-				Bharat Heavy Electricals Ltd. Hardwar		NAME SIGN DATE NO. OF VAR.	
M/CG- A/E/M/H AA 0230208				DRN N.S. THAPA		22/X/08	
WELDING-A/B/C/D-AA621104				CHD YOGENDRA			
GAS CUTTING-T3'AA0621101				APD PRAVEEN		23, 24	
REV.	DATE	ALTERED CHECKED	REV.	DATE	ALTERED CHECKED	DEPT. WEX	SCALE
						1:2	WEIGHT (Kg.)
				REF. TO ASSY. DRG.		ITEM NO. OF ITEMS	
				TITLE		DRAWING NO.	
				TELESCOPIC COVER		D-1800-SP-14	
						SHEET NO. 01 NO. OF SHEETS 01	

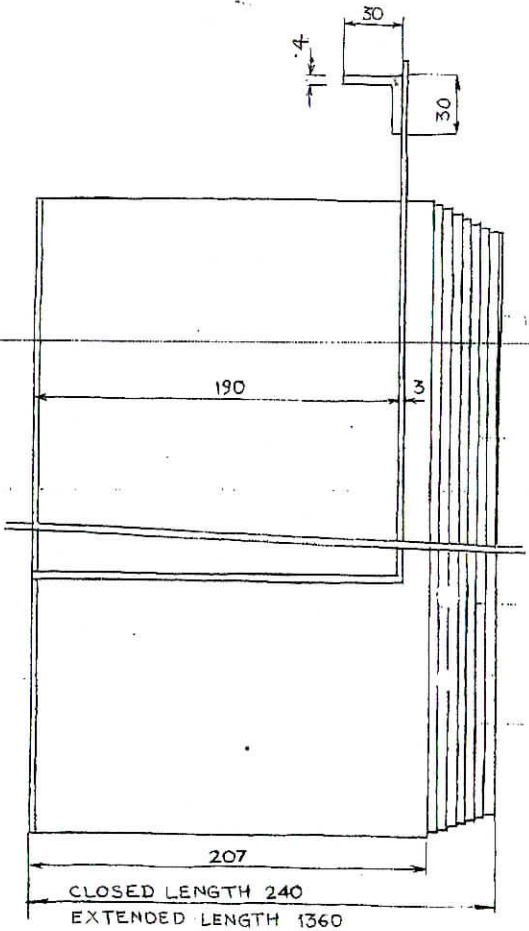

SCREWS AS PER SITE REQUIREM

CLOSED LENGTH 240
EXTENDED LENGTH 1360

NOTE :- 1 MATERIAL OF BED COVER GR.MS SHEET 2 MM THICK
2. M/C TRAVEL 1100 MM

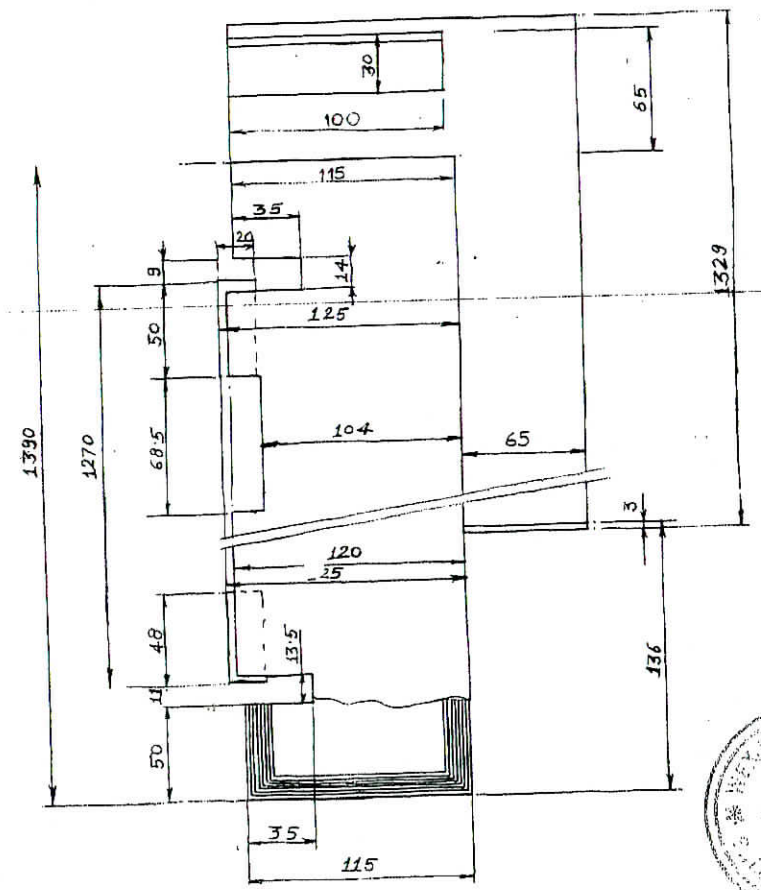

INVENTORY NO. 96-E-003
 SIGN & DATE 32
 REF. DRG. NO. SAMPLE
 COPYRIGHT AND CONFIDENTIAL
 The information contained herein is the property of BHARAT HEAVY ELECTRICALS LTD. and should not be used directly or indirectly in any way detrimental to the interest of the Company.

GRADE OF I				
MCG. :- C/				
WELDING :-				
GAS CUTTING				
REV	DATE	ALTERED	REV	DATE
		CHECKED		
ZONE			ZONE	

REMARKS	ITEM No.	DESCRIPTION	DRAWING No.	MATERIAL CODE	UNIT	UNIT WEIGHT	ZONE
				VAR MATERIAL SPECN			
CARD TYPE-3		CARD TYPE-1		CARD TYPE-2			
IMS No./GR. SP No.		STATUS OF DRG.		TYPE OF PRODUCT		PLAN NO - 2-360	
AGREED		NAME		OR		BLOCK - 3	
				BHARAT HEAVY ELECTRICALS LTD.		DRN. D.S. CHANDHAN	
				HARDWAR		SIGN AGARWAL	
				DEPT. WEX		DATE 2-6-26	
				SCALE 1:2		NO. OF VARI	
				WEIGHT (KG)		73 74	
				REF. TO ASSY. DRG.		ITEM No.	
				TITLE		NO. OF ITEMS	
				TELESCOPIC COVER		75 77	
				(X AXIS GUIDEWAYS)		78 79	
				DRAWING No.		REV	
				D-2300-SP-32:00		132 133 134	
				SHEET NO. 0		NO. OF SHEETS 0	

DRAWING NO. W200HB-SP-09

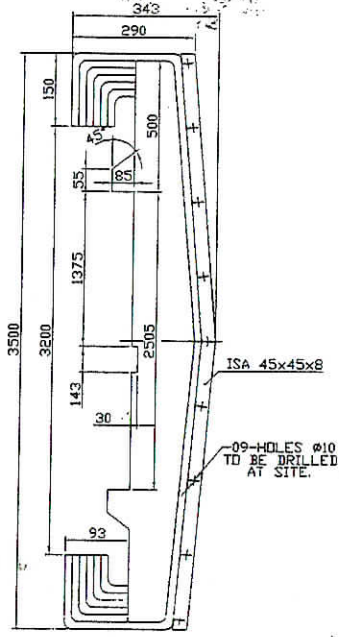
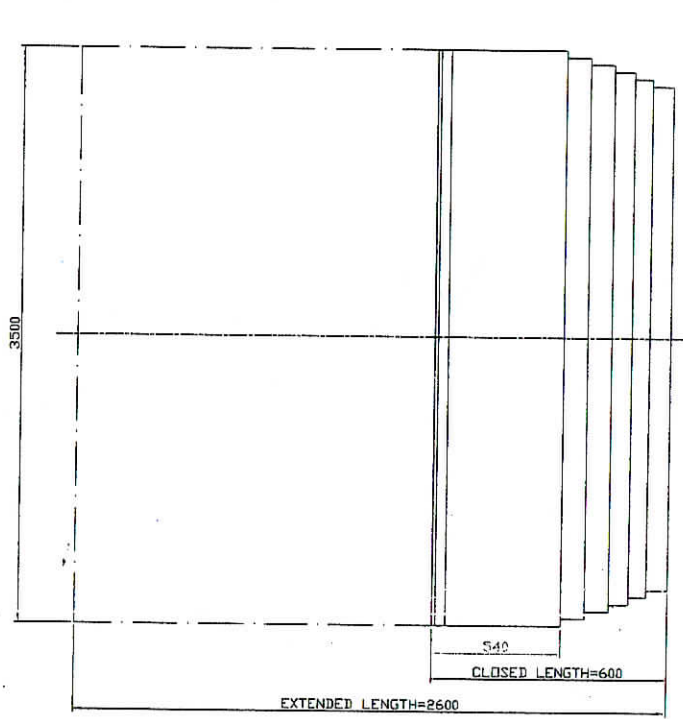

1. NO. OF COVERS. - 08
2. CLOSED LENGTH. - 600
3. TRAVERSE. - 2000
4. BED WIDTH - 2500.
5. EXTENDED LENGTH. -- 2600
6. MAX. TRAVERSING SPEED. -05M/MIN
7. ALL TELESCOPIC COVERS SHOULD BE PROVIDED WITH POLYURETHANE WIPERS. THESE WIPERS SHOULD BE TEMPERATURE RESISTANT FROM 0°C TO 100°C AND SHOULD BE RESISTANT TO OIL, WATER AND COOLANT.
8. COVERS SHOULD BE MADE OF 3 MM THICK OR GAUGE 11 ANTI-RUST STEEL PLATES HAVING ZINC COATING OF 0.5 MM MINIMUM.
9. COVERS SHOULD BE OF WALK ON TYPE.
10. THE COVERS SHOULD BE SUFFICIENT RIGID AND SLIDABLE AND SHOULD HAVE ROLLERS WITH BALL/NEEDLE BEARINGS ETC. FOR SMOOTH RUNNING.
11. THE PROFILE OF THE COVER SHOULD BE AS PER DRG.
12. THE WIPER LIPS SHOULD HAVE STEEL COVERING FOR PROTECTION AGAINST HOT CHIPS. THIS WIPER PROTECTION COVERING SHOULD BE FITTED BY SPOT WELDING TECHNIQUE. PLEASE CONFIRM.
13. WORKING CONDITION OF M/C INVOLVES WATER, COOLENT AND OIL SPILLAGE ON THE COVERS. THE SEALING OF COVERS BETWEEN SLIDING MOVEMENT SHOULD BE ENSURED SUCH THAT THERE IS NO SPILLAGE OF ANY FOREIGN MATERIAL.
14. ALL THE DIMENSIONS OF THE DRG. ARE APPROX. DIMENSIONS. THE SUPPLIER SHOULD NOTE DOWN THE FINAL DIMENSIONS FROM THE M/C HIMSELF FOR PROPER FITTING ON THE M/C AND TO AVOID FITTMENT AND RUNNING PROBLEM OF THE SITE FOR TROUBLE FREE RUN.
15. THE SUPPLIER SHALL ARRANGE TO FIT THE TELESCOPIC COVERS ON THE M/C WITHIN TWO WEEKS TIME.
16. PROFILE OF THE COVERS SHOULD BE PREFERABLY MANUFACTURED ON PROFILE FORMING M/C IF POSSIBLE. PLEASE CONFIRM.
17. THE PROFILE OF THE FIRST COVER OF TELESCOPIC COVERS OF LEFT SIDE OF M/C AND RINGT SIDE OF M/C ARE DIFFERENT DUE TO TYPICAL PROFILE OF DIFFERENT SUB-ASSEMBLIES FITTED ON THE M/C.



CBOM NO. —		STATUS OF DWG. —		TYPE OF PRODUCT HORZ. BORING M/C.		PLAN NO.-2-473	
AGREED DEPT. —		NAME SIGN DATE		OR NAME OF CUSTOMER/ PROJECT		BLOCK-III	
GRADE OF UNTOL. DIM.:-				NAME SIGN DATE NO. OF VAR.		DRN N.S.THAPA 25/1/2014	
M/C/G- X/R/M/F AA 0230208				VIKRANT KUMAR		CHD YOGENDRA	
WELDING-A/B/C/D-AA621104				Sr. Engineer		APD SANJAY	
GAS CUTTING-T3'AA0621101				REV. DATE ALTERED CHECKED		REF. TO ASSY/ DRG.	
REV. DATE ALTERED CHECKED				DEPT. WEX		SCALE WEIGHT(Kg.)	
REV. DATE ALTERED CHECKED				CODE/DESIGN		N.T.S.	
TITLE TELESCOPIC COVER (FRONT TABLE)				DRAWING NO. W200HB-SP-09 00		ITEM NO. OF ITEMS 75, 74 75, 77	
SHEET NO. 01				NO. OF SHEETS 01		NO. OF SHEETS 01	

THE INFORMATION ON THIS DOCUMENT IS THE PROPERTY OF
 BHARAT HEAVY ELECTRICALS LIMITED. IT MUST NOT BE USED DIRECTLY
 OR INDIRECTLY IN ANY WAY DETRIMENTAL TO THE INTEREST OF THE COMPANY.

DRAWING NO. HM 200-SP-10

- 1- NO. OF COVERS - 18
- 2- CLOSED LENGTH - 1100
- 3- TRAVERSERS - 12000
- 4- EXTENDED LENGTH - 13100
- 5- MAX. WIDTH OF COVER NOT TO EXCEED - 750 m.m.
- 6- MAX. TRAVERSING SPEED - 5-8 METER/min.
- 7- ALL TELESCOPIC COVERS SHOULD BE PROVIDED WITH POLYURETHANE WIPERS. THESE WIPERS SHOULD BE TEMPERATURE RESISTANT FROM 0°C TO 100°C AND SHOULD BE RESISTANT TO OIL, WATER AND COOLANT.
- 8- COVER SHOULD BE MADE OF 3m.m. THICK OR 11 GAUGE (C.R.C.A) ANTI-RUST STEEL PLATES HAVING ZINC COATING.
- 9- COVERS SHOULD BE OF WALK ON TYPE
- 10- THE PROFILE OF COVER SHOULD BE AS PER DRG.
- 11- WORKING CONDITION OF M/C INVOLVES WATER, COOLANT AND OIL SPILLAGE ON THE COVERS. THE SEALING OF COVERS BETWEEN SLIDING MOVEMENT SHOULD BE ENSURED SUCH THAT THERE IS NO SPILLAGE OF ANY FOREIGN MATERIAL.
- 12- THE COVERS SHOULD BE SUFFICIENT RIGID AND SLIDABLE AND SHOULD HAVE ROLLERS WITH BALL BEARING/NEEDLE BEARINGS ETC FOR SMOOTH RUNNING.
- 13- ALL THE DIMENSIONS OF THE DRG. ARE APPROX. DIMENSIONS. THE SUPPLIER SHOULD NOTE DOWN THE FINAL DIMENSIONS FROM THE M/C ITSELF FOR PROPER FITTING ON THE M/C AND TO AVOID FITTMENT AND RUNNING PROBLEM OF THE SITE FOR TROUBLE FREE RUN.
- 14- THE SUPPLIER SHALL ARRANGE TO FIT THE TELESCOPIC COVERS ON THE M/C WITHIN TWO WEEKS TIME.
- 15- PROFILE OF THE COVERS SHOULD BE PREFERABLY MANUFACTURED ON PROFILE FORMING M/C IF POSSIBLE. PL. CONFIRM.
- 16- THE TELESCOPIC COVERS OF LEFT SIDE AND RIGHT SIDE OF M/C ARE DIFFERENT DUE TO FITTING CONDITIONS.

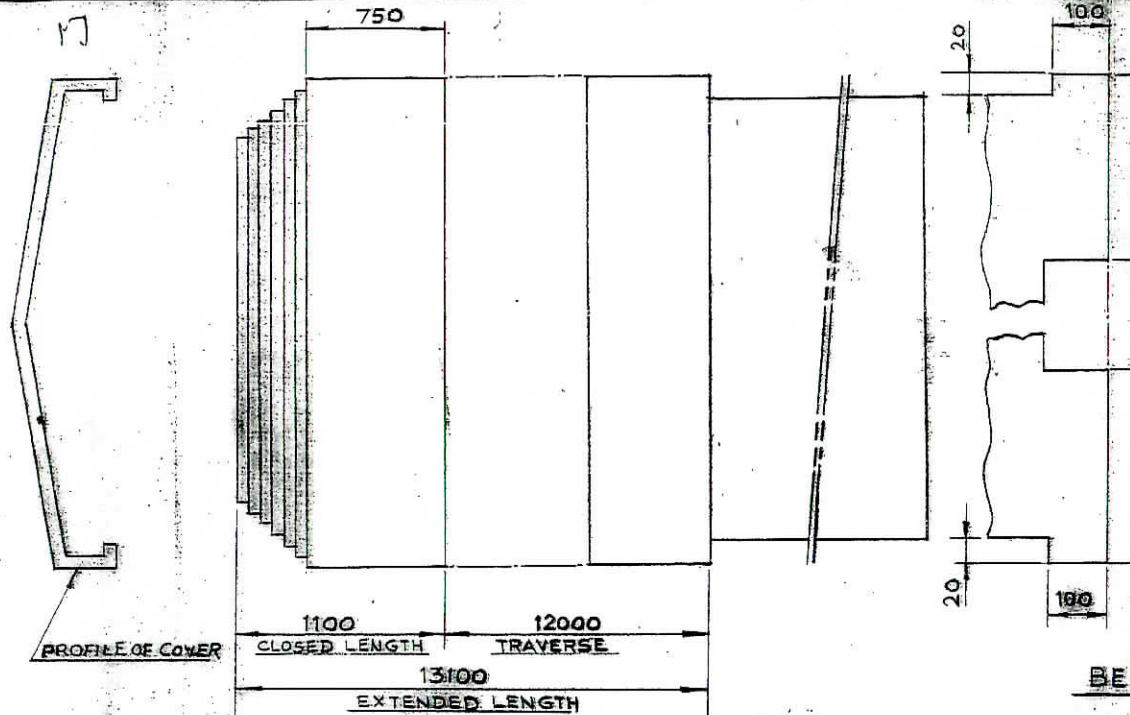

2000-07-002 INVENTORY NO. / 557 SIGN & DATE



VAR. 00	REMARKS	ITEM NO.	DESCRIPTION	STD	DRAWING NO.	MATERIAL CODE	UNIT W
59 64 65		75 25 27 29		58 69 60		29 31 VAR MATERIAL SPECN	54 55 56 57 66
CARD TYPE-3		28	28	CARD TYPE-1		28	
GMS NO./GR. SP. NO.			STATUS OF DRG.		TYPE OF PRODUCT		
AGREED DEPT.			NAME		SIGN.		
DATE			NAME OF CUSTOMER/ PROJECT		DATE		
GRADE OF UNTOL. DIM.:-			M/CG- V/C/M/F AA 0230208		NAME		
WELDING-A/B/C/D-AA621104			GAS CUTTING-T3'AA0621101		SIGN		
REV. DATE			ALTERED CHECKED		DATE		
APD			DEPT. WEX		SCALE		
CODE DESIGN			TITLE		WEIGHT (Kg.)		
			TELESCOPIC COVER (LONGITUDINAL)		REF. TO ASSY. DRG.		
			DRAWING NO.		SHEET NO.		
			HM 200-SP-10		18-0		

COPYRIGHT AND CONFIDENTIAL

THE INFORMATION ON THIS DOCUMENT IS THE PROPERTY OF BHARAT HEAVY ELECTRICALS LIMITED. IT MUST NOT BE USED DIRECTLY OR INDIRECTLY IN ANY WAY DETRIMENTAL TO THE INTEREST OF THE COMPANY.

SAMPLE REF. DRG NO.

SIGN & DATE

13-12-01/738 INVENTORY NO.

FIRST ANGLE PROJECTION

(ALL DIMENSIONS ARE IN mm)

FORM: C

DRAWING NO. RX-7-SP-1

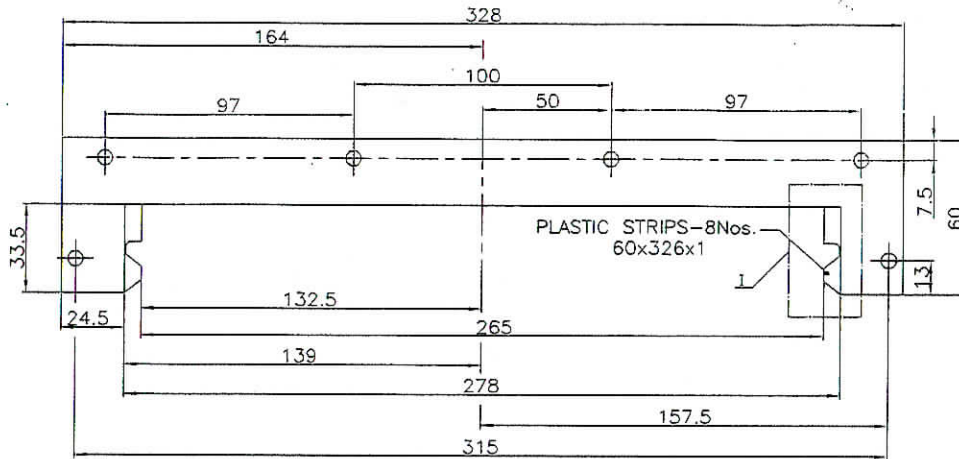

VIEW AT 'X'

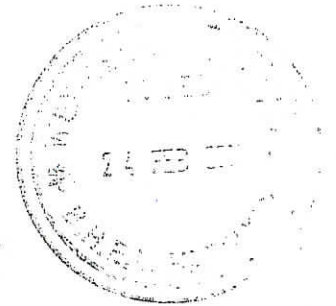
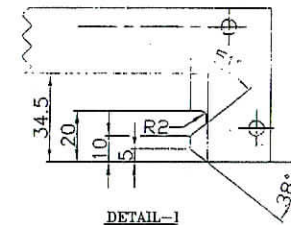
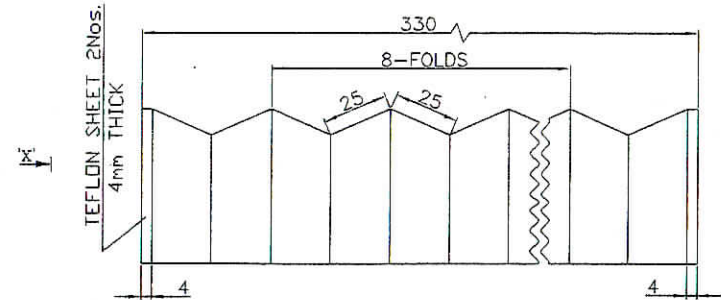

1. CLOSED LENGTH 34
2. TRAVERSE 270
3. EXTENDED LENGTH 330
4. MATERIAL OF BELLOW SHOULD BE OIL AND WATER PROOF RUBBERISED RAXINE.
5. PARTY SHOULD VISIT THE SITE AND TAKE ALL NECESSARY MEASUREMENTS REQUIRED FOR MANUFACTURE AND FITTING OF BELLOW.
6. PARTY SHOULD GIVE PERFORMANCE GUARANTEE FOR 12 MONTHS.

GRADE OF UNTOL. DIM.:-		CBOM NO.		STATUS OF DRG.		TYPE OF PRODUCT			PLAN NO.-6-2		
M/CG- X/Q/M/F AA 0230208		AGREED DEPT.		NAME SIGN DATE		OR ANCA TOOL & CUTTER GRINDER			BLOCK-III		
WELDING-A/B/C/D-AA621104		NAME		SIGN		NAME OF CUSTOMER/ PROJECT			DATE		
GAS CUTTING-T3'AA0621101		SIGNATURE		DATE		BHARAT HEAVY ELECTRICALS LTD.			DRN N.S.THAPA 23/XII/2001		
REV. DATE ALTERED CHECKED		REV. DATE ALTERED CHECKED		DEPT. WEX			SCALE N.T.S.		WEIGHT(Kg.)		REF. TO ASSY. DRG.
				CODE DESIGN			N.T.S.		-		ITEM NO.
				TITLE			BELLOW COVER		DRAWING NO.		RX-7-SP-1
							(COLUMN)		SHEET NO. 01		NO.OF SHEETS

SIZ

DRAWING NO. TMD-40-50-SP-10

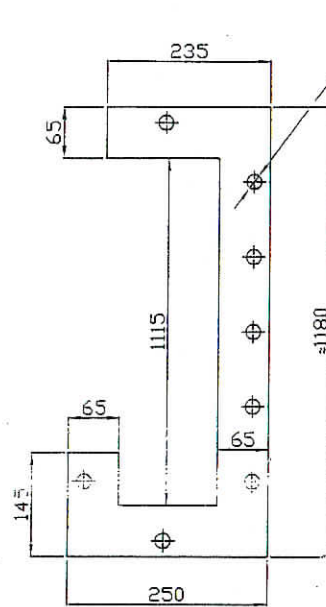
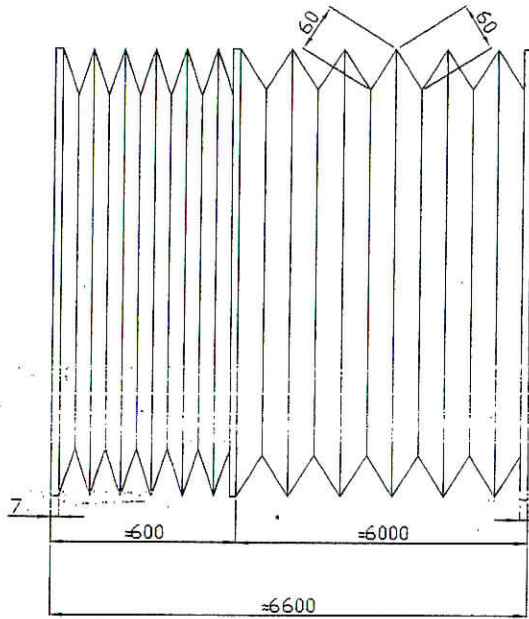

8-MOUNTING HOLES $\varnothing 7$
TO BE DRILLED AT SITE.

- 1-CLOSED LENGTH =600
- 2-TRAVERSE =6000
- 3-EXTENDED LENGTH =6600
- 4-BELLOWS ASSEMBLY COMPRISES OF 11 BELLOWS EACH OF 5 FOLDS.
- 5- THESE BELLOWS SHOULD BE SUITABLE FOR GUIDE HAVING A WIDTH OF --- ROUGH SKETCH OF GUIDE IS SHOWN IN THE DRAWING.
- 6- PARTY SHOULD VISIT THE SITE AND TAKE ALL THE NECESSARY MEASUREMENTS REQUIRED FOR MANUFACTURE AND FITTING OF BELLOWS.
- 7- MOVEMENT OF BELLOWS SHOULD BE SMOOTH AND PARTY SHOULD PROVIDE ROLLERS WHERE EVER NECESSARY.
- 8- PARTY SHOULD GIVE PERFORMANCE GUARANTEE FOR 12 MONTHS.
- 9- MATERIAL OF BELLOWS SHOULD BE CHIPS AND COOLANT RESISTANT FABRIC HAVING CONTINUOUS REINFORCED PLASTIC STIFFNERS.
- 10- BELLOWS SHOULD BE JOINED WITH SUITABLE STAINLESS STEEL CHAIN TO TAKE WEIGHT OF BELLOW COVERS.

THE INFORMATION ON THIS DOCUMENT IS THE PROPERTY OF BHARAT HEAVY ELECTRICALS LIMITED. IT MUST NOT BE USED DIRECTLY OR INDIRECTLY IN ANY WAY DETRIMENTAL TO THE INTEREST OF THE COMPANY.

13-06-06/570 INVENTORY NO. SIGN & DATE SAMPLE REF. DRG NO.

GRADE OF UNTOL. DIM.:-		CBOM NO.		STATUS OF DRG.		TYPE OF PRODUCT		PLAN NO.-2-422	
M/CS- 11/8/M/P AA 0230208		---		---		VERTICAL BORER		BLOCK-III	
WELDING-A/B/C/D-AA621104		AGREED DEPT.	NAME	SIGN	DATE	NAME OF CUSTOMER/ PROJECT			
GAS CUTTING-'T3'AA0621101						BHARAT HEAVY ELECTRICALS LTD.		HARDWAR	
REV. DATE ALTERED		V. K. KUMAR (Sr. Engineer)				DEPT. WEX		SCALE N.T.S.	
CHECKED						WEIGHT(Kg.)		REF. TO ASSY. DRG.	
						CODE DESIGN		ITEM NO.	
						TITLE		DRAWING NO.	
						BELLOW COVER (HORIZONTAL)		TMD-40-50-SP-10	
								SHEET NO. 01 NO.OF SHEETS 01	