

Technical Specifications for MATCHED PAIR SET OF SPIRAL BEVEL GEAR & PINION

S.No.	Description of BHEL Requirement	Specified / to be confirmed	Offered	Deviations	Remarks
1	Matched pair set of spiral bevel gear and pinion as per drawing no. : KY-152-SP-72-Rev-01 & KY-152-SP-73-Rev-01				Information to vendor
2	Drawing No. : KY-152-SP-72-Rev-01 & KY-152-SP-73-Rev-01 are provided for Boundry dimensions.				Information to vendor
3	Suitable teeth geometry should be adopted by the vendor for proper matching.				Vendor to offer
4	Maximum RPM on Gear & Pinion	412 RPM & 600 RPM			Vendor to confirm
5	Machining Process				Vendor to offer
6	Finishing Method	Lapping/Grinding			Vendor to confirm

~~V. K. Kunt~~  
 04.05.2015  
 Merchant Kumer  
 (Sr. Engr. WEX-132)

[Signature]  
 04/05/15  
 Ashish Gupta  
 (DGM/WEX-132)

DRAWING NO. KY152-SP-72

THE INFORMATION ON THIS DOCUMENT IS THE PROPERTY OF BHARAT HEAVY ELECTRICALS LIMITED. IT MUST NOT BE USED IN WHOLE OR IN PART WITHOUT THE WRITTEN PERMISSION OF THE COMPANY.

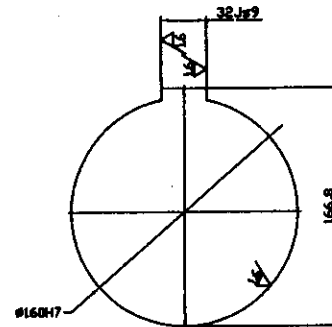
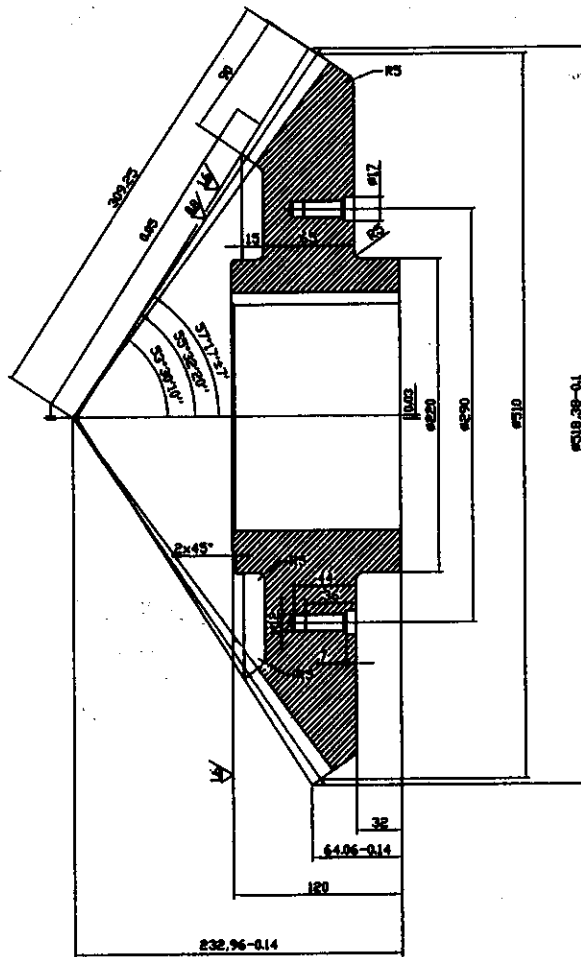

FACE MODULE	10	
NO. OF TEETH	51	
TYPE OF TOOTH	CIRCULAR	
MEAN TOOTH SPIRAL ANGLE	35°	
DIRECTION OF TEETH	L.H.	
PROFILE ANGLE OF RACK	20°	
PROFILE STANDARD		
TEETH DIMENSIONS	ADDENDUM	7.4
	DEPTH OF TOOTH	18.4
	THICKNESS OF TOOTH (ON PITCH CONE)	14.7
ACCURACY GRADE (GOST 1758-56) OR EQUIVALENT	7-x	
MATING PART DRG. NO.	SP-73	
MAX. PERIPHERAL SPEED M/C EC	8.4	



- 1. BLUNT ALL SHARP CORNERS
- 2. INDUCTION HARDENING OF TEETH TO HRC- 50-53.

MAT.- 18CrNiMo6

95-1-019/38  
 INVENTORY NO.  
 95-1-21-359  
 REF. DRG. NO.

GRADE OF UNTOL. DIM.:-		M/CO- X/R/M/AA 0230208		WELDING-A/B/C/D-AA821104		GAS CUTTING-T3/AA0821101		REV. DATE ALTERED CHECKED		REV. DATE ALTERED CHECKED		DEPT. WEX CODE/DESIGN		SCALE WEIGHT(Kg.) REF. TO ASSY. DRG. NO.		DRAWING NO. KY152-SP-72		SHEET NO. OF INO. OF SHEETS 01	
M/CO- X/R/M/AA 0230208		WELDING-A/B/C/D-AA821104		GAS CUTTING-T3/AA0821101		REV. DATE ALTERED CHECKED		REV. DATE ALTERED CHECKED		DEPT. WEX CODE/DESIGN		SCALE WEIGHT(Kg.) REF. TO ASSY. DRG. NO.		DRAWING NO. KY152-SP-72		SHEET NO. OF INO. OF SHEETS 01		SIZE A2	
M/CO- X/R/M/AA 0230208		WELDING-A/B/C/D-AA821104		GAS CUTTING-T3/AA0821101		REV. DATE ALTERED CHECKED		REV. DATE ALTERED CHECKED		DEPT. WEX CODE/DESIGN		SCALE WEIGHT(Kg.) REF. TO ASSY. DRG. NO.		DRAWING NO. KY152-SP-72		SHEET NO. OF INO. OF SHEETS 01		SIZE A2	
M/CO- X/R/M/AA 0230208		WELDING-A/B/C/D-AA821104		GAS CUTTING-T3/AA0821101		REV. DATE ALTERED CHECKED		REV. DATE ALTERED CHECKED		DEPT. WEX CODE/DESIGN		SCALE WEIGHT(Kg.) REF. TO ASSY. DRG. NO.		DRAWING NO. KY152-SP-72		SHEET NO. OF INO. OF SHEETS 01		SIZE A2	

TYPE OF PRODUCT V.BORER OR NAME OF CUSTOMER/ PROJECT PLAN NO.-1-13 BLOCK-I  
 BHARAT HEAVY ELECTRICALS LTD. HARDWAR  
 NAME SIGN DATE NO. OF VAR.  
 DRN M.K. Sarkar 23.04.15  
 CHD Yogendra  
 APD Saroj  
 TITLE SPIRAL BEVEL GEAR (SPEED GEAR BOX) (RETRACED)  
 REF. TO ASSY. DRG. NO. A91.21.001  
 DRAWING NO. KY152-SP-72  
 SHEET NO. OF INO. OF SHEETS 01

