

Reference Indent No.: 20153264 rv.1 dt. 12.09.15

Material Code : ZWN010505016, ZWN010508015, ZWN010509011

Work Order No. : ZMES1500101

**Pre-Qualifying Requirement (PQR):-**

- a) Only those vendors (Original Equipment Manufactures-OEM Authorized suppliers of OEMs) who have supplied at least one 2-bay compactor/optimizer or more in the past ten years (on the date of opening of tender) are only eligible to quote.
- > Such compactor/optimizer should be working satisfactorily for at least one year after its installation.
  - > The vendor should submit along with the offer one performance certificate from a customer on customer's letter head bearing name & designation of issuer of certificate to whom such machine is supplied and which is meeting the above criteria.
- b) The vendor should submit following information regarding company where referred compactor/optimizer has been installed.
- i) Name & Address of the customer/company.
  - ii) Date of installation of compactor/optimizer.
  - iii) Authorized Supplier should submit copy of authorization certificate from OEMs for supply of 2-bay compactor/optimizer and confirmation to take warranty obligation as per specification.
  - iv) BHEL reserves the right to verify the information provided by vendor. In case the information is found to be false/incorrect, the offer shall be rejected.

*ASJ*  
*12/09/2015*

*Ch. P. M.*  
*12/09/15*

Reference Indent No.: 20153264 rv.1 dt. 12.09.15

Material Code : ZWN010505016, ZWN010508015, ZWN010509011

Work Order No. : ZMES1500101

**Manufacturing and supplying of Compactor as per the following specification:-**

- i) The storages should be fixed or movable bolted to undercarriage which should be firmly embedded to the ground.
- ii) The size of each storage body shall be of width: 915mm (minimum, depth: 450mm (minimum) and a height: 1980mm (minimum). The overall height with undercarriage & rails should be 2080mm. The main body should be rigid knock down construction made out of Side Panels made up of 1mm and top and back panel is made up of 0.8mm thick CRCA steel as per IS:513:2008.
- iii) Each body block should consists of one single fixed unit, one double mobile, one single mobile unit and add on as per site conditions and each unit should have 5 loading levels formed by 4 nos of adjustable shelves.
- iv) The storage body units are bolted to the undercarriage. The shelf panel of storage unit should be made of 0.8mm thick CRCA steel (as per IS:513:2008) to take the minimum load bearing capacity of 50 Kg uniformly distributed per shelf.
- v) The shelves should be mounted on support brackets & its level should be adjustable. There should be 4 adjustable shelves per body giving 5 loading levels.
- vi) The under carriage should be made with HR sheet 2.5mm thick suitably fabricated using welding to take the loads.
- vii) The MSU should be running on a guide track of minimum rail size 25 mm bright square bar with necessary bracing/channel and base plates. (conforming to IS 2062/IS1079).
- viii) The bodies including shelves and undercarriages should be given 7 tank antirust surface treatment and finished with powder coating using epoxy powder of 40- 60 microns.
- ix) A centralized locking arrangement should be provided through the locking stiffener mounted onto back of single last unit so that it gets locked on channels when all the units are brought together.
- x) All the units should be provided with chrome plated handles. All the MSU should be provided with the features such as mechanical drive with a handle for mechanically assisted drive mechanism consisting of a series of sprocket and chain mechanism for smooth movement of the compactor with minimum effort.
- xi) It should be fitted with safety guard which is to be engaged when entering the common aisle. This should prevent from operating system when an individual is in the working aisle. The guide track should be provided with an end stopper to avoid derailment of the units.
- xii) It should be provided with the label holders.
- xiii) Assembly of bodies can be Two Bay Compactor.
- xiv) The mechanism can be drive type.
- xv) E&C charges 5% of total item cost. *E & C shall be done by vendor at BHEL HWR works.*
- xvi) Time period for E&C shall be 4 week *from the date of 1<sup>st</sup> Call to vendor by BHEL for E&C.*
- xvii) Warranty period of the material should be one year from the date of acceptance.
- xviii) Color of optimizers should be bond white with snowbell gray.

*AS*  
*12/09/2015*

*12/9/15*

Enclosures: A + B drawings.

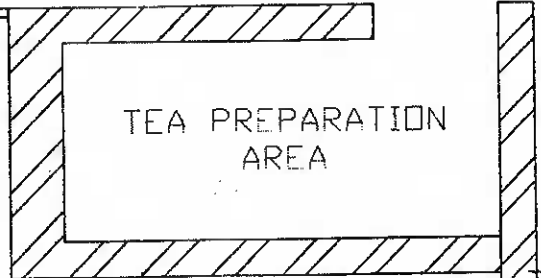
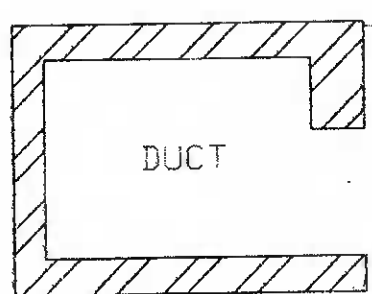

COMPACTOR

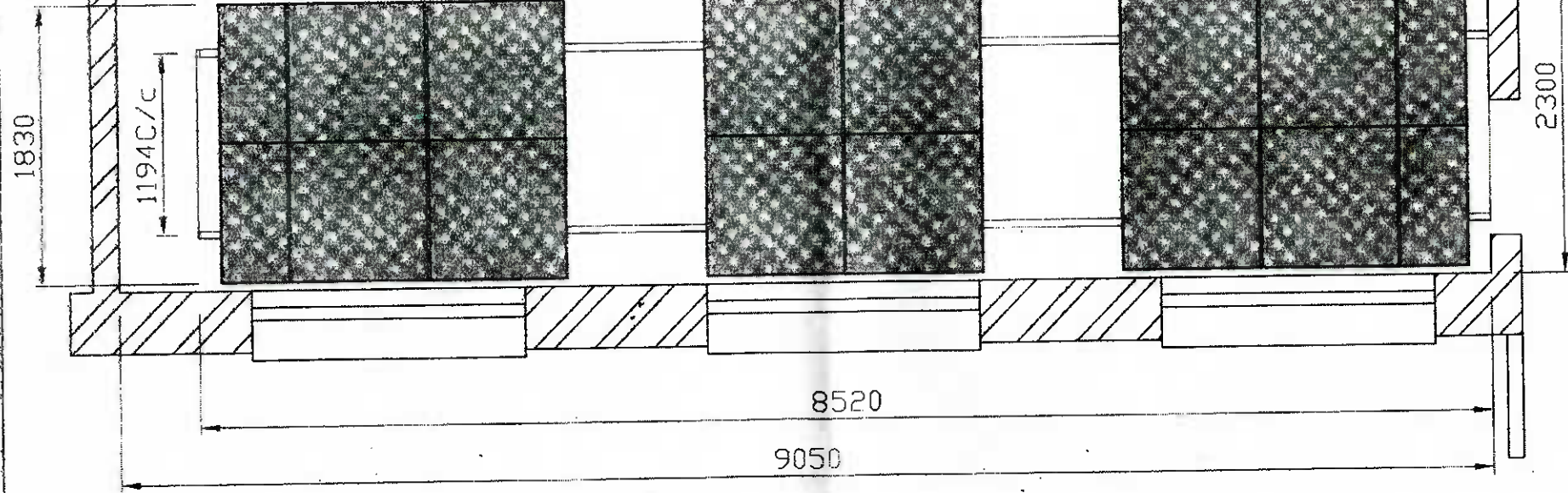

*Handwritten:* 81143 / 12/19/15

COMPACTOR ROOM FOR FCX  
DATE:-14/02/15

*Handwritten:* Annexure 'B'

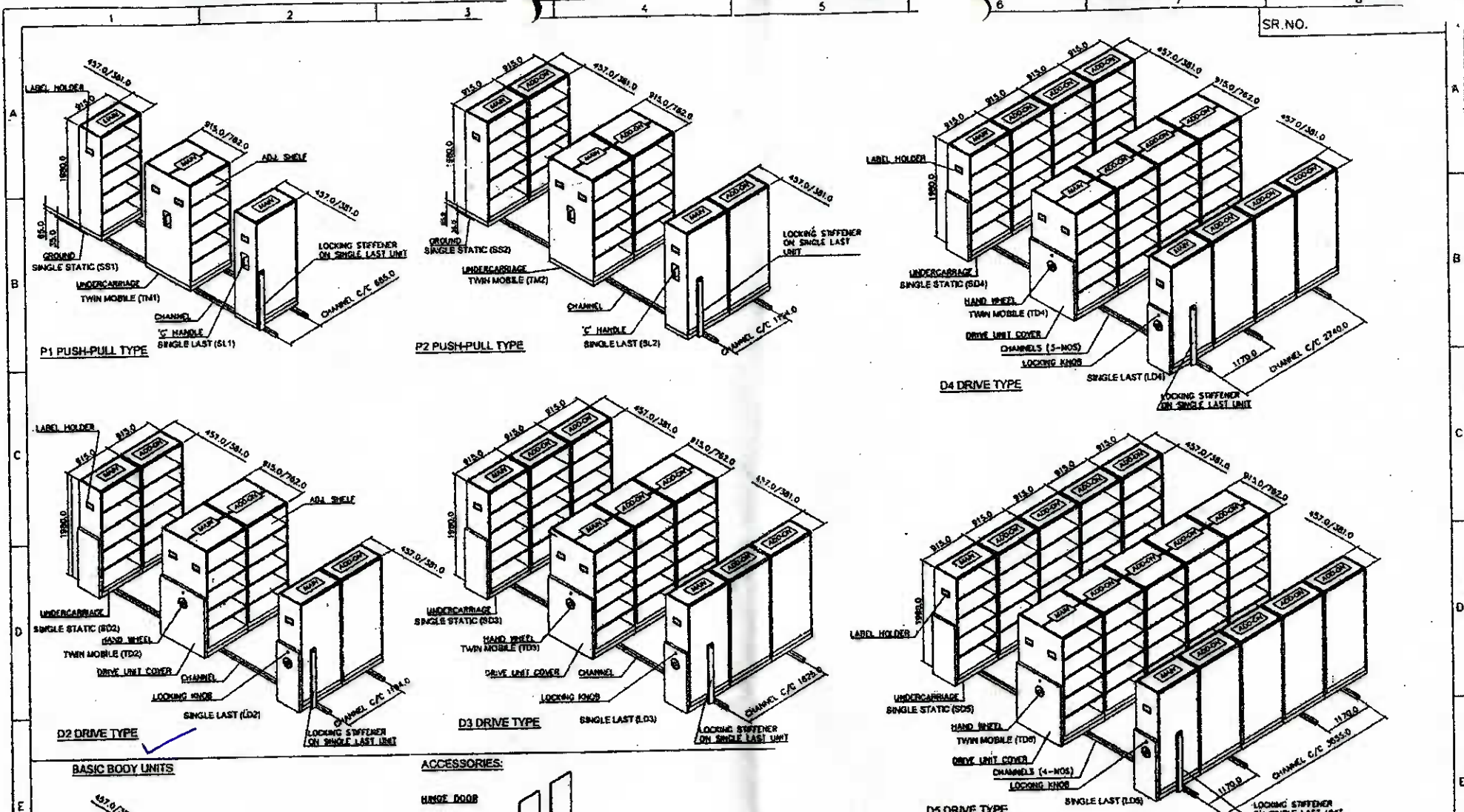

**BASIC BODY UNITS**

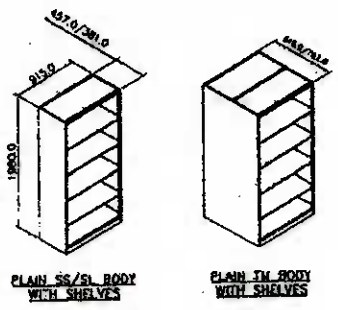

**ACCESSORIES:**

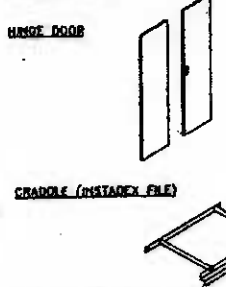

437 DEEP- (FOR BODY WITH HINGE DOOR/NO DOOR/SLIDING DOOR)  
 381 DEEP- (FOR BODY WITH HINGE DOOR/NO DOOR)

**ACCESSORIES:**

1					Ⓜ LAYOUT SYSTEM REMOVED, DESCRIPTION CHANGED						
MOD. No.		MODIFICATION			AREA		MDD. BY		DATE		CH. NOTE No.
DRN.	NAME	DATE	MATL. SPEC.	FINISH	P COAT	DESCRIPTION:					
CHK.			MS	No. OFF	--	P1 ,P2 ,D2 ,D3, D4, D5 KD OPTIMIZER ENHANCED					
APP.				WT. (kg)	--						
				SCALE	NTS	DRG. NO.					Rev no

Gr 100 2/19/15

Annexure (A)